**Textile machinery — Sliver cans,
rectangular — Main dimensions and
tolerances**

*Matériel pour l'industrie textile — Pots pour rubans, rectangulaires —
Dimensions principales et tolérances*



PDF disclaimer

This PDF file may contain embedded typefaces. In accordance with Adobe's licensing policy, this file may be printed or viewed but shall not be edited unless the typefaces which are embedded are licensed to and installed on the computer performing the editing. In downloading this file, parties accept therein the responsibility of not infringing Adobe's licensing policy. The ISO Central Secretariat accepts no liability in this area.

Adobe is a trademark of Adobe Systems Incorporated.

Details of the software products used to create this PDF file can be found in the General Info relative to the file; the PDF-creation parameters were optimized for printing. Every care has been taken to ensure that the file is suitable for use by ISO member bodies. In the unlikely event that a problem relating to it is found, please inform the Central Secretariat at the address given below.



COPYRIGHT PROTECTED DOCUMENT

© ISO 2010

All rights reserved. Unless otherwise specified, no part of this publication may be reproduced or utilized in any form or by any means, electronic or mechanical, including photocopying and microfilm, without permission in writing from either ISO at the address below or ISO's member body in the country of the requester.

ISO copyright office
Case postale 56 • CH-1211 Geneva 20
Tel. + 41 22 749 01 11
Fax + 41 22 749 09 47
E-mail copyright@iso.org
Web www.iso.org

Published in Switzerland

Foreword

ISO (the International Organization for Standardization) is a worldwide federation of national standards bodies (ISO member bodies). The work of preparing International Standards is normally carried out through ISO technical committees. Each member body interested in a subject for which a technical committee has been established has the right to be represented on that committee. International organizations, governmental and non-governmental, in liaison with ISO, also take part in the work. ISO collaborates closely with the International Electrotechnical Commission (IEC) on all matters of electrotechnical standardization.

International Standards are drafted in accordance with the rules given in the ISO/IEC Directives, Part 2.

The main task of technical committees is to prepare International Standards. Draft International Standards adopted by the technical committees are circulated to the member bodies for voting. Publication as an International Standard requires approval by at least 75 % of the member bodies casting a vote.

Attention is drawn to the possibility that some of the elements of this document may be the subject of patent rights. ISO shall not be held responsible for identifying any or all such patent rights.

ISO 16853 was prepared by Technical Committee ISO/TC 72, *Textile machinery and accessories*, Subcommittee SC 1, *Spinning preparatory, spinning, twisting and winding machinery and accessories*.

This second edition cancels and replaces the first edition (ISO 16853:2003), which has been technically revised.

© 2010 International Organization for Standardization

Textile machinery — Sliver cans, rectangular — Main dimensions and tolerances

1 Scope

This International Standard specifies the main dimensions, with tolerances, of rectangular sliver cans used in the textile industry. It also gives information about the right-angle position of cans according to ISO 1101.

2 Normative references

The following referenced documents are indispensable for the application of this document. For dated references, only the edition cited applies. For undated references, the latest edition of the referenced document (including any amendments) applies.

ISO 1101, *Geometrical Product Specifications (GPS) — Geometrical tolerancing — Tolerances of form, orientation, location and run-out*

3 Symbols and specifications

The symbols and specifications shall be the following:

b_1 outer width of the can

b_2 inner width of the can

h_1 outer height of the can

l_1 outer length of the can

l_1 up to 920 mm

$l_2 = l_1 - 20$ mm

$b_2 = b_1 - 20$ mm

l_1 greater than 920 mm

$l_2 = l_1 - 30$ mm

$b_2 = b_1 - 30$ mm

l_2 inner length of the can

NOTE The stability of the can requires a greater top rim of can for greater dimensions of sliver cans. It is known that this inevitably results in smaller inner dimensions.

4 Main dimensions

These shall be as specified in Table 1 and Figure 1.

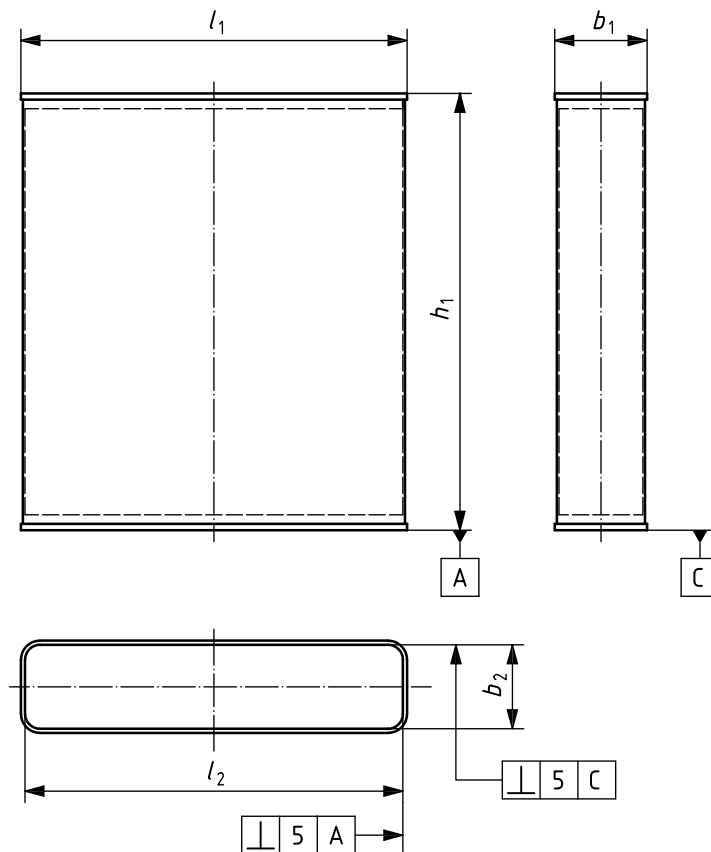

NOTE Squareness tolerance is in conformity with ISO 1101.

Figure 1 — Sliver cans

Table 1 — Main dimensions of rectangular sliver cans

Dimensions in millimetres

l_1^a ± 3	l_2	b_1 $\begin{smallmatrix} 0 \\ -5 \end{smallmatrix}$	b_2	h_1^c ± 5
920	900	215	195	1 040
				1 070
				1 100
				1 200
		220 ^b	200 ^b	1 040
				1 070
				1 100
				1 200
		235 ^b	215 ^b	1 040
				1 070
				1 100
				1 200
250 ^b	230 ^b	1 040		
		1 070		
		1 100		
		1 200		
<p>^a Outer lengths l_1 greater than 920 mm shall be in increments of 100 mm.</p> <p>^b Preferred dimensions.</p> <p>^c Heights h_1 greater than 1 200 mm shall be in increments of 100 mm.</p>				

5 Designation

The designation for ordering a rectangular sliver can shall include the following information:

- a reference to this International Standard, i.e. ISO 16853:2009;
- the inner length, l_2 ;
- the inner width, b_2 ;
- the outer height, h_1 .

EXAMPLE Rectangular sliver can corresponding to Figure 1 and Table 1, with an inner length $l_2 = 900$ mm and inner width $b_2 = 215$ mm and with an outer height $h_1 = 1 070$ mm:

Rectangular sliver can ISO 16853 – 900 × 215 × 1 070

ICS 59.120.10

Price based on 3 pages