Aircraft — Tubing tolerances — Inch series

Aéronefs — Tolérances de tuyauterie — Série en inches



Reference number
ISO 12573:2010(E)

© ISO 2010

PDF disclaimer

This PDF file may contain embedded typefaces. In accordance with Adobe's licensing policy, this file may be printed or viewed but shall not be edited unless the typefaces which are embedded are licensed to and installed on the computer performing the editing. In downloading this file, parties accept therein the responsibility of not infringing Adobe's licensing policy. The ISO Central Secretariat accepts no liability in this area.

Adobe is a trademark of Adobe Systems Incorporated.

Details of the software products used to create this PDF file can be found in the General Info relative to the file; the PDF-creation parameters were optimized for printing. Every care has been taken to ensure that the file is suitable for use by ISO member bodies. In the unlikely event that a problem relating to it is found, please inform the Central Secretariat at the address given below.



COPYRIGHT PROTECTED DOCUMENT

© ISO 2010

All rights reserved. Unless otherwise specified, no part of this publication may be reproduced or utilized in any form or by any means, electronic or mechanical, including photocopying and microfilm, without permission in writing from either ISO at the address below or ISO's member body in the country of the requester.

ISO copyright office
Case postale 56 • CH-1211 Geneva 20
Tel. + 41 22 749 01 11
Fax + 41 22 749 09 47
E-mail copyright@iso.org
Web www.iso.org

Published in Switzerland

Contents

Page

Foreword	iv
Introduction.....	v
1 Scope	1
2 Normative references	1
3 Terms and definitions	1
4 Tubes in titanium and titanium alloys	4
4.1 Dimensions	4
4.2 Tolerances	4
5 Tubes in aluminium alloys	5
5.1 Dimensions	5
5.2 Tolerances	6
6 Tubes in corrosion resistant steel (CRES)	7
6.1 Dimensions	7
6.2 Tolerances	7
7 Tubes in nickel alloys	8
7.1 Dimensions	8
7.2 Tolerances	9

Foreword

ISO (the International Organization for Standardization) is a worldwide federation of national standards bodies (ISO member bodies). The work of preparing International Standards is normally carried out through ISO technical committees. Each member body interested in a subject for which a technical committee has been established has the right to be represented on that committee. International organizations, governmental and non-governmental, in liaison with ISO, also take part in the work. ISO collaborates closely with the International Electrotechnical Commission (IEC) on all matters of electrotechnical standardization.

International Standards are drafted in accordance with the rules given in the ISO/IEC Directives, Part 2.

The main task of technical committees is to prepare International Standards. Draft International Standards adopted by the technical committees are circulated to the member bodies for voting. Publication as an International Standard requires approval by at least 75 % of the member bodies casting a vote.

Attention is drawn to the possibility that some of the elements of this document may be the subject of patent rights. ISO shall not be held responsible for identifying any or all such patent rights.

ISO 12573 was prepared by Technical Committee ISO/TC 20, *Aircraft and space vehicles*, Subcommittee SC 10, *Aerospace fluid systems and components*.

Introduction

The purpose of this International Standard is to harmonize the dimensional tolerances used in the preparation of aerospace tubing. It is intended that future aerospace tubing standards refer to this International Standard for the purpose of defining dimensional tolerances.

International Standards use the International System of units (SI); however, large segments of the aerospace industry make use of other measurement systems as a matter of common working practice. The title of this International Standard (“Inch series”) reflects the fact that nominal sizes (see definition 3.1), which are in common use in the aerospace industry, were originally defined in terms of fractional inches.

Although tube sizes were originally defined (and are frequently cited) using non-SI units, all dimensions used in this International Standard are given in SI units, with inch units also indicated for the convenience of the user.

The decimal sign used in International Standards is the comma (“,”); however, the comma is not used in common working practice for inch dimensions. Therefore, in common with many other aerospace standards, the decimal point is used in this International Standard when providing dimensions in inches.

NOTE The use of non-SI units and the decimal point in this International Standard does not constitute general acceptance of measurement systems other than SI within International Standards.

Aircraft — Tubing tolerances — Inch series

1 Scope

This International Standard specifies the dimensional tolerances to be applied to round section inch series tubing used in aircraft.

2 Normative references

The following referenced documents are indispensable for the application of this document. For dated references, only the edition cited applies. For undated references, the latest edition of the referenced document (including any amendments) applies.

ISO 8575, *Aerospace — Fluid systems — Hydraulic system tubing*

3 Terms and definitions

For the purposes of this document, the following terms and definitions apply.

3.1

nominal size

dash number

d_N

non-dimensional characteristic which identifies the size of the parts of a fluid system

NOTE For a tube, the nominal size corresponds to the nominal value of the outside diameter, expressed in sixteenths of an inch (1,59 mm).

EXAMPLE -04 corresponds to 4/16 in = 0.250 in = 6,35 mm.

3.2

outside diameter

d_1

distance between any two points at 180° to each other around the outside of a single section across the tube

NOTE Unless otherwise specified, the limits on the outside diameter therefore include all allowances for ovality (lack of circularity).

See Figure 1.

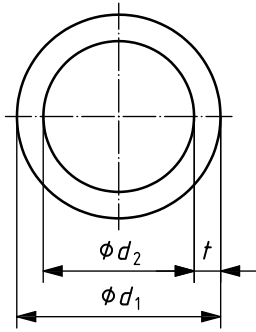

Key

- d_1 outside diameter
- d_2 inside diameter
- t wall thickness

Figure 1 — Outside diameter, inside diameter and wall thickness

3.3

mean outside diameter

arithmetic mean of two measurements of the outside diameter, taken at right angles to each other around a single section across the tube

NOTE Where a mean outside diameter is specified, a limitation on ovality is also specified.

See Figure 2.

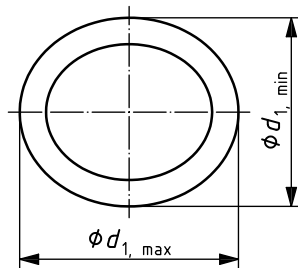

Key

- $d_{1,max}$ maximum outside diameter
- $d_{1,min}$ minimum outside diameter

mean outside diameter: $\frac{d_{1,max} - d_{1,min}}{2}$

ovality: $d_{1,max} - d_{1,min}$

Figure 2 — Mean outside diameter and ovality

3.4

inside diameter

d_2
distance between any two points at 180° to each other around the inside of a single section across the tube

NOTE Unless otherwise specified, the limits on the inside diameter shall include all allowances for ovality (lack of circularity).

See Figure 1.

3.5 wall thickness

t

thickness measured at a right angle across the tube wall

See Figure 1.

3.6 ovality

difference between the larger and smaller measures of the outside diameter where these are taken at right angles to each other around a single section across the tube

See Figure 2.

3.7 concentricity

lack of coaxiality

axis of the outside diameter being non-coincident with the axis of the inside diameter

NOTE As the position of the axes is difficult to determine in practice, it is defined as half the variation in wall thickness at any two points at 180° to each other around a single section of the tube. Unless otherwise specified, the allowance for concentricity is contained with the permitted variation of wall thickness.

See Figure 3.

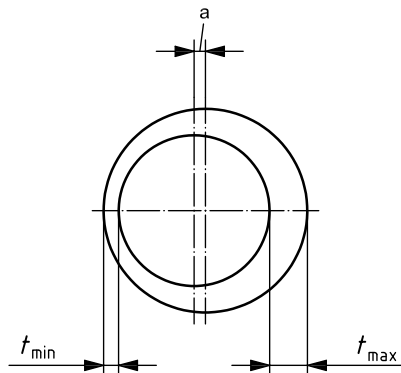

Key

t_{\max} maximum wall thickness

t_{\min} minimum wall thickness

a concentricity: $\frac{t_{\max} - t_{\min}}{2}$

Figure 3 — Concentricity

3.8 straightness

maximum curvature (depth of arc) permissible in a specified length

See Figure 4.

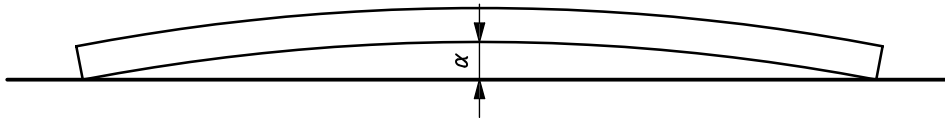

Key
 α depth of arc

Figure 4 — Straightness

4 Tubes in titanium and titanium alloys

4.1 Dimensions

For nominal sizes and thicknesses, the standard dimensions shall be as given in ISO 8575.

4.2 Tolerances

4.2.1 General

It is usual practice to specify tolerances on the outside diameter and one of the other two dimensional characteristics, i.e. the inside diameter and the wall thickness.

Where other specifications refer to this specification for tolerances, they shall make clear whether 4.2.3 or 4.2.4, or in special cases both, are applicable.

4.2.2 Tolerances on the outside diameter

Unless otherwise specified in the order, the tolerances on the outside diameter shall be as shown in Table 1.

Table 1 — Outside diameter tolerances — Titanium tubes

Nominal size d_N	Tolerances on outside diameter	
	mm	in
$d_N \leq -06$	+0,076 -0	+0.003 -0
$-06 < d_N \leq -10$	+0,102 -0	+0.004 -0
$-10 < d_N \leq -12$	+0,102 -0,025	+0.004 -0.001
$-12 < d_N \leq -24$	+0,102 -0,051	+0.004 -0.002
$-24 < d_N \leq -32$	+0,130 -0,050	+0.005 -0.002

4.2.3 Tolerances on inside diameter

Unless otherwise specified in the order, the tolerances on the inside diameter shall be as shown in Table 2.

Table 2 — Inside diameter tolerances — Titanium tubes

Nominal size d_N	Tolerances on inside diameter	
	mm	in
$d_N \leq -06$	$\pm 0,038$	$\pm 0.001\ 5$
$-06 < d_N \leq -08$	$\pm 0,051$	$\pm 0.002\ 0$
$-08 < d_N \leq -12$	$\pm 0,064$	$\pm 0.002\ 5$
$-12 < d_N \leq -20$	$\pm 0,076$	$\pm 0.003\ 0$
$-20 < d_N \leq -32$	$\pm 0,102$	$\pm 0.004\ 0$

4.2.4 Tolerances on wall thickness

Unless otherwise specified in the order, the actual thickness shall be not less than 95 % of the nominal thickness.

4.2.5 Tolerances on ovality

Unless otherwise specified in the order, the maximum and minimum values of the outside diameter shall remain within the limits in Table 1 and there shall be no additional allowance for ovality.

4.2.6 Tolerances on concentricity

Unless otherwise specified in the order, no additional concentricity shall be permitted beyond the limits of wall thickness defined in 4.2.4.

4.2.7 Tolerances on straightness

Unless otherwise specified in the order, the tube shall be of such straightness that the maximum curvature (depth of arc) shall not exceed the limits set out in Table 3.

Table 3 — Straightness tolerances — Titanium tubes

Tube length		Maximum permissible depth of arc	
mm	in	mm	in
300	12	0,62	0.025
1 500	60	3,00	0.125

4.2.8 Tolerances on fixed lengths

Unless otherwise specified in the order, for tube ordered in fixed lengths of less than 7,3 m (24 ft), the tolerance on length shall be $\left(\begin{smallmatrix} +3,2 \\ -0 \end{smallmatrix} \right) \text{ mm} \left[\left(\begin{smallmatrix} +0.125 \\ -0 \end{smallmatrix} \right) \text{ in} \right]$.

5 Tubes in aluminium alloys

5.1 Dimensions

For nominal sizes and thicknesses, the standard dimensions shall be as given in ISO 8575.

5.2 Tolerances

5.2.1 Tolerances on outside diameter

Unless otherwise specified in the order, the tolerances on the outside diameter shall be as shown in Table 4.

Table 4 — Outside diameter tolerances — Aluminium alloy tubes

Nominal size d_N	Tolerances on outside diameter	
	mm	in
$d_N \leq -08$	$\pm 0,08$	± 0.003
$-08 < d_N \leq -16$	$\pm 0,10$	± 0.004
$-16 < d_N \leq -32$	$\pm 0,13$	± 0.005
$-32 < d_N \leq -48$	$\pm 0,15$	± 0.006

5.2.2 Tolerances on wall thickness

Unless otherwise specified in the order, the tolerance on wall thickness shall be as shown in Table 5.

Table 5 — Wall thickness tolerances — Aluminium alloy tubes

Nominal wall thickness of tube		Tolerances on wall thickness	
mm	in	mm	in
$0,25 < t \leq 0,89$	$0.010 < t \leq 0.035$	$\pm 0,05$	± 0.002
$0,89 < t \leq 1,24$	$0.035 < t \leq 0.049$	$\pm 0,08$	± 0.003
$1,24 < t \leq 2,11$	$0.049 < t \leq 0.083$	$\pm 0,10$	± 0.004
$2,11 < t \leq 3,05$	$0.083 < t \leq 0.120$	$\pm 0,13$	± 0.005

5.2.3 Tolerances on ovality

Unless otherwise specified in the order, the maximum and minimum values of the outside diameter shall remain within the limits in Table 3 and there shall be no additional allowance for ovality, except where wall thickness is less than 3 % of the outside diameter. In such cases, the values of Table 3 are taken to represent the limits of mean outside diameter and an additional 1 % ovality may be permitted.

5.2.4 Tolerances on concentricity

Unless otherwise specified in the order, no additional concentricity shall be permitted beyond the limits of wall thickness defined in Table 5.

5.2.5 Tolerances on straightness

Unless otherwise specified in the order, the tube shall be of such straightness that the maximum curvature (depth of arc) shall not exceed the limits specified in Table 6.

Table 6 — Straightness tolerances — Aluminium alloy tubes

Tube size	Maximum permissible depth of arc	
	(in 1 m length) mm	(in 12 in length) in
$d_N \leq -06$	2,10	0.025
$-06 < d_N \leq -40$	0,83	0.010

5.2.6 Tolerances on fixed lengths

For tube ordered in fixed lengths of 3,7 m (12 ft) or less, the tolerance on length shall be:

$$\left(\begin{array}{c} +3,2 \\ -0 \end{array} \right) \text{mm} \left[\left(\begin{array}{c} +0.125 \\ -0 \end{array} \right) \text{in} \right].$$

For tube ordered in fixed lengths of 7,3 m (24 ft) or less, the tolerance on length shall be:

$$\left(\begin{array}{c} +6,3 \\ -0 \end{array} \right) \text{mm} \left[\left(\begin{array}{c} +0.250 \\ -0 \end{array} \right) \text{in} \right].$$

6 Tubes in corrosion resistant steel (CRES)

6.1 Dimensions

For nominal sizes and thicknesses, the standard dimensions shall be as given in ISO 8575.

6.2 Tolerances

6.2.1 Tolerances on outside diameter

Unless otherwise specified in the order, the tolerances on the outside diameter shall be as shown in Table 7.

Table 7 — Outside diameter tolerances — CRES tubes

Nominal size d_N	Tolerances on outside diameter	
	mm	in
$d_N \leq -08$	$\pm 0,08$	± 0.003
$-08 < d_N \leq -16$	$\pm 0,10$	± 0.004
$-16 < d_N \leq -24$	$\pm 0,13$	± 0.005
$-24 < d_N \leq -32$	$\pm 0,15$	± 0.006
$-32 < d_N \leq -40$	$\pm 0,20$	± 0.007
$-40 < d_N \leq -48$	$\pm 0,25$	± 0.010

6.2.2 Tolerances on thickness

Unless otherwise specified in the order, the tolerance on thickness is $\pm 10\%$.

6.2.3 Tolerances on ovality

Unless otherwise specified in the order, the maximum and minimum values of the outside diameter shall remain within the limits in Table 5 and there shall be no additional allowance for ovality.

6.2.4 Tolerances on concentricity

Unless otherwise specified in the order, no additional concentricity shall be permitted beyond the limits of wall thickness defined in 6.2.2.

6.2.5 Tolerances on straightness

Unless otherwise specified in the order, the tube shall be of such straightness that the maximum curvature (depth of arc) shall not exceed the limits specified in Table 8.

Table 8 — Straightness tolerances — CRES tubes

Tube length		Maximum permissible depth of arc	
mm	in	mm	in
300	12	0,62	0.025
1 500	60	3,00	0.125

6.2.6 Tolerances on fixed lengths

Unless otherwise specified in the order, for tube ordered in fixed lengths of less than 7,3 m (24 ft) the tolerance on length shall be $\left(\begin{smallmatrix} +3,2 \\ -0 \end{smallmatrix} \right) \text{mm} \left[\left(\begin{smallmatrix} +0.125 \\ -0 \end{smallmatrix} \right) \text{in} \right]$.

7 Tubes in nickel alloys

7.1 Dimensions

For nominal sizes and thicknesses, the standard dimensions are indicated in Table 9.

Table 9 — Nominal sizes and thicknesses for nickel alloy tubes

Nominal size d_N	Outside diameter d_1 mm (in)	Wall thickness t						
		0,71 mm (0.028 in)	0,81 mm (0.032 in)	0,89 mm (0.035 in)	0,99 mm (0.039 in)	1,07 mm (0.042 in)	1,14 mm (0.045 in)	1,24 mm (0.049 in)
-04	6,350 0 (0.250 0)	a	—	a	—	—	—	—
-05	7,937 5 (0.312 5)	a	—	a	—	—	—	—
-06	9,525 0 (0.375 0)	a	—	a	—	—	—	—
-08	12,700 0 (0.500 0)	a	—	a	—	a	—	a
-10	15,875 0 (0.625 0)	a	—	a	—	a	—	a
-12	19,050 0 (0.750 0)	a	—	a	—	a	—	a
-16	25,400 0 (1.000 0)	a	—	a	—	a	—	a
-20	31,750 0 (1.250 0)	a	—	a	—	a	—	a
-24	38,100 0 (1.500 0)	a	—	a	—	a	—	a
-28	44,450 0 (1.750 0)	a	—	a	—	a	—	a
-32	50,800 0 (2.000 0)	a	—	a	—	a	—	a
-40	63,500 0 (2.500 0)	—	—	—	—	—	—	—
-48	76,200 0 (3.000 0)	—	—	—	—	—	—	—
a Standard dimension.								

7.2 Tolerances

7.2.1 Tolerances on outside diameter

Unless otherwise specified in the order, the tolerances on the outside diameter shall be as shown in Table 10.

Table 10 — Outside diameter tolerances — Nickel alloy tubes

Nominal size d_N	Tolerances on outside diameter	
	mm	in
$d_N \leq -06$	$\pm 0,10$	± 0.004
$-06 < d_N \leq -10$	$\pm 0,13$	± 0.005
$-10 < d_N \leq -24$	$\pm 0,20$	± 0.007
$-24 < d_N \leq -48$	$\pm 0,25$	± 0.010

7.2.2 Tolerances on thickness

Unless otherwise specified in the order, the tolerance on thickness is $\pm 10\%$.

7.2.3 Tolerances on ovality

Unless otherwise specified in the order, the maximum and minimum values of the outside diameter shall remain within the limits in Table 7 and there shall be no additional allowance for ovality.

7.2.4 Tolerances on concentricity

Unless otherwise specified in the order, no additional concentricity shall be permitted beyond the limits of wall thickness defined in 7.2.2.

7.2.5 Tolerances on straightness

Unless otherwise specified in the order, the tube shall be of such straightness that the maximum curvature (depth of arc) shall not exceed the limits set out in Table 11.

Table 11 — Straightness tolerances — Nickel alloy tubes

Tube length		Maximum permissible depth of arc	
mm	in	mm	in
300	12	0,62	0.025
1 500	60	3,00	0.125

7.2.6 Tolerances on fixed lengths

Unless otherwise specified in the order, for tube ordered in fixed lengths of less than 7,3 m (24 ft) the tolerance on length shall be $\left(\begin{smallmatrix} +3,2 \\ -0 \end{smallmatrix} \right) \text{mm} \left[\left(\begin{smallmatrix} +0.125 \\ -0 \end{smallmatrix} \right) \text{in} \right]$.

ICS 49.080

Price based on 10 pages