

# INTERNATIONAL STANDARD

# ISO 8018

Second edition  
2007-02-01

---

---

## Tools for moulding — Guide bushes, headed, and locating guide bushes, headed

*Outils de moulage — Bagues de guidage, à collerette et à collerette  
avec plot de centrage*



Reference number  
ISO 8018:2007(E)

**PDF disclaimer**

This PDF file may contain embedded typefaces. In accordance with Adobe's licensing policy, this file may be printed or viewed but shall not be edited unless the typefaces which are embedded are licensed to and installed on the computer performing the editing. In downloading this file, parties accept therein the responsibility of not infringing Adobe's licensing policy. The ISO Central Secretariat accepts no liability in this area.

Adobe is a trademark of Adobe Systems Incorporated.

Details of the software products used to create this PDF file can be found in the General Info relative to the file; the PDF-creation parameters were optimized for printing. Every care has been taken to ensure that the file is suitable for use by ISO member bodies. In the unlikely event that a problem relating to it is found, please inform the Central Secretariat at the address given below.

© ISO 2007

All rights reserved. Unless otherwise specified, no part of this publication may be reproduced or utilized in any form or by any means, electronic or mechanical, including photocopying and microfilm, without permission in writing from either ISO at the address below or ISO's member body in the country of the requester.

ISO copyright office  
Case postale 56 • CH-1211 Geneva 20  
Tel. + 41 22 749 01 11  
Fax + 41 22 749 09 47  
E-mail [copyright@iso.org](mailto:copyright@iso.org)  
Web [www.iso.org](http://www.iso.org)

Published in Switzerland

## Foreword

ISO (the International Organization for Standardization) is a worldwide federation of national standards bodies (ISO member bodies). The work of preparing International Standards is normally carried out through ISO technical committees. Each member body interested in a subject for which a technical committee has been established has the right to be represented on that committee. International organizations, governmental and non-governmental, in liaison with ISO, also take part in the work. ISO collaborates closely with the International Electrotechnical Commission (IEC) on all matters of electrotechnical standardization.

International Standards are drafted in accordance with the rules given in the ISO/IEC Directives, Part 2.

The main task of technical committees is to prepare International Standards. Draft International Standards adopted by the technical committees are circulated to the member bodies for voting. Publication as an International Standard requires approval by at least 75 % of the member bodies casting a vote.

Attention is drawn to the possibility that some of the elements of this document may be the subject of patent rights. ISO shall not be held responsible for identifying any or all such patent rights.

ISO 8018 was prepared by Technical Committee ISO/TC 29, *Small tools*, Subcommittee SC 8, *Tools for pressing and moulding*.

This second edition cancels and replaces the first edition (ISO 8018:1985), of which it constitutes a minor revision. In particular, the references given in Clause 2, which are not mentioned in the text, have been listed in a Bibliography, and the indication of surface textures has been updated in accordance with ISO 1302:2002.



# Tools for moulding — Guide bushes, headed, and locating guide bushes, headed

## 1 Scope

This International Standard specifies the dimensions and tolerances, in millimetres, for headed guide bushes and headed locating guide bushes intended for use in moulds.

## 2 Dimensions

### 2.1 Guide bushes, headed — Type A

The dimensions of headed guide bushes of type A shall conform to the indications of Figure 1 and Table 1.

Surface roughness values in micrometres

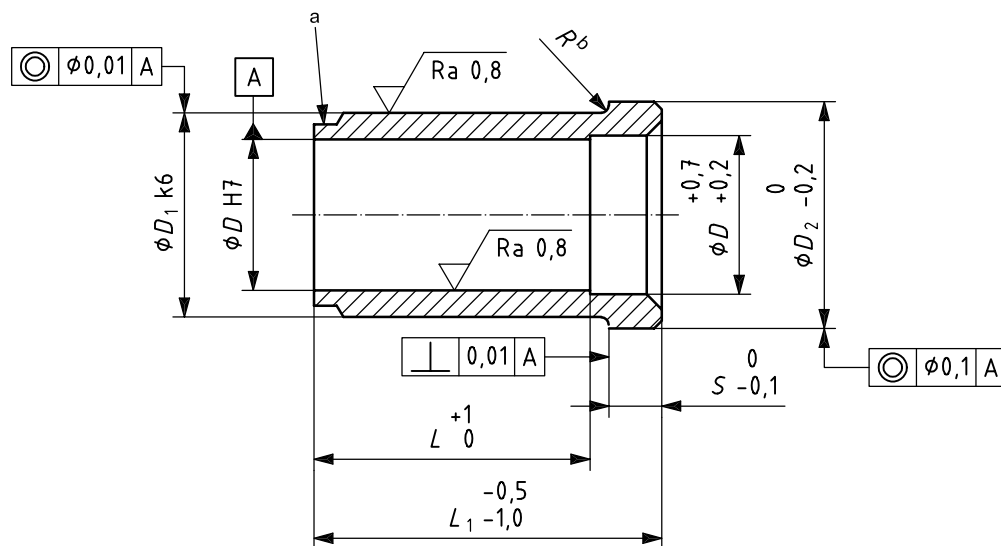

NOTE The sketch is an example only.

- a Chamfer and a cylindrical entry over  $\approx 3$  mm.  
 b  $R \leq 0,1S$ .

Figure 1 — Guide bushes, headed — Type A

**Table 1 — Dimensions of guide bushes, headed — Type A**

$D^a$	12	16	20	25	32	40	50
$D_1$	18	22	28	32	40	50	63
$D_2$	22	26	32	36	45	56	71
$S$	4	6	6	6	8	8	8
$L_1$	$L$						
16	16	16	16				
20	20	20	20	20			
25	25	25	25	25			
32	32	32	32	32	32		
40	32	40	40	40	40		
50	32	50	50	50	50		
63		63	63	63	63	63	
80		63	80	80	80	80	80
100			80	80	100	100	100
125					100	100	100
160						100	100
200						125	125

<sup>a</sup> For use in exceptional cases, for instance, to prevent incorrect assembly of the upper and lower plates of the mould in relation to each other, the following additional values for diameter  $D$  are recommended : 11, 15, 19, 24, 30, 38 and 48

## 2.2 Locating guide bushes, headed — Type B

The dimensions of headed locating guide bushes of type B shall conform to the indications of Figure 2 and Table 2.

Surface roughness values in micrometres

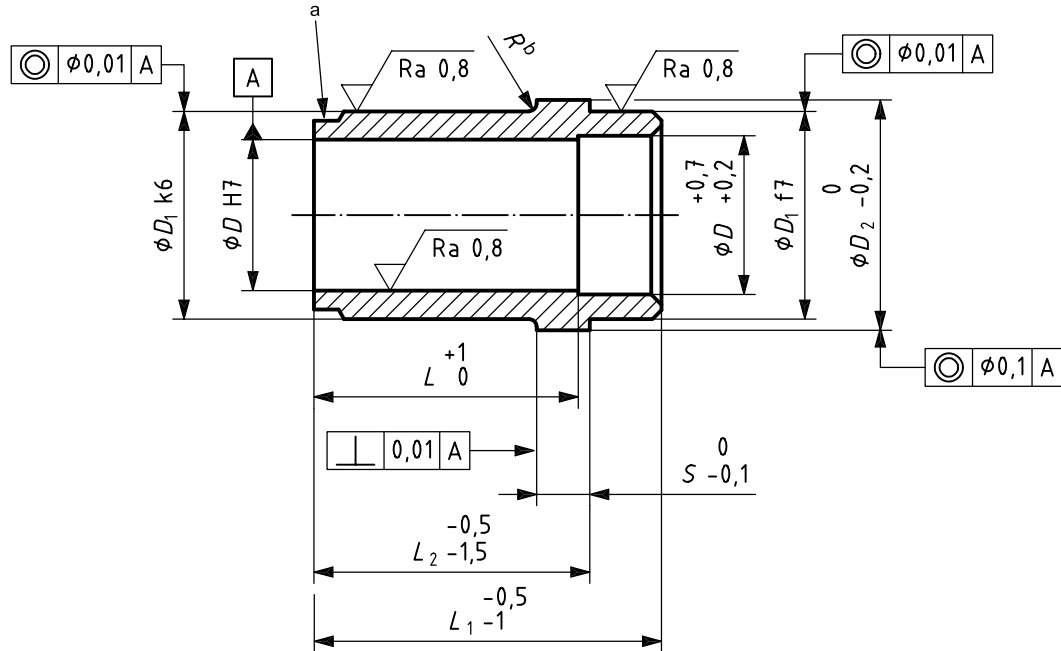

NOTE The sketch is an example only.

- a Chamfer and a cylindrical entry over  $\approx 3$  mm.
- b  $R \leq 0,1S$ .

Figure 2 — Locating guide bushes, headed — Type B

**Table 2 — Dimensions of locating guide bushes, headed — Type B**

$D^a$		12	16	20	25	32	40	50
$D_1$		18	22	28	32	40	50	63
$D_2$		22	26	32	36	45	56	71
$S$		4	6	6	6	8	8	8
$L_1$	$L_2$	$L$						
20	16	20						
25	20	25	25	25	25			
32	25	32	32	32	32			
40	32	32	32	40	40			
50	40	32	32	40	40	50		
60	50		40	40	40	50		
71	63		40	40	40	50		
90	80		50	50	63	63		
112	100			63	63	63	80	100
132	125			63	80	80	100	100
170	160			63	80	80	100	100
210	200						125	125

<sup>a</sup> For use in exceptional cases, for instance, to prevent incorrect assembly of the upper and lower plates of the mould in relation to each other, the following additional values for diameter  $D$  are recommended : 11, 15, 19, 24, 30, 38 and 48.

### 3 Designation

A guide bush in accordance with this International Standard shall be designated by:

- a) "guide bush";
- b) a reference to this International Standard;
- c) type of guide bush (A or B);
- d) its internal diameter ( $D$ );
- e) its length ( $L$ ).

EXAMPLE      **Guide bush ISO 8018 – A 12 × 20**

**Guide bush ISO 8018 – B 12 × 20**



## Bibliography

- [1] ISO 1302:2002, *Geometrical Product Specifications (GPS) — Indication of surface texture in technical product documentation*
- [2] ISO 4957:1999, *Tool steels*
- [3] ISO 6753-2:1998, *Tools for pressing and moulding — Machined plates — Part 2: Machined plates for moulds*
- [4] ISO 8017, *Tools for moulding — Guide pillars, straight and shouldered, and locating guide pillars, shouldered*

---

---

**ICS 25.120.30**

Price based on 5 pages