**Internal combustion engines —
Piston rings —**

**Part 2:
Half keystone rings made of cast iron**

Moteurs à combustion interne — Segments de piston —

Partie 2: Segments demi-trapézoïdaux fabriqués en fonte moulée



COPYRIGHT PROTECTED DOCUMENT

© ISO 2016, Published in Switzerland

All rights reserved. Unless otherwise specified, no part of this publication may be reproduced or utilized otherwise in any form or by any means, electronic or mechanical, including photocopying, or posting on the internet or an intranet, without prior written permission. Permission can be requested from either ISO at the address below or ISO's member body in the country of the requester.

ISO copyright office
Ch. de Blandonnet 8 • CP 401
CH-1214 Vernier, Geneva, Switzerland
Tel. +41 22 749 01 11
Fax +41 22 749 09 47
copyright@iso.org
www.iso.org

Contents

Page

Foreword	iv
Introduction	v
1 Scope	1
2 Normative references	1
3 Overview	1
4 Ring types and designation examples	1
4.1 Type HK — Straight faced half keystone ring 7°	1
4.1.1 General features	1
4.1.2 Designation	2
4.2 Type HKB — Barrel faced half keystone ring 7°	2
4.2.1 General features	2
4.2.2 Designation	4
4.3 Type HKBA — Asymmetrical barrel faced half keystone ring 7° ($h_1 \geq 1,2$ mm)	4
4.3.1 General features	4
4.3.2 Designation	5
5 Common features	5
5.1 Type HK, HKB and HKBA — Half keystone ring	5
5.1.1 Uncoated rings	5
5.1.2 Chromium plated or spray coated rings	6
5.2 Chamfered edges — Type HK, HKB and HKBA rings — Outside and/or inside chamfered edges (KA, KI)	7
5.3 Type HK, HKB and HKBA rings (fully faced, semi-inlaid) — Plating/coating thickness	7
6 Force factors	8
7 Dimensions and forces	8
Annex A (normative) Calculation of measurement width h_3 of half keystone rings	17
Bibliography	18

Foreword

ISO (the International Organization for Standardization) is a worldwide federation of national standards bodies (ISO member bodies). The work of preparing International Standards is normally carried out through ISO technical committees. Each member body interested in a subject for which a technical committee has been established has the right to be represented on that committee. International organizations, governmental and non-governmental, in liaison with ISO, also take part in the work. ISO collaborates closely with the International Electrotechnical Commission (IEC) on all matters of electrotechnical standardization.

The procedures used to develop this document and those intended for its further maintenance are described in the ISO/IEC Directives, Part 1. In particular the different approval criteria needed for the different types of ISO documents should be noted. This document was drafted in accordance with the editorial rules of the ISO/IEC Directives, Part 2 (see www.iso.org/directives).

Attention is drawn to the possibility that some of the elements of this document may be the subject of patent rights. ISO shall not be held responsible for identifying any or all such patent rights. Details of any patent rights identified during the development of the document will be in the Introduction and/or on the ISO list of patent declarations received (see www.iso.org/patents).

Any trade name used in this document is information given for the convenience of users and does not constitute an endorsement.

For an explanation on the meaning of ISO specific terms and expressions related to conformity assessment, as well as information about ISO's adherence to the WTO principles in the Technical Barriers to Trade (TBT) see the following URL: [Foreword - Supplementary information](#)

The committee responsible for this document is ISO/TC 22, *Road vehicles*, Subcommittee SC 34, *Propulsion, powertrain and powertrain fluids*.

This second edition cancels and replaces the first edition (ISO 6624-2:2003), which has been technically revised.

ISO 6624 consists of the following parts, under the general title *Internal combustion engines — Piston rings*:

- *Part 1: Keystone rings made of cast iron*
- *Part 2: Half keystone rings made of cast iron*
- *Part 3: Keystone rings made of steel*
- *Part 4: Half keystone rings made of steel*

Introduction

ISO 6624 is one of a number of series of International Standards dealing with piston rings for reciprocating internal combustion engines. Others are ISO 6621,[\[2\]](#)[\[3\]](#)[\[4\]](#)[\[5\]](#) ISO 6622,[\[6\]](#)[\[7\]](#) ISO 6623,[\[8\]](#) ISO 6625,[\[9\]](#) ISO 6626,[\[10\]](#)[\[11\]](#)[\[12\]](#) and ISO 6627.[\[13\]](#)

Internal combustion engines — Piston rings —

Part 2:

Half keystone rings made of cast iron

1 Scope

This part of ISO 6624 specifies the essential dimensional features of half keystone rings made of cast iron, types HK, HKB and HKBA, having nominal diameters from 38 mm up to, and including, 160 mm, used in reciprocating internal combustion piston engines for road vehicles and other applications.

2 Normative references

The following documents, in whole or in part, are normatively referenced in this document and are indispensable for its application. For dated references, only the edition cited applies. For undated references, the latest edition of the referenced document (including any amendments) applies.

ISO 6621-4, *Internal combustion engines — Piston rings — Part 4: General specifications*

3 Overview

The half keystone ring types are specified in [Tables 1](#) and [2](#) and [Figures 1](#) to [3](#). Their common features and the dimensions of those features are specified in [Tables 3](#) and [4](#) and [Figures 4](#) to [9](#). [Tables 5](#) and [6](#) give the force factors for the different ring types, while [Table 7](#) gives the dimensions and forces of half keystone rings.

The common features and dimensional tables presented in this part of ISO 6624 constitute a broad range of variables and, in selecting a particular ring type, the designer shall bear in mind the conditions under which it will be required to operate.

It is also essential that the designer refer to the specifications and requirements of ISO 6621-3^[4] and ISO 6621-4 before completing selection.

4 Ring types and designation examples

NOTE For the angle of half keystone rings, the same definition and measurement apply as for keystone rings (see ISO 6621-2).

4.1 Type HK — Straight faced half keystone ring 7°

4.1.1 General features

[Figure 1](#) shows the general features of piston ring type HK.

See [Table 7](#) for dimensions and forces.

h_3 values are calculated based on [Annex A](#).

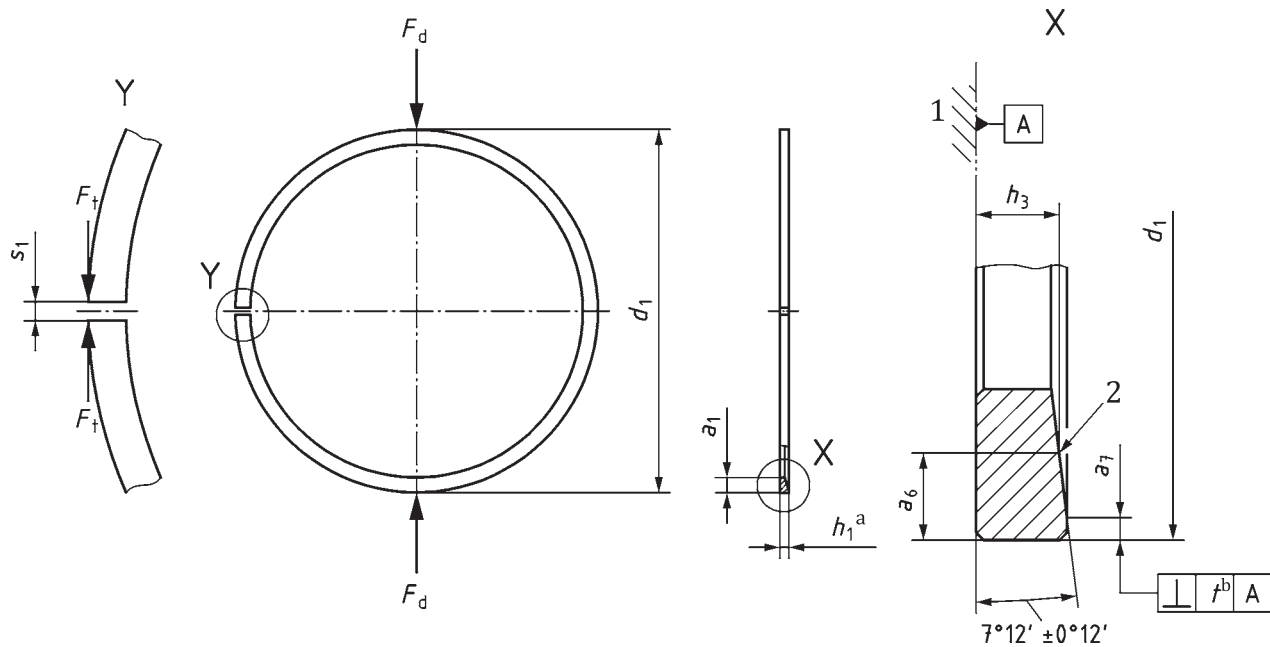

Key

- 1 reference plane (ring is positioned flat against datum A)
- 2 top side identification mark
- a Nominal.
- b $t = 0,006 \times h_1$.

Figure 1 — Type HK

4.1.2 Designation

EXAMPLE Designation of a piston ring complying with the requirements of ISO 6624-2, being a 7° half keystone ring made of cast iron, with a straight-faced peripheral surface (HK), of $d_1 = 90$ mm (90), of nominal ring width $h_1 = 1,5$ mm (1,5), made of heat treated martensitic spheroidal graphite cast iron, subclass 53 (MC53), and having a chromium plated peripheral surface with a minimum thickness 0,1 mm (CR2). Parameters in parenthesis are used in the ISO ring designation:

Piston ring ISO 6624-2 HK - 90 × 1,5 - MC53/CR2

4.2 Type HKB — Barrel faced half keystone ring 7°

4.2.1 General features

[Figure 2](#) shows the general features of piston ring type HKB.

See [Table 7](#) for dimensions and forces.

h_3 values are calculated based on [Annex A](#).

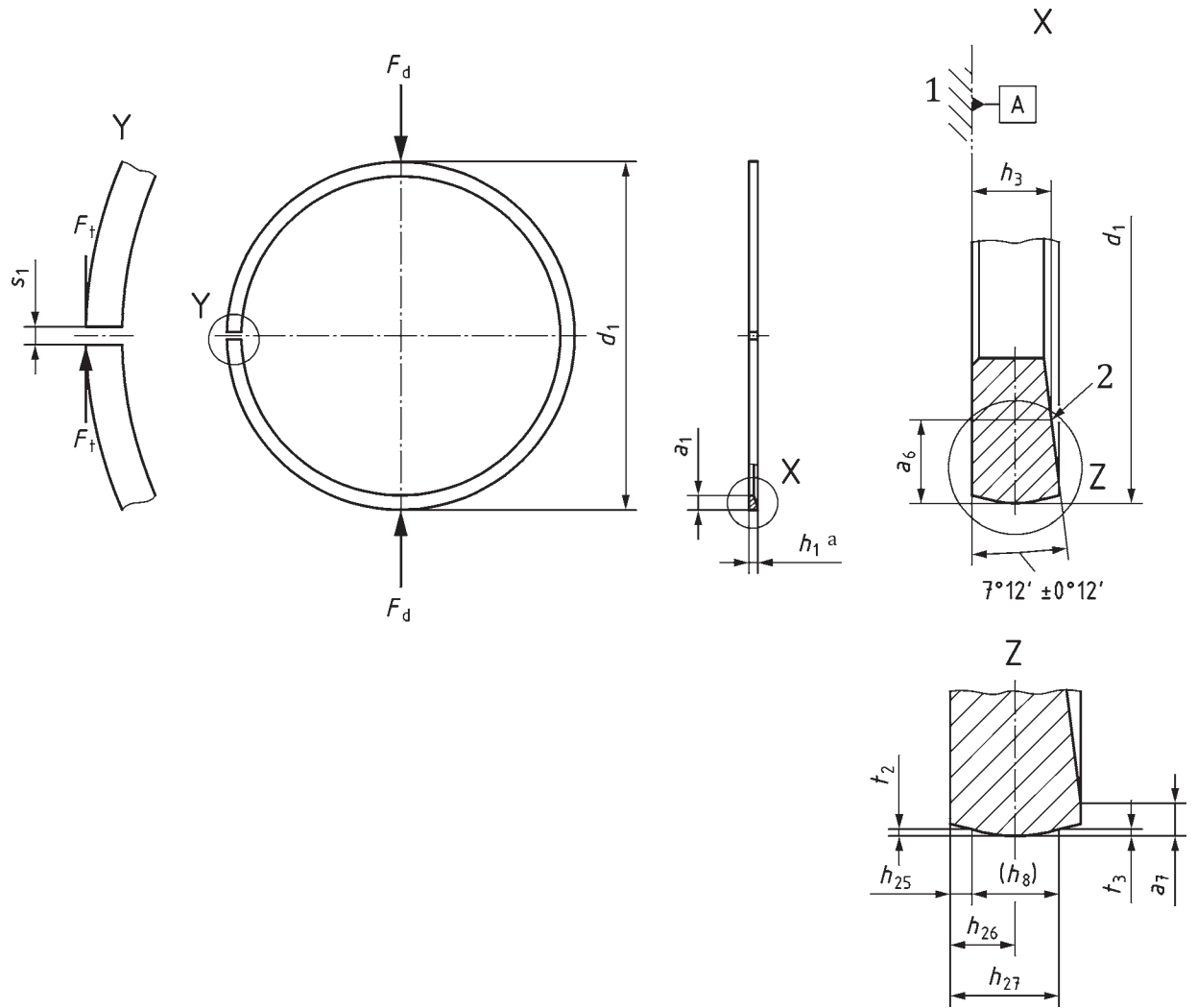

Key

- 1 reference plane (ring is positioned flat against datum A)
- 2 top side identification mark
- a Nominal.

Figure 2 — Type HKB

Table 1 — Symmetrical barrel dimensions and gauge width (h_8)

Dimensions in millimetres

h_1	h_{25}	h_{26}	h_{26} tol.	h_{27}	t_2, t_3	h_8^a	
1,2	0,30	0,60	±0,20	0,90	0,002...0,012	0,60	
1,5	0,35	0,75	±0,25	1,15		0,003...0,015	0,80
1,75	0,35	0,85	±0,30	1,35			1,00
2,0	0,40	1,00	±0,30	1,60			1,20
2,5	0,45	1,25	±0,40	2,05		1,60	
3,0	0,50	1,50	±0,50	2,50	0,005...0,020	2,00	
3,5	0,55	1,75	±0,50	2,95		2,40	

^a Gauge width (h_8) only informative; may be used only if agreed between the manufacturer and the customer.

4.2.2 Designation

EXAMPLE Designation of a piston ring complying with the requirements of ISO 6624-2, being a 7° half keystone ring made of cast iron, with a barrel faced peripheral surface (HKB), of $d_1 = 90$ mm (90), of nominal ring width $h_1 = 1,5$ mm (1,5), made of non-heat-treated grey cast iron, subclass 12 (MC12), and having a chromium plated peripheral surface with a minimum thickness of 0,1 mm (CR2). Parameters in parenthesis are used in the ISO ring designation:

Piston ring ISO 6624-2 HKB - 90 × 1,5 - MC12/CR2

4.3 Type HKBA — Asymmetrical barrel faced half keystone ring 7° ($h_1 \geq 1,2$ mm)

4.3.1 General features

See [Table 7](#) for dimensions and forces.

h_3 values are calculated based on [Annex A](#).

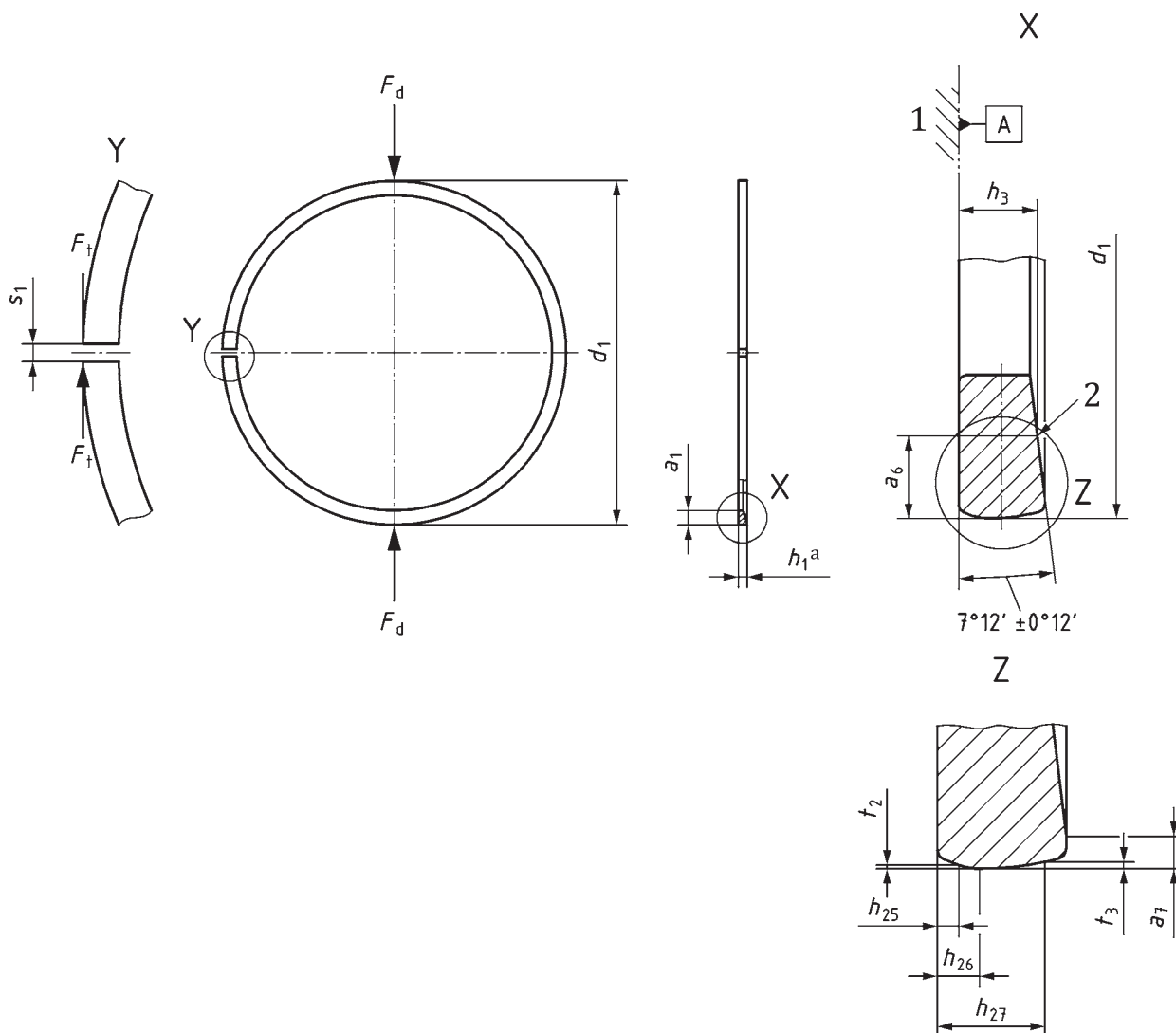

Key

- 1 reference plane (ring is positioned flat against datum A)
- 2 top side identification mark
- a Nominal.

Figure 3 — Type HKBA

Table 2 — Asymmetrical barrel dimensions

Dimensions in millimetres

h_1	h_{25}^a	h_{26}	h_{26} tol.	h_{27}	t_2^b	t_3^b
1,2	0,28	0,43	±0,15	0,90	0...0,005	0,005...0,016
1,5	0,35	0,50		1,15	0...0,006	0,007...0,022
1,75	0,35	0,55	±0,20	1,35	0...0,007	0,008...0,025
2,0	0,40	0,60		1,50		0,009...0,030
2,5	0,45	0,70	±0,25	1,80	0...0,008	0,011...0,035
3,0	0,55	0,80		2,10		0,012...0,038
3,5	0,60	0,90	±0,30	2,40	0...0,009	0,012...0,040

^a h_{25} may be lowered for rings with reduced edge dimensions.

^b t_2 and/or t_3 may be varied as agreed between the manufacturer and the customer.

4.3.2 Designation

EXAMPLE Designation of a piston ring complying with the requirements of ISO 6624-2, being a 7° half keystone ring made of cast iron, with an asymmetrical barrel faced peripheral surface (HKBA), of $d_1 = 90$ mm (90), of nominal ring width $h_1 = 1,5$ mm (1,5), made of non-heat-treated grey cast iron, subclass 12 (MC12), and having a chromium plated peripheral surface with a minimum thickness of 0,1 mm (CR2). Parameters in parenthesis are used in the ISO ring designation:

Piston ring ISO 6624-2 HKBA - 90 × 1,5 - MC12/CR2

5 Common features

5.1 Type HK, HKB and HKBA — Half keystone ring

5.1.1 Uncoated rings

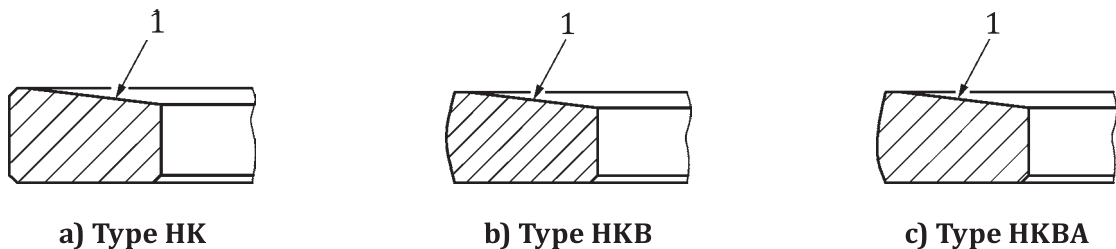

Key

1 top side identification mark

Figure 4 — Uncoated rings

5.1.2 Chromium plated or spray coated rings

5.1.2.1 Fully faced

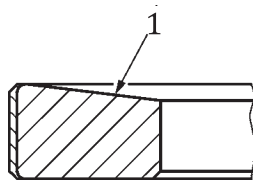

a) Type HK

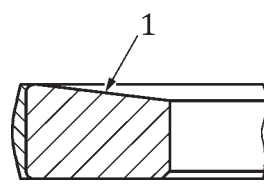

b) Type HKB

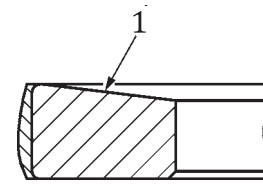

c) Type HKBA

Key

1 top side identification mark

Figure 5 — Fully faced rings

5.1.2.2 Semi-inlaid

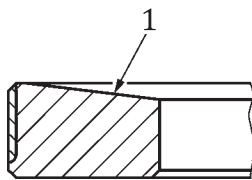

a) Type HK

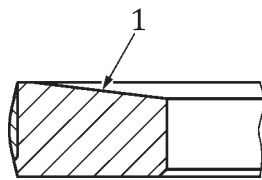

b) Type HKB

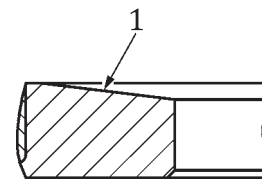

c) Type HKBA

Key

1 top side identification mark

Figure 6 — Semi-inlaid rings

5.1.2.3 Inlaid (not recommended for chromium plated rings)

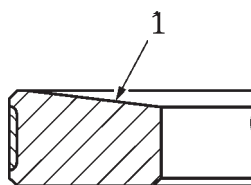

a) Type HK

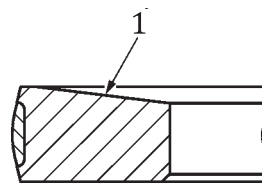

b) Type HKB

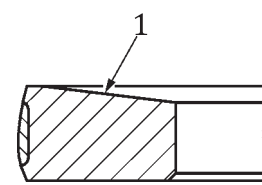

c) Type HKBA

Key

1 top side identification mark

Figure 7 — Inlaid rings

5.2 Chamfered edges — Type HK, HKB and HKBA rings — Outside and/or inside chamfered edges (KA, KI)

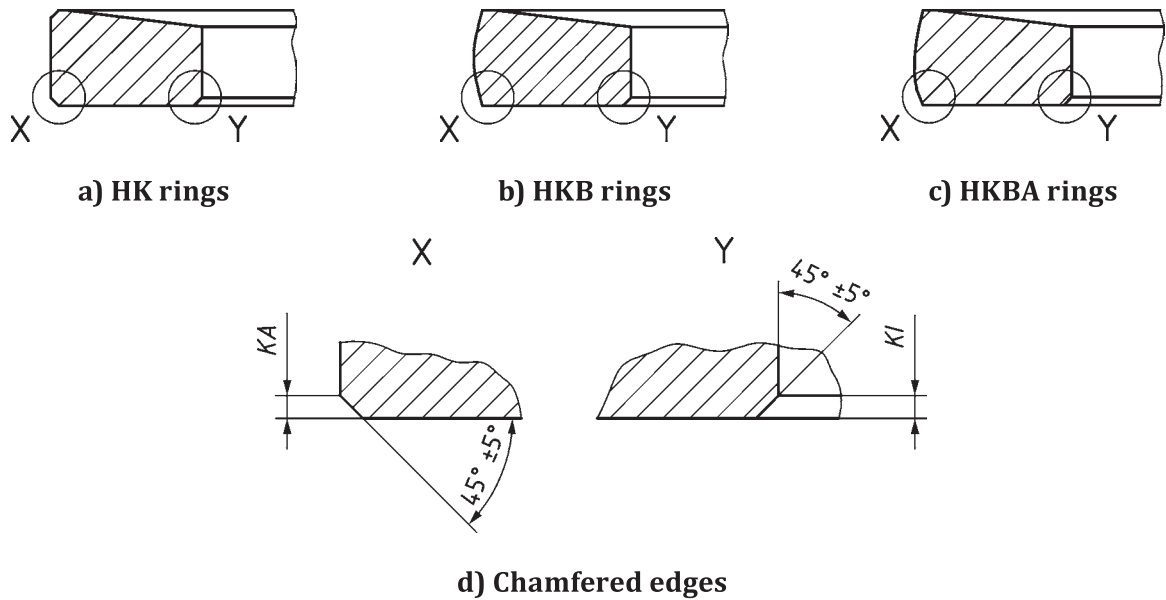

Key

1 top side identification mark

Figure 8 — Details of chamfered edges (KA, KI)

Table 3 — KA and KI dimensions

Dimensions in millimetres

d_1	KA	KI
$38 \leq d_1 < 50$	0,2 max.	0,2 max.
$50 \leq d_1 < 125$	$0,3 \pm 0,1$	$0,3 \pm 0,15$
$125 \leq d_1 \leq 160$	$0,4 \pm 0,1$	$0,4 \pm 0,15$

5.3 Type HK, HKB and HKBA rings (fully faced, semi-inlaid) — Plating/coating thickness

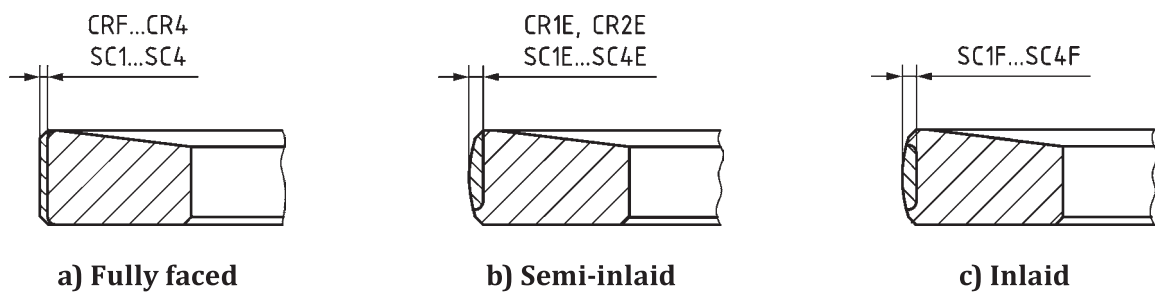

Figure 9 — Plating/coating thickness

Table 4 — Plating/coating thickness

Dimensions in millimetres

Chromium plating code	Spray coating code	Thickness min.
CRF	—	0,005
CR1	SC1	0,05
CR2	SC2	0,10
CR3 ^a	SC3 ^a	0,15
CR4 ^a	SC4 ^a	0,20

^a Not recommended for rings $h_1 \leq 1,5$.

6 Force factors

The tangential and diametral forces given in [Table 7](#) shall be corrected when additional features or materials other than grey cast iron with a modulus of elasticity, E_n , of 100 GN/m², or both, are used.

For common features, multiplier correction factors given in [Tables 5](#) and [6](#) and the force correction factors specified in ISO 6621-4 shall be used.

Table 5 — Force correction factors for HK, HKB and HKBA rings with features KA or KI

Factor	
KA	KI
0,98	0,98

Table 6 — Force correction factors for chromium plated and spray coated HK, HKB and HKBA rings (fully faced, semi-inlaid and inlaid type)

d_1 mm	Factor					
	CRF	CR1	CR2/SC1	CR3/SC2	CR4/SC3	SC4
$38 \leq d_1 < 50$	1	0,81	0,70	0,64	—	—
$50 \leq d_1 < 75$	1	0,90	0,85	0,81	0,75	0,71
$75 \leq d_1 < 100$	1	0,92	0,88	0,85	0,81	0,77
$100 \leq d_1 < 125$	1	0,94	0,91	0,88	0,86	0,83
$125 \leq d_1 \leq 160$	1	0,95	0,92	0,90	0,88	0,85

7 Dimensions and forces

See [Table 7](#).

Table 7 — Dimensions and forces of HK, HKB and HKBA half keystone rings

Dimensions in millimetres

Nominal diameter d_1	Radial wall thickness a_1		Nominal value of ring width h_1					a_6 Ref.	a_7	Method A					Method B																																									
										Measured value, h_3^{ab}					h_3 (ref.)					Measured value ^b a_6																																				
										For h_1 shown in column					Column																																									
										1	2	3	4	5	1	2	3	4	5	1	2	3	4	5	Tolerance																															
38	1,6	±0,15 Within a ring: 0,15 max.	1,2	—	—	—	0,6	1,169	—	—	—	—	—	—	—	—	—	1,16	0,69																																					
39	1,65						1,16																																																	
40	1,65						1,5											—		—	—	—	0,8	1,143	—	—	—	—	—	—	—	—	—	—	—																					
41	1,7																																			1,13																				
42	1,75																																			0,5 max.	—	—	—	—	—	—	—	—	—	—	—	—	—	—	—	—	—			
43	1,8																																																							
44	1,85																																																							
45	1,9																																																							
46	1,9						1,0											—		—	—	—	—	—	—	—	—	—	—	—	—	—	—	—	—																					
47	1,95																																																							
48	2																																																							
49	2,05																																																							
50	2,1	±0,15 Within a ring: 0,15 max.	1,2	—	—	—	—	—	—	—	—	—	—	—	—	—	—	—	—	—																																				
51	2,15																																																							
52	2,15																				1,5	—	—	—	—	—	—	—	—	—	—	—	—	—	—	—	—	—																		
53	2,2																																																							
54	2,25																																						0,6 max.	—	—	—	—	—	—	—	—	—	—	—	—	—	—	—	—	—
55	2,3																																																							
56	2,35																																																							
57	2,4																																																							
58	2,4																				1,0	—	—	—	—	—	—	—	—	—	—	—	—	—	—	—	—	—																		
59	2,45																																																							
60	2,5																																																							
61	2,55																																																							
62	2,6	0,6 max.	—	—	—	—	—	—	—	—	—	—	—	—	—	—	—	—	—																																					
63	2,65																																																							
64	2,65																																																							
65	2,7																																																							
66	2,75																																																							
67	2,8																			1,5	—	—	—	—	—	—	—	—	—	—	—	—	—	—	—	—	—																			
68	2,85																																																							
69	2,9																																																							
70	2,9																																																							
71	2,95	0,7 max.	—	—	—	—	—	—	—	—	—	—	—	—	—	—	—	—	—																																					
72	3																																																							
73	3,05																																																							
73	3,05																																																							

Table 7 — (continued)

Closed gap		Tangential force						Diametral force					Nominal diameter d_1			
s_1	Tolerance	F_t N					Tolerance	F_d N								
		For h_1 shown in column						For h_1 shown in column								
		1	2	3	4	5		1	2	3	4	5				
0,15	$+0,2$ 0	—	—					7,3	—					38		
								7,7						39		
		—	—					7,3						40		
								7,5						41		
		—	—					8,0	—					42		
								8,4						43		
								8,6						44		
		—	—					8,8						45		
								8,4						46		
		—	—					8,6	—					47		
								8,8						48		
								9,2						49		
				4,4	5,6					9,5	12,0				50	
				4,5	5,8					9,7	12,5				51	
				4,3	5,5					9,2	11,8				52	
				4,5	5,8	—	—			9,7	12,5	—	—		53	
				4,6	5,9				$\pm 30\%$ if $F_t < 10\text{ N}$	9,9	12,7				$\pm 30\%$ if $F_d < 21,5\text{ N}$	54
				4,7	6,1					10,1	13,1					55
				4,8	6,2					10,3	13,3					56
		5,0	6,4				$\pm 20\%$ if $F_t \geq 10\text{ N}$	10,8	13,8				$\pm 20\%$ if $F_d \geq 21,5\text{ N}$	57		
		4,8	6,2					10,3	13,3					58		
		4,9	6,3					10,5	13,5					59		
0,2	$+0,2$ 0	5,0	6,5					10,8	14,0					60		
		5,2	6,6					11,2	14,2					61		
		5,3	6,8					11,4	14,6					62		
		5,4	7,0					11,6	15,1					63		
		5,2	6,7					11,2	14,4					64		
		5,3	6,9					11,4	14,8					65		
		5,4	7,0					11,6	15,1					66		
		5,6	7,2					12,0	15,5					67		
		5,7	7,4					12,3	15,9					68		
		5,8	7,5					12,5	16,1					69		
		5,6	7,3	8,6	10,0				12,0	15,7	18,5	21,5		70		
5,8	7,5	8,9	10,3				12,5	16,1	19,1	22,1		71				
5,9	7,6	9,1	10,5				12,7	16,3	19,6	22,6		72				
6,0	7,8	9,2	10,7				12,9	16,8	19,8	23,0		73				

Table 7 — (continued)

Nominal diameter d_1	Radial wall thickness a_1	Nominal value of ring width h_1					a_6 Ref.	a_7	Method A							Method B						
		Column							Measured value, h_3^{ab}							h_3 (ref.)					Measured value ^b	
		Tolerance	1	2	3	4			5	For h_1 shown in column					Tolerance	1	2	3	4	5		a_6
74	3,1																					
75	3,15																					
76	3,15																					
77	3,2																					
78	3,25																					
79	3,3																					
80	3,35																					
81	3,4		1,2				—	1,5	1,053	1,353	1,603	1,853	—		1,04	1,34	1,59	1,84	—	1,60		
82	3,4																					
83	3,45																					
84	3,5																					
85	3,55	$\pm 0,15$																				0 -0,19
86	3,6	Within a		1,5	1,75	2,0																For phos - phated PO surface: +0,08 -0,19
87	3,65	ring:																				
88	3,65	0,15 max.																				
89	3,7																					
90	3,75																					
91	3,8																					
92	3,85							0,7 max.														
93	3,9																					
94	3,9		—						—	1,289	1,539	1,789	2,289		—	1,28	1,53	1,78	2,28			
95	3,95																					
96	4																					
97	4,05																					
98	4,1																					
99	4,15																					
100	4,15							2,0													2,07	
101	4,2																					
102	4,25																					
103	4,25	$\pm 0,20$																				
104	4,3	Within a	1,75	2,0	2,5	3,0	—		1,539	1,789	2,289	2,789	—	0	1,53	1,78	2,28	2,78	—		0	
105	4,35	ring:																				-0,23
106	4,4	0,20 max.																				For phos - phated PO surface: +0,08 -0,23
107	4,4																					
108	4,45																					
109	4,5																					

Table 7 — (continued)

Closed gap		Tangential force					Diametral force					Nominal diameter d_1							
s_1	Tolerance	F_t N					Tolerance	F_d N											
		For h_1 shown in column						For h_1 shown in column											
		1	2	3	4	5		1	2	3	4	5							
0,2	$^{+0,2}_0$	6,1	7,9	9,4	10,9	—	—	13,1	17,0	20,2	23,4	—	—	74					
0,25	$^{+0,25}_0$	6,2	8,0	9,5	11,1			13,3	17,2	20,4	23,9			75					
		6,0	7,8	9,3	10,8			12,9	16,8	20,0	23,2			76					
		6,2	8,0	9,5	11,1			13,3	17,2	20,4	23,9			77					
		6,3	8,1	9,7	11,2			13,5	17,4	20,9	24,1			78					
		6,4	8,3	9,8	11,4			13,8	17,8	21,1	24,5			79					
		6,4	8,4	10,0	11,6			13,8	18,1	21,5	24,9			80					
		6,6	8,6	10,3	11,9			14,2	18,5	22,1	25,6			81					
		6,4	8,4	10,0	11,6			13,8	18,1	21,5	24,9			82					
		6,5	8,5	10,1	11,8			14,0	18,3	21,7	25,4			83					
		6,6	8,6	10,3	12,0			14,2	18,5	22,7	25,8			84					
6,8	8,8	10,5	12,3	14,6	18,9			22,6	26,4	85									
6,8	8,9	10,7	12,4	14,6	19,1			23,0	26,7	86									
6,9	9,1	10,9	12,6	14,8	19,6			23,4	27,1	87									
6,8	8,9	10,6	12,3	14,6	19,1			22,8	26,4	88									
6,9	9,0	10,8	12,6	14,8	19,4			23,2	27,1	89									
0,3	$^{+0,25}_0$	—	9,1	10,9	12,7			16,3	—	—	19,6			23,4	27,3	35,0	—	—	90
			9,2	11,0	12,9			16,5			19,8			23,7	27,7	35,5			91
			9,4	11,2	13,1			16,8			20,2			24,1	28,2	36,1			92
			9,5	11,4	13,3	17,1	20,4	24,5			28,6	36,8	93						
		9,3	11,1	13,0	16,7	20,0	23,9	28,0	35,9	94									
		—	9,5	11,3	13,2	17,0	—	—	20,4	24,3	28,4	36,6	—	—	95				
			9,6	11,5	13,5	17,3			20,6	24,7	29,0	37,2			96				
			9,7	11,7	13,6	17,5			20,9	25,2	29,2	37,6			97				
			9,9	11,9	13,9	17,8			21,3	25,6	29,9	38,3			98				
			10,0	12,0	14,0	18,0			21,5	25,8	30,1	38,7			99				
		—	11,8	13,7	17,7	21,6	—	—	25,3	29,5	38,1	46,4	—	—	100				
			11,9	13,9	17,9	21,9			25,6	29,9	38,5	47,1			101				
			12,1	14,1	18,2	22,3			26,0	30,3	39,1	47,9			102				
			12,2	14,3	18,4	22,5			26,3	30,7	39,6	48,4			103				
12,0	14,0		18,1	22,1	25,8	30,1			38,9	47,5	104								
12,1	14,2		18,3	22,3	26,0	30,5			39,3	47,9	105								
12,2	14,3		18,5	22,6	26,3	30,7			39,8	48,6	106								
12,0	14,0		18,1	22,2	25,8	30,1			38,9	47,7	107								
12,1	14,2	18,3	22,4	26,1	30,5	39,3	48,2	108											
12,2	14,3	18,5	22,7	26,3	30,7	39,8	48,8	109											

Table 7 — (continued)

Nominal diameter d_1	Radial wall thickness a_1	Nominal value of ring width h_1					a_6 Ref.	a_7	Method A							Method B										
		Column							Measured value, $h_3^{a,b}$							h_3 (ref.)					Measured value ^b a_6					
		1	2	3	4	5			For h_1 shown in column					Tolerance	Column				Tolerance							
1	2	3	4	5	1	2	3	4	5	Tolerance	1	2	3	4	5	Tolerance										
110	4,55																									
111	4,55																									
112	4,6																									
113	4,65																									
114	4,7																									
115	4,7																									
116	4,75																									
117	4,8																									
118	4,85																									
119	4,85																									
120	4,9		2,0											1,789												
121	4,95																									
122	4,95																									
123	5																									
124	5,05																									
125	5,05																									
126	5,1																									
127	5,15	±0,20																								
128	5,2	Within a																								
129	5,2	ring:	—		2,5	3,0	3,5	2,0	0,7					2,289	2,789	3,289										
130	5,25	0,20 max.																								
131	5,3																									
132	5,3																									
133	5,35																									
134	5,4																									
135	5,4																									
136	5,45																									
137	5,5																									
138	5,5																									
139	5,55		—											—												
140	5,6																									
141	5,65																									
142	5,65																									
143	5,7																									
144	5,75																									
145	5,75																									
146	5,8																									
147	5,85																									

Table 7 — (continued)

Closed gap		Tangential force						Diametral force						Nominal diameter d_1				
s_1	Tolerance	F_t N					Tolerance	F_d N					Tolerance					
		For h_1 shown in column						For h_1 shown in column										
		1	2	3	4	5		1	2	3	4	5						
0,35	$\pm 0,25$ 0	—	14,5	18,7	22,9	27,1	$\pm 30\%$ if $F_t < 10$ N	—	31,2	40,2	49,2	58,3	$\pm 30\%$ if $F_d < 21,5$ N	110				
			14,2	18,4	22,5	26,6			30,5	39,6	48,4	57,2		111				
			14,4	18,6	22,8	27,0			31,0	40,0	49,0	58,1		112				
			14,6	18,8	23,1	27,3			31,4	40,4	49,7	58,7		113				
			14,7	19,1	23,4	27,7			31,6	41,1	50,3	59,6		114				
		—	14,5	18,7	23,0	27,2		$\pm 20\%$ if $F_t \geq 10$ N	—	31,2	40,2	49,5		58,5	$\pm 20\%$ if $F_d \geq 21,5$ N	115		
			14,6	18,9	23,1	27,4				31,4	40,6	49,7		58,9		116		
			14,8	19,1	23,4	27,8				31,8	41,1	50,3		59,8		117		
			14,5	18,7	23,0	27,2				31,2	40,2	49,5		58,5		118		
			14,7	19,0	23,3	27,6				31,6	40,9	50,1		59,3		119		
		—	14,8	19,2	23,6	28,0			$\pm 30\%$ if $F_t < 10$ N	—	31,8	41,3		50,7		60,2	$\pm 30\%$ if $F_d < 21,5$ N	120
			15,0	19,5	23,9	28,3					32,3	41,9		51,4		60,8		121
			14,7	19,1	23,5	27,8					31,6	41,1		50,5		59,8		122
			14,9	19,3	23,8	28,2					32,0	41,5		51,2		60,6		123
15,0	19,5		23,9	28,4	32,3	41,9	51,4				61,1	124						
—	14,7	19,1	23,5	27,9	$\pm 20\%$ if $F_t \geq 10$ N	—	31,6			41,1	50,5	60,0	$\pm 20\%$ if $F_d \geq 21,5$ N	125				
	14,9	19,4	23,8	28,2			32,0			41,7	51,2	60,6		126				
	15,1	19,6	24,1	28,6			32,5			42,1	51,8	61,5		127				
	15,3	19,8	24,4	29,0			32,9			42,6	52,5	62,4		128				
	15,0	19,5	24,0	28,4			32,3	41,9		51,6	61,1	129						
0,4	$\pm 0,25$ 0	—	19,6	24,2		28,7	$\pm 30\%$ if $F_t < 10$ N	—		42,2	51,9	61,7		$\pm 30\%$ if $F_d < 21,5$ N	130			
			19,9	24,4		29,0				42,7	52,6	62,4			131			
			19,5	24,0		28,5				41,9	51,6	61,3			132			
			19,7	24,2		28,7				42,3	52,0	61,7			133			
			19,9	24,5		29,1			42,8	52,7	62,6	134						
		—	19,5	24,1		28,6		$\pm 20\%$ if $F_t \geq 10$ N	—	42,0	51,7	61,5			$\pm 20\%$ if $F_d \geq 21,5$ N	135		
			19,8	24,4		28,9				42,5	52,4	62,1				136		
			20,0	24,6		29,3				43,0	53,0	63,0				137		
			19,6	24,2		28,8				42,2	52,1	61,9				138		
			19,9	24,5	29,1	42,7				52,7	62,6	139						
		—	20,1	24,7	29,4	$\pm 30\%$ if $F_t < 10$ N			—	43,1	53,2	63,2	$\pm 30\%$ if $F_d < 21,5$ N			140		
			20,2	25,0	29,7					43,5	53,7	63,9				141		
			19,9	24,5	29,2					42,8	52,7	62,8				142		
			20,1	24,8	29,5					43,1	53,3	63,4				143		
20,3	25,1		29,8	43,7	53,9		64,1			144								
—	20,0	24,6	29,3	$\pm 20\%$ if $F_t \geq 10$ N	—		42,9		53,0	63,0	$\pm 20\%$ if $F_d \geq 21,5$ N	145						
	20,1	24,9	29,6				43,3		53,5	63,6		146						
	20,3	25,1	29,9				43,7		54,0	64,3		147						

Table 7 — (continued)

Nominal diameter d_1	Radial wall thickness a_1	Nominal value of ring width h_1					a_6 Ref.	a_7	Method A Measured value, h_3^{ab}						Method B h_3 (ref.)						Measured value ^b			
		Column							For h_1 shown in column					Column					a_6	Tolerance				
		1	2	3	4	5			1	2	3	4	5	1	2	3	4	5						
148	5,85			2,5							2,289					2,28								
149	5,9																							
150	5,95																				0	0		
151	5,95	±0,20 Within a ring: 0,20 max.																			-0,23	-0,23		
152	6																							
153	6																							
154	6,05				3,0	3,5	2,0	0,7 max.					2,789	3,289					2,78	3,28	2,07		For phosphated PO surface: +0,08	
155	6,1				—								—										For phosphated PO surface: -0,23	
156	6,15																							
157	6,15																							
158	6,2																							
159	6,2																							
160	6,25																							

Table 7 — (continued)

Closed gap		Tangential force					Diametral force					Nominal diameter d_1		
s_1	Tolerance	F_t N					Tolerance	F_d N						
		For h_1 shown in column						For h_1 shown in column						
		1	2	3	4	5		1	2	3	4	5		
0,4	$+0,25$ 0	—	—	20,0	24,8	29,5	±30 % if $F_t < 10$ N ±20 % if $F_t \geq 10$ N	—	—	43,1	53,2	63,4	148	
				20,2	25,0	29,8				43,5	53,7	64,1		149
0,5	$+0,3$ 0				25,0	29,8		±30 % if $F_d < 21,5$ N				53,9	64,1	150
					25,0	29,8						53,9	64,1	151
		—	—	—	24,9	29,7			—	—	—	53,6	63,9	152
					24,9	29,7						53,6	63,9	153
					24,8	29,5						53,3	63,4	154
					25,0	29,8		±20 % if $F_d \geq 21,5$ N				53,8	64,1	155
					25,3	30,1						54,3	64,7	156
		—	—	—	25,3	30,1			—	—	—	54,3	64,7	157
					25,1	30,0					54,1	64,5	158	
					25,1	30,0					54,1	64,5	159	
		—	—	—	25,0	29,8	—	—	—	53,8	64,1	160		

NOTE 1 For intermediate sizes (for example repair sizes), the radial wall thickness of the next smaller nominal diameter should be applied.

NOTE 2 The values for F_t and F_d , given in Table 6, apply to grey cast iron with a typical modulus of elasticity (E_n) of 100 GN/m². Multiplying factors for materials having a different modulus of elasticity (E_n) are given in ISO 6621-4. Mean forces are calculated for nominal radial wall thickness (a_1) and mean ring width (h_1).

NOTE 3 For the sole purpose of this part of ISO 6624, the assumed average ratio F_d/F_t is 2,15. However, for rings up to 50 mm, the ratio F_d/F_t shall be determined between manufacturer and customer.

a h_3 values are calculated based on Annex A.

b These tolerances are based on single keystone machined rings.

Annex A (normative)

Calculation of measurement width h_3 of half keystone rings

The measurement width, h_3 , as defined in DIN is calculated according to Formula (A.1):

$$h_3 = (h_1 + 0,05) - a_6 \cdot \tan 7,2^\circ \quad (\text{A.1})$$

As the dimensioning of keystone rings in the ISO standard differs significantly from the dimensioning according to the old DIN standard and the tolerance values in the ISO standard have been increased, a correction value (h_{3k}) for the accurately calculated measurement width h_3 has been introduced to ensure continued compatibility of the rings according to the ISO standards. Therefore, the measurement width, h_3 , as defined in ISO is calculated according to Formula (A.2):

$$h_3 = (h_1 + 0,05) - a_6 \cdot \tan 7,2^\circ - h_{3k} \quad (\text{A.2})$$

The correction value, h_{3k} , is dependent on the nominal diameter, d_1 (see [Table A.1](#)):

Table A.1 — Correction value

Nominal diameter d_1 [mm]	Correction value h_{3k}
$d_1 < 60$	0,005 5
$60 \leq d_1 < 90$	0,007 5
$90 \leq d_1 \leq 160$	0,008 5

Bibliography

- [1] ISO 1101, *Technical drawings — Geometrical tolerancing — Tolerancing of form, orientation, location and run-out — Generalities, definitions, symbols, indications on drawings*
- [2] ISO 6621-1, *Internal combustion engines — Piston rings — Part 1: Vocabulary*
- [3] ISO 6621-2, *Internal combustion engines — Piston rings — Part 2: Inspection measuring principles*
- [4] ISO 6621-3, *Internal combustion engines — Piston rings — Part 3: Material specifications*
- [5] ISO 6621-5, *Internal combustion engines — Piston rings — Part 5: Quality requirements*
- [6] ISO 6622-1, *Internal combustion engines — Piston rings — Part 1: Rectangular rings made of cast iron*
- [7] ISO 6622-2, *Internal combustion engines — Piston rings — Part 2: Rectangular rings made of steel*
- [8] ISO 6623, *Internal combustion engines — Piston rings — Scraper rings made of cast iron*
- [9] ISO 6625, *Internal combustion engines — Piston rings — Oil control rings*
- [10] ISO 6626-1¹⁾, *Internal combustion engines — Piston rings — Coil spring loaded oil control rings*
- [11] ISO 6626-2, *Internal combustion engines — Piston rings — Part 2: Coil-spring-loaded oil control rings of narrow width made of cast iron*
- [12] ISO 6626-3, *Internal combustion engines — Piston rings — Part 3: Coil-spring-loaded oil control rings made of steel*
- [13] ISO 6627, *Internal combustion engines — Piston rings — Expander/segment oil-control rings*

1) To be published (revision of ISO 6626:1989).

