

INTERNATIONAL STANDARD

ISO 5429

Second edition
2005-04-01

Coated abrasives — Flap wheels with incorporated flanges or separate flanges

*Abrasifs appliqués — Roues à lamelles à flasques incorporés ou
amovibles*



Reference number
ISO 5429:2005(E)

© ISO 2005

PDF disclaimer

This PDF file may contain embedded typefaces. In accordance with Adobe's licensing policy, this file may be printed or viewed but shall not be edited unless the typefaces which are embedded are licensed to and installed on the computer performing the editing. In downloading this file, parties accept therein the responsibility of not infringing Adobe's licensing policy. The ISO Central Secretariat accepts no liability in this area.

Adobe is a trademark of Adobe Systems Incorporated.

Details of the software products used to create this PDF file can be found in the General Info relative to the file; the PDF-creation parameters were optimized for printing. Every care has been taken to ensure that the file is suitable for use by ISO member bodies. In the unlikely event that a problem relating to it is found, please inform the Central Secretariat at the address given below.

© ISO 2005

All rights reserved. Unless otherwise specified, no part of this publication may be reproduced or utilized in any form or by any means, electronic or mechanical, including photocopying and microfilm, without permission in writing from either ISO at the address below or ISO's member body in the country of the requester.

ISO copyright office
Case postale 56 • CH-1211 Geneva 20
Tel. + 41 22 749 01 11
Fax + 41 22 749 09 47
E-mail copyright@iso.org
Web www.iso.org

Published in Switzerland

Foreword

ISO (the International Organization for Standardization) is a worldwide federation of national standards bodies (ISO member bodies). The work of preparing International Standards is normally carried out through ISO technical committees. Each member body interested in a subject for which a technical committee has been established has the right to be represented on that committee. International organizations, governmental and non-governmental, in liaison with ISO, also take part in the work. ISO collaborates closely with the International Electrotechnical Commission (IEC) on all matters of electrotechnical standardization.

International Standards are drafted in accordance with the rules given in the ISO/IEC Directives, Part 2.

The main task of technical committees is to prepare International Standards. Draft International Standards adopted by the technical committees are circulated to the member bodies for voting. Publication as an International Standard requires approval by at least 75 % of the member bodies casting a vote.

Attention is drawn to the possibility that some of the elements of this document may be the subject of patent rights. ISO shall not be held responsible for identifying any or all such patent rights.

ISO 5429 was prepared by Technical Committee ISO/TC 29, *Small tools*, Subcommittee SC 5, *Grinding wheels and abrasives*.

This second edition cancels and replaces the first edition (ISO 5429:1977), which has been technically revised.

.....

Coated abrasives — Flap wheels with incorporated flanges or separate flanges

1 Scope

This International Standard specifies the nominal dimensions and limit deviations of flap wheels with incorporated flanges or separate flanges for use on stationary grinding machines.

2 Dimensions

See Figure 1 and Table 1.

3 Designation

Flap wheels with incorporated flanges or separate flanges conforming to this International Standard shall be designated by

- a) “Flap wheel”,
- b) reference to this International Standard, i.e. ISO 5429,
- c) incorporated flange version A or separate flange version B,
- d) the diameter of the flap wheel, D , in millimetres,
- e) the width of the flap wheel, T , in millimetres,
- f) the bore diameter, H for version A, in millimetres.

EXAMPLE A flap wheel with incorporated flange A, with diameter $D = 350$ mm, width $T = 75$ mm and bore diameter $H = 40$ mm is designated as follows:

Flap wheel ISO 5429 - A 350 × 75 × 40

4 Marking

Flap wheels with incorporated flanges or separate flanges shall be marked with the following information:

- a) manufacturer, supplier, importer or their registered trademark;
- b) dimensions;
- c) maximum operating speed;
- d) maximum permissible speed of rotation;
- e) grit size.

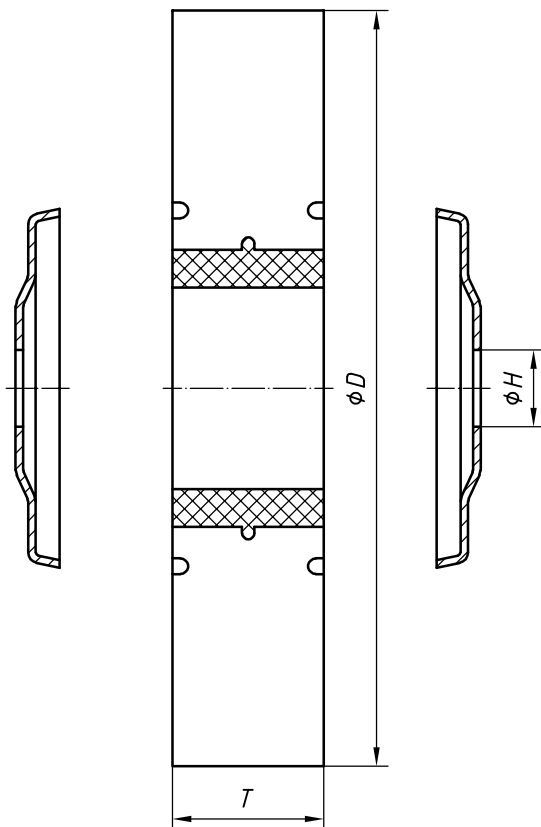

NOTE The sketch of the flange is given for information only, and does not prejudice the shape or the method of attaching the flange and the flap wheel.

Figure 1

Table 1 — Dimensions of flap wheels

Dimensions in millimetres

<i>T</i>	<i>D</i>								
	100	150	165	200	250	300	350	400	500
± 1									
25	X	X	X	X	X	X	—	—	—
50	X	X	X	X	X	X	X	X	—
75	—	X	X	X	X	X	X	X	—
100	—	—	—	—	—	—	X	X	X
<i>H</i>	a								
a The dimensions <i>H</i> are left to the manufacturer's discretion.									

ICS 25.100.70

Price based on 2 pages