

---

**INTERNATIONAL STANDARD**



**2587**

---

INTERNATIONAL ORGANIZATION FOR STANDARDIZATION • МЕЖДУНАРОДНАЯ ОРГАНИЗАЦИЯ ПО СТАНДАРТИЗАЦИИ • ORGANISATION INTERNATIONALE DE NORMALISATION

---

**Side and face milling cutters with plain bore and key drive —  
Metric series**

**First edition — 1972-12-01**

---

**UDC 621.914.28**

**Ref. No. ISO 2587-1972 (E)**

**Descriptors :** tools, cutting tools, milling cutters, dimensions.

Price based on 1 page

# Side and face milling cutters with plain bore and key drive – Metric series

## 1 SCOPE AND FIELD OF APPLICATION

This International Standard specifies the dimensions of metric series side and face milling cutters with plain bore and key drive, intended for fitting to cutter arbors.

It is applicable to cutters with straight teeth and cutters with double alternate helix (staggered tooth).

The range of outside diameters of these cutters is taken from ISO/R 523, *Recommended range of outside diameters for milling cutters*.

## 2 REFERENCE

ISO/R 240, *Interchangeability dimensions for milling cutters and cutter arbors or cutter mandrels – Metric series and inch series*.

## 3 DIMENSIONS

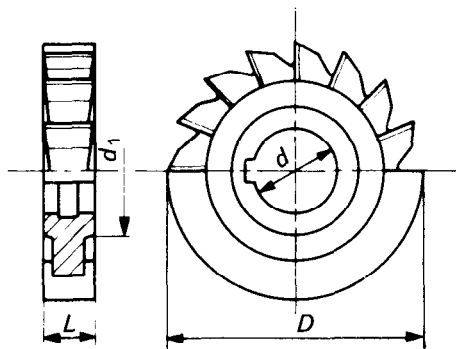

FIGURE 1 – Cutter with straight teeth

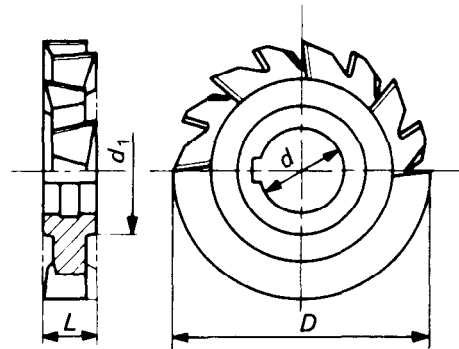

FIGURE 2 – Cutter with double alternate helix

Dimensions in millimetres

D j <sub>s</sub> 16	d H7	d <sub>1</sub> min.	L k11															
			4	5	6	8	10	12	14	16	18	20	22	25	28	32	36	40
50	16	27	X	X	X	X	X											
63	22	34	X	X	X	X	X	X	X	X								
80	27	41		X	X	X	X	X	X	X	X	X						
100	32	47			X	X	X	X	X	X	X	X	X	X				
125	32	47				X	X	X	X	X	X	X	X	X	X			
160	40	55					X	X	X	X	X	X	X	X	X	X		
200	40	55						X	X	X	X	X	X	X	X	X	X	X

The bore and keyway dimensions shall be in accordance with the metric series of ISO/R 240.

