**Conveyor belts with a textile carcass —
Total belt thickness and thickness of
constitutive elements — Test methods**

*Courroies transporteuses à carcasse textile — Épaisseur totale de la
courroie et épaisseur des éléments constitutifs — Méthodes d'essai*



Reference number
ISO 583:2007(E)

© ISO 2007

PDF disclaimer

This PDF file may contain embedded typefaces. In accordance with Adobe's licensing policy, this file may be printed or viewed but shall not be edited unless the typefaces which are embedded are licensed to and installed on the computer performing the editing. In downloading this file, parties accept therein the responsibility of not infringing Adobe's licensing policy. The ISO Central Secretariat accepts no liability in this area.

Adobe is a trademark of Adobe Systems Incorporated.

Details of the software products used to create this PDF file can be found in the General Info relative to the file; the PDF-creation parameters were optimized for printing. Every care has been taken to ensure that the file is suitable for use by ISO member bodies. In the unlikely event that a problem relating to it is found, please inform the Central Secretariat at the address given below.

© ISO 2007



COPYRIGHT PROTECTED DOCUMENT

© ISO 2007

All rights reserved. Unless otherwise specified, no part of this publication may be reproduced or utilized in any form or by any means, electronic or mechanical, including photocopying and microfilm, without permission in writing from either ISO at the address below or ISO's member body in the country of the requester.

ISO copyright office
Case postale 56 • CH-1211 Geneva 20
Tel. + 41 22 749 01 11
Fax + 41 22 749 09 47
E-mail copyright@iso.org
Web www.iso.org

Published in Switzerland

Contents

Page

Foreword.....	iv
1 Scope	1
2 Determination of total belt thickness.....	1
2.1 Apparatus	1
2.2 Test piece	1
2.3 Measurement points	2
2.4 Procedure	3
2.5 Expression of results	3
3 Determination of thickness of covers.....	3
3.1 General.....	3
3.2 Method used when covers can be removed completely from carcass.....	3
3.3 Method used when covers cannot be removed completely from carcass	5
4 Determination of carcass thickness	6
4.1 Carcass thickness without covers.....	6
4.2 Carcass thickness with covers	6
4.3 Expression of results	6
5 Determination of thickness of interlayer	6
5.1 General.....	6
5.2 Method used when elastomeric material in interlayer can be removed completely from adjacent fabric ply	6
5.3 Method for use when elastomeric material in interlayer cannot be separated completely from adjacent fabric ply	7
6 Test report	8
Bibliography	9

Foreword

ISO (the International Organization for Standardization) is a worldwide federation of national standards bodies (ISO member bodies). The work of preparing International Standards is normally carried out through ISO technical committees. Each member body interested in a subject for which a technical committee has been established has the right to be represented on that committee. International organizations, governmental and non-governmental, in liaison with ISO, also take part in the work. ISO collaborates closely with the International Electrotechnical Commission (IEC) on all matters of electrotechnical standardization.

International Standards are drafted in accordance with the rules given in the ISO/IEC Directives, Part 2.

The main task of technical committees is to prepare International Standards. Draft International Standards adopted by the technical committees are circulated to the member bodies for voting. Publication as an International Standard requires approval by at least 75 % of the member bodies casting a vote.

Attention is drawn to the possibility that some of the elements of this document may be the subject of patent rights. ISO shall not be held responsible for identifying any or all such patent rights.

ISO 583 was prepared by Technical Committee ISO/TC 41, *Pulleys and belts (including veebelts)*, Subcommittee SC 3, *Conveyer belts*.

This third edition of ISO 583 cancels and replaces ISO 583-1:1999, of which it constitutes a technical revision. It also incorporates the Technical Corrigendum, ISO 583-1:1999/Cor.1:2006.

Conveyor belts with a textile carcass — Total belt thickness and thickness of constitutive elements — Test methods

1 Scope

This International Standard specifies test methods for the determination of total belt thickness and the thickness of constitutive elements of conveyor belts having a textile carcass. The constitutive elements include the covers, the carcass and interlayers, i.e. the material between adjoining plies.

This International Standard is not suitable or valid for light conveyor belts as described in ISO 21183-1 [1].

2 Determination of total belt thickness

2.1 Apparatus

The apparatus shall consist of a flat, rigid baseplate, on which the test piece rests, and a gauge having a flat circular foot, 10 mm in diameter, by means of which a specified pressure is applied to the test piece.

The gauge shall be capable of measuring to at least 0,1 mm.

The pressure applied shall be (22 ± 5) kPa for materials with a hardness equal to or greater than 35 IRHD; otherwise, the pressure shall be (10 ± 2) kPa.

NOTE The masses needed to give these specified pressures using a 10 mm diameter foot are 176 g and 80 g, respectively.

2.2 Test piece

Either test piece 1 or test piece 2, according to the following, shall be used.

Test piece 1: cut a rectangular piece of full-width belt, designated as dimension L , with a length of 50 mm, as shown in Figure 1.



Figure 1 — Test piece 1 (rectangular)

Test piece 2: cut a wedge-shaped piece of full-width belt, designated as dimension L , as shown in Figure 2.

Dimensions in millimetres

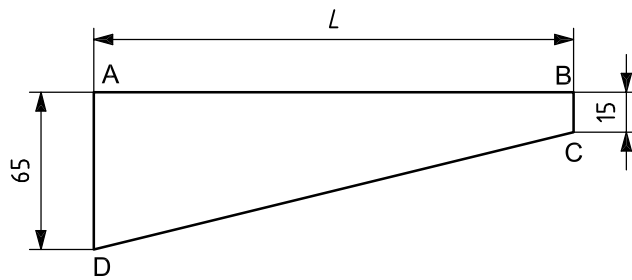

Figure 2 — Test piece 2 (wedge-shaped)

2.3 Measurement points

The measurement points shall be spaced equidistantly along the long axis of the test piece (i.e. the belt width), as shown in Figure 3.

Dimensions in millimetres

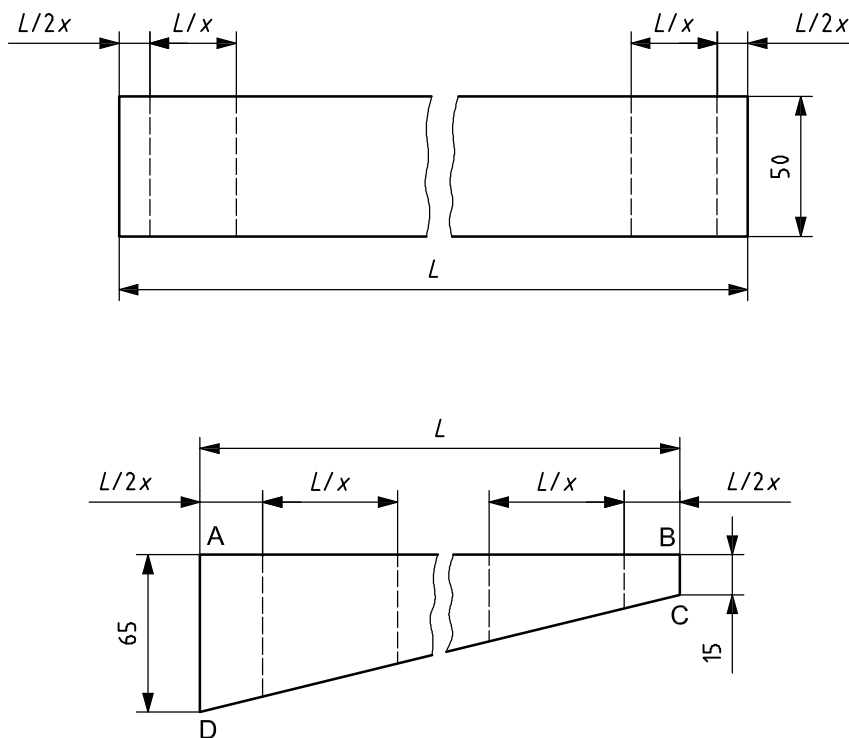

Figure 3 — Measurement points

Determine the minimum number of measurement points, x , according to the width of the belt, L , in accordance with Table 2.

Table 1 — Minimum number of measurement points

Belt width L mm	Minimum number of measurement points x
$L \leq 650$	3
$650 < L \leq 1\ 200$	5
$L > 1\ 200$	8

2.4 Procedure

Measure the total thickness, d , of the test piece at each of the measurement points specified in 2.3, using the pressure specified in 2.1.

2.5 Expression of results

Calculate the arithmetic mean of the individual measurements taken according to 2.4 and express this as the total belt thickness in millimetres, to the nearest 0,1 mm.

3 Determination of thickness of covers

3.1 General

The thickness of the covers can be obtained by two methods, the choice of one or the other method depending on whether or not the covers can be removed completely from the carcass.

3.2 Method used when covers can be removed completely from carcass

3.2.1 Principle

The thickness of a test piece is measured at a number of points, according to belt width, both before and after each of the covers has been removed. The cover thickness is calculated by subtraction.

3.2.2 Apparatus

The apparatus shall be in accordance with 2.1.

3.2.3 Test piece

Test piece 1, in accordance with 2.2 and Figure 1, shall be used.

3.2.4 Measurement points

The measurement points shall be in accordance with 2.3.

3.2.5 Procedure

Measure the total thickness, d , of the test piece at each of the measurement points, in accordance with 2.4.

Remove the top cover completely, then remeasure the thickness of the test piece, d_1 , at the same measurement points.

Then remove the bottom cover completely and measure the thickness of the test piece, d_2 , at the same measurement points.

See Figure 4.

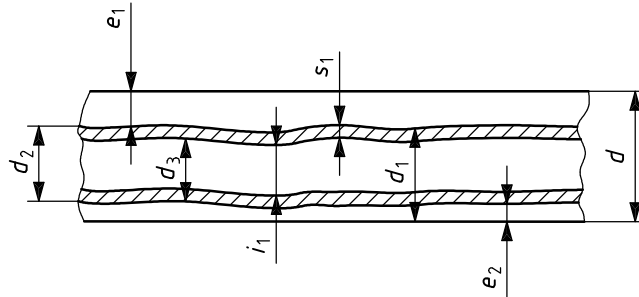

Key

- d total thickness
 - d_1 thickness of test piece with top cover removed
 - d_2 thickness of test piece with top and bottom covers removed
 - d_3 thickness of test piece with one fabric ply removed ^a
 - e_1 thickness of top cover
 - e_2 thickness of bottom cover
 - i_1 thickness of interlayer ^a
 - s_1 thickness of fabric ^a
- ^a Applicable to belts with two fabric plies (see 5.2.5 and 5.2.6).

Figure 4 — Interlayer thickness (plied fabric belt)

Protective fabrics embedded in the covers, and which do not form an integral part of the textile carcass, shall be regarded as part of the covers and should be removed with them. Other non-load bearing yarns, which are an integral part of the carcass, shall normally be regarded as part of the carcass, unless otherwise agreed between manufacturer and purchaser. In the latter case, full details shall be included in the test report.

3.2.6 Expression of results

Calculate the thickness, e_1 , of the top cover at each of the measurement points:

$$e_1 = d - d_1$$

Calculate the thickness, e_2 , of the bottom cover at each of the measurement points:

$$e_2 = d_1 - d_2$$

where

- d is the total belt thickness;
- d_1 is the thickness of the test piece with the top cover removed;
- d_2 is the thickness of the test piece with both top and bottom covers removed.

Calculate the arithmetic mean of the individual measurements and express the cover thicknesses in millimetres, to the nearest 0,1 mm.

3.3 Method used when covers cannot be removed completely from carcass

3.3.1 Principle

The thickness of each cover is measured directly on a cut edge of unstripped belt by means of an optical micrometer or travelling microscope.

3.3.2 Apparatus

Optical micrometer or travelling microscope incorporating a scale graduated in divisions of 0,1 mm.

3.3.3 Test piece

Cut the test piece in accordance with 2.2 (test piece 1 or test piece 2). If the conveyor belt is of solid woven construction, test piece 2 shall be used.

3.3.4 Measurement points

The measurement points shall be in accordance with 2.3. If test piece 2 is used, take measurements along line DC shown in Figure 2.

3.3.5 Procedure

Using the optical micrometer or travelling microscope (3.3.2), measure the distance between the surface of the belting and the top of the nearest fabric knuckle (see Figure 5) at each of the measurement points specified in 2.3. Ensure that the graduated scale of the optical micrometer or travelling microscope is in physical contact with the test piece to avoid errors of parallax.

With certain colours of cover material, difficulty can be experienced in determining the outline of the fabric knuckles. In these cases, the textile fabric may be identified with a colour stain.

Protective fabrics embedded in the covers, and which do not form an integral part of the textile carcass, shall be regarded as part of the covers and excluded from the measurements. Other non-load bearing yarns, which are an integral part of the carcass, shall normally be regarded as part of the carcass, unless otherwise agreed between manufacturer and purchaser. In the latter case, full details shall be included in the test report.

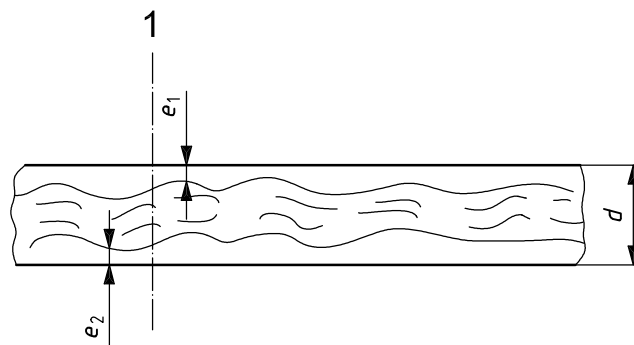

Key

- d total thickness
- e_1 thickness of top cover
- e_2 thickness of bottom cover
- 1 target measurement point

Figure 5 — Cover thickness (solid woven belt)

3.3.6 Expression of results

Calculate the arithmetic mean of the individual measurements for each cover and report the result in millimetres, to the nearest 0,1 mm, as e_1 , the thickness of the top cover, and e_2 , the thickness of the bottom cover.

4 Determination of carcass thickness

4.1 Carcass thickness without covers

For belts where the covers can be removed completely, measure the carcass thickness, d_2 , in accordance with 3.2.

4.2 Carcass thickness with covers

For belts where the covers cannot be removed, obtain the carcass thickness by subtracting the thickness of both covers, measured in accordance with 3.3, from the total belt thickness measured in accordance with Clause 2.

4.3 Expression of results

Calculate carcass thickness d_2 at each of the measurement points:

$$d_2 = d - (e_1 + e_2)$$

where

d is the total belt thickness;

e_1 is the thickness of the top cover;

e_2 is the thickness of the bottom cover.

Calculate the arithmetic mean of the individual measurements and express carcass thickness d_2 in millimetres, to the nearest 0,1 mm.

5 Determination of thickness of interlayer

5.1 General

The thickness of an interlayer (i.e. the elastomeric material between textile fabric layers in a belt of multiply fabric construction) can be obtained using two methods, the choice of one or the other method depending on whether or not the elastomer can be completely separated from the fabric plies.

5.2 Method used when elastomeric material in interlayer can be removed completely from adjacent fabric ply

5.2.1 Principle

Thickness measurements are taken at a number of points across the belt width, after the covers have been removed, and again after separation of the fabric and elastomeric layers. The thicknesses of the interlayers are obtained by subtraction.

5.2.2 Apparatus

The apparatus shall be in accordance with 2.1.

5.2.3 Test piece

Test piece 1, in accordance with 2.2 and Figure 1, shall be used.

5.2.4 Measurement points

The measurement points shall be in accordance with 2.3.

5.2.5 Procedure

Measure carcass thickness d_2 of the test piece at each of the measurement points specified in 2.3, using the pressure in accordance with 2.1.

For belts with two fabric plies, remove one of these fabric plies and measure the thickness of the remaining test piece, d_3 , at the same measurement points (see Figure 4).

For belts with more than two fabric plies, continue removing fabric and elastomer, taking measurements at the specified points after each operation, until only one layer of fabric and elastomer remains.

5.2.6 Expression of results

For belts with two fabric plies, calculate the thickness of the interlayer, i_1 , at each of the measurement points.

$$i_1 = d_2 - (2 \times s_1)$$

where

d_2 is the carcass thickness;

s_1 is the thickness of the fabric and where

$$s_1 = d_2 - d_3$$

d_3 is the thickness of the test piece with one of two plies removed.

For belts with more than two fabric plies, calculate the thickness of each interlayer (i_2, i_3, \dots) in a similar manner.

Calculate the arithmetic mean of the individual measurements and express the interlayer thickness, i , in millimetres, to the nearest 0,1 mm (see Figure 4).

5.3 Method for use when elastomeric material in interlayer cannot be separated completely from adjacent fabric ply

5.3.1 Principle

The thickness of an interlayer is measured directly, on a cut edge of unstripped belt, by means of an optical micrometer or travelling microscope.

5.3.2 Apparatus

An optical micrometer or travelling microscope in accordance with 3.3.2.

5.3.3 Test piece

Cut the test piece, either 1 or 2, in accordance with 2.2.

5.3.4 Measurement points

The measurement points shall be in accordance with 2.3.

5.3.5 Procedure

Using the optical micrometer or travelling microscope (3.3.2), measure the thickness of the interlayer material by measuring the distance between each elastomer/fabric interface for that particular layer. Ensure that the graduated scale of the optical magnifier is in physical contact with the test piece in order to avoid errors of parallax.

Small differences in measurement caused by fabric undulations will be minimized by subsequent averaging of results. However, where the crimp of the fabric is sufficient to cause a significant difference, measurement points should be selected in a similar manner to those described in 2.3 to ensure that a minimum interlayer thickness is obtained.

5.3.6 Expression of results

Calculate the arithmetic mean of the individual measurements for a particular interlayer and report the result in millimetres, to the nearest 0,1 mm, as interlayer thickness i_1, i_2, i_3, \dots , as appropriate.

6 Test report

The test report shall contain the following information:

- a) reference to this International Standard (i.e. ISO 583);
- b) the identification of the conveyor belt tested;
- c) the number of measurement points;
- d) whether test piece 1 or test piece 2 was used;
- e) the test pressure value (where applicable);
- f) the result expressed in accordance with 2.5, 3.2.6, 3.3.6, 4.3, 5.2.6 or 5.3.6, as appropriate;
- g) the date of the test.

Bibliography

- [1] ISO 21183-1, *Light conveyor belts — Part 1: Principal characteristics and applications*

© ISO 2007. All rights reserved.

ICS 53.040.20

Price based on 9 pages