

INTERNATIONAL STANDARD

ISO
11

Second edition
1987-02-01



INTERNATIONAL ORGANIZATION FOR STANDARDIZATION
ORGANISATION INTERNATIONALE DE NORMALISATION
МЕЖДУНАРОДНАЯ ОРГАНИЗАЦИЯ ПО СТАНДАРТИЗАЦИИ

Aircraft — Ground pressure testing connections for pressure cabins

Aéronefs — Raccords pour essais de pressurisation au sol de la cabine des aéronefs

Reference number
ISO 11:1987 (E)

Foreword

ISO (the International Organization for Standardization) is a worldwide federation of national standards bodies (ISO member bodies). The work of preparing International Standards is normally carried out through ISO technical committees. Each member body interested in a subject for which a technical committee has been established has the right to be represented on that committee. International organizations, governmental and non-governmental, in liaison with ISO, also take part in the work.

Draft International Standards adopted by the technical committees are circulated to the member bodies for approval before their acceptance as International Standards by the ISO Council. They are approved in accordance with ISO procedures requiring at least 75 % approval by the member bodies voting.

International Standard ISO 11 was prepared by Technical Committee ISO/TC 20, *Aircraft and space vehicles*.

This second edition cancels and replaces the first edition (ISO 11 : 1980), of which it constitutes a minor revision.

Users should note that all International Standards undergo revision from time to time and that any reference made herein to any other International Standard implies its latest edition, unless otherwise stated.

Aircraft — Ground pressure testing connections for pressure cabins

1 Scope and field of application

This International Standard specifies the basic dimensional and access clearance requirements for pressure testing connections on pressurized aircraft for coupling with the hose unit or adaptor of ground pressurizing equipment. Three sizes of connection are specified as follows:

Connection bore	Recommended cabin volume
22,22 mm ¹⁾ (0.875 in)	Not exceeding 10 m ³ (300 ft ³)
46,04 mm (1.812 5 in)	10 to 45 m ³ (300 to 1 500 ft ³)
72,39 mm (2.85 in)	45 to 170 m ³ (1 500 to 6 000 ft ³)

2 Reference

ISO 725, *ISO inch screw threads — Basic dimensions*.

3 Requirements

3.1 Basic dimensions

The basic dimensions of the connections shall conform to the requirements of the figure.

3.2 Access clearance

The clearance allowed around the connections shall be in accordance with the figure.

1) The 22,22 mm (0.875 in) bore connection should be used as the fitting for ducting pressure testing

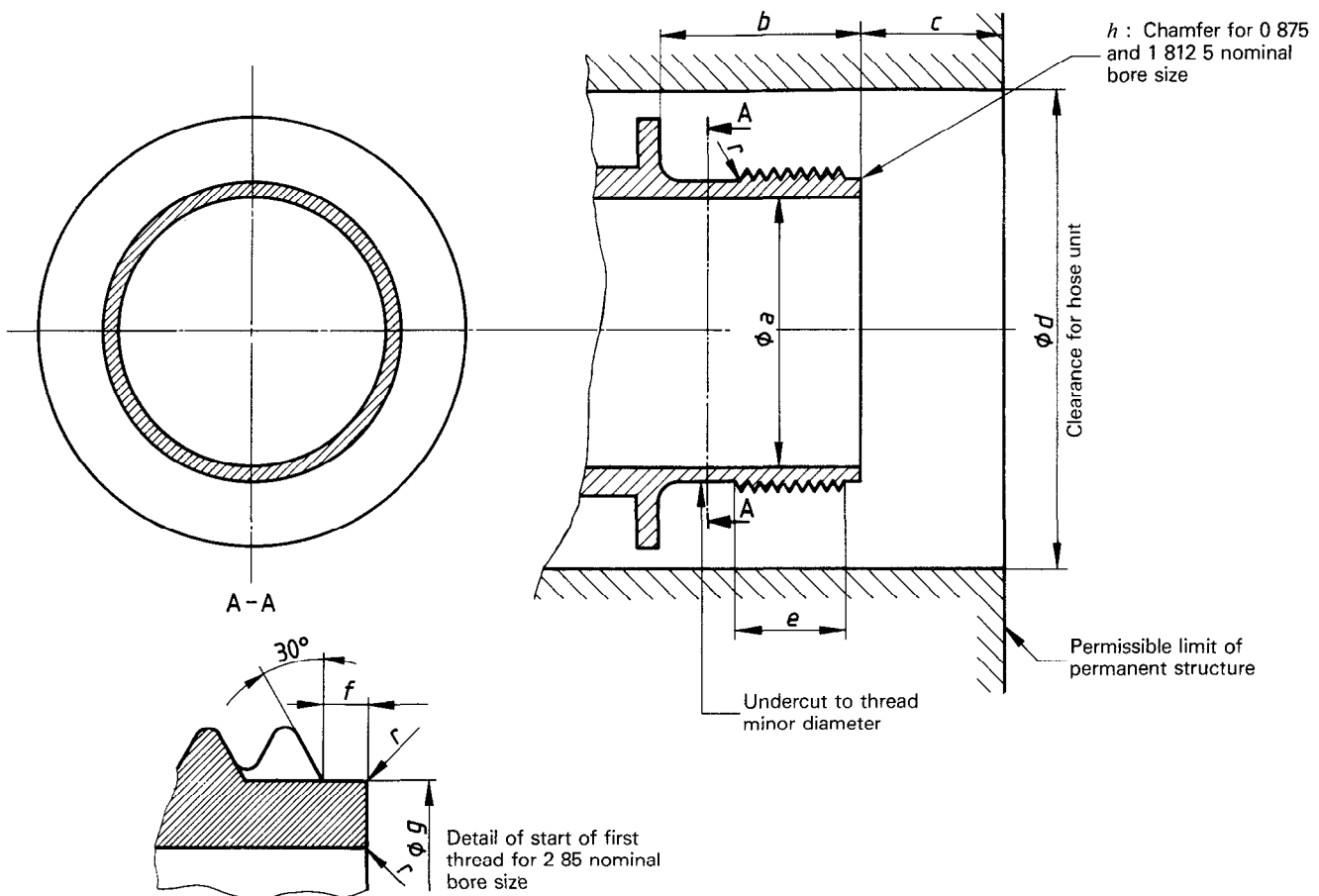

Dimension	Nominal bore size					
	0.875		1.812.5		2.85	
	mm	in	mm	in	mm	in
a ¹⁾	22,22	0.875	46,04	1.812.5	72,39 ^{+ 0,13} ₀	2.85 ^{+ 0.005} ₀
b min.	25,4	1.0	25,4	1.0	57,15	2.25
c max.	38,0	1.5	38,0	1.5	38,0	1.5
d min.	82,0	3.25	95,0	3.75	127,0	5.0
e ²⁾	12,7	0.50	12,7	0.50	31,75	1.25
f	—	—	—	—	3,94 ± 0,13	0.155 ± 0.005
g	—	—	—	—	79,76 ⁰ _{- 0,26}	3.14 ⁰ _{- 0.01}
h	1,6/45°	0.062.5/45°	1,6/45°	0.062.5/45°	—	—
r ³⁾	—	—	—	—	0,635	0.025
Thread ⁴⁾	1,25 - 12 UNF 2 A		2,375 - 12 UN 2 A		3,5 - 4 UNC 2 A	

- 1) Recommended bore.
- 2) Full thread.
- 3) Radius.
- 4) Threads in accordance with ISO 725.

Figure — Basic dimensions and clearance requirements

ISO 11 : 1987 (E)

UDC 629.7.028 : 621.643.414

Descriptors : aircraft, aircraft cabins, pressurized cabins, pressure tests, aircraft equipment, pipe fittings, inlet connections, dimensions.

Price based on 2 pages
