

# Connectors for electronic equipment — Product requirements —

**Part 2-107: Circular connectors — Detail  
specification for circular hybrid  
connectors M12 with electrical and  
fibre-optic contacts with screw-locking**

ICS 31.220.10

## National foreword

This Draft for Development is the UK implementation of IEC/PAS 61076-2-107:2007.

**This publication is not to be regarded as a British Standard.**

It is being issued in the Draft for Development series of publications and is of a provisional nature. It should be applied on this provisional basis, so that information and experience of its practical application can be obtained.

A PAS is a Technical Specification not fulfilling the requirements for a standard, but made available to the public and established in an organization operating under a given procedure.

A review of this Draft for Development will be carried out not later than three years after its publication.

Notification of the start of the review period, with a request for the submission of comments from users of this Draft for Development, will be made in an announcement in the appropriate issue of *Update Standards*. According to the replies received, the responsible BSI Committee will judge whether the validity of the PAS should be extended for a further three years or what other action should be taken and pass their comments on to the relevant international committee.

Observations which it is felt should receive attention before the official call for comments will be welcomed. These should be sent to the Secretary of the responsible BSI Technical Committee at British Standards House, 389 Chiswick High Road, London W4 4AL.

The UK participation in its preparation was entrusted to Technical Committee EPL/48, Electromechanical components and mechanical structures for electronic equipment.

A list of organizations represented on this committee can be obtained on request to its secretary.

This publication does not purport to include all the necessary provisions of a contract. Users are responsible for its correct application.

This Draft for Development was published under the authority of the Standards Policy and Strategy Committee on 31 March 2008

© BSI 2008

ISBN 978 0 580 60996 1

### Amendments/corrigenda issued since publication

Date	Comments



DD IEC/PAS 61076-2-107:2007

IEC/PAS 61076-2-107

Edition 1.0 2007-12

# PUBLICLY AVAILABLE SPECIFICATION PRE-STANDARD

---

**Connectors for electronic equipment – Product requirements –  
Part 2-107: Circular connectors – Detail specification for circular hybrid  
connectors M12 with electrical and fibre-optic contacts with screw-locking**



## CONTENTS

1	General information .....	5
1.1	Scope.....	5
1.2	Recommended method of termination .....	5
1.3	Ratings and characteristics .....	5
1.3.1	Electrical contacts .....	5
1.3.2	Optic contacts .....	6
1.4	Normative references .....	6
1.5	Marking .....	7
1.6	Safety aspects.....	7
2	Technical information .....	7
2.1	Terms and definitions .....	7
2.1.1	Mounting orientation .....	7
2.2	Survey of styles and variants.....	7
2.2.1	Fixed connectors .....	7
2.2.2	Free connectors .....	8
2.2.3	Adaptor .....	9
3	Dimensions .....	10
3.1	General .....	10
3.2	Interface dimensions .....	10
3.2.1	Pin front view plug connector.....	10
3.3	Engagement (mating) information.....	11
3.4	Gauges for electric contacts .....	12
4	Characteristics .....	13
4.1	Climatic category.....	13
4.2	Electrical characteristics (only electrical contacts).....	13
4.2.1	Rated voltage – Impulse voltage – Pollution degree.....	13
4.2.2	Voltage proof.....	13
4.2.3	Current-carrying capacity.....	13
4.2.4	Contact resistance.....	14
4.2.5	Insulation resistance.....	14
4.3	Optic characteristics (only optic contacts).....	14
4.4	Mechanical.....	14
4.4.1	IP degree of protection .....	14
4.4.2	Mechanical operation .....	14
4.4.3	Insertion and withdrawal forces .....	14
4.4.4	Contact retention in insert.....	14
4.4.5	Polarizing method.....	15
4.4.6	Vibration (sinusoidal).....	15
5	Test schedule .....	15
5.1	General .....	15
5.1.1	Arrangement for contact resistance measurements.....	15
5.1.2	Arrangement for dynamic stress tests (vibration) .....	16
5.2	Test schedule.....	17
5.2.1	Test group P – Preliminary .....	17
5.2.2	Test group AP – Dynamic/ Climatic.....	19

5.2.3	Test group BP – Mechanical endurance.....	23
5.2.4	Test group CP – Electrical load .....	26
5.2.5	Test group DP – Chemical resistivity .....	27
5.2.6	Test group EP – Connection method tests .....	28
BIBLIOGRAPHY .....		29

Figure 1	– Fixed connector, electrical female contacts, single hole mounting thread M16 × 1,5 mounting orientation.....	8
Figure 2	– Fixed connector, electrical female contacts, for feed through, single hole mounting thread M16 × 1,5 .....	8
Figure 3	– Free connector, straight version, with locking nut, male contacts .....	9
Figure 4	– Adaptor, straight version, without locking nut .....	9
Figure 5	- Pin front view plug connector .....	10
Figure 6	– Engagement (mating) information .....	11
Figure 7	– Gauge dimensions .....	12
Figure 8	– Contact resistance arrangement.....	16
Figure 9	– Dynamic stress test arrangement A.....	16
Figure 10	– Dynamic stress test arrangement B .....	16
Table 1	– Styles of fixed connectors .....	7
Table 2	– Styles of free connectors .....	8
Table 3	– Styles of adaptors .....	9
Table 4	– Dimensions connectors Type D in mated position.....	11
Table 5	- Gauges .....	12
Table 6	– Climatic Category.....	13
Table 7	– Rated voltage – Impulse voltage – Pollution degree .....	13
Table 8	– Voltage proof.....	13
Table 9	– Number of mechanical operations .....	14
Table 10	– Insertion and withdrawal forces .....	14
Table 11	– Number of test specimens .....	15
Table 12	– Test group P .....	17
Table 13	– Test group AP .....	19
Table 14	– Test group BP .....	23
Table 15	– Test group CP .....	26
Table 16	– Test group DP .....	27
Table 17	– Test group EP .....	28

## CONNECTORS FOR ELECTRONIC EQUIPMENT – PRODUCT REQUIREMENTS –

### Part 2-107: Circular connectors – Detail specification for circular hybrid connectors M12 with electrical and fibre-optic contacts with screw-locking

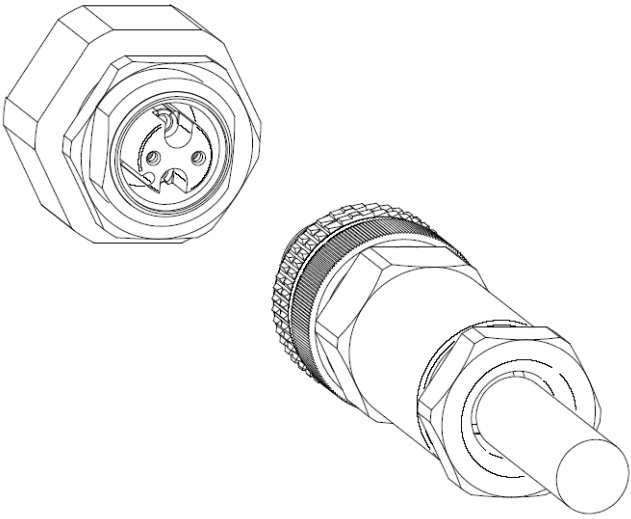
<p>IEC SC 48B – Connectors</p> <p>Specification available from: IEC General secretariat or from the addresses shown on the inside cover.</p>	IEC/PAS 61076-2-107
<p>ELECTRONIC COMPONENTS</p> <p>DETAIL SPECIFICATION in accordance with IEC 61076-1</p>	
	<p>Circular hybrid connectors M12-4: with 2 way electrical connections with <math>\varnothing</math> 1,0 male contacts and with 2 way fibre optic connections with <math>\varnothing</math> 1,25 ceramic LC ferrule</p>
	<p>Free cable connectors Straight connectors</p> <p>Fixed connectors</p> <p>Flange mounting Single hole mounting</p> <p>Adapters</p> <p>Feed through</p>

## 1 General information

This Publicly Available Specification (PAS) has been prepared by SC 48B to support and to be referenced in IEC 61784-5-3:2007.

This PAS is subject to further development of a joint Project Team of SC 48B and SC 86B to publish an International Standard IS.

### 1.1 Scope

This PAS describes circular M12-connectors typically used for industrial process measurement and control. These connectors consist of fixed and free connectors with screw-locking as well as adaptors.

The connectors are suitable to connect two optic fibres and two electrical wires intended for power transmission to the optionally integrated transmitter and receiver, not specified in this PAS.

Male connectors have round electrical contacts  $\varnothing$  1,0 mm and cylindrical ceramic optic contacts  $\varnothing$  1,25 mm according to IEC 61754-20 Type LC for

- All-silica optic fibre cables
- Single-Mode fibre 9/125  $\mu\text{m}$
- Multi-Mode fibre 50/125  $\mu\text{m}$  or 62,5/125  $\mu\text{m}$

NOTE M12 is the dimension of the thread of the screw locking mechanism of these circular connectors.

### 1.2 Recommended method of termination

The electrical contact terminations shall be of the following types: screw, crimp, insulation piercing, insulation displacement, press-in or solder.

The optical contact terminations shall be defined between manufacturer and user. Preferred termination method for the international standard should be developed between SC 48B and SC 86B.

### 1.3 Ratings and characteristics

#### 1.3.1 Electrical contacts

Rated voltage: 250 V d.c. or a.c.

Rated current: 4 A

Insulation resistance: minimum  $10^8 \Omega$

Climatic category: see 4.1, Table 6

Contact spacing: see Clause 3

### 1.3.2 Optic contacts

Dimensions for ferrule and end face:

- for mono mode fibre, according to Grade 1 of IEC 61754-20
- for multi mode fibre, according to Grade 2 of IEC 61754-20

Insertion loss: Under development between SC 48B and SC 86B

Return loss: Under development between SC 48B and SC 86B

Climatic category : see 4.1, Table 6

Contact spacing : not applicable

### 1.4 Normative references

The following referenced documents are indispensable for the application of this document. For dated references, only the edition cited applies. For undated references, the latest edition of the referenced document (including any amendments) applies.

IEC 60050-581, *International Electrotechnical Vocabulary – Electromechanical components for electronic equipment*

IEC 60068-1:1988, *Environmental testing – Part 1: General and guidance*  
Amendment 1 (1992)

IEC 60352 (all parts), *Solderless connections*

IEC 60512 (all parts), *Connectors for electronic equipment – Tests and measurements*

IEC 60512-1-100, *Connectors for electronic equipment – Tests and measurements – Part 1-100: General – Applicable publications*

IEC 60529:2001, *Degrees of protection provided by enclosures (IP code)*

IEC 60664-1, *Insulation coordination for equipment within low-voltage systems – Part 1: Principles, requirements and tests*

IEC 60998-2-1, *Connecting devices for low-voltage circuits for household and similar purposes – Part 2-1: Particular requirements for connecting devices as separate entities with screw-type clamping units*

IEC 60999-2, *Connecting devices – Electrical copper conductors – Safety requirements for screw-type and screwless-type clamping units*

IEC 61076-1:2006, *Connectors for electronic equipment – Product requirements – Part 1: Generic specification*

IEC 61754-20:2002, *Fibre optic connector interfaces – Part 20: Type LC connector family*

ISO 1302, *Geometrical Product Specification (GPS) – Indication of surface texture in technical product documentation*



**1.5 Marking**

The marking of the connector and the package shall be in accordance with 2.6 of IEC 61076-1:2006.

**1.6 Safety aspects**

For safety aspects, IEC 61984 shall be considered unless otherwise specified.

**2 Technical information**

All dimensions in mm.

**2.1 Terms and definitions**

For the purpose of this Publicly Available Specification, the terms and definitions from IEC 60050 (581) apply.

**2.1.1 Mounting orientation**

Circular mounting position of the connector in relation to the polarization of the mating interface.

**2.2 Survey of styles and variants**

For all connector styles with cables, the length L of the cable shall be agreed upon between manufacturer and user.

For interface dimensions, see 3.2.

The interface dimensions of the female styles shall be chosen according to the common characteristics of the male styles.

**2.2.1 Fixed connectors**

**Table 1 – Styles of fixed connectors**

Style	Description
AF	Fixed connector, electrical female contacts, single hole mounting thread M16 x 1,5, mounting orientation
BF	Fixed connector, electrical female contacts, for feed through, single hole mounting thread M16 x 1,5

## 2.2.1.1 Style AF

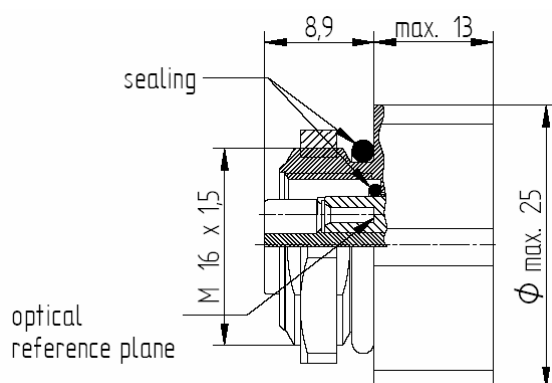

Figure 1 – Fixed connector, electrical female contacts, single hole mounting thread M16 × 1,5 mounting orientation

## 2.2.1.2 Style BF

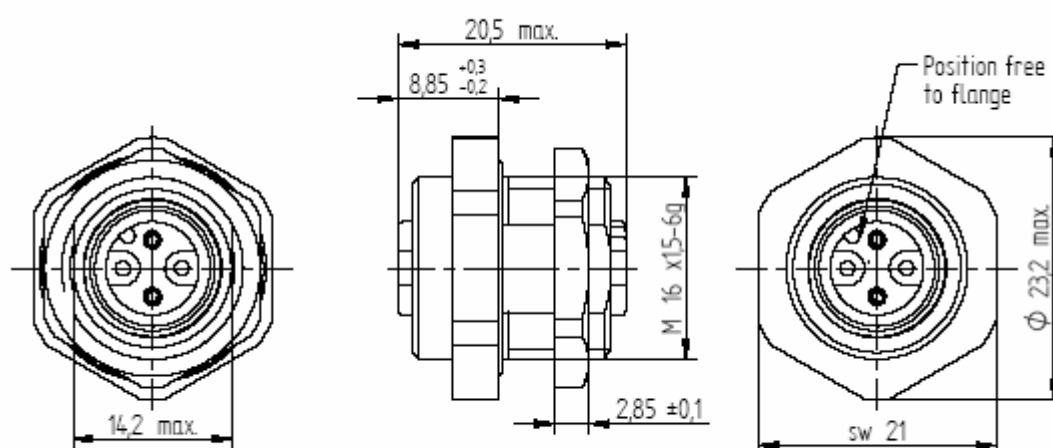

Figure 2 – Fixed connector, electrical female contacts, for feed through, single hole mounting thread M16 × 1,5

## 2.2.2 Free connectors

Table 2 – Styles of free connectors

Style	Description
CM	Free connector, straight version, with locking nut, male contacts

2.2.2.1 Style CM

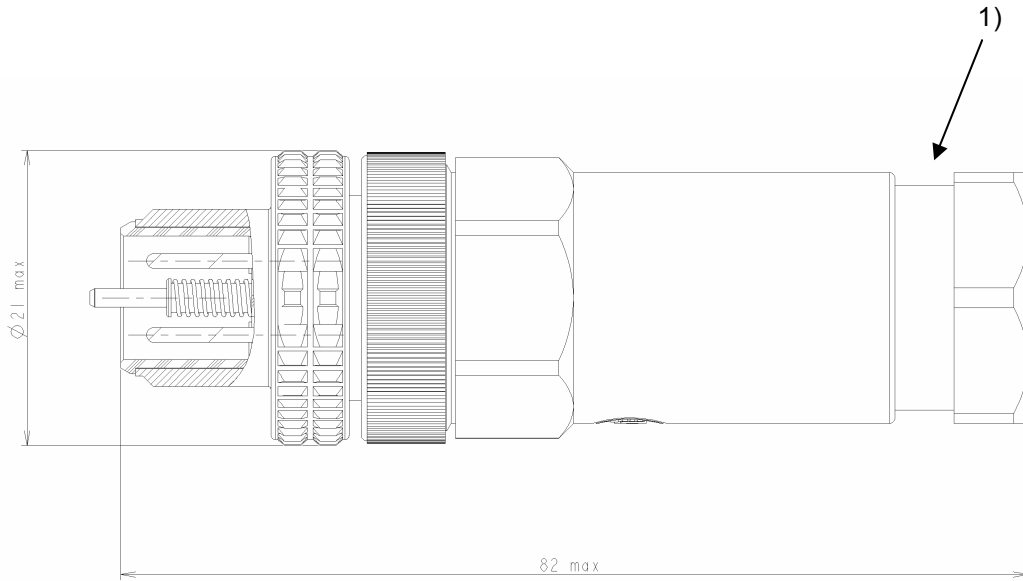

Key

- 1) Cable outlet diameter upon agreement

Figure 3 – Free connector, straight version, with locking nut, male contacts

2.2.3 Adaptor

Table 3 – Styles of adaptors

Style	Description
DF	Adaptor, straight version, without locking nut

2.2.3.1 Style DF

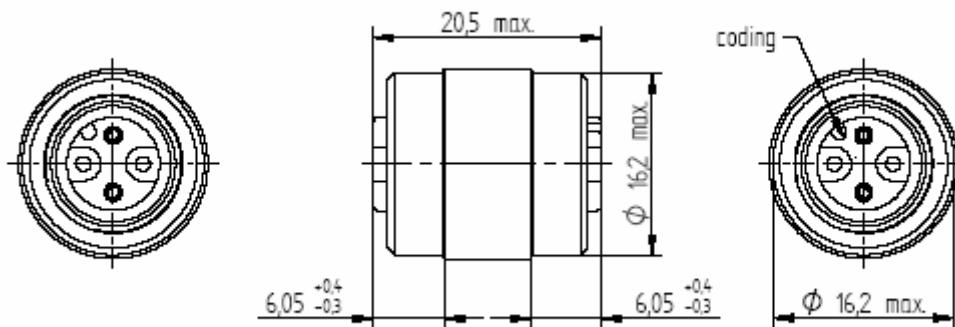

Figure 4 – Adaptor, straight version, without locking nut

### 3 Dimensions

#### 3.1 General

All original dimensions are in millimeters. Drawings are shown in the first angle projection. The shape of the connectors may deviate from those given in the following drawings as long as the specified dimensions are not influenced.

For connector dimensions and interface dimensions, see 2.2.

Missing dimensions shall be chosen according to common characteristics and intended use.

The contact marking shall be on the termination side of the connector insert as long as the size of the component allows the placement there.

#### 3.2 Interface dimensions

##### 3.2.1 Pin front view plug connector

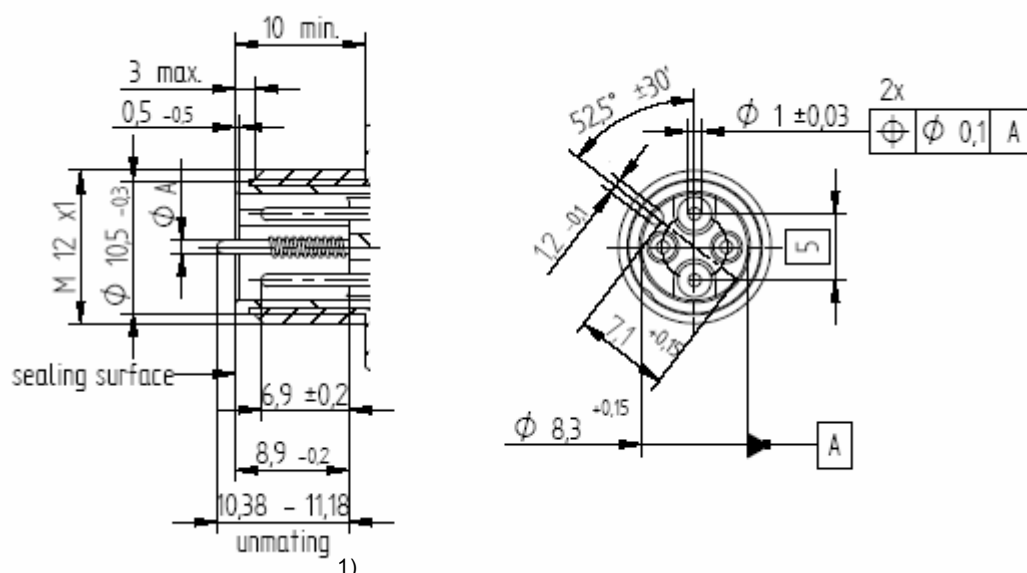

1) 8,9 in mated position (see optical reference plane in Figure 1)

**Figure 5 - Pin front view plug connector**

NOTE Critical optical dimensions are under development between SC 48B and SC 86B.

### 3.3 Engagement (mating) information

Arrows in Figure 6 indicate mating direction.

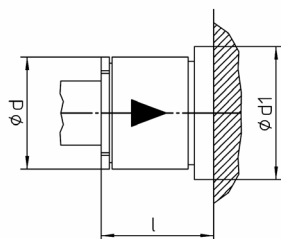

Figure 6a - Housing variant 1

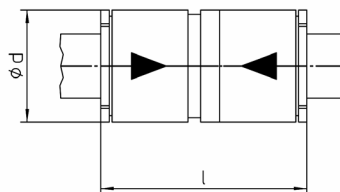

Figure 6b - Housing variant 2

Figure 6 – Engagement (mating) information

Table 4 – Dimensions of connectors Type D in mated position

Figure	Combination of styles	d maximum	d1	l <sup>1)</sup> maximum
6a	AF-CM	Ø 21	Ø 26,2	65
6a	BF-CM	Ø 21	Ø 26,2	65
6b	CM-DF-CM	Ø 21	---	130

<sup>1)</sup> Dimensions in mated position, additional space for insertion: 15 mm.

### 3.4 Gauges for electric contacts

Sizing gauges and retention force gauges

Material: tool steel, hardened

▽ = Surface (clean and free of grease)  
 roughness according to ISO 1302: Ra = 0,25 µm maximum, 0,15 µm minimum

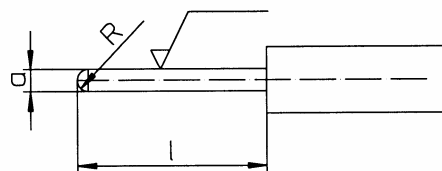

Figure 7 – Gauge dimensions

Table 5 - Gauges

Gauge	Mass g	Application	Ø a mm	l minimum mm	Nom pin Ø
P11	–	Sizing	1,03	10	1,0 ± 0,03
P12	20	Retention force	0,97	10	

## 4 Characteristics

### 4.1 Climatic category

Conditions: IEC 60068-1

**Table 6 – Climatic category**

Climatic category	Category temperature		Damp heat, steady state		Days
	Lower °C	Upper °C	Temperature °C	Relative humidity %	
25/85/21	-25	+85	40	93	21

### 4.2 Electrical characteristics (only electrical contacts)

#### 4.2.1 Rated voltage – Impulse voltage – Pollution degree

Conditions: IEC 60664-1

The permissible rated voltage depends on the application or specified safety requirement. Reductions in creepage or clearance distances may occur due to the printed board or wiring used and shall be duly taken into account.

**Table 7 – Rated voltage – Impulse voltage – Pollution degree**

Rated voltage V	Rated impulse voltage kV	Pollution degree
250	2,5	3
NOTE Only in mated and locked condition. Due to the accessibility of the male contacts, the rated voltage shall be reduced to 50 V SELV/PELV.		

#### 4.2.2 Voltage proof

Conditions: IEC 60512, Test 4a  
 Standard atmospheric conditions  
 Mated connectors

**Table 8 – Voltage proof**

Between contacts r.m.s. withstand voltage		Between contacts and metal housing	
Fixed connectors kV	Free connectors kV	Fixed connectors kV	Free connectors kV
1,4	1,4	1,4	1,4

#### 4.2.3 Current-carrying capacity

Conditions: IEC 60512, Test 5b  
 All contacts  
 Values at 40°C 4 A

**4.2.4 Contact resistance**

Conditions: IEC 60512, Test 2a  
Standard atmospheric conditions  
connecting points, see 5.1.1

**4.2.5 Insulation resistance**

Conditions: IEC 60512, Test 3a, Method A  
Standard atmospheric conditions  
Test voltage 500 V ± 15 V d.c.

**4.3 Optic characteristics (only optic contacts)**

(Under development between SC 48B and SC 86B)

**4.4 Mechanical****4.4.1 IP degree of protection**

IP65 and IP67 according to IEC 60529, connectors in mated and locked position.

IP68 as agreed upon between manufacturer and user.

**4.4.2 Mechanical operation**

Conditions: IEC 60512, Test 9a  
Standard atmospheric conditions  
Maximum speed of operations = 10 mm/s  
Rest: 30 s, unmated

**Table 9 – Number of mechanical operations**

Contact finish	Mechanical operations
Gold	100
Silver	50
Tin	20
other types	a)

a) Other mating cycles are upon agreement between manufacturer and user.

**4.4.3 Insertion and withdrawal forces**

Conditions: IEC 60512, Test 13b  
Standard atmospheric conditions  
Maximum speed = 10 mm/s

**Table 10 – Insertion and withdrawal forces**

Total insertion force N	Total withdrawal force N
25	30

**4.4.4 Contact retention in insert**

Not applicable



For removable crimp type contacts, the introduction of an appropriate requirement is under consideration.

**4.4.5 Polarizing method**

Conditions: IEC 60512, Test 13e  
 Insertion force: 35 N minimum.

**4.4.6 Vibration (sinusoidal)**

Conditions: IEC 60512, Test 6d  
 Standard atmospheric conditions  
 Connectors in mated and locked position  
 The fixed and free connector shall be rigidly installed in a suitable fixture as specified in 5.1.2.  
 Vibration Severity: 10 to 500 Hz and 0,35 mm or 50 m/s<sup>2</sup>

**5 Test schedule**

**5.1 General**

This test schedule shows the tests and the order in which they shall be carried out, as well as the requirements to be met.

Unless otherwise specified, all tests shall be carried out under standard atmospheric conditions for testing as specified in IEC 60068-1, as directed by the applicable part of IEC 60512.

Unless otherwise specified, mated and locked sets of connectors shall be tested. Care shall be taken to keep a particular combination of connectors together during the complete test sequence, i.e. when unmating is necessary for a certain test, the same connector styles as before shall be mated for the subsequent tests.

In the following, a mated and locked set of connector styles is called a specimen.

When the initial tests have been completed, all the specimens are divided up according to the test groups.

Before testing commences, the connectors shall be stored for at least 24 h in the non-engaged state under standard atmospheric conditions as per IEC 60068-1.

The necessary specimens are stated in Table 11.

**Table 11 – Number of test specimens**

	Test group					
	P	AP	BP	CP	DP	EP
<b>No. of specimens</b>	12	3	3	3	3	20 single contacts

**5.1.1 Arrangement for contact resistance measurements**

Conditions: see 4.2.4

The measurement of contact resistance shall be carried out on the number of contacts specified. Any subsequent measurements of contact resistance shall be made on the same contacts.

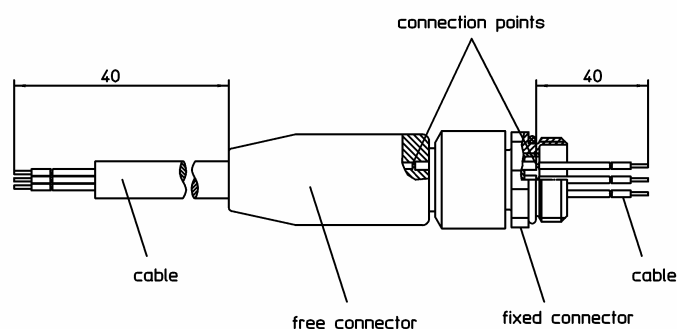

**Figure 8 – Contact resistance arrangement**

**5.1.2 Arrangement for dynamic stress tests (vibration)**

Conditions: see 4.4.6

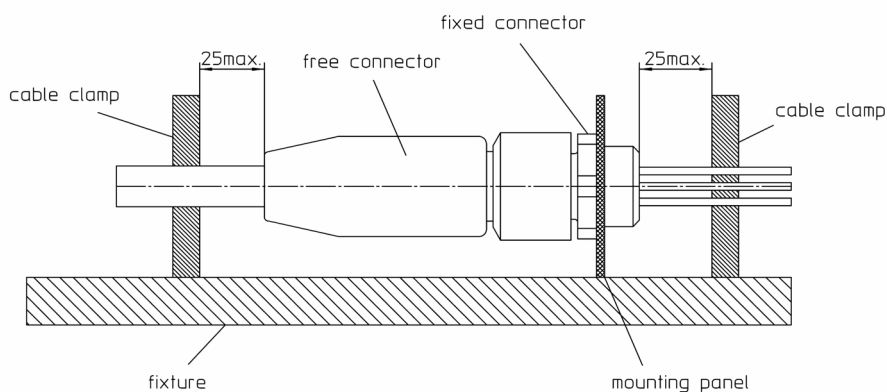

**Figure 9 – Dynamic stress test arrangement A**

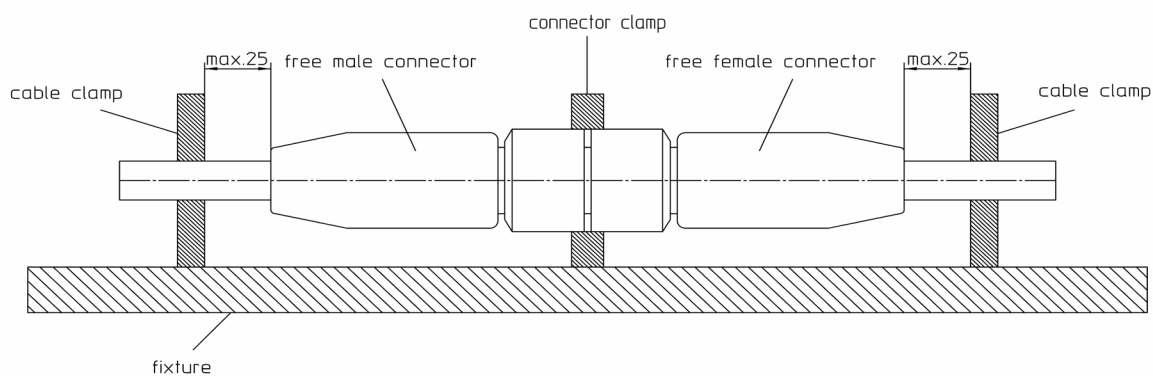

**Figure 10 – Dynamic stress test arrangement B**

**5.2 Test schedule**

**5.2.1 Test group P – Preliminary**

All specimens shall be subject to the following tests.

**Table 12 – Test group P**

Test phase	Test		Electrical measurement to be performed	Electrical requirements	Optic measurement to be performed		Optic requirements	
	Title	IEC 60512 Test No.			Severity or condition of test	Title		Method
P1	General examination	1	Unmated connectors	Visual examination	1a			(Under development between SC 48B and SC 86B)
P2	Polarizing method	13e	see 4.4.5					

Test phase	Test			Electrical measurement to be performed		Electrical requirements	Optic measurement to be performed		Optic requirements
	Title	IEC 60512 Test No.	Severity or condition of test	Title	IEC 60512 Test No.		Title	Method	
<b>P3</b>	Connection quality (initial value)			Connection points according to 5.1.1, all electrical contacts per specimen, Contact resistance – Millivolt level method	2a	initial value maximum 10 mΩ			<b>(Under development between SC 48B and SC 86B)</b>
				Insulation resistance	3a				
<b>P4</b>			Test voltage 500 V ± 15 V d.c. Method A			No electrical requirement			
<b>P5</b>	Return loss (random mated)								
<b>P6</b>			Contact/cont act same measuring points as for P4	Voltage proof	4a	According to 4.2.2			

The specimen shall be divided into five groups. All connectors in each group shall undergo the tests specified for the relevant group.

5.2.2 Test group AP – Dynamic/ Climatic

Table 13 – Test group AP

Test phase	Test		Electrical measurement to be performed	Electrical requirements	Optic measurement to be performed		Optic requirements
	Title	IEC 60512 Test No.			Severity or condition of test	Title	
AP1	Insertion and with-drawal force	See 4.4.3	IEC 60512 Test No. 13b	Insertion and withdrawal force	Requirements see 4.4.3		
AP2	Gauge retention force	Female contacts only 2 contacts/ specimen sizing and retention force gauge see 3.3	IEC 60512 Test No. 16e	Engaging and separating forces	See 4.4.4		
AP3	Vibration	10 Hz - 500 Hz, 0,35 mm resp. 50 m/s <sup>2</sup> Sweep cycles: 10 Full duration: 6 h	IEC 60512 Test No. 6d	Contact disturbance	2e	Duration of disturbance maximum 1 µs	(Under development between SC 48B and SC 86B)
				Contact resistance – Millivolt level method	2a	Rise in relation to initial values maximum 15 mΩ	
				Insertion loss	25b	Maximum 0,5 dB per connector	
				Visual examination	1a	There shall be no defect that would impair normal operation	

Test phase	Test		Electrical measurement to be performed	Electrical requirements	Optic measurement to be performed		Optic requirements	
	Title	IEC 60512 Test No.			Severity or condition of test	Title		Method
AP4	Shock	6c	Arrangement according to 5.1.2 Half sine shock Acceleration 490 m/s <sup>2</sup> (50 g) Duration of impact: 11 ms	IEC 60512 Test No.	Duration of disturbance maximum 1 µs	(Under development between SC 48B and SC 86B)		
				Title	2e			
				Contact disturbance	2a			
AP5	Rapid change of temperature	11d	-15 °C to 85 °C t = 30 min 5 cycles	Contact resistance – Millivolt level method	Rise in relation to initial values maximum 15 mΩ			
				Visual examination	1a			
				There shall be no defect that would impair normal operation				
				Contact resistance – Millivolt level method	Rise in relation to initial values maximum 15 mΩ			
				Insulation resistance	3a			minimum 10 <sup>8</sup> Ω
				Voltage proof	4a			According to 4.2.2
AP6	Climatic sequence	11a		Visual examination	1a			
				There shall be no defect that would impair normal operation				
AP6.1	Dry heat	11i	Temperature: 85 °C Duration: 16 h	Insulation resistance at high temperature	3a			
				Minimum 10 <sup>8</sup> Ω				
AP6.2	Damp heat, cyclic; first cycle	11m	Method Db Temp.: 40 °C Recovery time: 2 h	Visual examination	1a			
				There shall be no defect that would impair normal operation				

Test phase	Test		Electrical measurement to be performed	Electrical requirements	Optic measurement to be performed		Optic requirements
	Title	IEC 60512 Test No.			Severity or condition of test	Title	
AP6.3	Cold	11j	Temperature: -25 °C Duration: 2 h Recovery time: 2 h	Visual examination	1a		(Under development between SC 48B and SC 86B)
AP6.4	Damp heat, cyclic; remaining cycles	11m	Conditions according to AP6.2 5 cycles Recovery time: 2 h	Contact resistance – Millivolt level method	2a	Rise in relation to initial values maximum 15 mΩ	
				Insulation resistance	3a	Minimum 10 <sup>8</sup> Ω	
				Voltage proof	4a	According to 4.2.2	
AP7	Impacting dust and water						
AP7.1	Second characteristic numeral		Spray-IPX5-IPX7 Test 5 and 7 Test 5: nozzle 6,3 mm Test 7: 1 m, 30 min	IEC 60529:2001 Test 14.2.5 and Test 14.2.7		No leakage on contacts	
AP7.2	First characteristic numeral		Dust IP6X Test 6, Table 7	IEC 60529:2001 Test 6 Table 7		IP6X no deposit of dust on contacts	

Test phase	Test		Electrical measurement to be performed	Electrical requirements	Optic measurement to be performed		Optic requirements	
	Title	IEC 60512 Test No.			Severity or condition of test	Title		Method
AP7.3			IEC 60512 Test No.	Title	IEC 60512 Test No.			
					2a			Rise in relation to initial values maximum 15 mΩ
					3a			Minimum 10 <sup>8</sup> Ω
					4a			According to 4.2.2
					13b			Requirements - see 4.4.3
					1a			There shall be no defect that would impair normal operation



5.2.3 Test group BP – Mechanical endurance

Table 14 – Test group BP

Test phase	Test		Electrical measurement to be performed	Electrical requirements	Optic measurement to be performed		Optic requirements
	Title	IEC 60512 Test No.			Severity or condition of test	Title	
BP1	Gauge retention force		Female contacts only 2 contacts/ specimen sizing and retention force gauge see 3.3	16e	Engaging and separating forces		
BP2	Mechanical operation (half of the specified number of operations)	9a	Speed: 10 mm/s maximum Rest: 30 s (unmated) Operations see 4.4.2	2a	Contact resistance – Millivolt level method	Rise in relation to initial values maximum 15 mΩ	
BP3	Corrosion industrial atmosphere (salt spray)	11f	48 h	1a	Visual examination	There shall be no defect that would impair normal operation	

(Under development between SC 48B and SC 86B)

Test phase	Test		Severity or condition of test	Electrical measurement to be performed		Electrical requirements	Optic measurement to be performed		Optic requirements						
	Title	IEC 60512 Test No.		Title	IEC 60512 Test No.		Title	Method							
<b>BP4</b>	Mechanical operation (remaining half of specified number of operations)	9a	See BP2	Contact resistance – Millivolt level method	2a	Rise in relation to initial values maximum 15 mΩ									
										Insulation resistance	3a	Minimum 10 <sup>8</sup> Ω			
													Voltage proof	4a	According to 4.2.2
<b>BP5</b>	Gauge retention force		Female contacts only 2 contacts/ specimen sizing and retention force gauge see 3.3	Engaging and separating forces	16e	See 4.4.4									
				Fibre / cable retention		Visual examination	1a	There shall be no defect that would impair normal operation							
<b>BP6</b>	Mechanical impact			Visual examination	1a	There shall be no defect that would impair normal operation									
<b>BP7</b>	Torsion			Visual examination	1a	There shall be no defect that would impair normal operation									
<b>BP8</b>				Visual examination	1a	There shall be no defect that would impair normal operation									

Test phase	Test			Electrical measurement to be performed		Electrical requirements	Optic measurement to be performed		Optic requirements
	Title	IEC 60512 Test No.	Severity or condition of test	Title	IEC 60512 Test No.		Title	Method	
<b>BP9</b>	Static side load			Visual examination	1a	There shall be no defect that would impair normal operation			
<b>BP10</b>	Bending moment			Visual examination	1a	There shall be no defect that would impair normal operation	<b>(Under development between SC 48B and SC 86B)</b>		

## 5.2.4 Test group CP – Electrical load

Table 15 – Test group CP

Test phase	Test		Electrical measurement to be performed		Electrical requirements	Optic measurement to be performed		Optic requirements	
	Title	IEC 60512 Test No.	Severity or condition of test	Title		IEC 60512 Test No.	Title		Method
CP1	Rapid change of temperature	11d	-15 °C to 85 °C t = 1 h 5 cycles	Contact resistance – Millivolt level method	2a	Rise in relation to initial values maximum 15 mΩ			
				Insulation resistance	3a				Minimum 10 <sup>8</sup> Ω
				Voltage proof	4a				
CP2	Mechanical operation (specified number of operations)	9a	Speed: < 10 mm/s Rest: 30 s (unmated) Operations see 4.3.2						
CP3	Mechanical operation (specified number of operations) (electrical contacts only)	9b	Duration: 1 000 h Ambient temperature: 40 °C Current load according to 4.2.3 Recovery time: 2 h Temp.-sensor in center of specimen	Contact resistance – Millivolt level method	2a	Rise in relation to initial values maximum 15 mΩ			
				Insulation resistance	3a				Minimum 10 <sup>8</sup> Ω
				Voltage proof	4a				

5.2.5 Test group DP – Chemical resistivity

Table 16 – Test group DP

Test phase	Test		Electrical measurement to be performed		Electrical requirements	Optic measurement to be performed		Optic requirements
	Title	IEC 60512 Test No.	Title	IEC 60512 Test No.		Title	Method	
DP1	Resistance to fluids	19c	Upon agreement between manufacturer and user		Upon agreement between manufacturer and user	(Under development between SC 48B and SC 86B)		
			Clearing of specimen by washing briefly in light petrol	2a	Rise in relation to initial values maximum 15 mΩ			
DP2	Retreatment		Unmated connectors	Voltage proof	4a	According to 4.2.2		
				Visual examination	1a	There shall be no defect that would impair normal operation		

## 5.2.6 Test group EP – Connection method tests

Table 17 – Test group EP

Test phase	Test		Electrical measurement to be performed		Electrical requirements	Optic measurement to be performed		Optic requirements
	Title	Test No.	Severity or condition of test	Title		IEC 60512 Test No.	Title	
EP1	Solderless connections: screw, crimp, insulation displacement, insulation piercing, press-in	IEC 60352	See relevant IEC 60352 standard, for screw-type terminations see relevant IEC 60998-2-1 or IEC 60999					(Under development between SC 48B and SC 86B)

## BIBLIOGRAPHY

IEC 61784-5-3, *Industrial communication networks – Profiles – Part 5-3: Installation of fieldbuses – Installation profiles for CPF 3*

IEC 61984, *Connectors – Safety requirements and tests*

---

---

---

## BSI — British Standards Institution

BSI is the independent national body responsible for preparing British Standards. It presents the UK view on standards in Europe and at the international level. It is incorporated by Royal Charter.

### Revisions

British Standards are updated by amendment or revision. Users of British Standards should make sure that they possess the latest amendments or editions.

It is the constant aim of BSI to improve the quality of our products and services. We would be grateful if anyone finding an inaccuracy or ambiguity while using this British Standard would inform the Secretary of the technical committee responsible, the identity of which can be found on the inside front cover.  
Tel: +44 (0)20 8996 9000. Fax: +44 (0)20 8996 7400.

BSI offers members an individual updating service called PLUS which ensures that subscribers automatically receive the latest editions of standards.

### Buying standards

Orders for all BSI, international and foreign standards publications should be addressed to Customer Services. Tel: +44 (0)20 8996 9001.  
Fax: +44 (0)20 8996 7001. Email: [orders@bsi-global.com](mailto:orders@bsi-global.com). Standards are also available from the BSI website at <http://www.bsi-global.com>.

In response to orders for international standards, it is BSI policy to supply the BSI implementation of those that have been published as British Standards, unless otherwise requested.

### Information on standards

BSI provides a wide range of information on national, European and international standards through its Library and its Technical Help to Exporters Service. Various BSI electronic information services are also available which give details on all its products and services. Contact the Information Centre.  
Tel: +44 (0)20 8996 7111. Fax: +44 (0)20 8996 7048. Email: [info@bsi-global.com](mailto:info@bsi-global.com).

Subscribing members of BSI are kept up to date with standards developments and receive substantial discounts on the purchase price of standards. For details of these and other benefits contact Membership Administration.  
Tel: +44 (0)20 8996 7002. Fax: +44 (0)20 8996 7001.  
Email: [membership@bsi-global.com](mailto:membership@bsi-global.com).

Information regarding online access to British Standards via British Standards Online can be found at <http://www.bsi-global.com/bsonline>.

Further information about BSI is available on the BSI website at <http://www.bsi-global.com>.

### Copyright

Copyright subsists in all BSI publications. BSI also holds the copyright, in the UK, of the publications of the international standardization bodies. Except as permitted under the Copyright, Designs and Patents Act 1988 no extract may be reproduced, stored in a retrieval system or transmitted in any form or by any means – electronic, photocopying, recording or otherwise – without prior written permission from BSI.

This does not preclude the free use, in the course of implementing the standard, of necessary details such as symbols, and size, type or grade designations. If these details are to be used for any other purpose than implementation then the prior written permission of BSI must be obtained.

Details and advice can be obtained from the Copyright & Licensing Manager.  
Tel: +44 (0)20 8996 7070. Fax: +44 (0)20 8996 7553.  
Email: [copyright@bsi-global.com](mailto:copyright@bsi-global.com).