

BS ISO 26322-2:2010



BSI Standards Publication

Tractors for agriculture and forestry — Safety

Part 2: Narrow-track and small tractors

NO COPYING WITHOUT BSI PERMISSION EXCEPT AS PERMITTED BY COPYRIGHT LAW

raising standards worldwide[™]



National foreword

This British Standard is the UK implementation of ISO 26322-2:2010.

The UK participation in its preparation was entrusted to Technical Committee AGE/6, Agricultural tractors and forestry machinery.

A list of organizations represented on this committee can be obtained on request to its secretary.

This publication does not purport to include all the necessary provisions of a contract. Users are responsible for its correct application.

© BSI 2010

ISBN 978 0 580 62545 9

ICS 65.060.10

Compliance with a British Standard cannot confer immunity from legal obligations.

This British Standard was published under the authority of the Standards Policy and Strategy Committee on 31 October 2010.

Amendments issued since publication

Date	Text affected
------	---------------

INTERNATIONAL STANDARD

BS ISO 26322-2:2010

ISO
26322-2

First edition
2010-10-01

Tractors for agriculture and forestry — Safety —

Part 2: Narrow-track and small tractors

Tracteurs agricoles et forestiers — Sécurité —

Partie 2: Tracteurs à voie étroite et tracteurs compacts



Reference number
ISO 26322-2:2010(E)

© ISO 2010

Foreword

ISO (the International Organization for Standardization) is a worldwide federation of national standards bodies (ISO member bodies). The work of preparing International Standards is normally carried out through ISO technical committees. Each member body interested in a subject for which a technical committee has been established has the right to be represented on that committee. International organizations, governmental and non-governmental, in liaison with ISO, also take part in the work. ISO collaborates closely with the International Electrotechnical Commission (IEC) on all matters of electrotechnical standardization.

International Standards are drafted in accordance with the rules given in the ISO/IEC Directives, Part 2.

The main task of technical committees is to prepare International Standards. Draft International Standards adopted by the technical committees are circulated to the member bodies for voting. Publication as an International Standard requires approval by at least 75 % of the member bodies casting a vote.

Attention is drawn to the possibility that some of the elements of this document may be the subject of patent rights. ISO shall not be held responsible for identifying any or all such patent rights.

ISO 26322-2 was prepared by Technical Committee ISO/TC 23, *Tractors and machinery for agriculture and forestry*, Subcommittee SC 4, *Tractors*.

This first edition of ISO 26322-2, together with ISO 26322-1, cancels and replaces ISO 4254-3:1992, of which it constitutes a technical revision. It also incorporates requirements for tractor safety formerly given in ISO 4254-1. Additional requirements have been included in order to take account of the technical evolution of the tractors and changes in their use that have occurred since publication of the replaced International Standard.

ISO 26322 consists of the following parts, under the general title *Tractors for agriculture and forestry — Safety*:

- *Part 1: Standard tractors*
- *Part 2: Narrow-track and small tractors*

Tractors for agriculture and forestry — Safety —

Part 2: Narrow-track and small tractors

1 Scope

This part of ISO 26322 specifies the general safety requirements and their verification for the design and construction of narrow-track and small tractors used in agriculture and forestry. It also specifies the type of information on safe working practices, including residual risks, to be provided by the manufacturer. It provides technical means for improving the level of personal safety of operators and others involved in the course of the normal operation, maintenance and use of these tractors.

It is applicable to narrow-track tractors having at least two axles for pneumatic-tyred wheels, or having tracks instead of wheels with a smallest fixed or adjustable track width of not more than 1 150 mm, and to small tractors having an unladen mass not greater than 600 kg.

NOTE Tractors having a smallest fixed or adjustable track width greater than 1 150 mm and an unladen mass greater than 600 kg are dealt with in ISO 26322-1.

It is not applicable to vibration or braking.

2 Normative references

The following referenced documents are indispensable for the application of this document. For dated references, only the edition cited applies. For undated references, the latest edition of the referenced document (including any amendments) applies.

ISO 500-1, *Agricultural tractors — Rear-mounted power take-off types 1, 2 and 3 — Part 1: General specifications, safety requirements, dimensions for master shield and clearance zone*

ISO 500-2, *Agricultural tractors — Rear-mounted power take-off types 1, 2 and 3 — Part 2: Narrow-track tractors, dimensions for master shield and clearance zone*

ISO 3776-1, *Tractors and machinery for agriculture — Seat belts — Part 1: Anchorage location requirements*

ISO 3776-2, *Tractors and machinery for agriculture — Seat belts — Part 2: Anchorage strength requirements*

ISO 3776-3, *Tractors and machinery for agriculture — Seat belts — Part 3: Requirements for assemblies*

ISO 4252, *Agricultural tractors — Operator's workplace, access and exit — Dimensions*

ISO 5353, *Earth-moving machinery, and tractors and machinery for agriculture and forestry — Seat index point*

ISO 8759-1, *Agricultural wheeled tractors — Front-mounted equipment — Part 1: Power take-off and three-point linkage*

ISO 12003-1, *Agricultural and forestry tractors — Roll-over protective structures on narrow-track wheeled tractors — Part 1: Front-mounted ROPS*

ISO 12003-2, *Agricultural and forestry tractors — Roll-over protective structures on narrow-track wheeled tractors — Part 2: Rear-mounted ROPS*

ISO 23205:2006, *Agricultural tractors — Instructional seat*

ISO 26322-1:2008, *Tractors for agriculture and forestry — Safety requirements — Part 1: Standard tractors*

3 Terms and definitions

For the purposes of this document, the terms and definitions given in ISO 26322-1 and the following apply.

3.1 narrow-track tractor
agricultural or forestry tractor having an unladen mass greater than 600 kg and a fixed or adjustable minimum track width of the axle fitted with the larger tyres of not more than 1 150 mm, it being possible to set the track width of the axle fitted with the smaller tyres so that the overall width across those tyres is not greater than the overall width across the larger tyres, and on which, if both axles are fitted with tyres of the same size, the fixed or adjustable track width of both axles is not greater than 1 150 mm

3.2 small tractor
agricultural or forestry tractor having an unladen mass not greater than 600 kg

4 Safety requirements

4.1 Fundamental principles and design guidance

The fundamental principles and design guidance given in ISO 26322-1:2008, 4.1, apply.¹⁾

4.2 Noise

For noise, the provisions of ISO 26322-1:2008, 4.2, apply.

4.3 Controls

For controls, the provisions of ISO 26322-1:2008, 4.3, apply.

4.4 Operator station

4.4.1 Boarding means

4.4.1.1 General

The provisions of ISO 26322-1:2008, 4.4.1.1, apply.

1) This includes reference to ISO 12100-1:2003, Clause 5, since replaced by ISO 12100:2010, *Safety of machinery — General principles for design — Risk assessment and risk reduction*, Clauses 4 and 5.

4.4.1.2 Steps and ladders

For steps and ladders, the provisions of ISO 26322-1:2008, 4.4.1.2, apply.

4.4.1.3 Handrails/handholds

For handrails/handholds, the provisions of ISO 26322-1:2008, 4.4.1.3, apply.

4.4.2 Operator's workplace

4.4.2.1 The operator's workplace, access and exit dimensions shall be in accordance with ISO 4252, except for Table 1, whose values shall be replaced by the values given in Table 1 below.

Table 1 — Minimum internal clearance dimensions

Distance	Minimum dimension mm
Distance from a point 90 mm below and $(140 + a_h)$ mm behind the seat index point (SIP) to any part of the cab ceiling surface, above, forward and to either side of the operator's head ^a	940 ^c
Distance from the SIP to the cabin back wall at a height between 210 mm above the SIP and the roof contour defined by the 910 mm radius and the 150 mm blend radius	$260 + a_h$
Lateral clearance at any distance between 310 mm above the SIP and the roof contour defined by the 910 mm radius, perpendicular to the vertical reference plane for a distance of $(310 + a_h)$ mm forward and $(140 + a_h)$ mm rearward from the SIP	350
Distance from the outer side of the steering-wheel rim to the cabin surface or other hand controls ^b	50
<p>^a Soft materials such as padding may penetrate into the free space up to a maximum of 50 mm.</p> <p>^b Excluding hand controls mounted on the steering column.</p> <p>^c It is intended that, at the next revision of this part of ISO 26322, this value be further evaluated, taking into consideration the development of the physical dimensions of operators and the operating environment of these tractors.</p>	

4.4.2.2 There shall be no shearing or crushing points within hand or foot reach of the operator when seated in the seat provided.

4.4.2.3 The foot reach of the operator is defined by a hemisphere of 800 mm radius centred on the seat centreline at the front edge of the cushion and extending downwards, with the seat in its central position.

The hand reach of the operator is divided into spherical volumes A and B, as shown in Figure 1. The spherical centre point of the volumes is located 60 mm in front and 580 mm above the SIP, as defined in ISO 5353 and indicated in Figure 1. Volume A is formed by a spherical radius of 550 mm, volume B is the volume between this radius and a spherical radius of 1 000 mm.

Within volume A, a minimum clearance of 120 mm between power and inertia-operated, and other adjacent parts, shall be maintained. Within volume B, a minimum clearance of 25 mm shall be maintained. Within both volumes, a minimum angle of 30° shall be maintained where parts shear against each other.

The hand and foot reach for tractors equipped with a cabin is limited to those portions of the volumes specified, lying within the cab.

These requirements do not apply to any points behind a plane located at an angle of 45° to the rear and running transverse to the travel direction through a point located 230 mm behind the SIP (see Figure 1).

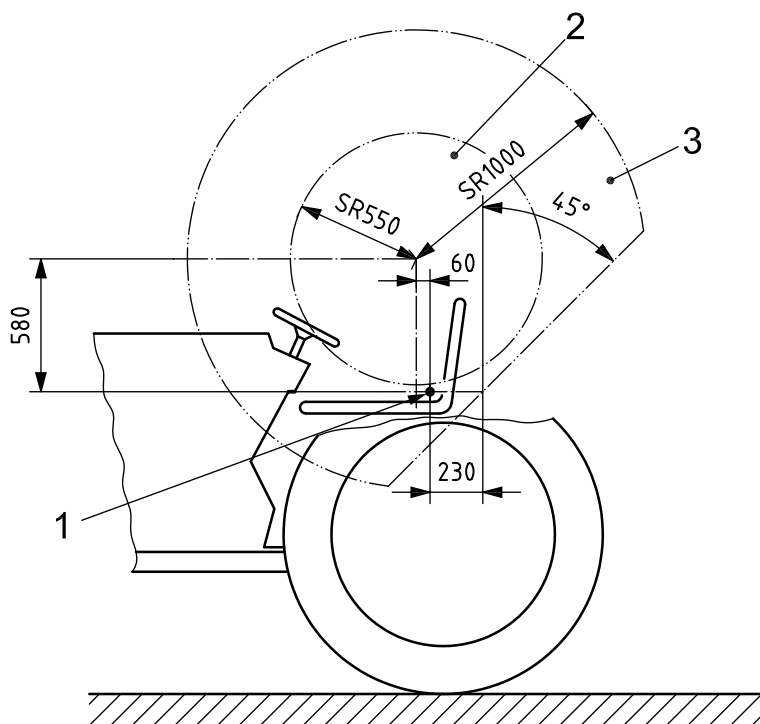

Key

- 1 SIP
- 2 volume A
- 3 volume B

Figure 1 — Operator's hand reach

4.4.3 Operator's seat

A seat shall be provided which will adequately support the operator in all working and operating modes. Information on the seat adjustment shall be provided in the operator's manual. Additionally, two-point seat belts (lap belts) in accordance with ISO 3776-1, ISO 3776-2 and ISO 3776-3 shall be provided on narrow-track tractors.

4.4.4 Instructional seat

An instructional seat, if installed, shall be in accordance with ISO 23205. The exception to this is the case of small tractors without ROPS (roll-over protective structures), for which ISO 23205:2006, 4.7, does not apply.

4.4.5 Cab material burning rate

For the cab material burning rate, the provisions of ISO 26322-1:2008, 4.4.5, apply.

4.5 Power take-off (PTO)

Rear-mounted PTOs shall be in accordance with ISO 500-1 or ISO 500-2, as declared by the manufacturer. Front-mounted PTOs shall be in accordance with ISO 8759-1. Additionally, any components of the tractor that transmit power to the PTO, that are not addressed in ISO 500-1, ISO 500-2 or ISO 8759-1, shall be guarded by location (see ISO 26322-1:2008, 4.1.2), safety distances or with guard(s).

4.6 Strength requirements for guards and barriers

For the strength of guards and barriers, the provisions of ISO 26322-1:2008, 4.6, apply.

4.7 Electrical equipment

For electrical equipment, the provisions of ISO 26322-1:2008, 4.7, apply.

4.8 Hydraulic components and fittings

For hydraulic components and fittings, the provisions of ISO 26322-1:2008, 4.8, apply.

4.9 Ballast weights

For ballast weights, the provisions of ISO 26322-1:2008, 4.9, apply.

4.10 Levelling adjustments — Rear and front linkages

For levelling adjustments of rear and front linkages, the provisions of ISO 26322-1:2008, 4.10, apply.

4.11 Fuel systems

For the fuel system, the provisions of ISO 26322-1:2008, 4.11, apply.

4.12 Roll-over protection

4.12.1 A roll-over protection system meeting the requirements of either ISO 12003-1 or ISO 12003-2 shall be installed on each tractor having an unladen mass greater than 600 kg.

4.12.2 In addition, the provisions of ISO 26322-1, 4.12.2, apply.

4.13 Falling objects protection

For falling objects protection, the provisions of ISO 26322-1, 4.13, apply.

4.14 Hot surfaces

For hot surfaces, the provisions of ISO 26322-1:2008, 4.14, apply.

4.15 Exhaust gases

For exhaust gases, the provisions of ISO 26322-1:2008, 4.15, apply.

5 Information for use

5.1 Operator's manual

For the operator's manual, the provisions of ISO 26322-1:2008, 5.1, apply.

5.2 Safety and instructional signs

For safety and instructional signs, the provisions of ISO 26322-1:2008, 5.2, apply.

ICS 65.060.10

Price based on 5 pages

British Standards Institution (BSI)

BSI is the independent national body responsible for preparing British Standards and other standards-related publications, information and services.

It presents the UK view on standards in Europe and at the international level.

It is incorporated by Royal Charter.

Revisions

British Standards are updated by amendment or revision. Users of British Standards should make sure that they possess the latest amendments or editions.

It is the constant aim of BSI to improve the quality of our products and services. We would be grateful if anyone finding an inaccuracy or ambiguity while using this British Standard would inform the Secretary of the technical committee responsible, the identity of which can be found on the inside front cover.

Tel: +44 (0)20 8996 9001 Fax: +44 (0)20 8996 7001

BSI offers Members an individual updating service called PLUS which ensures that subscribers automatically receive the latest editions of standards.

Tel: +44 (0)20 8996 7669 Fax: +44 (0)20 8996 7001

Email: plus@bsigroup.com

Buying standards

You may buy PDF and hard copy versions of standards directly using a credit card from the BSI Shop on the website www.bsigroup.com/shop. In addition all orders for BSI, international and foreign standards publications can be addressed to BSI Customer Services.

Tel: +44 (0)20 8996 9001 Fax: +44 (0)20 8996 7001

Email: orders@bsigroup.com

In response to orders for international standards, it is BSI policy to supply the BSI implementation of those that have been published as British Standards, unless otherwise requested.

Information on standards

BSI provides a wide range of information on national, European and international standards through its Knowledge Centre.

Tel: +44 (0)20 8996 7004 Fax: +44 (0)20 8996 7005

Email: knowledgecentre@bsigroup.com

Various BSI electronic information services are also available which give details on all its products and services.

Tel: +44 (0)20 8996 7111 Fax: +44 (0)20 8996 7048

Email: info@bsigroup.com

BSI Subscribing Members are kept up to date with standards developments and receive substantial discounts on the purchase price of standards. For details of these and other benefits contact Membership Administration.

Tel: +44 (0)20 8996 7002 Fax: +44 (0)20 8996 7001

Email: membership@bsigroup.com

Information regarding online access to British Standards via British Standards Online can be found at www.bsigroup.com/BSOL

Further information about BSI is available on the BSI website at www.bsigroup.com/standards

Copyright

Copyright subsists in all BSI publications. BSI also holds the copyright, in the UK, of the publications of the international standardization bodies. Except as permitted under the Copyright, Designs and Patents Act 1988 no extract may be reproduced, stored in a retrieval system or transmitted in any form or by any means – electronic, photocopying, recording or otherwise – without prior written permission from BSI. This does not preclude the free use, in the course of implementing the standard of necessary details such as symbols, and size, type or grade designations. If these details are to be used for any other purpose than implementation then the prior written permission of BSI must be obtained. Details and advice can be obtained from the Copyright & Licensing Manager.

Tel: +44 (0)20 8996 7070

Email: copyright@bsigroup.com

BSI Group Headquarters

389 Chiswick High Road London W4 4AL UK

Tel +44 (0)20 8996 9001

Fax +44 (0)20 8996 7001

www.bsigroup.com/standards

raising standards worldwide™

