



BSI Standards Publication

Fine ceramics (advanced ceramics, advanced technical ceramics) — Methods of test for reinforcements — Determination of tensile properties of filaments at ambient temperature

National foreword

This British Standard is the UK implementation of ISO 19630:2017.

The UK participation in its preparation was entrusted to Technical Committee RPI/13, Advanced technical ceramics.

A list of organizations represented on this committee can be obtained on request to its secretary.

This publication does not purport to include all the necessary provisions of a contract. Users are responsible for its correct application.

© The British Standards Institution 2017
Published by BSI Standards Limited 2017

ISBN 978 0 580 86687 6

ICS 81.060.30

Compliance with a British Standard cannot confer immunity from legal obligations.

This British Standard was published under the authority of the Standards Policy and Strategy Committee on 31 July 2017.

Amendments/corrigenda issued since publication

Date	Text affected
------	---------------

INTERNATIONAL
STANDARD

ISO
19630

First edition
2017-07

**Fine ceramics (advanced ceramics,
advanced technical ceramics) —
Methods of test for reinforcements —
Determination of tensile properties of
filaments at ambient temperature**

*Céramiques techniques — Méthodes d'essai pour renforts —
Détermination des propriétés en traction du filament à température
ambiante*



Reference number
ISO 19630:2017(E)



COPYRIGHT PROTECTED DOCUMENT

© ISO 2017, Published in Switzerland

All rights reserved. Unless otherwise specified, no part of this publication may be reproduced or utilized otherwise in any form or by any means, electronic or mechanical, including photocopying, or posting on the internet or an intranet, without prior written permission. Permission can be requested from either ISO at the address below or ISO's member body in the country of the requester.

ISO copyright office
Ch. de Blandonnet 8 • CP 401
CH-1214 Vernier, Geneva, Switzerland
Tel. +41 22 749 01 11
Fax +41 22 749 09 47
copyright@iso.org
www.iso.org

Contents

Page

Foreword	iv
1 Scope	1
2 Normative references	1
3 Terms, definitions and symbols	1
4 Principle	3
5 Apparatus	3
6 Test specimens	3
7 Test specimen preparation	3
8 Number of test specimens	5
9 Test procedure	5
9.1 Displacement rate.....	5
9.2 Determination of the gauge length.....	5
9.3 Determination of the initial cross-section area.....	5
9.4 Testing technique.....	5
9.4.1 General.....	5
9.4.2 Load cell.....	5
9.4.3 Test specimen mounting.....	5
9.4.4 Measurements.....	6
9.4.5 Test validity.....	6
10 Calculation of results	6
10.1 Tensile strength.....	6
10.1.1 Determination of maximum tensile force.....	6
10.1.2 Calculation of tensile strength.....	6
10.2 Calculation of the load train compliance, C_1	6
10.3 Strain.....	7
10.4 Young modulus.....	8
10.5 Fracture strain.....	8
11 Test report	9
Bibliography	10

Foreword

ISO (the International Organization for Standardization) is a worldwide federation of national standards bodies (ISO member bodies). The work of preparing International Standards is normally carried out through ISO technical committees. Each member body interested in a subject for which a technical committee has been established has the right to be represented on that committee. International organizations, governmental and non-governmental, in liaison with ISO, also take part in the work. ISO collaborates closely with the International Electrotechnical Commission (IEC) on all matters of electrotechnical standardization.

The procedures used to develop this document and those intended for its further maintenance are described in the ISO/IEC Directives, Part 1. In particular the different approval criteria needed for the different types of ISO documents should be noted. This document was drafted in accordance with the editorial rules of the ISO/IEC Directives, Part 2 (see www.iso.org/directives).

Attention is drawn to the possibility that some of the elements of this document may be the subject of patent rights. ISO shall not be held responsible for identifying any or all such patent rights. Details of any patent rights identified during the development of the document will be in the Introduction and/or on the ISO list of patent declarations received (see www.iso.org/patents).

Any trade name used in this document is information given for the convenience of users and does not constitute an endorsement.

For an explanation on the voluntary nature of standards, the meaning of ISO specific terms and expressions related to conformity assessment, as well as information about ISO's adherence to the World Trade Organization (WTO) principles in the Technical Barriers to Trade (TBT) see the following URL: www.iso.org/iso/foreword.html.

This document was prepared by Technical Committee ISO/TC 206, *Fine ceramics*.

Fine ceramics (advanced ceramics, advanced technical ceramics) — Methods of test for reinforcements — Determination of tensile properties of filaments at ambient temperature

1 Scope

This document specifies the conditions for the determination of tensile properties of single filaments of ceramic fibre such as tensile strength, Young modulus and fracture strain. The method applies to continuous ceramic filaments taken from tows, yarns, braids and knittings, which have strain to fracture less than or equal to 5 %.

The method does not apply to carbon fibres that exhibit nonlinear stress-strain curve. The method does not apply to checking the homogeneity of strength properties of fibres, nor to assessing the effects of volume under stress. Statistical aspects of filament failure are not included.

2 Normative references

The following documents are referred to in the text in such a way that some or all of their content constitutes requirements of this document. For dated references, only the edition cited applies. For undated references, the latest edition of the referenced document (including any amendments) applies.

ISO 7500-1, *Metallic materials — Calibration and verification of static uniaxial testing machines — Part 1: Tension/compression testing machines — Calibration and verification of the force-measuring system*

ISO 19634, *Fine ceramics (advanced ceramics, advanced technical ceramics) — Ceramic composites — Notations and symbols*

ISO 20501, *Fine ceramics (advanced ceramics, advanced technical ceramics) — Weibull statistics for strength data*

EN 1007-1, *Advanced technical ceramics — Ceramic composites — Methods of test for reinforcements — Part 1: Determination of size content*

EN 1007-3, *Advanced technical ceramics — Ceramic composites — Methods of test for reinforcements — Part 3: Determination of filament diameter and cross-section area*

3 Terms, definitions and symbols

For the purposes of this document, the terms, definitions and symbols given in ISO 19634 and the following apply.

ISO and IEC maintain terminological databases for use in standardization at the following addresses:

— IEC Electropedia: available at <http://www.electropedia.org/>

— ISO Online browsing platform: available at <http://www.iso.org/obp>

3.1

gauge length

L_0

initial distance between two reference points on the filament

3.2
test specimen length

L_f
initial distance between the gripped ends of the filament

3.3
initial cross-section area

A_0
initial area of the cross section of the filament within the *gauge length* (3.1)

3.4
maximum tensile force

F_m
highest recorded tensile force on the test specimen when tested to failure

3.5
tensile stress

σ
tensile force supported by the test specimen divided by the *initial cross-section area* (3.3)

3.6
tensile strength

σ_m
ratio of the maximum tensile force to the *initial cross-section area* (3.3)

3.7
longitudinal deformation

ΔL
increase of the *gauge length* (3.1) during the tensile test

3.8
total compliance

C_t
inverse of the slope in the linear part of the tensile force-displacement curve

3.9
load train compliance

C_l
ratio of the cross-head displacement excluding any test specimen contribution to the corresponding force during the tensile test

3.10
strain

ε
ratio of the *longitudinal deformation* (3.7) to the *gauge length* (3.1)

3.11
fracture strain

ε_m
strain at failure of the test specimen

3.12
Young modulus

E
slope of the linear part of the tensile stress-strain curve

3.13
elementary unit

smallest commercially available unit of a given product

Note 1 to entry: For fibre, this is usually a spool.

4 Principle

A ceramic filament is loaded in tension. The test is performed at constant displacement rate up to failure. Force and cross-head displacement are measured and recorded simultaneously. When required, the longitudinal deformation is derived from the cross-head displacement using a compliance correction.

5 Apparatus

5.1 Test machine, which shall be equipped with a system for measuring the force applied to the test specimen which shall conform to grade 1 according to ISO 7500-1. Additionally, the machine shall be equipped with a system for measuring the cross-head displacement with accuracy better than 1 μm .

5.2 Load train, in which the grips shall align the test specimen with the direction of the force. Slippage of the filament in the grips shall be prevented.

5.3 Adhesive, such as epoxy resin or sealing wax, for fixing the filament ends to the grip.

5.4 Data recording system, which, when calibrated, may be used to record force-displacement curves. The use of a digital data recording system is recommended.

6 Test specimens

Specimens with a gauge length of 25 mm shall be used to establish the force-displacement curves.

Specimens with a gauge length of 10 mm and 50 mm shall be used to determine the load train compliance, C_1 .

The tolerance on the gauge length is ± 1 mm.

7 Test specimen preparation

Extreme care shall be taken during test specimen preparation to ensure that the procedure is repeatable from test specimen to test specimen and to avoid handling damage.

NOTE 1 The introduction of damage during test specimen preparation may result in the weakening of the filament.

During test specimen preparation, and in particular when extracting a filament from the tow, the ratio of the amount of damaged filaments to the total number of extracted filaments should be minimized.

NOTE 2 An example of a device to prevent damage during test specimen manipulation and mounting is shown in [Figure 1](#). This test specimen preparation uses a window tab of thin paper, metal or plastic cut. The length of the window is equal to the gauge length of the filament test specimen. A suitable adhesive, such as epoxy resin, cement or sealing wax, is used for affixing the filament to the ends of the mounting tab.

NOTE 3 Another device that can be used to prevent damage during test specimen manipulation and mounting is shown in [Figure 2](#).

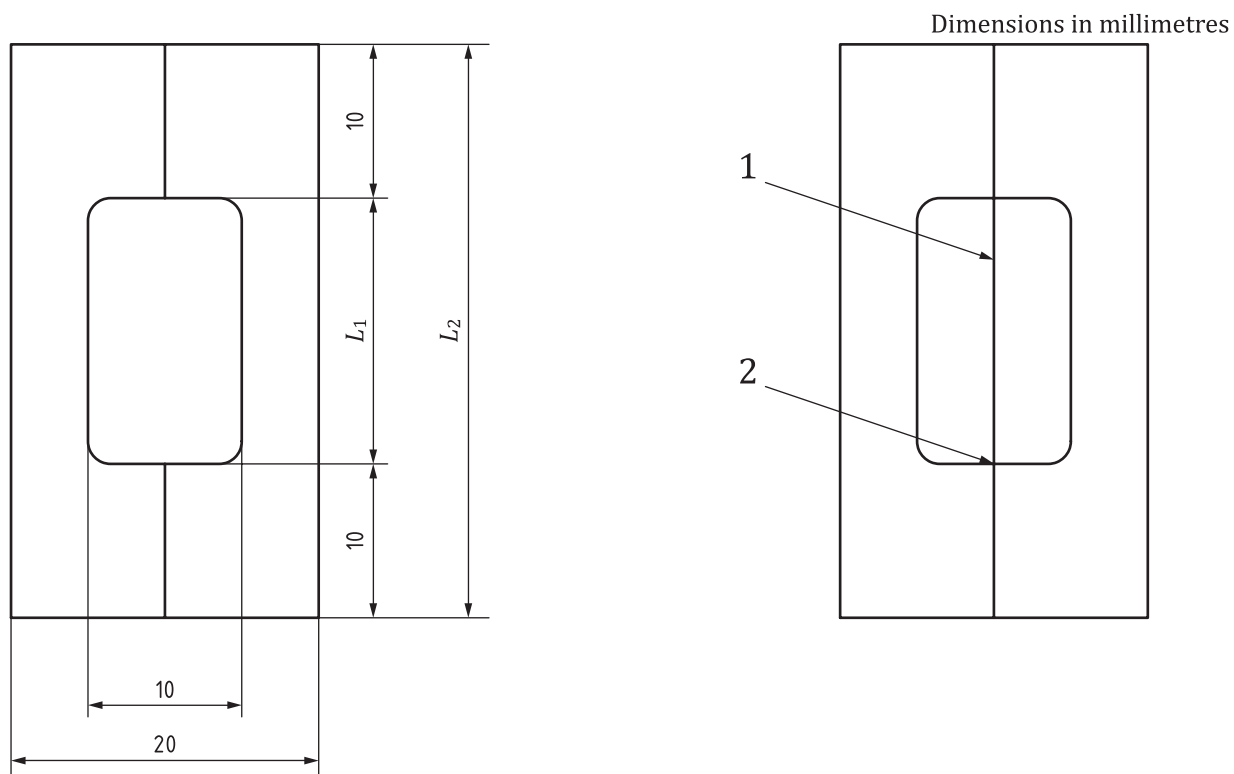

Key

- 1 filament
- 2 glue

L_1	L_2
$10 \pm 0,5$	30 ± 1
$25 \pm 0,5$	45 ± 1
$50 \pm 0,5$	70 ± 1

Figure 1 — Assembly of a test specimen

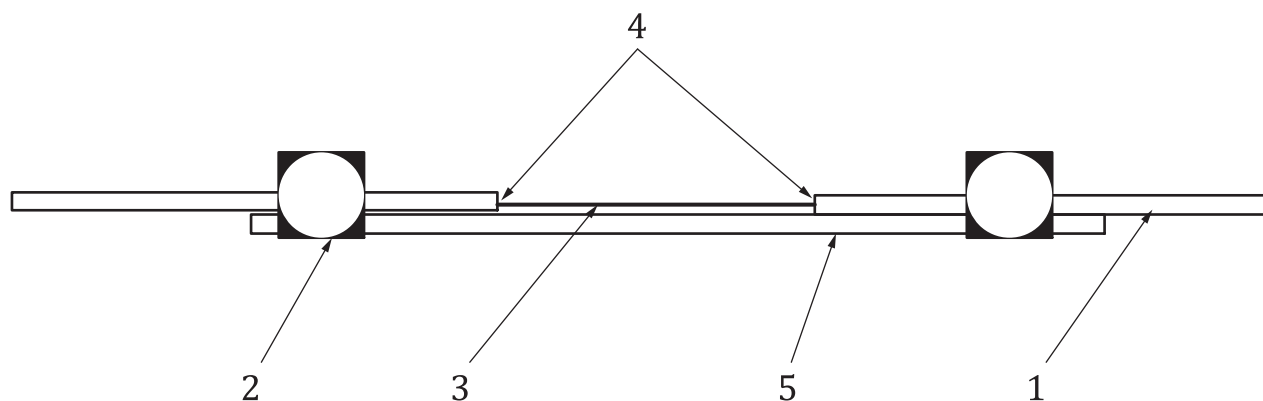

Key

- 1 alumina tubes
- 2 temporary screw attachment
- 3 test specimen
- 4 ceramic cement
- 5 alumina rod

Figure 2 — Alternative assembly of a test specimen

8 Number of test specimens

Prepare at least 20 test specimens from each elementary unit to enable 20 measurements to be made.

Removal of any size present makes it easier to prepare good specimens. The size shall be removed in accordance with EN 1007-1.

For the determination of strain-related properties, three additional tests at each gauge length of 10 mm and 50 mm are required in order to establish load train compliance, C_1 .

If a statistical evaluation is required, the number of test specimens at a gauge length of 25 mm shall be in accordance with ISO 20501.

NOTE Compliance determination is not required if only strength needs to be determined.

9 Test procedure

9.1 Displacement rate

A displacement rate that allows specimen rupture within 1 min shall be used.

The displacement rate and the loading mode shall be reported.

9.2 Determination of the gauge length

The gauge length is measured to an accuracy of $\pm 0,1$ mm.

9.3 Determination of the initial cross-section area

The initial cross-section area is measured in accordance with EN 1007-3.

NOTE In principle, the initial cross-section area is to be determined on the filament to be tested. In practice, this can be achieved by sampling the lengths to be tested from a single filament at intermittent locations and using the parts in between for cross-section measurement. This assumes that for the lengths of filament to be tested, the cross section does not vary significantly with the length.

An alternative method consists of measuring the filament cross section after fracture from a transverse cross section taken from the part of the grips still containing embedded filament. In this case, care has to be taken not to damage the filament during preparation and handling.

9.4 Testing technique

9.4.1 General

Perform the following steps in a sequential order.

9.4.2 Load cell

Zero the load cell.

9.4.3 Test specimen mounting

Mount the specimen in the load train with its longitudinal axis coinciding with that of the test machine. Care shall be taken not to induce torsional loads or surface damage to the filament. Before applying the load, i.e. with the mounting unstrained, cut or burn through both sides of the window tab at mid-gauge. If burning is used, care shall be taken to avoid exposing the specimen to the flame. As the filament is very fragile, the test specimen breaks occasionally during this step.

9.4.4 Measurements

- Set the cross-head speed.
- Record the force versus cross-head displacement curve up to failure.

9.4.5 Test validity

The following circumstances invalidate a test:

- failure to specify and record test conditions;
- any slippage in the load train as evidenced by a drop in the force/displacement curve, before reaching the maximum tensile force;
- fracture strain exceeding 5 %.

Failure exactly at the mounting tabs invalidates only the determination of the strength and strain to failure.

10 Calculation of results

10.1 Tensile strength

10.1.1 Determination of maximum tensile force

The maximum tensile force on the test specimen, F_m , is obtained from the maximum force value taken from the force versus displacement graph.

10.1.2 Calculation of tensile strength

Calculate the tensile strength using [Formula \(1\)](#):

$$\sigma_m = F_m/A_0 \quad (1)$$

where

σ_m is the filament strength, in megapascals (MPa);

F_m is the maximum tensile force, in newtons (N);

A_0 is the initial cross-section area, in square millimetres (mm²).

Calculate the error or uncertainty using [Formula \(2\)](#):

$$\Delta\sigma_m/\sigma_m = \Delta F_m/F_m + \Delta A_0/A_0 \quad (2)$$

10.2 Calculation of the load train compliance, C_l

Calculate the total compliance, C_t , for the tests performed for all the gauge lengths as the inverse slope of the linear part of the force/cross-head displacement curve. The total compliances, C_t , of all the specimens are plotted against L_0/A_0 . A best-fit line is determined by linear regression analysis of C_t versus L_0/A_0 . Determine the load train compliance, C_l , from the intercept with the ordinate axis (see [Figure 3](#)).

The error or uncertainty in the specimen compliance, $C = C_t - C_1$, is calculated as shown in [Formula \(3\)](#):

$$\Delta C/C = \Delta F/F + \Delta(\Delta L_0)/\Delta L_0 \quad (3)$$

where

ΔL_0 is the filament longitudinal deformation, in millimetres (mm);

F is the tensile force, in newtons (N).

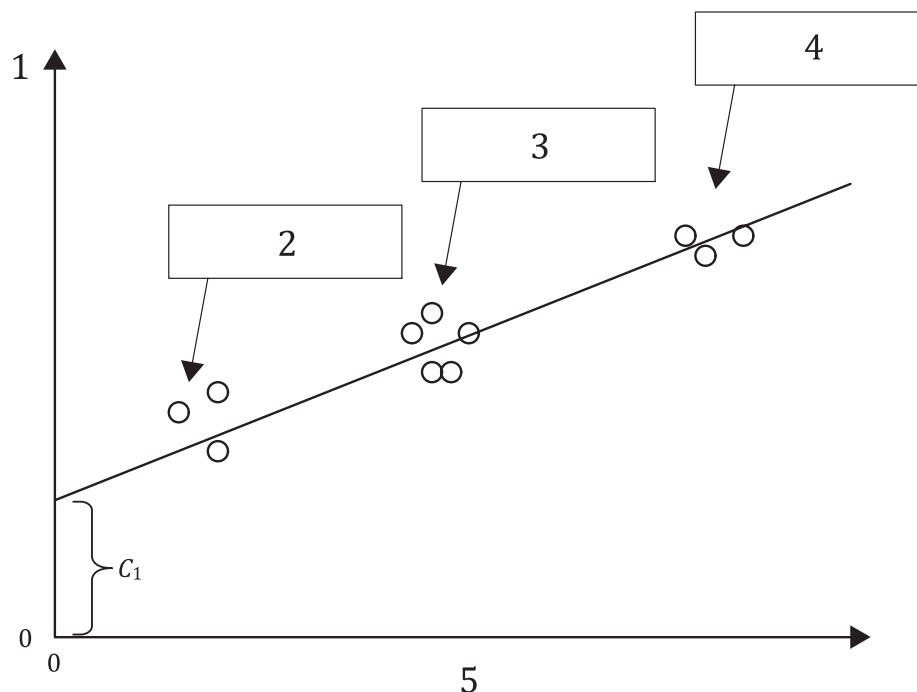

Key

- | | | | |
|---|--------------------------------|---|-------------------------------|
| 1 | total compliance, C_t (mm/N) | 4 | $L_0 = 50$ mm |
| 2 | $L_0 = 10$ mm | 5 | L_0/A_0 (mm ⁻¹) |
| 3 | $L_0 = 25$ mm | | |

Figure 3 — Plot of total compliance, C_t , versus ratio of gauge length to initial cross-section area, L_0/A_0

10.3 Strain

Strain-related parameters (strain, fracture strain, Young modulus) can only be determined when a linear part is present in the force/cross-head displacement curve, either from the start of loading or after the initial slack has been taken up.

Calculate the strain of the test specimen using [Formula \(4\)](#):

$$\varepsilon = 10^2 F \cdot (C_t - C_1) / L_0 \quad (4)$$

where

- ε is the strain of the test specimen, in percent (%);
- F is the applied force, in newtons (N);
- C_t is the total compliance, in millimetres per newton ($\text{mm}\cdot\text{N}^{-1}$);
- C_l is the load train compliance, in millimetres per newton ($\text{mm}\cdot\text{N}^{-1}$);
- L_0 is the gauge length (equal to the test specimen length, L_f), in millimetres (mm).

Calculate the error or uncertainty in the measurement of strain using [Formula \(5\)](#):

$$\Delta\varepsilon/\varepsilon = \Delta F/F + \Delta C/C + \Delta L_0/L_0 \quad (5)$$

10.4 Young modulus

The Young modulus is given by the slope of the linear part in the stress-strain curve and calculated as shown in [Formula \(6\)](#):

$$E = \frac{L_0}{A_0} \frac{1}{(C_t - C_l)} 10^{-3} \quad (6)$$

where

- E is the Young modulus, in gigapascals (GPa);
- A_0 is the initial cross-section area, in square millimetres (mm^2);
- C_l is the load train compliance, in millimetres per newton ($\text{mm}\cdot\text{N}^{-1}$);
- C_t is the total compliance, in millimetres per newton ($\text{mm}\cdot\text{N}^{-1}$);
- L_0 is the gauge length, in millimetres (mm).

The error or uncertainty in the measurements of Young's modulus is given as shown in [Formula \(7\)](#):

$$\Delta E/E = \Delta L_0/L_0 + \Delta C/C + \Delta A_0/A_0 \quad (7)$$

10.5 Fracture strain

The fracture strain, ε_m , is calculated from [Formula \(8\)](#):

$$\varepsilon_m = 10^2 F_m(C_t - C_l)/L_0 \quad (8)$$

where

- ε_m is the fracture strain of the test specimen, in percent (%);
- F_m is the maximum tensile force, in newtons (N);
- C_t is the total compliance, in millimetres per newton ($\text{mm}\cdot\text{N}^{-1}$);
- C_l is the load train compliance, in millimetres per newton ($\text{mm}\cdot\text{N}^{-1}$);
- L_0 is the gauge length (equal to the test specimen length, L_f), in millimetres (mm).

NOTE For linear elastic behaviour up to failure, the fracture strain can be obtained from:

$$\varepsilon_m = \sigma_m / (10E)$$

where

ε_m is the fracture strain of the test specimen, in percent (%);

σ_m is the filament strength, in megapascals (MPa);

E is the Young modulus, in gigapascals (GPa).

The error or uncertainty in fracture strain is given by [Formula \(9\)](#):

$$\Delta\varepsilon_\mu/\varepsilon_\mu = \Delta F_m/F_m + \Delta C/C + \Delta L_0/L_0 \quad (9)$$

11 Test report

The test report shall contain at least the following information:

- a) the name and address of the testing establishment;
- b) the date of the test, unique identification of report and of each page, customer's and signatory's name and address;
- c) a reference to this document, i.e. determined in accordance with ISO 19630;
- d) a description of the equipment used;
- e) a complete identification of the tested filament (manufacturer, type, batch, sampling location, date of receipt, etc.);
- f) the method employed for the determination of the filament initial cross-section area;
- g) for each test specimen, the gauge length expressed in millimetres;
- h) the displacement rate;
- i) where applicable, the load train compliance and the graph of total compliance versus gauge length divided by initial cross-section area;
- j) individual values and average value of tensile strength and, where applicable, fracture strain and elastic modulus, as well as values of uncertainties;
- k) the number of tests carried out and the number of valid results obtained;
- l) details of any aspect of the experimental procedure which might influence the results, in particular for each tested length, the ratio of the number of prepared test specimens to the total number of extracted filaments;
- m) comments on the test or test results.

Bibliography

- [1] EN 843-5, *Advanced technical ceramics — Mechanical properties of monolithic ceramics at room temperature — Statistical analysis*
- [2] EN 1007-6, *Advanced technical ceramics — Ceramic composites — Methods of test for reinforcements — Part 6: Determination of tensile properties of filaments at high temperature*

British Standards Institution (BSI)

BSI is the national body responsible for preparing British Standards and other standards-related publications, information and services.

BSI is incorporated by Royal Charter. British Standards and other standardization products are published by BSI Standards Limited.

About us

We bring together business, industry, government, consumers, innovators and others to shape their combined experience and expertise into standards-based solutions.

The knowledge embodied in our standards has been carefully assembled in a dependable format and refined through our open consultation process. Organizations of all sizes and across all sectors choose standards to help them achieve their goals.

Information on standards

We can provide you with the knowledge that your organization needs to succeed. Find out more about British Standards by visiting our website at bsigroup.com/standards or contacting our Customer Services team or Knowledge Centre.

Buying standards

You can buy and download PDF versions of BSI publications, including British and adopted European and international standards, through our website at bsigroup.com/shop, where hard copies can also be purchased.

If you need international and foreign standards from other Standards Development Organizations, hard copies can be ordered from our Customer Services team.

Copyright in BSI publications

All the content in BSI publications, including British Standards, is the property of and copyrighted by BSI or some person or entity that owns copyright in the information used (such as the international standardization bodies) and has formally licensed such information to BSI for commercial publication and use.

Save for the provisions below, you may not transfer, share or disseminate any portion of the standard to any other person. You may not adapt, distribute, commercially exploit, or publicly display the standard or any portion thereof in any manner whatsoever without BSI's prior written consent.

Storing and using standards

Standards purchased in soft copy format:

- A British Standard purchased in soft copy format is licensed to a sole named user for personal or internal company use only.
- The standard may be stored on more than 1 device provided that it is accessible by the sole named user only and that only 1 copy is accessed at any one time.
- A single paper copy may be printed for personal or internal company use only.
- Standards purchased in hard copy format:
- A British Standard purchased in hard copy format is for personal or internal company use only.
- It may not be further reproduced – in any format – to create an additional copy. This includes scanning of the document.

If you need more than 1 copy of the document, or if you wish to share the document on an internal network, you can save money by choosing a subscription product (see 'Subscriptions').

Reproducing extracts

For permission to reproduce content from BSI publications contact the BSI Copyright & Licensing team.

Subscriptions

Our range of subscription services are designed to make using standards easier for you. For further information on our subscription products go to bsigroup.com/subscriptions.

With **British Standards Online (BSOL)** you'll have instant access to over 55,000 British and adopted European and international standards from your desktop. It's available 24/7 and is refreshed daily so you'll always be up to date.

You can keep in touch with standards developments and receive substantial discounts on the purchase price of standards, both in single copy and subscription format, by becoming a **BSI Subscribing Member**.

PLUS is an updating service exclusive to BSI Subscribing Members. You will automatically receive the latest hard copy of your standards when they're revised or replaced.

To find out more about becoming a BSI Subscribing Member and the benefits of membership, please visit bsigroup.com/shop.

With a **Multi-User Network Licence (MUNL)** you are able to host standards publications on your intranet. Licences can cover as few or as many users as you wish. With updates supplied as soon as they're available, you can be sure your documentation is current. For further information, email subscriptions@bsigroup.com.

Revisions

Our British Standards and other publications are updated by amendment or revision.

We continually improve the quality of our products and services to benefit your business. If you find an inaccuracy or ambiguity within a British Standard or other BSI publication please inform the Knowledge Centre.

Useful Contacts

Customer Services

Tel: +44 345 086 9001

Email (orders): orders@bsigroup.com

Email (enquiries): cservices@bsigroup.com

Subscriptions

Tel: +44 345 086 9001

Email: subscriptions@bsigroup.com

Knowledge Centre

Tel: +44 20 8996 7004

Email: knowledgecentre@bsigroup.com

Copyright & Licensing

Tel: +44 20 8996 7070

Email: copyright@bsigroup.com

BSI Group Headquarters

389 Chiswick High Road London W4 4AL UK