

**BS ISO 13976:2016**



**BSI Standards Publication**

# **Hot-rolled steel sheet in coils of structural quality and heavy thickness**

**National foreword**

This British Standard is the UK implementation of ISO 13976:2016. It supersedes BS ISO 13976:2005 which is withdrawn.

The UK participation in its preparation was entrusted to Technical Committee ISE/109, Coated and Uncoated Flat Products to be Used for Cold Forming.

A list of organizations represented on this committee can be obtained on request to its secretary.

This publication does not purport to include all the necessary provisions of a contract. Users are responsible for its correct application.

© The British Standards Institution 2016. Published by BSI Standards Limited 2016

ISBN 978 0 580 87940 1

ICS 77.140.50

**Compliance with a British Standard cannot confer immunity from legal obligations.**

This British Standard was published under the authority of the Standards Policy and Strategy Committee on 31 August 2016.

**Amendments issued since publication**

Date	Text affected
------	---------------

---

INTERNATIONAL  
STANDARD

BS ISO 13976:2016

**ISO**  
**13976**

Third edition  
2016-08-15

---

---

**Hot-rolled steel sheet in coils of  
structural quality and heavy thickness**

*Tôles fortes en acier de construction laminées à chaud en bobines*



Reference number  
ISO 13976:2016(E)

© ISO 2016



**COPYRIGHT PROTECTED DOCUMENT**

© ISO 2016, Published in Switzerland

All rights reserved. Unless otherwise specified, no part of this publication may be reproduced or utilized otherwise in any form or by any means, electronic or mechanical, including photocopying, or posting on the internet or an intranet, without prior written permission. Permission can be requested from either ISO at the address below or ISO's member body in the country of the requester.

ISO copyright office  
Ch. de Blandonnet 8 • CP 401  
CH-1214 Vernier, Geneva, Switzerland  
Tel. +41 22 749 01 11  
Fax +41 22 749 09 47  
copyright@iso.org  
www.iso.org

# Contents

Page

<b>Foreword</b> .....	<b>iv</b>
<b>1 Scope</b> .....	<b>1</b>
<b>2 Normative references</b> .....	<b>1</b>
<b>3 Terms and definitions</b> .....	<b>1</b>
<b>4 Dimensions</b> .....	<b>2</b>
<b>5 Conditions of manufacture</b> .....	<b>2</b>
5.1 Steelmaking.....	2
5.2 Chemical composition.....	2
5.3 Chemical analysis.....	3
5.3.1 Heat analysis.....	3
5.3.2 Product analysis.....	3
5.4 Mechanical properties.....	4
5.5 Application.....	4
5.6 Weldability.....	4
5.7 Surface condition.....	4
5.8 Oiling.....	4
5.9 Dimensional and shape tolerances.....	4
<b>6 Sampling — Tensile test</b> .....	<b>6</b>
<b>7 Test methods</b> .....	<b>6</b>
7.1 Tensile test.....	6
7.2 Impact test.....	6
<b>8 Retests</b> .....	<b>7</b>
8.1 Machining and flaws.....	7
8.2 Elongation.....	7
8.3 Additional tests.....	7
<b>9 Resubmission</b> .....	<b>7</b>
<b>10 Workmanship</b> .....	<b>7</b>
<b>11 Inspection and acceptance</b> .....	<b>7</b>
<b>12 Coil size</b> .....	<b>7</b>
<b>13 Marking</b> .....	<b>8</b>
<b>14 Information to be supplied by the purchaser</b> .....	<b>8</b>
<b>Bibliography</b> .....	<b>9</b>

## Foreword

ISO (the International Organization for Standardization) is a worldwide federation of national standards bodies (ISO member bodies). The work of preparing International Standards is normally carried out through ISO technical committees. Each member body interested in a subject for which a technical committee has been established has the right to be represented on that committee. International organizations, governmental and non-governmental, in liaison with ISO, also take part in the work. ISO collaborates closely with the International Electrotechnical Commission (IEC) on all matters of electrotechnical standardization.

The procedures used to develop this document and those intended for its further maintenance are described in the ISO/IEC Directives, Part 1. In particular the different approval criteria needed for the different types of ISO documents should be noted. This document was drafted in accordance with the editorial rules of the ISO/IEC Directives, Part 2. [www.iso.org/directives](http://www.iso.org/directives)

Attention is drawn to the possibility that some of the elements of this document may be the subject of patent rights. ISO shall not be held responsible for identifying any or all such patent rights. Details of any patent rights identified during the development of the document will be in the Introduction and/or on the ISO list of patent declarations received. [www.iso.org/patents](http://www.iso.org/patents)

Any trade name used in this document is information given for the convenience of users and does not constitute an endorsement.

For an explanation on the meaning of ISO specific terms and expressions related to conformity assessment, as well as information about ISO's adherence to the World Trade Organization (WTO) principles in the Technical Barriers to Trade (TBT), see the following URL: <http://www.iso.org/iso/foreword.html>

The committee responsible for this document is ISO/TC 17, *Steel*, Subcommittee SC 12, *Continuous mill flat rolled products*.

This third edition cancels and replaces the second edition (ISO 13976:2005), which has been technically revised.

# Hot-rolled steel sheet in coils of structural quality and heavy thickness

## 1 Scope

This document applies to hot-rolled carbon/manganese steel sheet in coils of structural quality without the use of microalloying elements. It is generally used in the delivered condition and is intended for bolted, riveted or welded structures. The product is produced on a wide sheet mill.

The product is intended for structural purposes where particular mechanical properties are required.

The steel sheet is produced in a number of grade designations designed to be compatible with differing application requirements.

This document does not cover steels intended for boilers or pressure vessels, or steels designated as commercial quality or drawing qualities, or steels rolled to cold-reduced products, or steels designated as weathering steels, having increased atmospheric corrosion resistance, or those products rolled on a plate mill.

## 2 Normative references

The following documents are referred to in the text in such a way that some or all of their content constitutes requirements of this document. For dated references, only the edition cited applies. For undated references, the latest edition of the referenced document (including any amendments) applies.

ISO 148-1, *Metallic materials — Charpy pendulum impact test — Part 1: Test method*

ISO 6892-1, *Metallic materials — Tensile testing — Part 1: Method of test at room temperature*

## 3 Terms and definitions

For the purposes of this document, the following terms and definitions apply.

ISO and IEC maintain terminological databases for use in standardization at the following addresses:

- IEC Electropedia: available at <http://www.electropedia.org/>
- ISO Online browsing platform: available at <http://www.iso.org/obp>

### 3.1

#### microalloying elements

elements such as niobium, vanadium, titanium, etc., added singly or in combination to obtain higher strength levels combined with better formability, weldability and toughness as compared with non-alloyed steel produced to equivalent strength levels

### 3.2

#### hot-rolled steel sheet in coils

steel sheet in coil form manufactured through hot-rolling process where the material was heated before rolling to achieve the required sheet thickness and tolerances

Note 1 to entry: The product has a surface covered with oxide or scale resulting from the hot-rolling operation.

### 3.3 **hot-rolled descaled steel sheet in coils**

hot-rolled steel sheet from the surface of which oxide or scale has been removed, commonly by pickling in an acid solution

Note 1 to entry: Descaling can also be performed by mechanical means such as grit blasting. Some increase in hardness and some loss of ductility can result from descaling.

Note 2 to entry: This product is normally supplied oiled.

### 3.4 **mill edge**

normal edge produced without any definite contour produced in hot-rolling

Note 1 to entry: Mill edges can contain some irregularities such as cracked or torn edges on thin (feathered) edges.

### 3.5 **sheared edge**

normal edge obtained by shearing, slitting or trimming a mill edge product

Note 1 to entry: Normal processing does not necessarily provide a definite positioning of the slitting burr.

### 3.6 **lot**

50 t or less of steel sheet of the same grade rolled to the same thickness and condition

### 3.7 **edge camber**

edge camber is the greatest deviation of a side from a straight line, the measurement being taken on the concave side with a straight edge

## 4 Dimensions

Hot-rolled steel sheet in coils of structural quality and heavy thickness is produced in the range of thicknesses greater than 6 mm to 25 mm, and widths of 600 mm and over, in coils.

## 5 Conditions of manufacture

### 5.1 Steelmaking

Unless otherwise agreed upon by the interested parties, the processes used in making the steel and in manufacturing hot-rolled sheet are left to the discretion of the manufacturer. On request, the purchaser shall be informed of the steelmaking process being used.

### 5.2 Chemical composition

The chemical composition (heat analysis) shall conform to the requirements given in [Tables 1](#) and [2](#).



**Table 1 — Chemical composition (heat analysis)**

Mass fractions in percent

Grade	C max.	Mn max.	P max.	S max.	Si max.	N max.
HR185	0,16	1,5	0,030	0,035	0,40	0,015
HR235	0,18	1,5	0,030	0,035	0,40	0,015
HR275	0,18	1,5	0,030	0,035	0,40	0,015
HR295	0,21	1,5	0,030	0,035	0,55	0,015
HR325	0,18	1,6	0,030	0,035	0,55	0,015
HR355	0,22	1,5	0,030	0,035	0,55	0,015

**Table 2 — Limits on additional chemical elements**

Mass fractions in percent

Element	Cu <sup>a</sup> max.	Ni <sup>a</sup> max.	Cr <sup>ab</sup> max.	Mo <sup>ab</sup> max.	Nb max.	V <sup>c</sup> max.	Ti max.
Heat analysis	0,20	0,20	0,15	0,06	0,008	0,008 <sup>c</sup>	0,008
Product analysis	0,23	0,23	0,19	0,07	0,018	0,018	0,018

<sup>a</sup> The sum of copper, nickel, chromium and molybdenum shall not exceed 0,50 % on the heat analysis. When one or more of these elements is specified, the sum does not apply, in which case only the individual limits on the remaining elements will apply.

<sup>b</sup> The sum of chromium and molybdenum shall not exceed 0,16 % on heat analysis. When one or more of these elements is specified, the sum does not apply, in which case, only the individual limits on the remaining elements will apply.

<sup>c</sup> Where residual V levels greater than 0,008 % occur due to high levels of V in natural ores, such material may be supplied after agreement between the manufacturer and purchaser.

## 5.3 Chemical analysis

### 5.3.1 Heat analysis

An analysis of each heat shall be made by the manufacturer in order to determine compliance with the requirements given in [Tables 1](#) and [2](#). On request, a report of the heat analysis shall be made available to the purchaser or the purchaser's representative. Each of the elements listed in [Tables 1](#) and [2](#) shall be included in the report of the heat analysis. When the amount of copper, nickel, chromium or molybdenum present is less than 0,02 %, the analysis may be reported as "<0,02 %".

### 5.3.2 Product analysis

A product analysis may be made by the purchaser in order to verify the specified analysis of the product and shall take into consideration any normal heterogeneity. The product analysis tolerances shall be in accordance with [Tables 2](#) and [3](#).

**Table 3 — Product analysis tolerances**

Mass fractions in percent

Element	Maximum or range of specified element	Tolerance over maximum specified
C	> 0,15 to ≤ 0,22	0,04
Mn	> 1,15 to ≤ 1,6	0,05
P	≤ 0,030	0,010
S	≤ 0,035	0,010
Si	> 0,40 to ≤ 0,55	0,05
N	≤ 0,015	0,005

NOTE The above maximum tolerance is the allowable excess over the specified requirement and not the heat analysis. For example: for Grade HR295, the following product analysis values are within these tolerances: C 0,25 %, Mn 1,55 %, P 0,040 %, S 0,045 %, Si 0,60 %, N 0,020 %.

## 5.4 Mechanical properties

At the time that the steel is made available for shipment, the mechanical properties shall be as stated in [Table 4](#), when they are determined on test pieces obtained in accordance with the requirements in [Clause 7](#).

## 5.5 Application

It is desirable that the specified product be identified for fabrication by the name of the part or by the intended application.

Proper identification of the part may include visual examination, prints or description, or a combination of these.

## 5.6 Weldability

This product is normally suitable for welding when appropriate welding conditions are selected. For non-descaled steel, it may be necessary to remove the scale or oxide depending upon the welding method.

NOTE When the mass fraction of carbon exceeds 0,15 %, spot welding becomes increasingly difficult.

## 5.7 Surface condition

Designation AR describes the as-rolled condition. Oxide or scale on hot-rolled steel sheet is subject to variations in thickness, adherence and colour. Removal of the oxide or scale by pickling or blast cleaning may disclose surface imperfections not readily visible prior to this operation.

## 5.8 Oiling

Designation DO describes the descaled and oiled condition. As a deterrent to rusting, a coating of oil is usually applied to hot-rolled descaled steel sheet, but sheet may be furnished not oiled if required. The oil is not intended as a drawing or forming lubricant and shall be easily removable with degreasing chemicals. On request, the manufacturer shall advise the purchaser which type of oil has been used. Hot-rolled descaled steel sheet may be ordered not oiled, if required, in which case the supplier has limited responsibility if oxidation occurs.

NOTE If AR and DO are omitted, it means that the delivery will be as-rolled.

## 5.9 Dimensional and shape tolerances

**5.9.1** Dimensional and shape tolerances applicable to hot-rolled steel sheet in coils of structural quality heavy thickness shall be as specified in [Tables 5](#) and [6](#). These tolerances also apply to descaled material.

5.9.2 Edge camber shall not exceed 25 mm in any 5 000 mm of length (see [Figure 1](#)).

**Table 4 — Mechanical properties**

Grade	$R_e^a$ min. MPa <sup>c</sup>	$R_m$ min. MPa <sup>c</sup>	$A^b$ min, %			
			$L_o = 5,65\sqrt{S_o}$	$L_o = 50$ mm for sheet thickness		
				$6 < e \leq 12$ mm	$12 < e \leq 19$ mm	$19 < e \leq 25$ mm
HR185	185	290	19	20	23	26
HR235	235	400	19	20	23	26
HR275	275	410	16	17	20	22
HR295	295	470	15	16	19	21
HR325	325	490	15	16	19	21
HR355	355	490	15	16	19	21

$R_e$  = yield strength – can be either  $R_{eL}$  or  $R_{eH}$  not both;  
 $R_{eL}$  = lower yield strength,  $R_{eH}$  = high yield strength;  
 $R_m$  = tensile strength;  
 $A$  = percentage elongation after fracture;  
 $L_o$  = gauge length of original test piece;  
 $S_o$  = original cross-sectional area of gauge length;  
 $e$  = thickness of steel sheet, in millimetres.

<sup>a</sup> Either  $R_{eH}$  or  $R_{eL}$  shall be measured and either value shall meet the minimum requirement. The yield strength values can be measured by 0,5 % total elongation proof strength (proof strength under load) or by 0,2 % offset when a definite yield phenomenon is not present.

<sup>b</sup> In case of dispute, only the results obtained on a 50 mm test piece will be valid.

<sup>c</sup> 1 MPa = 1 N/mm<sup>2</sup>

**Table 5 — Thickness tolerances for heavy thickness hot-rolled sheet (including descaled) in coils**

Dimensions and tolerances in millimetres

Specified widths	Specified thicknesses <sup>a</sup>				
	$6,00 < e \leq 8,00$	$8,00 < e \leq 10,00$	$10,00 < e \leq 12,50$	$12,50 < e \leq 16,00$	$16,00 < e \leq 25,00$
$600 < w \leq 1\ 200$	±0,29	±0,32	±0,35	±0,38	±0,40
$1\ 200 < w \leq 1\ 500$	±0,30	±0,33	±0,36	±0,39	±0,42
$1\ 500 < w \leq 1\ 800$	±0,31	±0,34	±0,37	±0,40	±0,44
$w > 1\ 800$	±0,35	±0,40	±0,43	±0,48	±0,50

$w$  = width;  
 $e$  = thickness of steel sheet, in millimetres;

NOTE The values specified do not apply to the uncropped ends for a length,  $l$ , of a mill edge coil. The length,  $l$ , would be calculated using the following formula:

$$l = \frac{90}{e} \text{ metres}$$

provided that the result was not greater than 20 m inclusive of both ends.

<sup>a</sup> Thickness is measured at any point on the sheet not less than 40 mm from a side edge for mill edge material and not less than 25 mm from the edge for sheared edge material.

**Table 6 — Width tolerances for heavy thickness hot-rolled sheet in coils**

Dimensions and tolerances in millimetres

Specified widths	Mill edges		Sheared edges	
$\geq 600 < w \leq 1\,200$	+28	0	+5	0
$\geq 1\,200 < w \leq 1\,500$	+38	0	+6	0
$\geq 1\,500 < w \leq 1\,800$	+45	0	+8	0
$w > 1\,800$	+50	0	+10	0

w = width

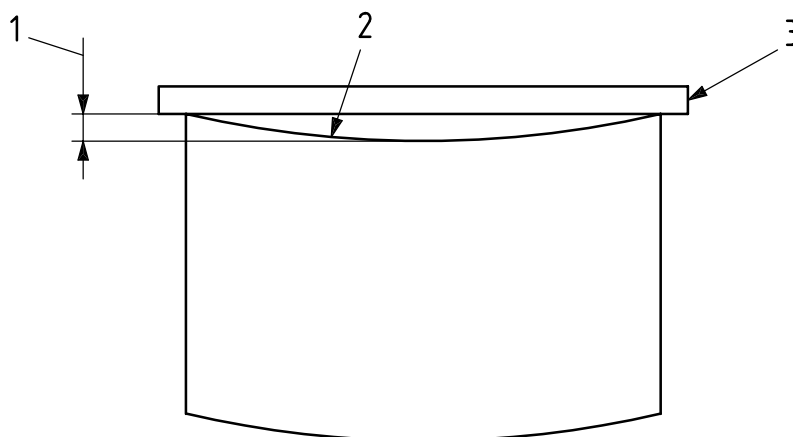

**Key**

- 1 edge camber
- 2 side edge (concave side)
- 3 straight edge

**Figure 1 — Measurement of edge camber**

## 6 Sampling — Tensile test

One representative transverse sample from each 50 t or less for shipment shall be taken for the tensile test to verify conformance to the requirements of [Table 4](#).

## 7 Test methods

### 7.1 Tensile test

The tensile test shall be conducted in accordance with the methods specified in ISO 6892-1. Transverse test pieces shall be taken midway between the centre and the edge of the as-rolled sheet.

### 7.2 Impact test

While not usually specified, if so agreed at the time of ordering, impact tests may be specified for material over 12,5 mm in thickness. The test piece shall be in the longitudinal direction and the test shall be carried out in accordance with ISO 148-1.

## 8 Retests

### 8.1 Machining and flaws

If any test piece shows defective machining or develops flaws, it shall be discarded and another test piece shall be substituted.

### 8.2 Elongation

On any tensile test, if any part of the fracture is outside the middle half of the gauge length as scribed before the test, the test shall be discarded and a retest carried out.

### 8.3 Additional tests

If any test does not give the specified results, two additional tests shall be conducted on samples selected at random from the same lot. Both retests shall conform to the requirements of document; otherwise the lot shall be rejected.

## 9 Resubmission

**9.1** The manufacturer has the right to resubmit, for acceptance, the products that have been rejected during earlier inspection because of unsatisfactory properties, after the rejected products have been subjected to a suitable treatment (e.g. selection, heat treatment, etc.) which, on request, will be indicated to the purchaser. In this case, tests shall be carried out as if they applied to a new lot.

**9.2** The manufacturer has the right to present the rejected products for re-examination for compliance with the requirements for another grade.

## 10 Workmanship

**10.1** The surface condition shall be that normally obtained for a hot-rolled product.

**10.2** Processing for shipment in coils does not afford the manufacturer the opportunity to observe readily or remove non-conforming portions, as is possible on cut length products. However, this does not relieve the manufacturer of responsibility to provide a product that meets the requirement for surface condition that is normally obtained on a hot-rolled product.

## 11 Inspection and acceptance

**11.1** Although not usually required for products covered by this document, when the purchaser specifies that inspection and tests for acceptance shall be observed prior to shipment from the manufacturer's works, the manufacturer shall afford the purchaser's inspector all reasonable facilities to determine that the steel is being furnished in accordance with this document.

**11.2** Steel that is reported to be non-conforming after arrival at the user's works shall be set aside, properly and correctly identified and adequately protected. The manufacturer shall be notified in order that the reported non-conforming material may be properly investigated.

## 12 Coil size

When ISO 13976 is ordered in coils. A minimum or range of acceptable inside diameter(s) (ID) or range of acceptable inside diameters shall be specified. In addition, the maximum outside diameter (OD) and the maximum acceptable coil mass shall be specified.

### 13 Marking

Unless otherwise stated, the following minimum requirements for identifying the steel sheet shall be legibly stenciled on the outside of each coil or shown on a tag attached to each coil or shipping unit:

- a) the manufacturer's name or identifying brand;
- b) a reference to this document, i.e. ISO 13976:2016;
- c) the grade designation;
- d) the order number;
- e) the product dimensions;
- f) the lot number;
- g) the mass;
- h) the coil number.

### 14 Information to be supplied by the purchaser

To specify requirements adequately according to this document, inquiries and orders shall include the following information:

- a) a reference to this document, i.e. ISO 13976:2016;
- b) the name and grade of the material (for example, hot-rolled steel sheet in coils, structural quality, grade HR275);
- c) the dimensions of the product and the quantity required;
- d) the application (name of part) when available (see [5.5](#));
- e) whether pickling or descaling by grit or shot blasting is required.

NOTE The material specified to be pickled or descaled will be oiled unless ordered unoled (see [3.3](#) and [5.8](#));

- f) the type of edge (see [3.4](#) and [3.5](#));
- g) whether cropped ends are required;
- h) the report of the heat analysis and mechanical properties, if required (see [5.4](#) and [5.3.1](#));
- i) limitations on masses and dimensions of individual coils if applicable (see [Clause 12](#));
- j) inspection and tests for acceptance prior to shipment from the manufacturer's works, if required (see [11.1](#)).

EXAMPLE A typical ordering description is as follows:

International Standard 13976:2016, hot-rolled steel sheet in coils, structural quality, heavy-thickness, grade HR275, 12 mm × 1 200 mm × coil, 40 000 kg, for a hinge part No 3 456, pickled, descaled and oiled (DO), mill edge, cropped, furnish report of mechanical properties, maximum coil 20 000 kg, coil ID 760 mm, maximum OD 1 850 mm.

## Bibliography

- [1] ASTM A1018, *M, Standard Specification for Steel, Sheet and Strip, Heavy-Thickness Coils, Hot-Rolled, Carbon, Commercial, Drawing, Structural, High-Strength Low-Alloy and High-Strength Low-Alloy with Improved Formability*<sup>1)</sup>

---

1) This standard is recognized by ISO/TC 17/SC 12 to cover a subject similar to that of this document. This information is given for the convenience of users of this document and constitutes neither an endorsement of the standard by TC 17/SC 12 or ISO, nor a statement regarding its degree of equivalence with this document.







# British Standards Institution (BSI)

BSI is the national body responsible for preparing British Standards and other standards-related publications, information and services.

BSI is incorporated by Royal Charter. British Standards and other standardization products are published by BSI Standards Limited.

## About us

We bring together business, industry, government, consumers, innovators and others to shape their combined experience and expertise into standards-based solutions.

The knowledge embodied in our standards has been carefully assembled in a dependable format and refined through our open consultation process. Organizations of all sizes and across all sectors choose standards to help them achieve their goals.

## Information on standards

We can provide you with the knowledge that your organization needs to succeed. Find out more about British Standards by visiting our website at [bsigroup.com/standards](http://bsigroup.com/standards) or contacting our Customer Services team or Knowledge Centre.

## Buying standards

You can buy and download PDF versions of BSI publications, including British and adopted European and international standards, through our website at [bsigroup.com/shop](http://bsigroup.com/shop), where hard copies can also be purchased.

If you need international and foreign standards from other Standards Development Organizations, hard copies can be ordered from our Customer Services team.

## Copyright in BSI publications

All the content in BSI publications, including British Standards, is the property of and copyrighted by BSI or some person or entity that owns copyright in the information used (such as the international standardization bodies) and has formally licensed such information to BSI for commercial publication and use.

Save for the provisions below, you may not transfer, share or disseminate any portion of the standard to any other person. You may not adapt, distribute, commercially exploit, or publicly display the standard or any portion thereof in any manner whatsoever without BSI's prior written consent.

## Storing and using standards

Standards purchased in soft copy format:

- A British Standard purchased in soft copy format is licensed to a sole named user for personal or internal company use only.
- The standard may be stored on more than 1 device provided that it is accessible by the sole named user only and that only 1 copy is accessed at any one time.
- A single paper copy may be printed for personal or internal company use only.

Standards purchased in hard copy format:

- A British Standard purchased in hard copy format is for personal or internal company use only.
- It may not be further reproduced – in any format – to create an additional copy. This includes scanning of the document.

If you need more than 1 copy of the document, or if you wish to share the document on an internal network, you can save money by choosing a subscription product (see 'Subscriptions').

## Reproducing extracts

For permission to reproduce content from BSI publications contact the BSI Copyright & Licensing team.

## Subscriptions

Our range of subscription services are designed to make using standards easier for you. For further information on our subscription products go to [bsigroup.com/subscriptions](http://bsigroup.com/subscriptions).

With **British Standards Online (BSOL)** you'll have instant access to over 55,000 British and adopted European and international standards from your desktop. It's available 24/7 and is refreshed daily so you'll always be up to date.

You can keep in touch with standards developments and receive substantial discounts on the purchase price of standards, both in single copy and subscription format, by becoming a **BSI Subscribing Member**.

**PLUS** is an updating service exclusive to BSI Subscribing Members. You will automatically receive the latest hard copy of your standards when they're revised or replaced.

To find out more about becoming a BSI Subscribing Member and the benefits of membership, please visit [bsigroup.com/shop](http://bsigroup.com/shop).

With a **Multi-User Network Licence (MUNL)** you are able to host standards publications on your intranet. Licences can cover as few or as many users as you wish. With updates supplied as soon as they're available, you can be sure your documentation is current. For further information, email [subscriptions@bsigroup.com](mailto:subscriptions@bsigroup.com).

## Revisions

Our British Standards and other publications are updated by amendment or revision.

We continually improve the quality of our products and services to benefit your business. If you find an inaccuracy or ambiguity within a British Standard or other BSI publication please inform the Knowledge Centre.

## Useful Contacts

### Customer Services

**Tel:** +44 345 086 9001

**Email (orders):** [orders@bsigroup.com](mailto:orders@bsigroup.com)

**Email (enquiries):** [cservices@bsigroup.com](mailto:cservices@bsigroup.com)

### Subscriptions

**Tel:** +44 345 086 9001

**Email:** [subscriptions@bsigroup.com](mailto:subscriptions@bsigroup.com)

### Knowledge Centre

**Tel:** +44 20 8996 7004

**Email:** [knowledgecentre@bsigroup.com](mailto:knowledgecentre@bsigroup.com)

### Copyright & Licensing

**Tel:** +44 20 8996 7070

**Email:** [copyright@bsigroup.com](mailto:copyright@bsigroup.com)

### BSI Group Headquarters

389 Chiswick High Road London W4 4AL UK