



BSI Standards Publication

Diesel engines — Steel tubes for high-pressure fuel injection pipes

Part 1: Requirements for seamless cold-drawn single-wall tubes

National foreword

This British Standard is the UK implementation of ISO 8535-1:2016. It supersedes BS ISO 8535-1:2011 which is withdrawn.

The UK participation in its preparation was entrusted to Technical Committee MCE/22, Engines for road vehicles.

A list of organizations represented on this committee can be obtained on request to its secretary.

This publication does not purport to include all the necessary provisions of a contract. Users are responsible for its correct application.

© The British Standards Institution 2016.
Published by BSI Standards Limited 2016

ISBN 978 0 580 93903 7

ICS 43.060.40; 77.140.75

Compliance with a British Standard cannot confer immunity from legal obligations.

This British Standard was published under the authority of the Standards Policy and Strategy Committee on 31 December 2016.

Amendments/corrigenda issued since publication

Date	Text affected
------	---------------

**Diesel engines — Steel tubes for high-
pressure fuel injection pipes —**

**Part 1:
Requirements for seamless cold-
drawn single-wall tubes**

*Moteurs diesels — Tubes en acier pour lignes d'injection de
combustible à haute pression —*

Partie 1: Exigences pour les tubes monoparoi sans soudure étirés à froid





COPYRIGHT PROTECTED DOCUMENT

© ISO 2016, Published in Switzerland

All rights reserved. Unless otherwise specified, no part of this publication may be reproduced or utilized otherwise in any form or by any means, electronic or mechanical, including photocopying, or posting on the internet or an intranet, without prior written permission. Permission can be requested from either ISO at the address below or ISO's member body in the country of the requester.

ISO copyright office
Ch. de Blandonnet 8 • CP 401
CH-1214 Vernier, Geneva, Switzerland
Tel. +41 22 749 01 11
Fax +41 22 749 09 47
copyright@iso.org
www.iso.org

Contents

	Page
Foreword	iv
1 Scope	1
2 Normative references	1
3 Terms and definitions	1
4 Dimensions and tolerances	1
4.1 Diameters.....	1
4.2 Length.....	2
5 Material processing	2
5.1 Steel manufacturing process.....	2
5.2 Manufacturing of tubes.....	2
5.3 Surface quality.....	4
5.3.1 General.....	4
5.3.2 Minimum quality inside surface (bore grade S).....	4
5.3.3 Higher quality inside surface (bore grades O, P, Q, R).....	4
5.4 Surface finish.....	4
5.5 Minimum mechanical properties of tubes.....	5
5.6 Cleanliness.....	5
5.7 Straightness.....	5
5.8 Corrosion resistance.....	5
6 Testing	5
6.1 General.....	5
6.2 Scope of tests.....	5
6.3 Dimension tests.....	6
6.4 Mechanical-property tests.....	6
6.5 Bending test.....	6
6.6 Cold upsetting of tubes.....	6
6.7 Surface quality test.....	6
6.8 Inside pressure test.....	6
6.9 Retesting.....	6
6.10 Test certificate.....	7
7 Designation	7
8 Identification and marking	8
9 Packing	8
Annex A (informative) Theoretical maximum pressure for inside pressure testing	9
Bibliography	10

Foreword

ISO (the International Organization for Standardization) is a worldwide federation of national standards bodies (ISO member bodies). The work of preparing International Standards is normally carried out through ISO technical committees. Each member body interested in a subject for which a technical committee has been established has the right to be represented on that committee. International organizations, governmental and non-governmental, in liaison with ISO, also take part in the work. ISO collaborates closely with the International Electrotechnical Commission (IEC) on all matters of electrotechnical standardization.

The procedures used to develop this document and those intended for its further maintenance are described in the ISO/IEC Directives, Part 1. In particular the different approval criteria needed for the different types of ISO documents should be noted. This document was drafted in accordance with the editorial rules of the ISO/IEC Directives, Part 2 (see www.iso.org/directives).

Attention is drawn to the possibility that some of the elements of this document may be the subject of patent rights. ISO shall not be held responsible for identifying any or all such patent rights. Details of any patent rights identified during the development of the document will be in the Introduction and/or on the ISO list of patent declarations received (see www.iso.org/patents).

Any trade name used in this document is information given for the convenience of users and does not constitute an endorsement.

For an explanation on the meaning of ISO specific terms and expressions related to conformity assessment, as well as information about ISO's adherence to the World Trade Organization (WTO) principles in the Technical Barriers to Trade (TBT) see the following URL: www.iso.org/iso/foreword.html.

The committee responsible for this document is ISO/TC 22, *Road vehicles*, Subcommittee SC 34, *Propulsion, powertrain, and powertrain fluids*.

This sixth edition cancels and replaces the fifth edition (ISO 8535-1:2011), which has been technically revised with the following changes:

- inside diameter sizes 3,5 mm and 3,6 mm have been added to [Table 1](#);
- code 5 and code 6 have been added to [Table 4](#).

A list of parts in the ISO 8535 series can be found on the ISO website.

NOTE The first part of the general title, "*Diesel engines*", is used for Part 1 only while for Part 2, "*Compression-ignition engines*" is still used but will be replaced at the next revision.

Diesel engines — Steel tubes for high-pressure fuel injection pipes —

Part 1: Requirements for seamless cold-drawn single-wall tubes

1 Scope

This document specifies dimensions and requirements for seamless cold-drawn single-wall steel tubes for high-pressure fuel injection pipes used on diesel (compression-ignition) engines (class 2) and for fuel injection pump testing (class 1).

This document applies to diesel (compression-ignition) engines.

2 Normative references

The following documents are referred to in the text in such a way that some or all of their content constitutes requirements of this document. For dated references, only the edition cited applies. For undated references, the latest edition of the referenced document (including any amendments) applies.

ISO 6507-1, *Metallic materials — Vickers hardness test — Part 1: Test method*

ISO 6892-1, *Metallic materials — Tensile testing — Part 1: Method of test at room temperature*

ISO 12345, *Diesel engines — Cleanliness assessment of fuel injection equipment*

3 Terms and definitions

No terms and definitions are listed in this document.

ISO and IEC maintain terminological databases for use in standardization at the following addresses:

- IEC Electropedia: available at <http://www.electropedia.org/>
- ISO Online browsing platform: available at <http://www.iso.org/obp>

4 Dimensions and tolerances

4.1 Diameters

Recommended inside and outside diameters are given in [Table 1](#). Other sizes may be used by agreement between supplier and customer.

Tolerances on inside and outside diameters shall be as follows.

a) Inside diameter, d

$d \leq 4$ mm: $\pm 0,05$ mm for class 2

$\pm 0,025$ mm for class 1 (these tolerances are in accordance with ISO 4093)

$d > 4$ mm: $\pm 0,10$ mm

NOTE Classes 1 and 2 are explained in [Clause 1](#).

b) Outside diameter, D

$D < 8$ mm: $\pm 0,06$ mm

$D \geq 8$ mm: $\pm 0,10$ mm

for classes 1 and 2

c) The maximum value of the concentricity of the tube outside diameter relative to the inside diameter shall be proportional to the wall thickness, as shown in [Figure 1](#).

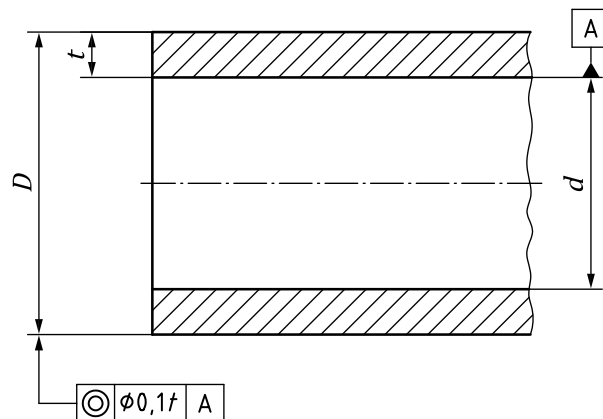

Figure 1 — Concentricity of the tube outside diameter

4.2 Length

Length and tolerances on length shall be by agreement between supplier and customer.

5 Material processing

5.1 Steel manufacturing process

The tubes shall be manufactured from unalloyed quality steel or an equivalent quality steel produced by a steel-making process that ensures a very homogeneous structure.

If requested by the customer, the supplier shall state the method of manufacture and the deoxidation process used.

5.2 Manufacturing of tubes

The final reduction(s) of the tube shall be followed by heat treatment to achieve the specified mechanical properties.

Table 1 — Recommended inside and outside diameters

Inside diameter ^a (<i>d</i>) mm		Outside diameter (<i>D</i>) mm														
Preferred		4	4,5	5	6	6,35	7	8	9	10	12	15	19	24	30	
1																
	1,12															
	1,25															
	1,4															
1,5																
	1,6															
1,7																
	1,8															
1,9																
	2															
2,12			Size combinations to be used appear in shaded cells													
	2,24															
2,36																
	2,5															
2,65																
	2,8															
	3															
	3,15															
3,5																
	3,6															
3,75																
	4															
4,25																
	4,5															
4,75																
	5															
5,3																
	5,6															
6																
	6,3															
6,7																
	7,1															
7,5																
	8															
8,5																
	9															
9,5																
	10															
10,6																
	11,2															
11,8																
	12,5															

NOTE The diameter sizes have been established with the ratio of outside to inside diameter within the range of 2 to 4.

^a Based on ISO 3.

5.3 Surface quality

5.3.1 General

The outside and inside surfaces of finished tubes shall be free from scale, rust, grooves, laps, laminations, deep pits or other injurious defects.

5.3.2 Minimum quality inside surface (bore grade S)

The inside of tubes of bore grade S shall be finished to ensure a smooth bore of accurate size with no more than five imperfections (fissures, crevices, etc.) over 0,08 mm to 0,13 mm (maximum) deep, per tube cross-section, using $\times 50$ magnification for examination (see [Table 2](#)).

5.3.3 Higher quality inside surface (bore grades O, P, Q, R)

If closer control over the depth of imperfections is required, bore grades O, P, Q or R, assessed under the magnification indicated (see [Table 2](#)) may be specified in the tube designation (see [Clause 6](#)).

Table 2 — Bore grades

Code	Permitted imperfections	Magnification
S	As in 5.3.2	$\times 50$
R	A maximum of five imperfections over 0,05 mm to 0,08 mm (maximum) deep	$\times 100$
Q	A maximum of five imperfections over 0,02 mm to 0,05 mm (maximum) deep	$\times 100$
P	A maximum of five imperfections over 0,01 mm to 0,02 mm (maximum) deep	$\times 200$
O	All imperfections equal to or less than 0,01 mm deep	$\times 500$

5.4 Surface finish

The outside surface of the tube may be coated on delivery by metal plating or galvanizing, or may be submitted to a chemical surface treatment (see [Table 3](#)).

The inside surface of the tube shall remain uncoated.

Table 3 — Surface finish on delivery

Code	Outside surface condition	Application remarks
0	Not specified (at manufacturer's choice).	May have additional finish at manufacturer's choice.
1	Outside surface as-processed, without any additional finish. Tubes annealed or normalized in a controlled atmosphere may be discoloured, but shall be free from loose scale.	Condition preferred for further surface processing.
2	Zinc electroplated with a coating layer thickness of 8 μm minimum and an additional colourless chromating ^a .	When minimum corrosion resistance is required. Not recommended for use with light alcohol-based fuels such as methanol.
3	Zinc electroplated with a coating layer thickness of 8 μm minimum and an additional yellow chromating ^a .	
(4, 5, 6, 7, 8)	(Reserved for further application.)	—
9	As specified subject to agreement.	—
^a Chromating as described in ISO 2080 and ISO 4520.		

5.5 Minimum mechanical properties of tubes

The tubes shall comply with one of the classes of mechanical properties (codes 1 to 4) as listed in [Table 4](#).

Table 4 — Mechanical properties

Code	Minimum tensile strength R_m N/mm ²	Minimum proof strength $R_{p0,2}$ N/mm ²	Minimum elongation A_5 %	Maximum hardness HV
1	310	205	30	115
2	360	220	23	150
3	490	355	22	194
4	600	430	15	280
5	750	670	10	310
6	850	770	8	340

NOTE The mechanical properties apply when the tube is tested in accordance with ISO 6507-1 and ISO 6892-1.

5.6 Cleanliness

The bore shall be clean and free from any contamination or coating which would impair the processing and serviceability of the tubes. When specifying a cleanliness requirement for the inside of the tubes, ISO 12345 shall be used.

5.7 Straightness

Unless otherwise agreed between supplier and customer, the tubes shall be straight within a maximum error of 1 in 400, with no localized deformation.

5.8 Corrosion resistance

The outside and inside surfaces shall be protected against corrosion for transportation and storage in closed areas. A permanent coating may be used on the outside surface when agreed between supplier and customer. Any temporary coating used shall not be injurious to the injection and combustion systems of the engine and shall be removable with diesel fuel.

6 Testing

6.1 General

Unless otherwise agreed between supplier and customer, tests shall be carried out in accordance with [6.2](#) to [6.8](#).

6.2 Scope of tests

Tubes shall be tested by lots of the same dimensions, steel type, heat treatment and surface finish. Tubes from each heat of steel shall be tested irrespective of lot.

For the test in [6.4](#), a test inspector shall select one tube from each lot, and for the test in [6.6](#), three tubes. The tests in [6.3](#), [6.7.1](#) and [6.8](#) shall be performed on all selected tubes.

For the test in [6.7.3](#), the lot size, the number of samples and the acceptance limit shall be agreed upon between supplier and customer.

6.3 Dimension tests

The tube dimensions shall comply with the dimensions and tolerances indicated in [Clause 4](#).

6.4 Mechanical-property tests

The tubes shall comply with the specifications given in [Table 4](#). The tests shall be made in accordance with ISO 6507-1 and ISO 6892-1. Tensile strength, proof strength, elongation and hardness shall be measured.

6.5 Bending test

The tube shall withstand cold bending through 180° over a rod of the same diameter as the tube outside diameter, without showing other than outside superficial cracks.

6.6 Cold upsetting of tubes

This test shall be carried out on tubes of outside diameter 15 mm and below.

A length of tube twice the outside diameter ($2D$) shall be capable of being compressed to a length D without showing cracks of depths exceeding 0,13 mm.

The test shall be made between two plane and parallel plates in a suitable fixture.

6.7 Surface quality test

6.7.1 A visual check shall be made to ensure that tubes satisfy the requirements in [5.3.1](#).

6.7.2 If mutually agreed between supplier and customer, the visual inspection may be replaced by a non-destructive test procedure.

6.7.3 If proof of a specified defect depth in the bore is required, an inspection by attributes, with an agreed acceptable quality level (AQL) shall be set when ordering; the test shall be made on metallographic cross-sections of the tube with the minimum magnification specified in [Table 2](#).

6.7.4 Surface coatings on tubes with plated or otherwise treated surfaces shall satisfy tests on these coatings when required. Such tests shall be agreed between supplier and customer.

6.8 Inside pressure test

Tubes shall be capable of withstanding appropriate inside pressure, which shall be agreed between supplier and customer (see [Annex A](#)), without permanent internal deformation or burst. This ability shall be confirmed by a hydraulic test. Other non-destructive tests, such as electronic testing, may be used if agreed between supplier and customer.

6.9 Retesting

If, after testing in accordance with [6.4](#), the selected tube fails, two other tubes shall be taken from the same lot to repeat the test. The same procedure shall apply to the test in [6.6](#). Each of the tubes taken shall meet the test requirements. If any tube fails to meet the test requirements, the whole lot is considered as rejected.

The supplier may submit a rejected lot for acceptance again in an improved condition, e.g. by repeating the heat treatment.

If, in this case, the test results of [6.4](#) and [6.6](#) do not fulfil the requirements, the whole lot shall be rejected.

6.10 Test certificate

A test certificate, if required [see [Clause 7](#), i)], shall be issued for each shipment, confirming that the tubes supplied meet the specifications of this document. For proof, the records of the continuous production inspections concerning the following tests may be used:

- a) dimensions in accordance with [6.3](#);
- b) mechanical properties in accordance with [6.4](#);
- c) bending test in accordance with [6.5](#);
- d) cold upsetting in accordance with [6.6](#);
- e) visual inspection in accordance with [6.7.1](#);
- f) metallographic test in accordance with [6.7.3](#);
- g) inside pressure test in accordance with [6.8](#).

Other test certificates may be agreed upon between supplier and customer.

7 Designation

A steel tube that meets the requirements of this document shall be designated as follows, in the order given:

- a) the word “Tube”;
- b) a reference to this document, i.e ISO 8535-1;
- c) tube type: a seamless cold-drawn single-wall steel tube is indicated by the letter “S”;
- d) size: the second and third characters identify the nominal inside and outside diameters, respectively, of the tube, in millimetres;
- e) class: the fourth character determines the bore tolerance [see [4.1 a](#))];
- f) the fifth character identifies the mechanical properties of the tube in accordance with [Table 4](#);
- g) the sixth character identifies the bore grade of the tube in accordance with [Table 2](#);
- h) the seventh character identifies the treatment of the outside surface of the tube (see [Table 3](#));
- i) at the end the of the designation, the letter “Z” may be added to indicate that a certificate from the tube manufacturer is required for confirmation of compliance with this document and additional delivery requirements, if any (see ISO 404).

EXAMPLE A tube conforming to this document shall be designated as shown below.

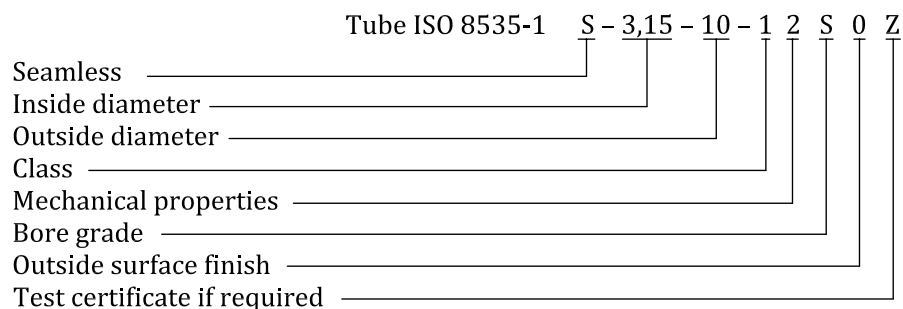

8 Identification and marking

Tubes shall be identified by use of labels with the designation in accordance with [Clause 7](#). Additional marking is permissible if agreed between supplier and customer.

9 Packing

Unless otherwise agreed upon between supplier and customer, the tubes shall be delivered in secure bundles, with tubes sealed at both ends.

Annex A (informative)

Theoretical maximum pressure for inside pressure testing

The theoretical maximum test pressure, p_{\max} , in kilopascals, for checking permanent internal deformation (see 5.8) is given by the product of the stress coefficient and the upper yield strength, R_{eH} , in newtons per square millimetre, and is based on von Mises' yield criterion:

$$p_{\max} = 10^3 \frac{K^2 - 1}{\sqrt{1 + 3K^4}} \times R_{eH}$$

where

$$K = \frac{D}{d}$$

where

D is the outside diameter, in millimetres;

d is the inside diameter, in millimetres.

Bibliography

- [1] ISO 3, *Preferred numbers — Series of preferred numbers*
- [2] ISO 404, *Steel and steel products — General technical delivery requirements*
- [3] ISO 2080, *Metallic and other inorganic coatings — Surface treatment, metallic and other inorganic coatings — Vocabulary*
- [4] ISO 4093, *Diesel engines — Fuel injection pumps — High-pressure pipes for testing*
- [5] ISO 4520, *Chromate conversion coatings on electroplated zinc and cadmium coatings*
- [6] ISO 8535-2, *Compression-ignition engines — Steel tubes for high-pressure fuel injection pipes — Part 2: Requirements for composite tubes*
- [7] ISO 13296, *Diesel engines — High-pressure fuel injection pipe assemblies — General requirements and dimensions*

British Standards Institution (BSI)

BSI is the national body responsible for preparing British Standards and other standards-related publications, information and services.

BSI is incorporated by Royal Charter. British Standards and other standardization products are published by BSI Standards Limited.

About us

We bring together business, industry, government, consumers, innovators and others to shape their combined experience and expertise into standards-based solutions.

The knowledge embodied in our standards has been carefully assembled in a dependable format and refined through our open consultation process. Organizations of all sizes and across all sectors choose standards to help them achieve their goals.

Information on standards

We can provide you with the knowledge that your organization needs to succeed. Find out more about British Standards by visiting our website at bsigroup.com/standards or contacting our Customer Services team or Knowledge Centre.

Buying standards

You can buy and download PDF versions of BSI publications, including British and adopted European and international standards, through our website at bsigroup.com/shop, where hard copies can also be purchased.

If you need international and foreign standards from other Standards Development Organizations, hard copies can be ordered from our Customer Services team.

Copyright in BSI publications

All the content in BSI publications, including British Standards, is the property of and copyrighted by BSI or some person or entity that owns copyright in the information used (such as the international standardization bodies) and has formally licensed such information to BSI for commercial publication and use.

Save for the provisions below, you may not transfer, share or disseminate any portion of the standard to any other person. You may not adapt, distribute, commercially exploit, or publicly display the standard or any portion thereof in any manner whatsoever without BSI's prior written consent.

Storing and using standards

Standards purchased in soft copy format:

- A British Standard purchased in soft copy format is licensed to a sole named user for personal or internal company use only.
- The standard may be stored on more than 1 device provided that it is accessible by the sole named user only and that only 1 copy is accessed at any one time.
- A single paper copy may be printed for personal or internal company use only.

Standards purchased in hard copy format:

- A British Standard purchased in hard copy format is for personal or internal company use only.
- It may not be further reproduced – in any format – to create an additional copy. This includes scanning of the document.

If you need more than 1 copy of the document, or if you wish to share the document on an internal network, you can save money by choosing a subscription product (see 'Subscriptions').

Reproducing extracts

For permission to reproduce content from BSI publications contact the BSI Copyright & Licensing team.

Subscriptions

Our range of subscription services are designed to make using standards easier for you. For further information on our subscription products go to bsigroup.com/subscriptions.

With **British Standards Online (BSOL)** you'll have instant access to over 55,000 British and adopted European and international standards from your desktop. It's available 24/7 and is refreshed daily so you'll always be up to date.

You can keep in touch with standards developments and receive substantial discounts on the purchase price of standards, both in single copy and subscription format, by becoming a **BSI Subscribing Member**.

PLUS is an updating service exclusive to BSI Subscribing Members. You will automatically receive the latest hard copy of your standards when they're revised or replaced.

To find out more about becoming a BSI Subscribing Member and the benefits of membership, please visit bsigroup.com/shop.

With a **Multi-User Network Licence (MUNL)** you are able to host standards publications on your intranet. Licences can cover as few or as many users as you wish. With updates supplied as soon as they're available, you can be sure your documentation is current. For further information, email subscriptions@bsigroup.com.

Revisions

Our British Standards and other publications are updated by amendment or revision.

We continually improve the quality of our products and services to benefit your business. If you find an inaccuracy or ambiguity within a British Standard or other BSI publication please inform the Knowledge Centre.

Useful Contacts

Customer Services

Tel: +44 345 086 9001

Email (orders): orders@bsigroup.com

Email (enquiries): cservices@bsigroup.com

Subscriptions

Tel: +44 345 086 9001

Email: subscriptions@bsigroup.com

Knowledge Centre

Tel: +44 20 8996 7004

Email: knowledgecentre@bsigroup.com

Copyright & Licensing

Tel: +44 20 8996 7070

Email: copyright@bsigroup.com

BSI Group Headquarters

389 Chiswick High Road London W4 4AL UK