

Forestry machinery — Portable chain-saws — Determination of balance and maximum holding moment

ICS 65.060.80



National foreword

This British Standard is the UK implementation of ISO 8334:2007. It supersedes BS 6916-10:1988 which is withdrawn.

The UK participation in its preparation was entrusted to Technical Committee AGE/29, Forestry machinery.

A list of organizations represented on this committee can be obtained on request to its secretary.

This publication does not purport to include all the necessary provisions of a contract. Users are responsible for its correct application.

Compliance with a British Standard cannot confer immunity from legal obligations.

This British Standard was published under the authority of the Standards Policy and Strategy Committee on 30 November 2007

© BSI 2007

Amendments issued since publication

Amd. No.	Date	Comments

ISBN 978 0 580 56219 8

This document is now
PUBLIC

INTERNATIONAL
STANDARD

ISO
8334

Second edition
2007-04-15

**Forestry machinery — Portable chain-
saws — Determination of balance and
maximum holding moment**

*Matériel forestier — Scies à chaîne portatives — Détermination de
l'équilibre et du moment de sustentation maximal*



Reference number
ISO 8334:2007(E)

This document is now
POOBLIC

Foreword

ISO (the International Organization for Standardization) is a worldwide federation of national standards bodies (ISO member bodies). The work of preparing International Standards is normally carried out through ISO technical committees. Each member body interested in a subject for which a technical committee has been established has the right to be represented on that committee. International organizations, governmental and non-governmental, in liaison with ISO, also take part in the work. ISO collaborates closely with the International Electrotechnical Commission (IEC) on all matters of electrotechnical standardization.

International Standards are drafted in accordance with the rules given in the ISO/IEC Directives, Part 2.

The main task of technical committees is to prepare International Standards. Draft International Standards adopted by the technical committees are circulated to the member bodies for voting. Publication as an International Standard requires approval by at least 75 % of the member bodies casting a vote.

Attention is drawn to the possibility that some of the elements of this document may be the subject of patent rights. ISO shall not be held responsible for identifying any or all such patent rights.

ISO 8334 was prepared by Technical Committee ISO/TC 23, *Tractors and machinery for agriculture and forestry*, Subcommittee SC 17, *Manually portable forest machinery*.

This second edition cancels and replaces the first edition (ISO 8334:1985), which has been technically revised to cover not only chain-saws for forest service but those for tree service as well. It includes the additional determination of lateral balance and maximum holding moment. All limits have been removed and are now to be set using the product standards.



**This document is now
PUBLIC**

blank

Forestry machinery — Portable chain-saws — Determination of balance and maximum holding moment

1 Scope

This International Standard specifies a test method for the longitudinal and the lateral balance of portable combustion engine hand-held chain-saws.

It also provides a test method for determining the maximum holding moment of tree service chain-saws.

2 Normative references

The following referenced documents are indispensable for the application of this document. For dated references, only the edition cited applies. For undated references, the latest edition of the referenced document (including any amendments) applies.

ISO 6531, *Machinery for forestry — Portable hand-held chain-saws — Vocabulary*

3 Terms and definitions

For the purposes of this document, the terms and definitions given in ISO 6531 apply.

4 Determination of balance

4.1 Preparation

4.1.1 Chain-saw

The balance shall be checked on a normal production saw in a new and clean condition. Fuel and oil tanks shall be half full. The saw shall be fitted with a guide bar and an associated saw chain as specified below. The guide bar shall be tightened to its uppermost position.

The chain-saw as specified in the instruction handbook or according to the manufacturer's instructions shall be tested in both of the following two configurations:

- a) shortest and lightest guide bar, without spiked bumper (if detachable);
- b) longest and heaviest guide bar, with spiked bumper (if available).

The length and mass of the guide bars used in the test shall be listed in the test report.

4.1.2 Test equipment

The suspension method shall not influence the test result.

This document is not
POOBLIC

4.2 Longitudinal balance at front handle of chain-saws for forest service

A chain-saw according to 4.1 shall be supported on the front handle, positioned so that the guide bar plane is vertical. This support shall produce the lowest possible friction to allow saw rotation. See the example shown in Figure 1.

Measure and report the angle, α , between the centreline of the guide bar and the horizontal plane.

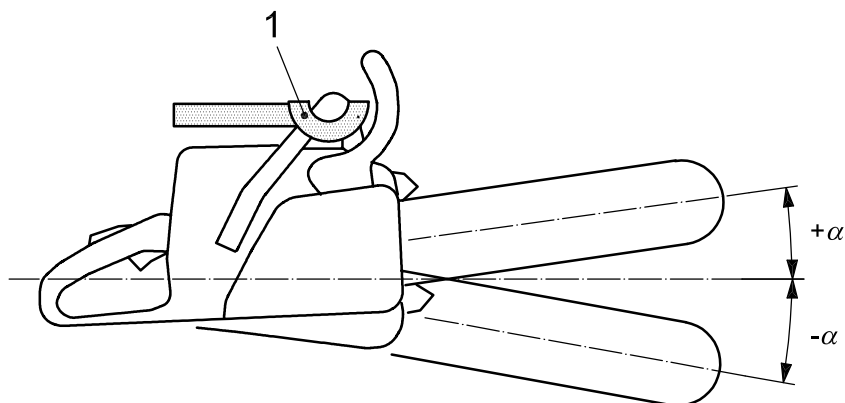

Key

1 segment of a ball bearing

Figure 1 — Example of device for determining longitudinal balance at front handle for chain-saws for forest service

4.3 Longitudinal balance at rear handle for chain-saws for tree service

A chain-saw according to 4.1 shall be supported by a rod of 10 mm diameter, positioned as close as possible behind the throttle trigger. This rod shall be firmly attached to the rear handle by means of a clamp or similar so that the guide bar plane will be vertical. The rod shall be supported on bearings such that the lowest possible friction is produced. See the example shown in Figure 2.

Measure and report the angle, β , between the centreline of the guide bar and the horizontal plane.

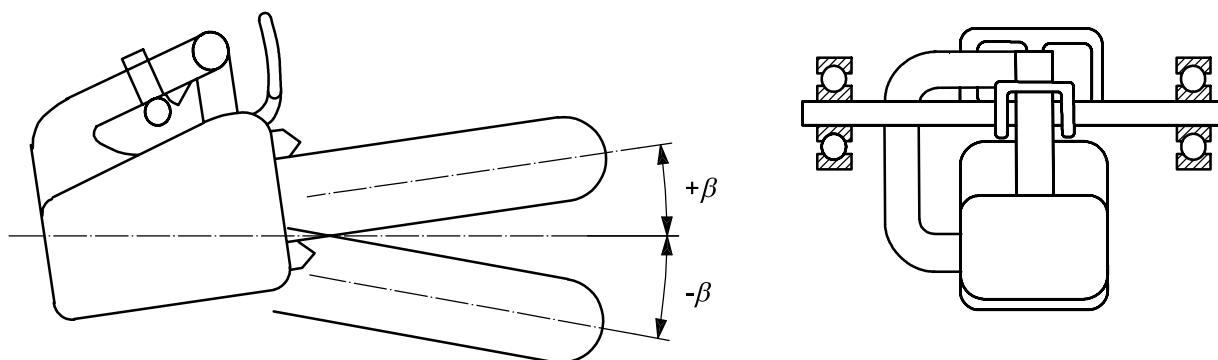

Figure 2 — Example of device for determining longitudinal balance at rear handle for chain-saws for tree service

4.4 Lateral balance at rear handle for chain-saws for tree service

A chain-saw shall be balanced on a support pin in accordance with Figure 3. The support pin shall be as close as possible behind the released throttle trigger.

The support pin shall be of steel, conical to a maximum of 45° and shall have a contact point with a radii, R , of 1 mm max.

If the chain-saw will not remain on the rear handle support pin because of handle design, it is permissible to drill a recess hole for locating the support pin. The recess hole diameter and depth shall be such as to provide positive location of the support pin without interfering with chain-saw movement.

Measure and report the angle, δ , between the plane of the guide bar and the vertical.

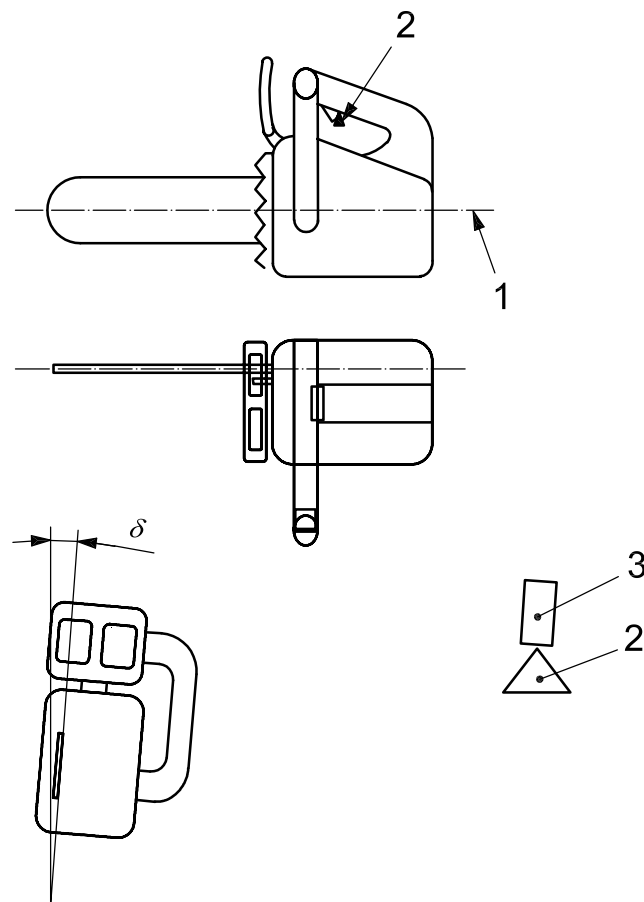

Key

- 1 guide bar centreline
- 2 support pin
- 3 rear handle

Figure 3 — Example of device for determining lateral balance at rear handle for chain-saws for tree service

5 Determination of maximum holding moment at rear handle for chain-saws for tree service

Determine the centre of gravity (CG) and the mass, m , of the complete saw, with half-full tanks and the longest guide bar with a saw chain and spiked bumper (if available). The guide bar shall be tightened to its uppermost position.

Measure the distance, R , from the reference point (RP) to the centre of gravity. RP is located as close as possible behind the back of the released throttle trigger as shown in Figure 4, and is defined as the point at which the inside of the rear handle intersects the back of the released throttle trigger. The measurement shall be conducted from RP in a plane parallel to the guide bar plane to the axis through the centre of gravity perpendicular to the guide bar plane.

Calculate the holding moment, M_H , in Newton metres (N·m), using the formula:

$$M_H = m \cdot g \cdot R \cdot 10^{-3}$$

where

- m is the chain-saw mass (kg);
- g is the acceleration due to gravity, i.e. 9,81 m/s²;
- R is the distance between the reference point and the centre of gravity (mm).

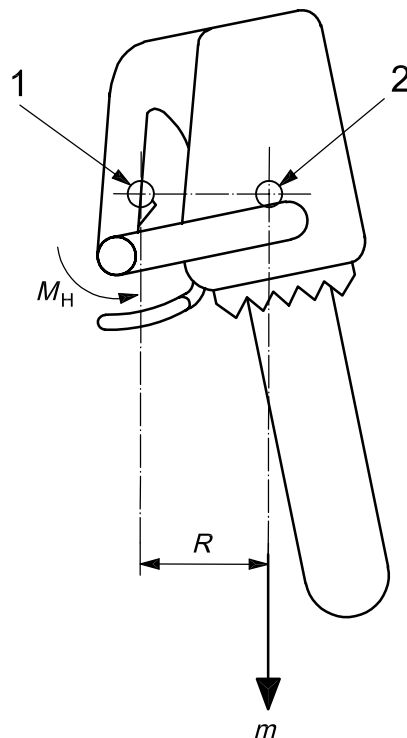

Key

- M_H holding moment
- R distance between RP and CG
- m mass of chain-saw
- 1 reference point (RP)
- 2 centre of gravity (CG)

Figure 4 — Determination of maximum holding moment at rear handle for chain-saws for tree service

6 Test report

The test report shall include at least the following information:

- a) reference to this International Standard (i.e. ISO 8334);
- b) date and place of measurement;
- c) description of the chain-saw, including
 - manufacturer,
 - type, model and serial number,
 - type and length of guide bars and saw chains, and
 - mass of the chain-saw (with guide bar and saw chain, and with tanks half full), in kilograms;
- d) description of the measuring equipment;
- e) recorded values of
 - longitudinal balance α at front handle for chain-saws for forest service, or
 - longitudinal balance β and lateral balance δ at rear handle, for chain-saws for tree service, and
 - maximum holding moment at the rear handle for chain-saws for tree service;
- f) name of test station and person responsible for the test.

An example of a test report is given in Annex A.



Annex A (informative)

Example test report

Test report for

ISO 8334, Forestry machinery — Portable chain-saws — Determination of balance and maximum holding moment

Chain-saw manufacturer:	Chain-saw type and model:	Chain-saw serial number:
Date and place of measurement:		
Name of test station and person responsible for test:		

Longitudinal balance			
Chain-saw for forest service	Yes	Chain-saw for tree service	Yes
Tank half filled (cm ³)			
Guide bar length (cm)/mass (kg)	Spiked bumper		Saw chain type
Shortest:/.....	Yes	No	
Longest:/.....	Yes	No	
Measured longitudinal guide bar angle from the vertical, α or β			
Shortest bar length	Angle (°)		
Longest bar length	Angle (°)		
Lateral balance for tree service chain-saws			
Tank half filled (cm ³)			
Guide bar length (cm)/mass (kg)	Spiked bumper		Saw chain type
Shortest:/.....	Yes	No	
Longest:/.....	Yes	No	
Measured lateral guide bar angle from the vertical, δ			
Shortest bar length	Angle(°)		
Longest bar length	Angle(°)		
Holding moment for tree service chain-saws			
Tank half filled cm ³	Longest guide bar length cm	Saw chain Type	Spiked bumper Yes
	Type		No
R distance between reference point (RP) and centre of gravity (CG) (mm)			
m total chain-saw mass (kg)			
Calculated holding moment, $M_H = 9,81 \cdot 10^{-3} \cdot m \cdot R$ (N·m)			

**This document is now
PUBLIC**

blank

BSI — British Standards Institution

BSI is the independent national body responsible for preparing British Standards. It presents the UK view on standards in Europe and at the international level. It is incorporated by Royal Charter.

Revisions

British Standards are updated by amendment or revision. Users of British Standards should make sure that they possess the latest amendments or editions.

It is the constant aim of BSI to improve the quality of our products and services. We would be grateful if anyone finding an inaccuracy or ambiguity while using this British Standard would inform the Secretary of the technical committee responsible, the identity of which can be found on the inside front cover.
Tel: +44 (0)20 8996 9000. Fax: +44 (0)20 8996 7400.

BSI offers members an individual updating service called PLUS which ensures that subscribers automatically receive the latest editions of standards.

Buying standards

Orders for all BSI, international and foreign standards publications should be addressed to Customer Services. Tel: +44 (0)20 8996 9001.
Fax: +44 (0)20 8996 7001. Email: orders@bsi-global.com. Standards are also available from the BSI website at <http://www.bsi-global.com>.

In response to orders for international standards, it is BSI policy to supply the BSI implementation of those that have been published as British Standards, unless otherwise requested.

Information on standards

BSI provides a wide range of information on national, European and international standards through its Library and its Technical Help to Exporters Service. Various BSI electronic information services are also available which give details on all its products and services. Contact the Information Centre.
Tel: +44 (0)20 8996 7111. Fax: +44 (0)20 8996 7048. Email: info@bsi-global.com.

Subscribing members of BSI are kept up to date with standards developments and receive substantial discounts on the purchase price of standards. For details of these and other benefits contact Membership Administration.
Tel: +44 (0)20 8996 7002. Fax: +44 (0)20 8996 7001.
Email: membership@bsi-global.com.

Information regarding online access to British Standards via British Standards Online can be found at <http://www.bsi-global.com/bsonline>.

Further information about BSI is available on the BSI website at <http://www.bsi-global.com>.

Copyright

Copyright subsists in all BSI publications. BSI also holds the copyright, in the UK, of the publications of the international standardization bodies. Except as permitted under the Copyright, Designs and Patents Act 1988 no extract may be reproduced, stored in a retrieval system or transmitted in any form or by any means – electronic, photocopying, recording or otherwise – without prior written permission from BSI.

This does not preclude the free use, in the course of implementing the standard, of necessary details such as symbols, and size, type or grade designations. If these details are to be used for any other purpose than implementation then the prior written permission of BSI must be obtained.

Details and advice can be obtained from the Copyright & Licensing Manager.
Tel: +44 (0)20 8996 7070. Fax: +44 (0)20 8996 7553.
Email: copyright@bsi-global.com.

BSI

389 Chiswick High Road
London
W4 4AL

This document is now
PUBLIC