

BS ISO 7368:2016



BSI Standards Publication

Hydraulic fluid power — Two-port slip-in cartridge valves — Cavities

National foreword

This British Standard is the UK implementation of ISO 7368:2016. It supersedes BS 7296-1:1990 which is withdrawn.

The UK participation in its preparation was entrusted to Technical Committee MCE/18/-/5, Control components.

A list of organizations represented on this committee can be obtained on request to its secretary.

This publication does not purport to include all the necessary provisions of a contract. Users are responsible for its correct application.

© The British Standards Institution 2016.
Published by BSI Standards Limited 2016

ISBN 978 0 580 87177 1

ICS 23.100.50

Compliance with a British Standard cannot confer immunity from legal obligations.

This British Standard was published under the authority of the Standards Policy and Strategy Committee on 30 September 2016.

Amendments/corrigenda issued since publication

Date	Text affected
------	---------------

INTERNATIONAL
STANDARD

ISO
7368

Second edition
2016-08-01

**Hydraulic fluid power — Two-port
slip-in cartridge valves — Cavities**

*Transmissions hydrauliques — Distributeurs à cartouche, à bride, à
deux orifices — Logements*



Reference number
ISO 7368:2016(E)

© ISO 2016



COPYRIGHT PROTECTED DOCUMENT

© ISO 2016, Published in Switzerland

All rights reserved. Unless otherwise specified, no part of this publication may be reproduced or utilized otherwise in any form or by any means, electronic or mechanical, including photocopying, or posting on the internet or an intranet, without prior written permission. Permission can be requested from either ISO at the address below or ISO's member body in the country of the requester.

ISO copyright office
Ch. de Blandonnet 8 • CP 401
CH-1214 Vernier, Geneva, Switzerland
Tel. +41 22 749 01 11
Fax +41 22 749 09 47
copyright@iso.org
www.iso.org

Contents

	Page
Foreword	iv
Introduction	v
1 Scope	1
2 Normative references	1
3 Terms and definitions	1
4 Symbols	1
5 Tolerances	2
6 Dimensions	2
7 Identification statement (Reference of this International Standard)	3
Bibliography	36

Foreword

ISO (the International Organization for Standardization) is a worldwide federation of national standards bodies (ISO member bodies). The work of preparing International Standards is normally carried out through ISO technical committees. Each member body interested in a subject for which a technical committee has been established has the right to be represented on that committee. International organizations, governmental and non-governmental, in liaison with ISO, also take part in the work. ISO collaborates closely with the International Electrotechnical Commission (IEC) on all matters of electrotechnical standardization.

The procedures used to develop this document and those intended for its further maintenance are described in the ISO/IEC Directives, Part 1. In particular the different approval criteria needed for the different types of ISO documents should be noted. This document was drafted in accordance with the editorial rules of the ISO/IEC Directives, Part 2 (see www.iso.org/directives).

Attention is drawn to the possibility that some of the elements of this document may be the subject of patent rights. ISO shall not be held responsible for identifying any or all such patent rights. Details of any patent rights identified during the development of the document will be in the Introduction and/or on the ISO list of patent declarations received (see www.iso.org/patents).

Any trade name used in this document is information given for the convenience of users and does not constitute an endorsement.

For an explanation on the meaning of ISO specific terms and expressions related to conformity assessment, as well as information about ISO's adherence to the World Trade Organization (WTO) principles in the Technical Barriers to Trade (TBT) see the following URL: www.iso.org/iso/foreword.html.

The committee responsible for this document is ISO/TC 131, *Fluid power systems*, Subcommittee SC 5, *Control products and components*.

This second edition cancels and replaces the first edition (ISO 7368:1989), which has been technically revised.

This edition includes the following significant changes with respect to the previous edition:

- New sizes 15 and 16 are introduced;
- Surface tolerances for sealing purposes are aligned with ISO 3601-2.

Introduction

In hydraulic fluid power systems, power is transmitted and controlled through a liquid under pressure within an enclosed circuit. Typical components found in such systems are hydraulic valves. These devices control flow direction, pressure or flow rate of liquids in the enclosed circuit.

Hydraulic fluid power — Two-port slip-in cartridge valves — Cavities

1 Scope

This document specifies only geometrical data relating to cavities in which two-port hydraulic slip-in cartridge valves are mounted in order to ensure interchangeability.

NOTE For example, this document does not specify rated pressures.

It applies to cavities for two-port hydraulic slip-in cartridge valves which are generally applicable to industrial equipment.

2 Normative references

The following documents are referred to in the text in such a way that some or all of their content constitutes requirements of this document. For dated references, only the edition cited applies. For undated references, the latest edition of the referenced document (including any amendments) applies.

ISO 1302, *Geometrical Product Specifications (GPS) — Indication of surface texture in technical product documentation*

ISO 2768-1, *General tolerances — Part 1: Tolerances for linear and angular dimensions without individual tolerance indications*

ISO 3601-2, *Fluid power systems — O-rings — Part 2: Housing dimensions for general applications*

ISO 4287, *Geometrical Product Specifications (GPS) — Surface texture: Profile method — Terms, definitions and surface texture parameters*

3 Terms and definitions

For the purposes of this document, the terms and definitions given in ISO 5598 apply.

ISO and IEC maintain terminological databases for use in standardization at the following addresses:

- IEC Electropedia: available at <http://www.electropedia.org/>
- ISO Online browsing platform: available at <http://www.iso.org/obp>

4 Symbols

a) A, B, X, Y, Z₁ and Z₂ identify ports the operational usage of which, in some cases, may be different from that given in the following examples:

- 1) A: inlet, service, return corresponding to the placing in the hydraulic circuit;
- 2) B: inlet, service, return corresponding to the placing in the hydraulic circuit;
- 3) X: pilot, inlet;
- 4) Y: pilot, return;

- 5) Z_1 : supplementary pilot, inlet;
- 6) Z_2 : supplementary pilot, return;
- b) $F_1 \dots F_{12}$ identify threaded holes for fixing screws;
- c) G, G_1 and G_2 identify the location of pin holes;
- d) D identifies the fixing screw diameter;
- e) r_{\max} identifies the mounting surface edge radius;
- f) R_1 indicates the maximum radius at the bottom of d_1 .

The code system used in this document is defined in ISO 5783.

NOTE Size 15 and size 16 are not yet listed in ISO 5783.

5 Tolerances

The following requirements shall be applied to the sealing and chamfer surfaces, i.e. that area within the chain lines:

- surface roughness (see ISO 3601-2);
- surface roughness, R_z : as indicated on the figures according to ISO 1302 and ISO 4287;
- all non-specified surface finishes: R_z 63;
- surface roughness values are given in micrometres (μm);
- surface flatness: 0,01 mm over a distance of 100 mm (see ISO 3601-2).

The following tolerances shall be complied with along the x, y and z axes with respect to the origin:

- pin holes: $\pm 0,2$ mm;
- screw holes: $\pm 0,2$ mm;
- port holes: $\pm 0,2$ mm;
- general tolerances according to ISO 2768-1 for linear and angular dimensions without tolerances.

As for other dimensions, see [Figure 1](#) to [Figure 16](#).

6 Dimensions

6.1 Cavity dimensions for hydraulic slip-in cartridge valves with two main ports shall be selected from [Figure 1](#) to [Figure 16](#) and [Table 1](#) to [Table 16](#) as specified in [6.2](#) to [6.17](#).

6.2 Cavity dimensions for all types of valves, except main system pressure-relief valves, with main ports of 16 mm nominal diameter (size 06) (code 7368 - 06 - 1 - 1 - 16) are specified in [Table 1](#) and shown in [Figure 1](#).

6.3 Cavity dimensions for main system pressure-relief valves with main ports of 16 mm nominal diameter (size 06) (code 7368 - 06 - 2 - 1 - 16) are specified in [Table 2](#) and shown in [Figure 2](#).

6.4 Cavity dimensions for all types of valves, except main system pressure-relief valves, with main ports of 25 mm nominal diameter (size 08) (code 7368 - 08 - 3 - 1 - 16) are specified in [Table 3](#) and shown in [Figure 3](#).

6.5 Cavity dimensions for main system pressure-relief valves with main ports of 25 mm nominal diameter (size 08) (code 7368 - 08 - 4 - 1 - 16) are specified in [Table 4](#) and shown in [Figure 4](#).

6.6 Cavity dimensions for all types of valves, except main system pressure-relief valves, with main ports of 32 mm nominal diameter (size 09) (code 7368 - 09 - 5 - 1 - 16) are specified in [Table 5](#) and shown in [Figure 5](#).

6.7 Cavity dimensions for main system pressure-relief valves with main ports of 32 mm nominal diameter (size 09) (code 7368 - 09 - 6 - 1 - 16) are specified in [Table 6](#) and shown in [Figure 6](#).

6.8 Cavity dimensions for all types of valves, except main system pressure-relief valves, with main ports of 40 mm nominal diameter (size 10) (code 7368 - 10 - 7 - 1 - 16) are specified in [Table 7](#) and shown in [Figure 7](#).

6.9 Cavity dimensions for main system pressure-relief valves with main ports of 40 mm nominal diameter (size 10) (code 7368 - 10 - 8 - 1 - 16) are specified in [Table 8](#) and shown in [Figure 8](#).

6.10 Cavity dimensions for all types of valves, except main system pressure-relief valves, with main ports of 50 mm nominal diameter (size 11) (code 7368 - 11 - 9 - 1 - 16) are specified in [Table 9](#) and shown in [Figure 9](#).

6.11 Cavity dimensions for main system pressure-relief valves with main ports of 50 mm nominal diameter (size 11) (code 7368 - 11 - 10 - 1 - 16) are specified in [Table 10](#) and shown in [Figure 10](#).

6.12 Cavity dimensions for all types of valves, except main system pressure-relief valves, with main ports of 63 mm nominal diameter (size 12) (code 7368 - 12 - 11 - 1 - 16) are specified in [Table 11](#) and shown in [Figure 11](#).

6.13 Cavity dimensions for main system pressure-relief valves with main ports of 63 mm nominal diameter (size 12) (code 7368 - 12 - 12 - 1 - 16) are specified in [Table 12](#) and shown in [Figure 12](#).

6.14 Cavity dimensions for all types of valves, except main system pressure-relief valves, with main ports of 80 mm nominal diameter (size 13) (code 7368 - 13 - 13 - 1 - 16) are specified in [Table 13](#) and shown in [Figure 13](#).

6.15 Cavity dimensions for all types of valves, except main system pressure-relief valves, with main ports of 100 mm nominal diameter (size 14) (code 7368 - 14 - 14 - 1 - 16) are specified in [Table 14](#) and shown in [Figure 14](#).

6.16 Cavity dimensions for all types of valves, except main system pressure-relief valves, with main ports of 125 mm nominal diameter (size 15) (code 7368 - 15 - 15 - 1 - 16) are specified in [Table 15](#) and shown in [Figure 15](#).

6.17 Cavity dimensions for all types of valves, except main system pressure-relief valves, with main ports of 160 mm nominal diameter (size 16) (code 7368 - 16 - 16 - 1 - 16) are specified in [Table 16](#) and shown in [Figure 16](#).

7 Identification statement (Reference of this International Standard)

Use the following statement in test reports, catalogues and sales literature when electing to comply with this International Standard:

“Cavity dimensions conform to ISO 7368, *Hydraulic fluid power — Two-port slip-in cartridge valves — Cavities.*”

Dimensions and geometrical tolerances in millimetres

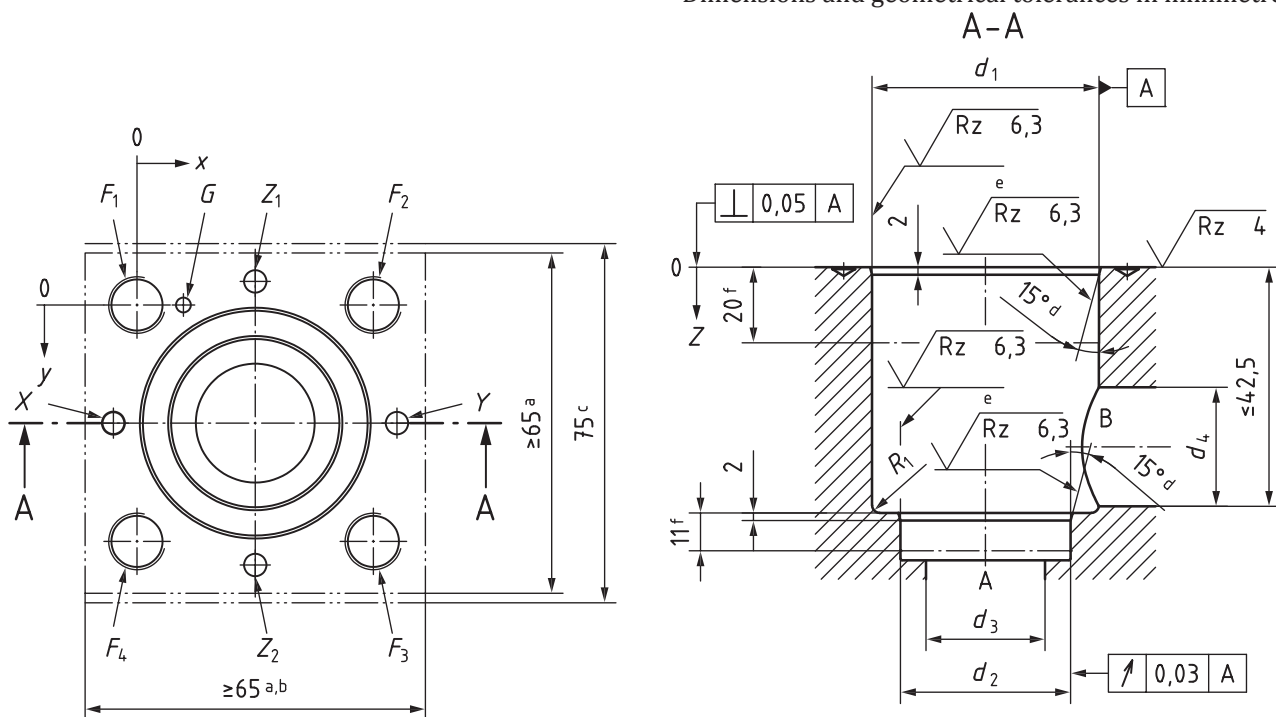

Key

- a The dimension specifying the area within the chain lines is the minimum dimension for mounting the cartridge valve cover. The corners of the square may be rounded to a maximum radius, r_{max} , equal to the thread diameter of the fixing screws. Along each axis, the fixing holes are at equal distances to the valve cover mounting surface edges.
- b Pilot valves and adjustment devices may exceed this dimension.
- c This dimension gives the minimum space required for a two-port hydraulic slip-in cartridge valve and its cover with this cavity. The dimension is also the minimum distance from centreline to centreline of two identical cavities on a manifold. The valve manufacturer's attention is drawn to the fact that no part of the complete valve assembly shall exceed this dimension.
- d No burrs permitted in this area; the edges shall be rounded.
- e Visual examination.
- f Minimum length over which the specified surface finish shall apply.

Figure 1 — Cavity for two-port hydraulic slip-in cartridge valves of all types, except main system pressure-relief valves, with main ports of 16 mm nominal diameter (size 06) and square flange cover (code: 7368 - 06 - 1 - 1 - 16)

Table 1 — Cavity for two-port hydraulic slip-in cartridge valves of all types, except main system pressure-relief valves, with main ports of 16 mm nominal diameter (size 06) and square flange cover

Dimensions in millimetres

Axis	d_1^e	d_2^e	d_3^c	$d_4^{b,c}$	X^c	Y^c	Z_1^c	Z_2^c	F_1^a	F_2^a	F_3^a	F_4^a	$G^{d,e}$	R_1
	$\varnothing 32$ H7	$\varnothing 25$ H7	$\varnothing 16$ max.	$\varnothing 16$	$\varnothing 4$ max.	$\varnothing 4$ max.	$\varnothing 4$ max.	$\varnothing 4$ max.	M8	M8	M8	M8	$\varnothing 4$ H13	max. R 2
x	23	23	23	—	-2	48	23	23	0	46	46	0	12,5	—
y	23	23	23	—	23	23	-2	48	0	0	46	46	0	—
z	$43 \pm 0,2$	$56 + 0,1$	—	—	—	—	—	—	—	—	—	—	8 min.	—

a The minimum thread depth is 1,8 times the screw diameter, D . The recommended full thread depth is $2 \cdot D + 6$ mm to facilitate interchangeability of valves and to reduce the number of fixing screw lengths. However, sufficient distance from fixing hole to port B shall be respected. The recommended engagement of fixing screw thread for ferrous mounting is $1,25 \cdot D$.

b Suggested diameter of port B, but may be of any size located within the space between the dimensions indicated as 20 mm and 42,5 mm; port B is not necessarily machined and may be provided by casting.

c The depth and angle of the pilot ports and the main ports are determined by the graphical layout of the hydraulic circuit and by the location of the valves in the manifold.

d Blind hole to accommodate the locating pin on the valve cover.

e The depth of d_1 , d_2 and G are given in the tables as dimension z .

Dimensions and geometrical tolerances in millimetres

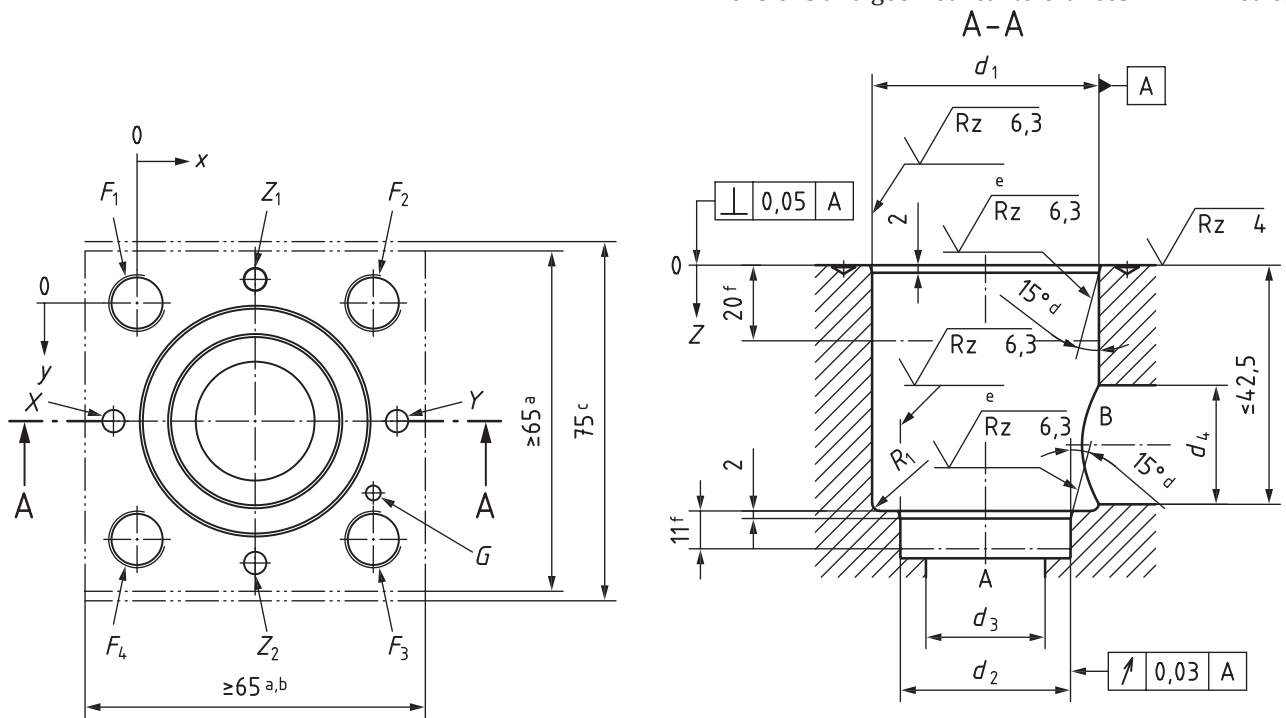

Key

- a The dimension specifying the area within the chain lines is the minimum dimension for mounting the cartridge valve cover. The corners of the square may be rounded to a maximum radius, r_{max} , equal to the thread diameter of the fixing screws. Along each axis, the fixing holes are at equal distances to the valve cover mounting surface edges.
- b Pilot valves and adjustment devices may exceed this dimension.
- c This dimension gives the minimum space required for a two-port hydraulic slip-in cartridge valve and its cover with this cavity. The dimension is also the minimum distance from centreline to centreline of two identical cavities on a manifold. The valve manufacturer's attention is drawn to the fact that no part of the complete valve assembly shall exceed this dimension.
- d No burrs permitted in this area; the edges shall be rounded.
- e Visual examination.
- f Minimum length over which the specified surface finish shall apply.

Figure 2 — Cavity for two-port hydraulic slip-in cartridge main system pressure-relief valves with main ports of 16 mm nominal diameter (size 06) and square flange cover (code: 7368 - 06 - 2 - 1 - 16)

Table 2 — Cavity for two-port hydraulic slip-in cartridge main system pressure-relief valves with main ports of 16 mm nominal diameter (size 06) and square flange cover

Dimensions in millimetres

Axis	d_1^e	d_2^e	d_3^c	$d_4^{b,c}$	X^c	Y^c	Z_1^c	Z_2^c	F_1^a	F_2^a	F_3^a	F_4^a	$G^{d,e}$	R_1
	$\varnothing 32$ H7	$\varnothing 25$ H7	$\varnothing 16$ max.	$\varnothing 16$	$\varnothing 4$ max.	$\varnothing 4$ max.	$\varnothing 4$ max.	$\varnothing 4$ max.	M8	M8	M8	M8	$\varnothing 4$ H13	max. R 2
<i>x</i>	23	23	23	—	-2	48	23	23	0	46	46	0	46	—
<i>y</i>	23	23	23	—	23	23	-2	48	0	0	46	46	33,5	—
<i>z</i>	$43 \pm 0,2$	$56 + 0,1$	—	—	—	—	—	—	—	—	—	—	8 min.	—

- ^a The minimum thread depth is 1,8 times the screw diameter, *D*. The recommended full thread depth is $2 \cdot D + 6$ mm to facilitate interchangeability of valves and to reduce the number of fixing screw lengths. However, sufficient distance from fixing hole to port B shall be respected. The recommended engagement of fixing screw thread for ferrous mounting is $1,25 \cdot D$.
- ^b Suggested diameter of port B, but may be of any size located within the space between the dimensions indicated as 20 mm and 42,5 mm; port B is not necessarily machined and may be provided by casting.
- ^c The depth and angle of the pilot ports and the main ports are determined by the graphical layout of the hydraulic circuit and by the location of the valves in the manifold.
- ^d Blind hole to accommodate the locating pin on the valve cover.
- ^e The depth of d_1 , d_2 and G are given in the tables as dimension *z*.

Dimensions and geometrical tolerances in millimetres

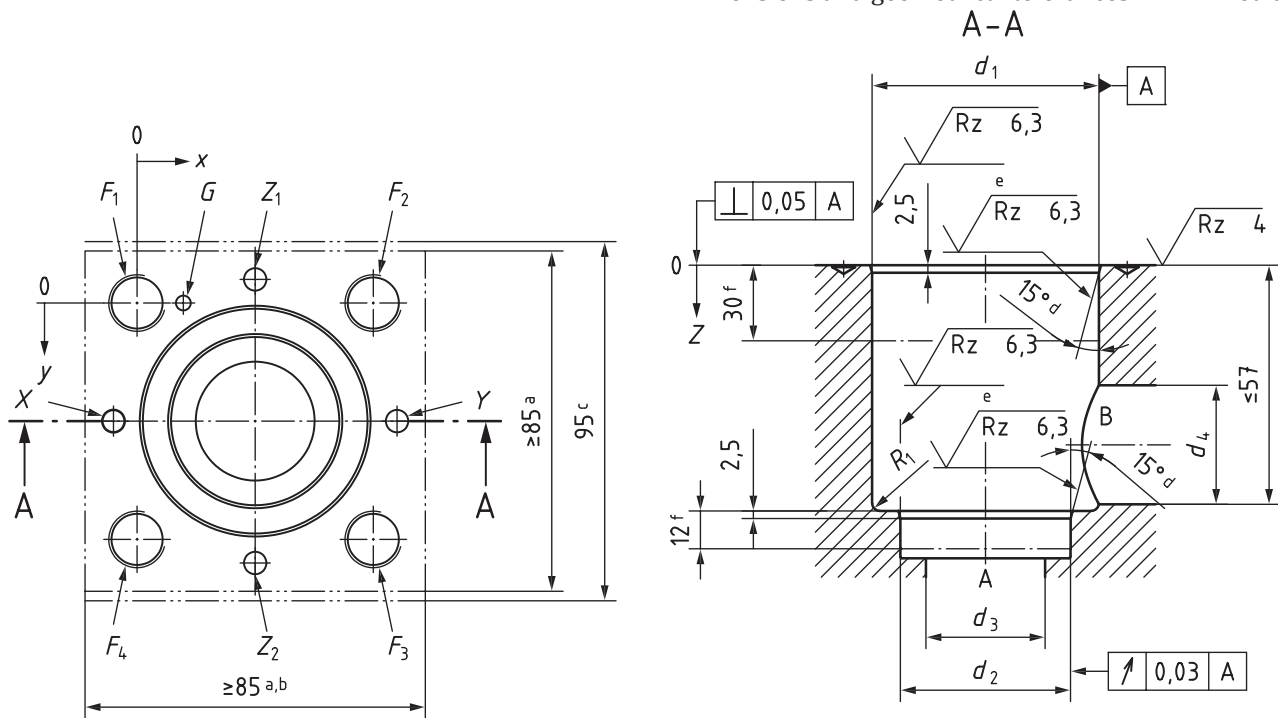

Key

- a The dimension specifying the area within the chain lines is the minimum dimension for mounting the cartridge valve cover. The corners of the square may be rounded to a maximum radius, r_{max} , equal to the thread diameter of the fixing screws. Along each axis, the fixing holes are at equal distances to the valve cover mounting surface edges.
- b Pilot valves and adjustment devices may exceed this dimension.
- c This dimension gives the minimum space required for a two-port hydraulic slip-in cartridge valve and its cover with this cavity. The dimension is also the minimum distance from centreline to centreline of two identical cavities on a manifold. The valve manufacturer's attention is drawn to the fact that no part of the complete valve assembly shall exceed this dimension.
- d No burrs permitted in this area; the edges shall be rounded.
- e Visual examination.
- f Minimum length over which the specified surface finish shall apply.

Figure 3 — Cavity for two-port hydraulic slip-in cartridge valves of all types, except main system pressure-relief valves, with main ports of 25 mm nominal diameter (size 08) and square flange cover (code: 7368 - 08 - 3 - 1 - 16)

Table 3 — Cavity for two-port hydraulic slip-in cartridge valves of all types, except main system pressure-relief valves, with main ports of 25 mm nominal diameter (size 08) and square flange cover

Dimensions in millimetres

Axis	d_1^e	d_2^e	d_3^c	$d_4^{b,c}$	X^c	Y^c	Z_1^c	Z_2^c	F_1^a	F_2^a	F_3^a	F_4^a	$G^{d,e}$	R_1
	$\varnothing 45$ H7	$\varnothing 34$ H7	$\varnothing 25$ max.	$\varnothing 25$	$\varnothing 6$ max.	$\varnothing 6$ max.	$\varnothing 6$ max.	$\varnothing 6$ max.	M12	M12	M12	M12	$\varnothing 6$ H13	max. R 2
x	29	29	29	—	-4	62	29	29	0	58	58	0	13	—
y	29	29	29	—	29	29	-4	62	0	0	58	58	0	—
z	$58 \pm 0,2$	$72 + 0,1$	—	—	—	—	—	—	—	—	—	—	8 min.	—

- ^a The minimum thread depth is 1,8 times the screw diameter, D . The recommended full thread depth is $2 \cdot D + 6$ mm to facilitate interchangeability of valves and to reduce the number of fixing screw lengths. However, sufficient distance from fixing hole to port B shall be respected. The recommended engagement of fixing screw thread for ferrous mounting is $1,25 \cdot D$.
- ^b Suggested diameter of port B, but may be of any size located within the space between the dimensions indicated as 30 mm and 57 mm; port B is not necessarily machined and may be provided by casting.
- ^c The depth and angle of the pilot ports and the main ports are determined by the graphical layout of the hydraulic circuit and by the location of the valves in the manifold.
- ^d Blind hole to accommodate the locating pin on the valve cover.
- ^e The depth of d_1 , d_2 and G are given in the tables as dimension z .

Dimensions and geometrical tolerances in millimetres

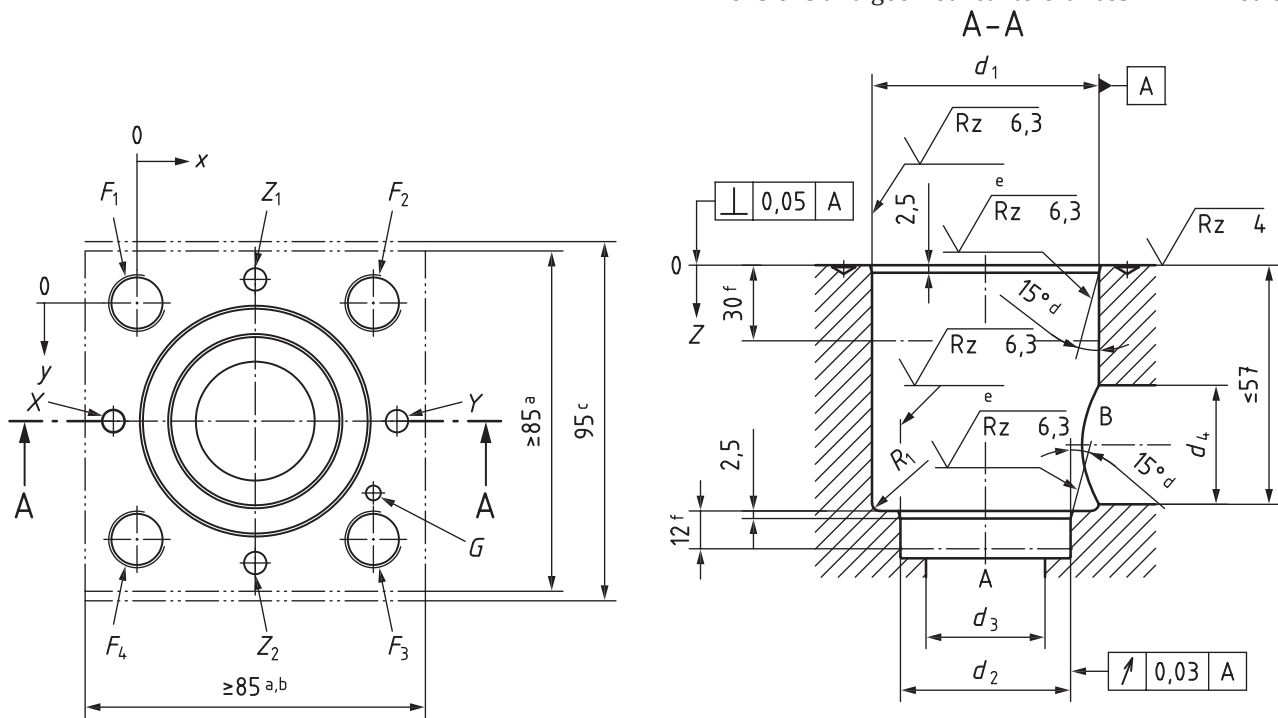

Key

- a The dimension specifying the area within the chain lines is the minimum dimension for mounting the cartridge valve cover. The corners of the square may be rounded to a maximum radius, r_{max} , equal to the thread diameter of the fixing screws. Along each axis, the fixing holes are at equal distances to the valve cover mounting surface edges.
- b Pilot valves and adjustment devices may exceed this dimension.
- c This dimension gives the minimum space required for a two-port hydraulic slip-in cartridge valve and its cover with this cavity. The dimension is also the minimum distance from centreline to centreline of two identical cavities on a manifold. The valve manufacturer's attention is drawn to the fact that no part of the complete valve assembly shall exceed this dimension.
- d No burrs permitted in this area; the edges shall be rounded.
- e Visual examination.
- f Minimum length over which the specified surface finish shall apply.

Figure 4 — Cavity for two-port hydraulic slip-in cartridge main system pressure-relief valves with main ports of 25 mm nominal diameter (size 08) and square flange cover (code: 7368 - 08 - 4 - 1 - 16)

Table 4 — Cavity for two-port hydraulic slip-in cartridge main system pressure-relief valves with main ports of 25 mm nominal diameter (size 08) and square flange cover

Dimensions in millimetres

Axis	d_1^e	d_2^e	d_3^c	$d_4^{b,c}$	X^c	Y^c	Z_1^c	Z_2^c	F_1^a	F_2^a	F_3^a	F_4^a	$G^{d,e}$	R_1
	$\varnothing 45$ H7	$\varnothing 34$ H7	$\varnothing 25$ max.	$\varnothing 25$	$\varnothing 6$ max.	$\varnothing 6$ max.	$\varnothing 6$ max.	$\varnothing 6$ max.	M12	M12	M12	M12	$\varnothing 6$ H13	max. R 2
x	29	29	29	—	-4	62	29	29	0	58	58	0	58	—
y	29	29	29	—	29	29	-4	62	0	0	58	58	45	—
z	$58 \pm 0,2$	$72 + 0,1$	—	—	—	—	—	—	—	—	—	—	8 min.	—

a The minimum thread depth is 1,8 times the screw diameter, D . The recommended full thread depth is $2 \cdot D + 6$ mm to facilitate interchangeability of valves and to reduce the number of fixing screw lengths. However, sufficient distance from fixing hole to port B shall be respected. The recommended engagement of fixing screw thread for ferrous mounting is $1,25 \cdot D$.

b Suggested diameter of port B, but may be of any size located within the space between the dimensions indicated as 30 mm and 57 mm; port B is not necessarily machined and may be provided by casting.

c The depth and angle of the pilot ports and the main ports are determined by the graphical layout of the hydraulic circuit and by the location of the valves in the manifold.

d Blind hole to accommodate the locating pin on the valve cover.

e The depth of d_1 , d_2 and G are given in the tables as dimension z .

Dimensions and geometrical tolerances in millimetres

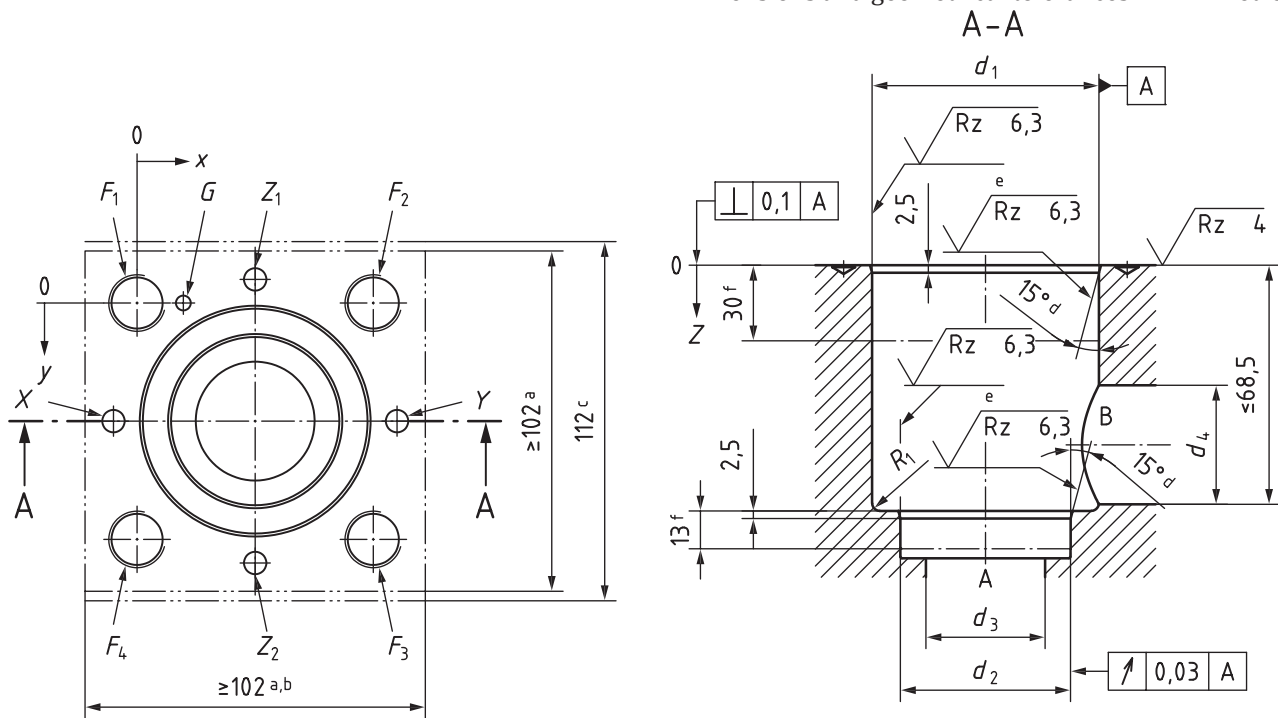

Key

- a The dimension specifying the area within the chain lines is the minimum dimension for mounting the cartridge valve cover. The corners of the square may be rounded to a maximum radius, r_{max} , equal to the thread diameter of the fixing screws. Along each axis, the fixing holes are at equal distances to the valve cover mounting surface edges.
- b Pilot valves and adjustment devices may exceed this dimension.
- c This dimension gives the minimum space required for a two-port hydraulic slip-in cartridge valve and its cover with this cavity. The dimension is also the minimum distance from centreline to centreline of two identical cavities on a manifold. The valve manufacturer's attention is drawn to the fact that no part of the complete valve assembly shall exceed this dimension.
- d No burrs permitted in this area; the edges shall be rounded.
- e Visual examination.
- f Minimum length over which the specified surface finish shall apply.

Figure 5 — Cavity for two-port hydraulic slip-in cartridge valves of all types, except main system pressure-relief valves, with main ports of 32 mm nominal diameter (size 09) and square flange cover (code: 7368 - 09 - 5 - 1 - 16)

Table 5 — Cavity for two-port hydraulic slip-in cartridge valves of all types, except main system pressure-relief valves, with main ports of 32 mm nominal diameter (size 09) and square flange cover

Dimensions in millimetres

Axis	d_1^e	d_2^e	d_3^c	$d_4^{b,c}$	X^c	Y^c	Z_1^c	Z_2^c	F_1^a	F_2^a	F_3^a	F_4^a	$G^{d,e}$	R_1
	$\varnothing 60$ H7	$\varnothing 45$ H7	$\varnothing 32$ max.	$\varnothing 32$	$\varnothing 8$ max.	$\varnothing 8$ max.	$\varnothing 8$ max.	$\varnothing 8$ max.	M16	M16	M16	M16	$\varnothing 6$ H13	max. R 2
x	35	35	35	—	-6	76	35	35	0	70	70	0	18	—
y	35	35	35	—	35	35	-6	76	0	0	70	70	0	—
z	$70 \pm 0,2$	$85 + 0,1$	—	—	—	—	—	—	—	—	—	—	8 min.	—

a The minimum thread depth is 1,8 times the screw diameter, D . The recommended full thread depth is $2 \cdot D + 6$ mm to facilitate interchangeability of valves and to reduce the number of fixing screw lengths. However, sufficient distance from fixing hole to port B shall be respected. The recommended engagement of fixing screw thread for ferrous mounting is $1,25 \cdot D$.

b Suggested diameter of port B, but may be of any size located within the space between the dimensions indicated as 30 mm and 68,5 mm; port B is not necessarily machined and may be provided by casting.

c The depth and angle of the pilot ports and the main ports are determined by the graphical layout of the hydraulic circuit and by the location of the valves in the manifold.

d Blind hole to accommodate the locating pin on the valve cover.

e The depth of d_1 , d_2 and G are given in the tables as dimension z .

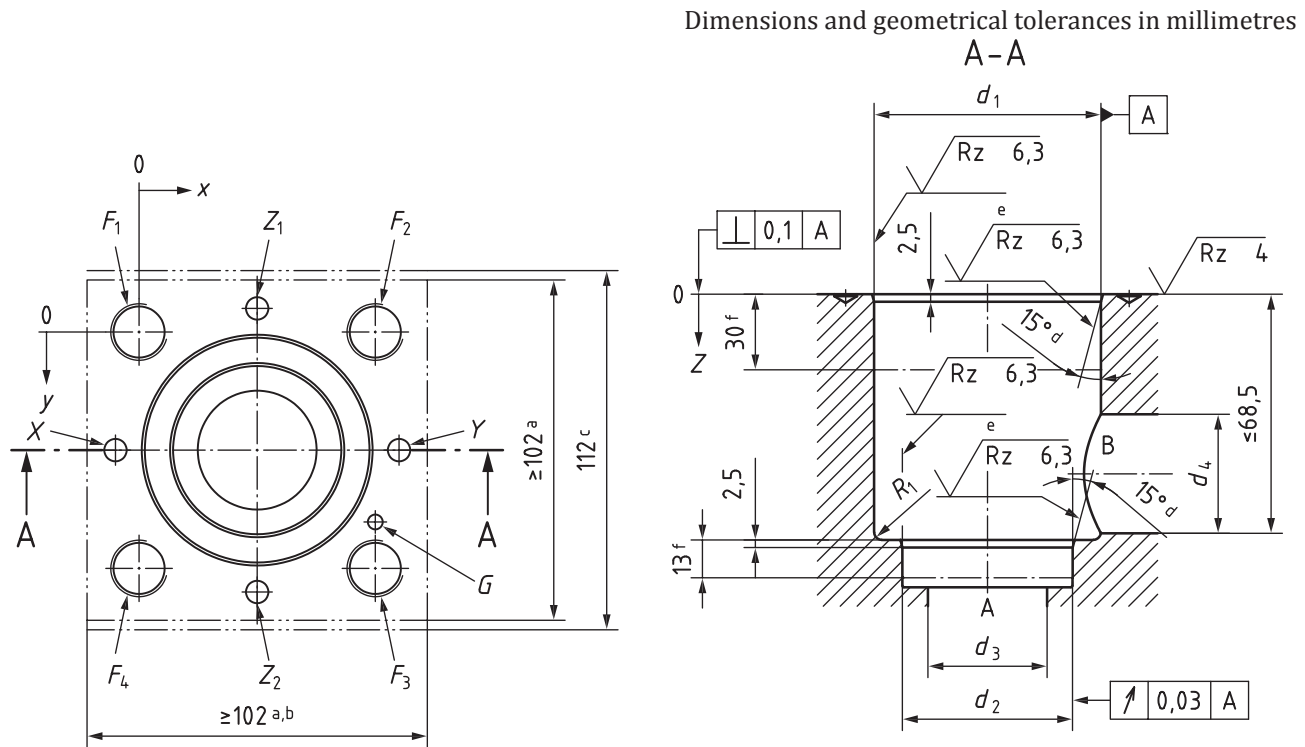

Key

- a The dimension specifying the area within the chain lines is the minimum dimension for mounting the cartridge valve cover. The corners of the square may be rounded to a maximum radius, r_{max} , equal to the thread diameter of the fixing screws. Along each axis, the fixing holes are at equal distances to the valve cover mounting surface edges.
- b Pilot valves and adjustment devices may exceed this dimension.
- c This dimension gives the minimum space required for a two-port hydraulic slip-in cartridge valve and its cover with this cavity. The dimension is also the minimum distance from centreline to centreline of two identical cavities on a manifold. The valve manufacturer's attention is drawn to the fact that no part of the complete valve assembly shall exceed this dimension.
- d No burrs permitted in this area; the edges shall be rounded.
- e Visual examination.
- f Minimum length over which the specified surface finish shall apply.

Figure 6 — Cavity for two-port hydraulic slip-in cartridge main system pressure-relief valves with main ports of 32 mm nominal diameter (size 09) and square flange cover (code: 7368 - 09 - 6 - 1 - 16)

Table 6 — Cavity for two-port hydraulic slip-in cartridge main system pressure-relief valves with main ports of 32 mm nominal diameter (size 09) and square flange cover

Dimensions in millimetres

Axis	d_1^e	d_2^e	d_3^c	$d_4^{b,c}$	X^c	Y^c	Z_1^c	Z_2^c	F_1^a	F_2^a	F_3^a	F_4^a	$G^{d,e}$	R_1
	$\varnothing 60$ H7	$\varnothing 45$ H7	$\varnothing 32$ max.	$\varnothing 32$	$\varnothing 8$ max.	$\varnothing 8$ max.	$\varnothing 8$ max.	$\varnothing 8$ max.	M16	M16	M16	M16	$\varnothing 6$ H13	max. R 2
x	35	35	35	—	-6	76	35	35	0	70	70	0	70	—
y	35	35	35	—	35	35	-6	76	0	0	70	70	52	—
z	$70 \pm 0,3$	$85 + 0,1$	—	—	—	—	—	—	—	—	—	—	8 min.	—

a The minimum thread depth is 1,8 times the screw diameter, D . The recommended full thread depth is $2 \cdot D + 6$ mm to facilitate interchangeability of valves and to reduce the number of fixing screw lengths. However, sufficient distance from fixing hole to port B shall be respected. The recommended engagement of fixing screw thread for ferrous mounting is $1,25 \cdot D$.

b Suggested diameter of port B, but may be of any size located within the space between the dimensions indicated as 30 mm and 68,5 mm; port B is not necessarily machined and may be provided by casting.

c The depth and angle of the pilot ports and the main ports are determined by the graphical layout of the hydraulic circuit and by the location of the valves in the manifold.

d Blind hole to accommodate the locating pin on the valve cover.

e The depth of d_1 , d_2 and G are given in the tables as dimension z .

Dimensions and geometrical tolerances in millimetres

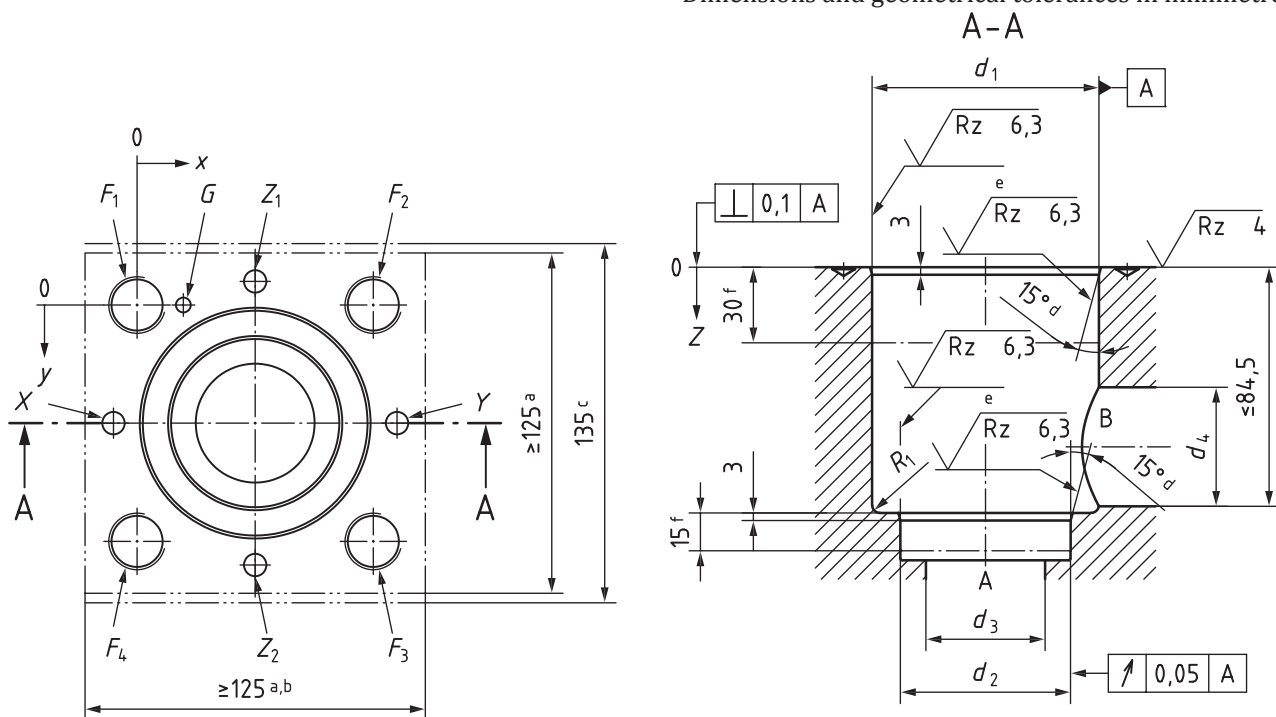

Key

- a The dimension specifying the area within the chain lines is the minimum dimension for mounting the cartridge valve cover. The corners of the square may be rounded to a maximum radius, r_{max} , equal to the thread diameter of the fixing screws. Along each axis, the fixing holes are at equal distances to the valve cover mounting surface edges.
- b Pilot valves and adjustment devices may exceed this dimension.
- c This dimension gives the minimum space required for a two-port hydraulic slip-in cartridge valve and its cover with this cavity. The dimension is also the minimum distance from centreline to centreline of two identical cavities on a manifold. The valve manufacturer's attention is drawn to the fact that no part of the complete valve assembly shall exceed this dimension.
- d No burrs permitted in this area; the edges shall be rounded.
- e Visual examination.
- f Minimum length over which the specified surface finish shall apply.

Figure 7 — Cavity for two-port hydraulic slip-in cartridge valves of all types, except main system pressure-relief valves, with main ports of 40 mm nominal diameter (size 10) and square flange cover (code: 7368 - 10 - 7 - 1 - 16)

Table 7 — Cavity for two-port hydraulic slip-in cartridge valves of all types, except main system pressure-relief valves, with main ports of 40 mm nominal diameter (size 10) and square flange cover

Dimensions in millimetres

Axis	d_1^e	d_2^e	d_3^c	$d_4^{b,c}$	X^c	Y^c	Z_1^c	Z_2^c	F_1^a	F_2^a	F_3^a	F_4^a	$G^{d,e}$	R_1
	$\varnothing 75$ H7	$\varnothing 55$ H7	$\varnothing 40$ max.	$\varnothing 40$	$\varnothing 10$ max.	$\varnothing 10$ max.	$\varnothing 10$ max.	$\varnothing 10$ max.	M20	M20	M20	M20	$\varnothing 6$ H13	max. R 4
x	42,5	42,5	42,5	—	-7,5	92,5	42,5	42,5	0	85	85	0	19,5	—
y	42,5	42,5	42,5	—	42,5	42,5	-7,5	92,5	0	0	85	85	0	—
z	$87 \pm 0,3$	$105 + 0,1$	—	—	—	—	—	—	—	—	—	—	8 min.	—

- ^a The minimum thread depth is 1,8 times the screw diameter, D . The recommended full thread depth is $2 \cdot D + 6$ mm to facilitate interchangeability of valves and to reduce the number of fixing screw lengths. However, sufficient distance from fixing hole to port B shall be respected. The recommended engagement of fixing screw thread for ferrous mounting is $1,25 \cdot D$.
- ^b Suggested diameter of port B, but may be of any size located within the space between the dimensions indicated as 30 mm and 84,5 mm; port B is not necessarily machined and may be provided by casting.
- ^c The depth and angle of the pilot ports and the main ports are determined by the graphical layout of the hydraulic circuit and by the location of the valves in the manifold.
- ^d Blind hole to accommodate the locating pin on the valve cover.
- ^e The depth of d_1 , d_2 and G are given in the tables as dimension z .

Dimensions and geometrical tolerances in millimetres

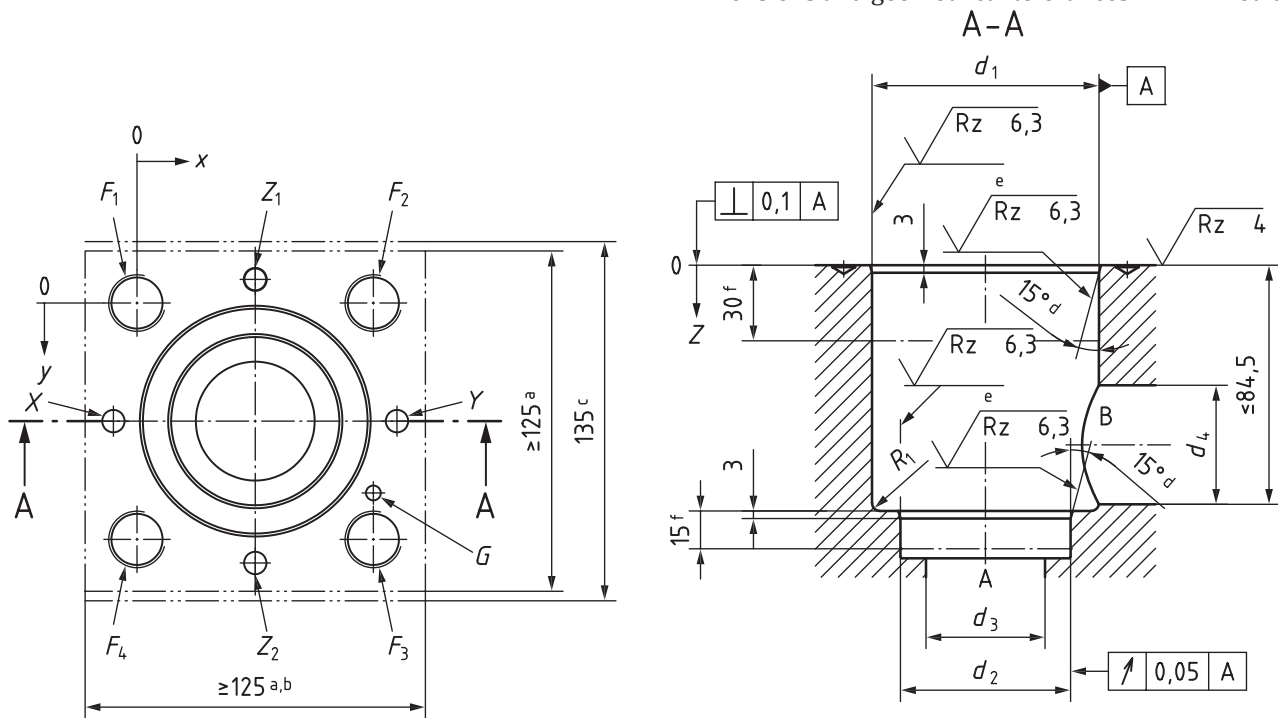

Key

- a The dimension specifying the area within the chain lines is the minimum dimension for mounting the cartridge valve cover. The corners of the square may be rounded to a maximum radius, r_{max} , equal to the thread diameter of the fixing screws. Along each axis, the fixing holes are at equal distances to the valve cover mounting surface edges.
- b Pilot valves and adjustment devices may exceed this dimension.
- c This dimension gives the minimum space required for a two-port hydraulic slip-in cartridge valve and its cover with this cavity. The dimension is also the minimum distance from centreline to centreline of two identical cavities on a manifold. The valve manufacturer's attention is drawn to the fact that no part of the complete valve assembly shall exceed this dimension.
- d No burrs permitted in this area; the edges shall be rounded.
- e Visual examination.
- f Minimum length over which the specified surface finish shall apply.

Figure 8 — Cavity for two-port hydraulic slip-in cartridge main system pressure-relief valves with main ports of 40 mm nominal diameter (size 10) and square flange cover (code: 7368 - 10 - 8 - 1 - 16)

Table 8 — Cavity for two-port hydraulic slip-in cartridge main system pressure-relief valves with main ports of 40 mm nominal diameter (size 10) and square flange cover

Dimensions in millimetres

Axis	d_1^e	d_2^e	d_3^c	$d_4^{b,c}$	X^c	Y^c	Z_1^c	Z_2^c	F_1^a	F_2^a	F_3^a	F_4^a	$G^{d,e}$	R_1
	$\varnothing 75$ H7	$\varnothing 55$ H7	$\varnothing 40$ max.	$\varnothing 40$	$\varnothing 10$ max.	$\varnothing 10$ max.	$\varnothing 10$ max.	$\varnothing 10$ max.	M20	M20	M20	M20	$\varnothing 6$ H13	max. R 4
x	42,5	42,5	42,5	—	-7,5	92,5	42,5	42,5	0	85	85	0	85	—
y	42,5	42,5	42,5	—	42,5	42,5	-7,5	92,5	0	0	85	85	65,5	—
z	$87 \pm 0,3$	$105 + 0,1$	—	—	—	—	—	—	—	—	—	—	8 min.	—

a The minimum thread depth is 1,8 times the screw diameter, D . The recommended full thread depth is $2 \cdot D + 6$ mm to facilitate interchangeability of valves and to reduce the number of fixing screw lengths. However, sufficient distance from fixing hole to port B shall be respected. The recommended engagement of fixing screw thread for ferrous mounting is $1,25 \cdot D$.

b Suggested diameter of port B, but may be of any size located within the space between the dimensions indicated as 30 mm and 84,5 mm; port B is not necessarily machined and may be provided by casting.

c The depth and angle of the pilot ports and the main ports are determined by the graphical layout of the hydraulic circuit and by the location of the valves in the manifold.

d Blind hole to accommodate the locating pin on the valve cover.

e The depth of d_1 , d_2 and G are given in the tables as dimension z .

Dimensions and geometrical tolerances in millimetres

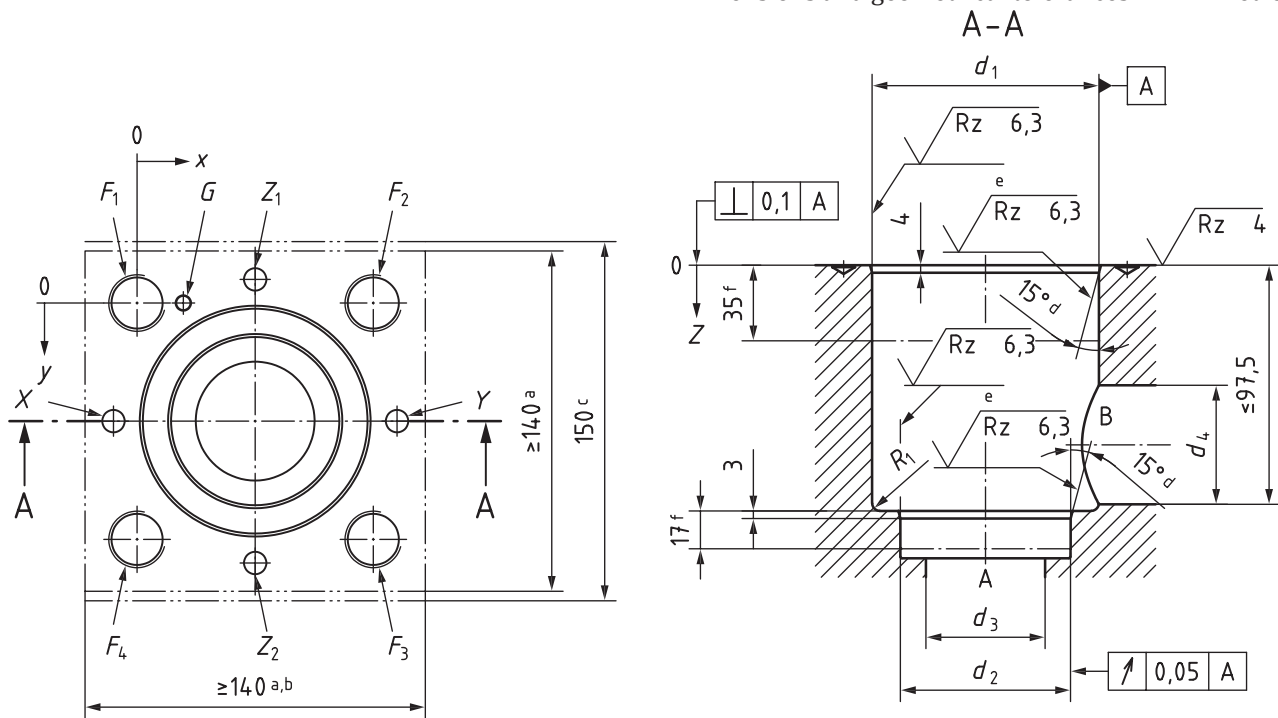

Key

- a The dimension specifying the area within the chain lines is the minimum dimension for mounting the cartridge valve cover. The corners of the square may be rounded to a maximum radius, r_{max} , equal to the thread diameter of the fixing screws. Along each axis, the fixing holes are at equal distances to the valve cover mounting surface edges.
- b Pilot valves and adjustment devices may exceed this dimension.
- c This dimension gives the minimum space required for a two-port hydraulic slip-in cartridge valve and its cover with this cavity. The dimension is also the minimum distance from centreline to centreline of two identical cavities on a manifold. The valve manufacturer's attention is drawn to the fact that no part of the complete valve assembly shall exceed this dimension.
- d No burrs permitted in this area; the edges shall be rounded.
- e Visual examination.
- f Minimum length over which the specified surface finish shall apply.

Figure 9 — Cavity for two-port hydraulic slip-in cartridge valves of all types, except main system pressure-relief valves, with main ports of 50 mm nominal diameter (size 11) and square flange cover (code: 7368 - 11 - 9 - 1 - 16)

Table 9 — Cavity for two-port hydraulic slip-in cartridge valves of all types, except main system pressure-relief valves, with main ports of 50 mm nominal diameter (size 11) and square flange cover

Dimensions in millimetres

Axis	d_1^e	d_2^e	d_3^c	$d_4^{b,c}$	X^c	Y^c	Z_1^c	Z_2^c	F_1^a	F_2^a	F_3^a	F_4^a	$G^{d,e}$	R_1
	$\varnothing 90$ H7	$\varnothing 68$ H7	$\varnothing 50$ max.	$\varnothing 50$	$\varnothing 10$ max.	$\varnothing 10$ max.	$\varnothing 10$ max.	$\varnothing 10$ max.	M20	M20	M20	M20	$\varnothing 8$ H13	max. R 4
x	50	50	50	—	-8	108	50	50	0	100	100	0	20	—
y	50	50	50	—	50	50	-8	108	0	0	100	100	0	—
z	$100 \pm 0,3$	$122 + 0,1$	—	—	—	—	—	—	—	—	—	—	8 min.	—

- a The minimum thread depth is 1,8 times the screw diameter, D . The recommended full thread depth is $2 \cdot D + 6$ mm to facilitate interchangeability of valves and to reduce the number of fixing screw lengths. However, sufficient distance from fixing hole to port B shall be respected. The recommended engagement of fixing screw thread for ferrous mounting is $1,25 \cdot D$.
- b Suggested diameter of port B, but may be of any size located within the space between the dimensions indicated as 35 mm and 97,5 mm; port B is not necessarily machined and may be provided by casting.
- c The depth and angle of the pilot ports and the main ports are determined by the graphical layout of the hydraulic circuit and by the location of the valves in the manifold.
- d Blind hole to accommodate the locating pin on the valve cover.
- e The depth of d_1 , d_2 and G are given in the tables as dimension z .

Dimensions and geometrical tolerances in millimetres

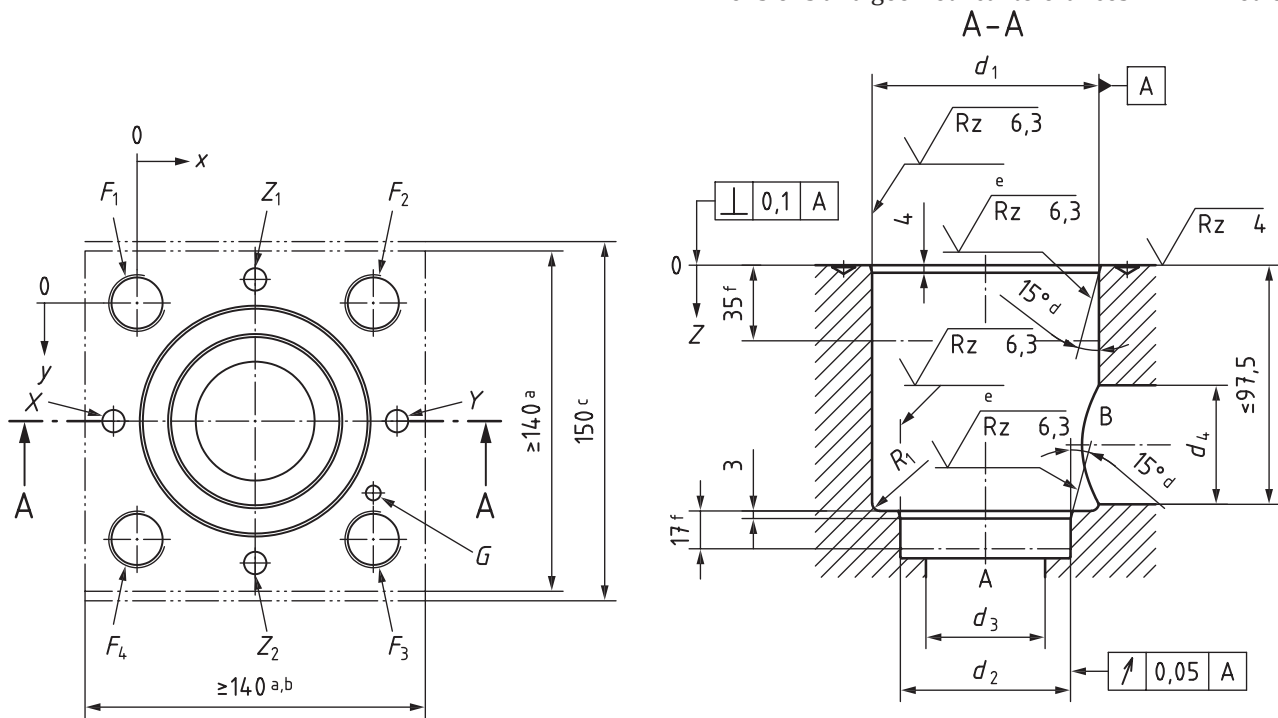

Key

- a The dimension specifying the area within the chain lines is the minimum dimension for mounting the cartridge valve cover. The corners of the square may be rounded to a maximum radius, r_{max} , equal to the thread diameter of the fixing screws. Along each axis, the fixing holes are at equal distances to the valve cover mounting surface edges.
- b Pilot valves and adjustment devices may exceed this dimension.
- c This dimension gives the minimum space required for a two-port hydraulic slip-in cartridge valve and its cover with this cavity. The dimension is also the minimum distance from centreline to centreline of two identical cavities on a manifold. The valve manufacturer's attention is drawn to the fact that no part of the complete valve assembly shall exceed this dimension.
- d No burrs permitted in this area; the edges shall be rounded.
- e Visual examination.
- f Minimum length over which the specified surface finish shall apply.

Figure 10 — Cavity for two-port hydraulic slip-in cartridge main system pressure-relief valves with main ports of 50 mm nominal diameter (size 11) and square flange cover (code: 7368 - 11 - 10 - 1 - 16)

Table 10 — Cavity for two-port hydraulic slip-in cartridge main system pressure-relief valves with main ports of 50 mm nominal diameter (size 11) and square flange cover

Dimensions in millimetres

Axis	d_1^e	d_2^e	d_3^c	$d_4^{b,c}$	X^c	Y^c	Z_1^c	Z_2^c	F_1^a	F_2^a	F_3^a	F_4^a	$G^{d,e}$	R_1
	$\varnothing 90$ H7	$\varnothing 68$ H7	$\varnothing 50$ max.	$\varnothing 50$	$\varnothing 10$ max.	$\varnothing 10$ max.	$\varnothing 10$ max.	$\varnothing 10$ max.	M20	M20	M20	M20	$\varnothing 8$ H13	max. R 4
x	50	50	50	—	-8	108	50	50	0	100	100	0	100	—
y	50	50	50	—	50	50	-8	108	0	0	100	100	80	—
z	$100 \pm 0,3$	$122 + 0,1$	—	—	—	—	—	—	—	—	—	—	8 min.	—

a The minimum thread depth is 1,8 times the screw diameter, D . The recommended full thread depth is $2 \cdot D + 6$ mm to facilitate interchangeability of valves and to reduce the number of fixing screw lengths. However, sufficient distance from fixing hole to port B shall be respected. The recommended engagement of fixing screw thread for ferrous mounting is $1,25 \cdot D$.

b Suggested diameter of port B, but may be of any size located within the space between the dimensions indicated as 35 mm and 97,5 mm; port B is not necessarily machined and may be provided by casting.

c The depth and angle of the pilot ports and the main ports are determined by the graphical layout of the hydraulic circuit and by the location of the valves in the manifold.

d Blind hole to accommodate the locating pin on the valve cover.

e The depth of d_1 , d_2 and G are given in the tables as dimension z .

Dimensions and geometrical tolerances in millimetres

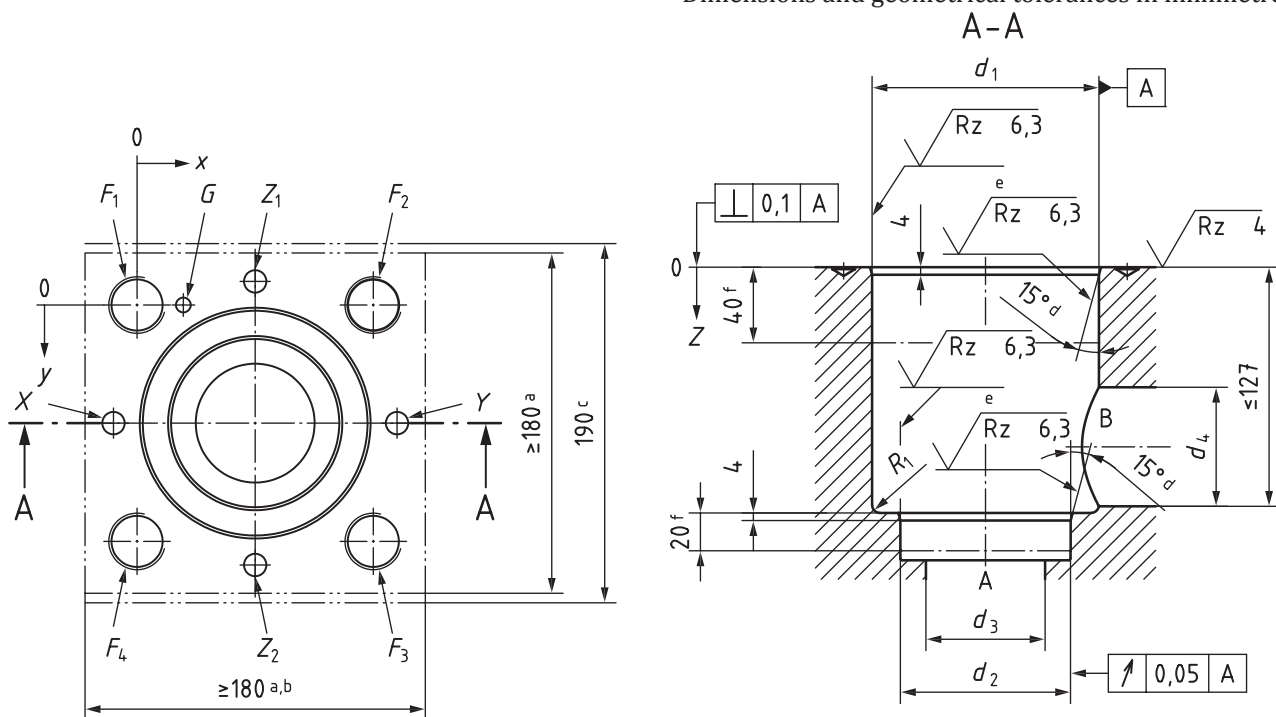

Key

- a The dimension specifying the area within the chain lines is the minimum dimension for mounting the cartridge valve cover. The corners of the square may be rounded to a maximum radius, r_{max} , equal to the thread diameter of the fixing screws. Along each axis, the fixing holes are at equal distances to the valve cover mounting surface edges.
- b Pilot valves and adjustment devices may exceed this dimension.
- c This dimension gives the minimum space required for a two-port hydraulic slip-in cartridge valve and its cover with this cavity. The dimension is also the minimum distance from centreline to centreline of two identical cavities on a manifold. The valve manufacturer's attention is drawn to the fact that no part of the complete valve assembly shall exceed this dimension
- d No burrs permitted in this area; the edges shall be rounded.
- e Visual examination.
- f Minimum length over which the specified surface finish shall apply.

Figure 11 — Cavity for two-port hydraulic slip-in cartridge valves of all types, except main system pressure-relief valves, with main ports of 63 mm nominal diameter (size 12) and square flange cover (code: 7368 - 12 - 11 - 1 - 16)

Table 11 — Cavity for two-port hydraulic slip-in cartridge valves of all types, except main system pressure-relief valves, with main ports of 63 mm nominal diameter (size 12) and square flange cover

Dimensions in millimetres

Axis	d_1^e	d_2^e	d_3^c	$d_4^{b,c}$	X^c	Y^c	Z_1^c	Z_2^c	F_1^a	F_2^a	F_3^a	F_4^a	$G^{d,e}$	R_1
	$\varnothing 120$ H7	$\varnothing 90$ H7	$\varnothing 63$ max.	$\varnothing 63$	$\varnothing 12$ max.	$\varnothing 12$ max.	$\varnothing 12$ max.	$\varnothing 12$ max.	M30	M30	M30	M30	$\varnothing 8$ H13	max. R 4
x	62,5	62,5	62,5	—	-12,5	137,5	62,5	62,5	0	125	125	0	24,5	—
y	62,5	62,5	62,5	—	62,5	62,5	-12,5	137,5	0	0	125	125	0	—
z	130 ± 0,3	155 + 0,1	—	—	—	—	—	—	—	—	—	—	8 min.	—

- ^a The minimum thread depth is 1,8 times the screw diameter, D . The recommended full thread depth is $2 \cdot D + 6$ mm to facilitate interchangeability of valves and to reduce the number of fixing screw lengths. However, sufficient distance from fixing hole to port B shall be respected. The recommended engagement of fixing screw thread for ferrous mounting is $1,25 \cdot D$.
- ^b Suggested diameter of port B, but may be of any size located within the space between the dimensions indicated as 40 mm and 127 mm; port B is not necessarily machined and may be provided by casting.
- ^c The depth and angle of the pilot ports and the main ports are determined by the graphical layout of the hydraulic circuit and by the location of the valves in the manifold.
- ^d Blind hole to accommodate the locating pin on the valve cover.
- ^e The depth of d_1 , d_2 and G are given in the tables as dimension z .

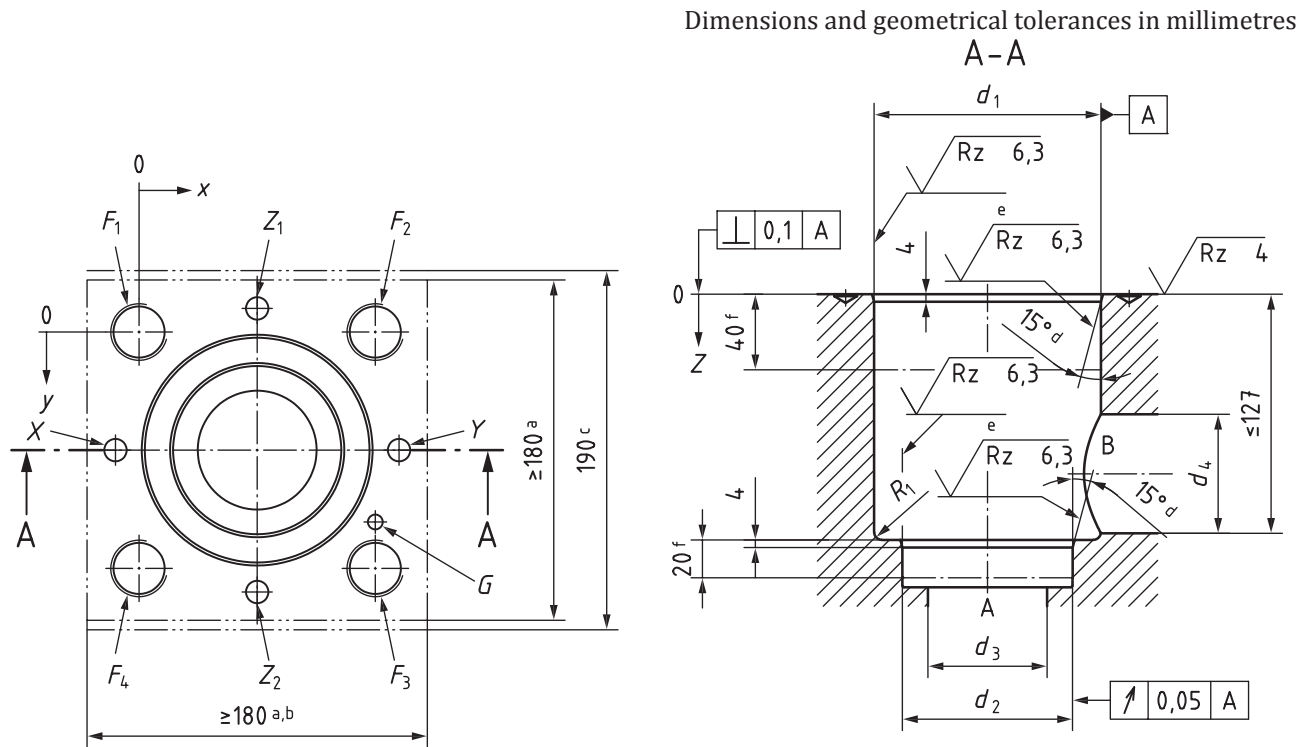

Key

- a The dimension specifying the area within the chain lines is the minimum dimension for mounting the cartridge valve cover. The corners of the square may be rounded to a maximum radius, r_{max} , equal to the thread diameter of the fixing screws. Along each axis, the fixing holes are at equal distances to the valve cover mounting surface edges.
- b Pilot valves and adjustment devices may exceed this dimension.
- c This dimension gives the minimum space required for a two-port hydraulic slip-in cartridge valve and its cover with this cavity. The dimension is also the minimum distance from centreline to centreline of two identical cavities on a manifold. The valve manufacturer's attention is drawn to the fact that no part of the complete valve assembly shall exceed this dimension.
- d No burrs permitted in this area; the edges shall be rounded.
- e Visual examination.
- f Minimum length over which the specified surface finish shall apply.

Figure 12 — Cavity for two-port hydraulic slip-in cartridge main system pressure-relief valves with main ports of 63 mm nominal diameter (size 12) and square flange cover (code: 7368 - 12 - 12 - 1 - 16)

Table 12 — Cavity for two-port hydraulic slip-in cartridge main system pressure-relief valves with main ports of 63 mm nominal diameter (size 12) and square flange cover

Dimensions in millimetres

Axis	d_1^e	d_2^e	d_3^c	$d_4^{b,c}$	X^c	Y^c	Z_1^c	Z_2^c	F_1^a	F_2^a	F_3^a	F_4^a	$G^{d,e}$	R_1
	$\varnothing 120$ H7	$\varnothing 90$ H7	$\varnothing 63$ max.	$\varnothing 63$	$\varnothing 12$ max.	$\varnothing 12$ max.	$\varnothing 12$ max.	$\varnothing 12$ max.	M30	M30	M30	M30	$\varnothing 8$ H13	max. R 4
x	62,5	62,5	62,5	—	-12,5	137,5	62,5	62,5	0	125	125	0	125	—
y	62,5	62,5	62,5	—	62,5	62,5	-12,5	137,5	0	0	125	125	100,5	—
z	$130 \pm 0,3$	$155 + 0,1$	—	—	—	—	—	—	—	—	—	—	8 min.	—

a The minimum thread depth is 1,8 times the screw diameter, D . The recommended full thread depth is $2 \cdot D + 6$ mm to facilitate interchangeability of valves and to reduce the number of fixing screw lengths. However, sufficient distance from fixing hole to port B shall be respected. The recommended engagement of fixing screw thread for ferrous mounting is $1,25 \cdot D$.

b Suggested diameter of port B, but may be of any size located within the space between the dimensions indicated as 40 mm and 127 mm; port B is not necessarily machined and may be provided by casting.

c The depth and angle of the pilot ports and the main ports are determined by the graphical layout of the hydraulic circuit and by the location of the valves in the manifold.

d Blind hole to accommodate the locating pin on the valve cover.

e The depth of d_1 , d_2 and G are given in the tables as dimension z .

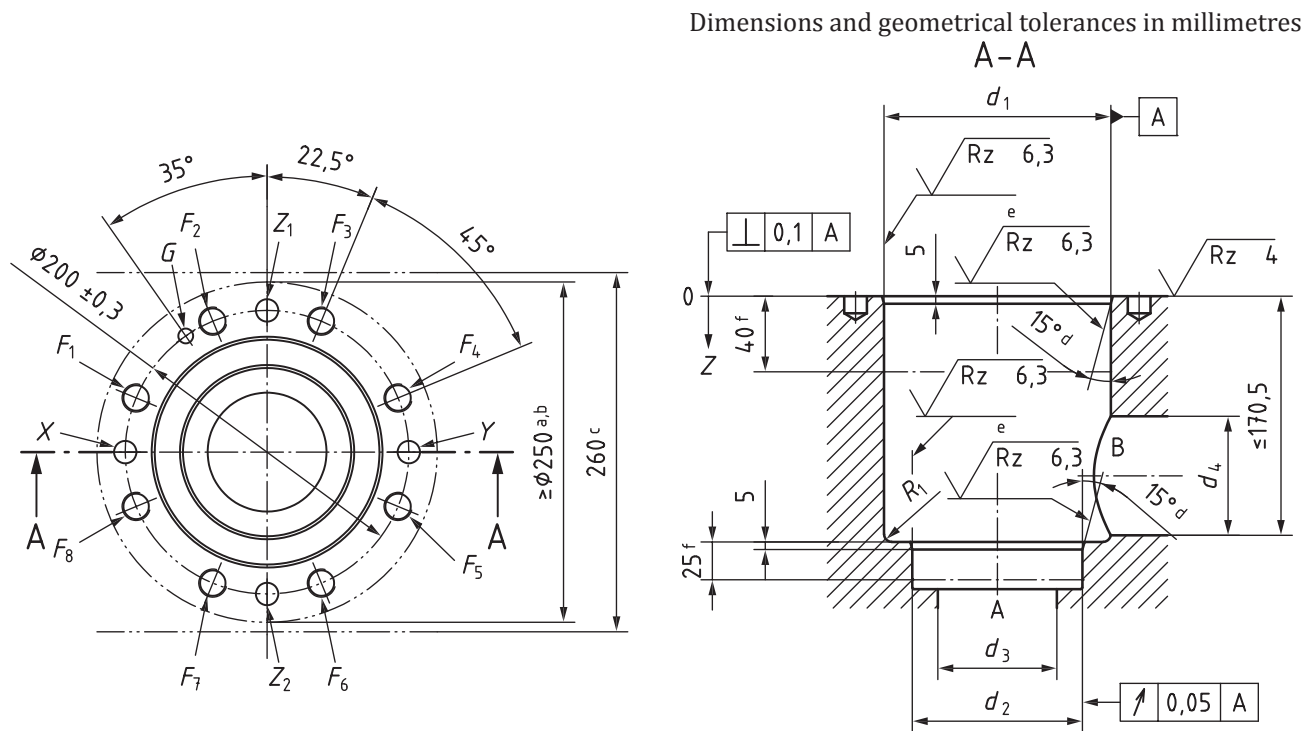

Key

- a The dimension specifying the area within the chain lines is the minimum dimension for mounting the cartridge valve cover. The fixing holes are arranged on a circular centre axis at equal distance to the valve cover mounting surface edges.
- b Pilot valves and adjustment devices may exceed this dimension.
- c This dimension gives the minimum space required for a two-port hydraulic slip-in cartridge valve and its cover with this cavity. The dimension is also the minimum distance from centreline to centreline of two identical cavities on a manifold. The valve manufacturer's attention is drawn to the fact that no part of the complete valve assembly shall exceed this dimension.
- d No burrs permitted in this area; the edges shall be rounded.
- e Visual examination.
- f Minimum length over which the specified surface finish shall apply.

Figure 13 — Cavity for two-port hydraulic slip-in cartridge valves of all types, except main system pressure-relief valves, with main ports of 80 mm nominal diameter (size 13) and circular flange cover (code 7368 - 13 - 13 - 1 - 16)

Table 13 — Cavity for two-port hydraulic slip-in cartridge valves of all types, except main system pressure-relief valves, with main ports of 80 mm nominal diameter (size 13) and circular flange cover

Dimensions in millimetres

	d_1^e	d_2^e	d_3^c	$d_{4^{b,c}}$	X^c	Y^c	Z_1^c	Z_2^c	F_1^a	F_2^a	F_3^a	F_4^a	F_5^a	F_6^a	F_7^a	F_8^a	$G^{d,e}$	R_1
Dimension	$\emptyset 145 \text{ H7}$	$\emptyset 110 \text{ H7}$	$\emptyset 80$ max.	$\emptyset 80$	$\emptyset 16$ max.	$\emptyset 16$ max.	$\emptyset 16$ max.	$\emptyset 16$ max.	M24	M24	M24	M24	M24	M24	M24	M24	$\emptyset 10$ H13	max. R 4
z	$175 \pm 0,4$	$205 +0,1$	—	—	—	—	—	—	—	—	—	—	—	—	—	—	8 min.	—

a The minimum thread depth is 1,8 times the screw diameter, D . The recommended full thread depth is $2 \cdot D + 6$ mm to facilitate interchangeability of valves and to reduce the number of fixing screw lengths. However, sufficient distance from fixing hole to port B shall be respected. The recommended engagement of fixing screw thread for ferrous mounting is $1,25 \cdot D$.

b Suggested diameter of port B, but may be of any size located within the space between the dimensions indicated as 40 mm and 170,5 mm; port B is not necessarily machined and may be provided by casting.

c The depth and angle of the pilot ports and the main ports are determined by the graphical layout of the hydraulic circuit and by the location of the valves in the manifold.

d Blind hole to accommodate the locating pin on the valve cover.

e The depth of d_1 , d_2 and G are given in the tables as dimension z .

Dimensions and geometrical tolerances in millimetres

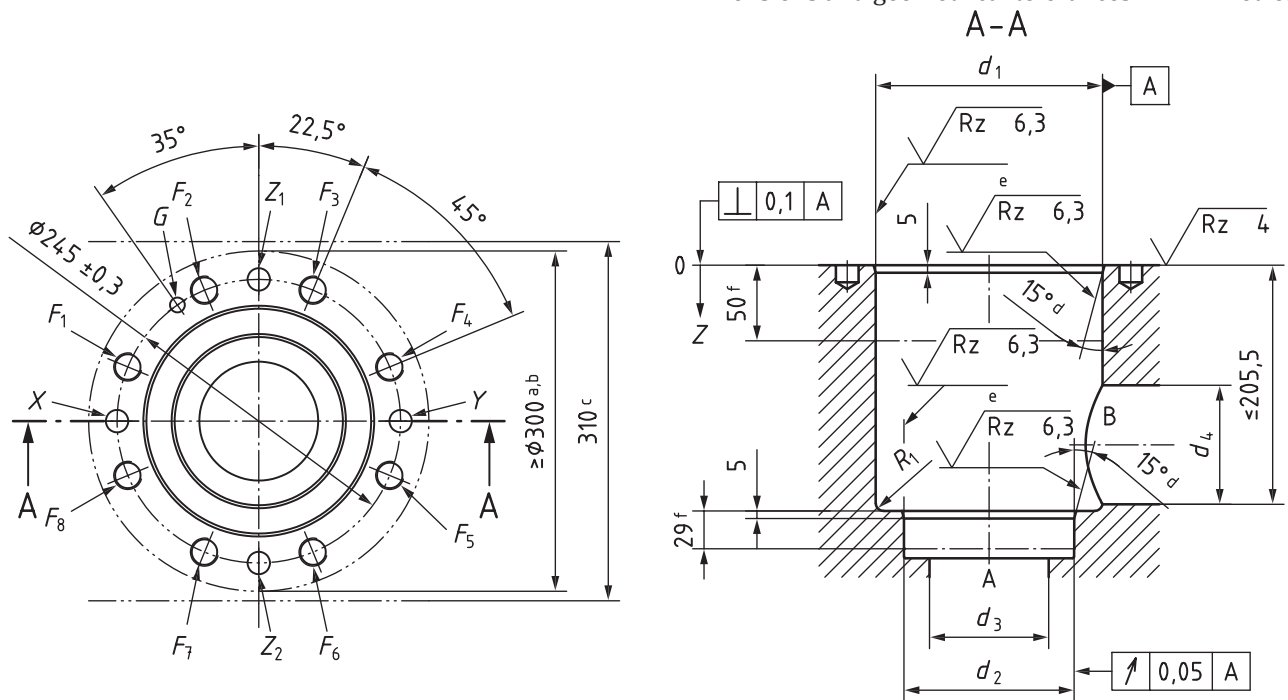

Key

- a The dimension specifying the area within the chain lines is the minimum dimension for mounting the cartridge valve cover. The fixing holes are arranged on a circular centre axis at equal distance to the valve cover mounting surface edges.
- b Pilot valves and adjustment devices may exceed this dimension.
- c This dimension gives the minimum space required for a two-port hydraulic slip-in cartridge valve and its cover with this cavity. The dimension is also the minimum distance from centreline to centreline of two identical cavities on a manifold. The valve manufacturer's attention is drawn to the fact that no part of the complete valve assembly shall exceed this dimension.
- d No burrs permitted in this area; the edges shall be rounded.
- e Visual examination.
- f Minimum length over which the specified surface finish shall apply.

Figure 14 — Cavity for two-port hydraulic slip-in cartridge valves of all types, except main system pressure-relief valves, with main ports of 100 mm nominal diameter (size 14) and circular flange cover (code: 7368 - 14 - 14 - 1 - 16)

Table 14 — Cavity for two-port hydraulic slip-in cartridge valves of all types, except main system pressure-relief valves, with main ports of 100 mm nominal diameter (size 14) and circular flange cover

Dimensions in millimetres

Dimension	d_1^e	d_2^e	d_3^c	$d_4^{b,c}$	X^c	Y^c	Z_1^c	Z_2^c	F_1^a	F_2^a	F_3^a	F_4^a	F_5^a	F_6^a	F_7^a	F_8^a	$G^{d,e}$	R_1
	$\emptyset 180$ H7	$\emptyset 135$ H7	$\emptyset 100$ max.	$\emptyset 100$	$\emptyset 20$ max.	$\emptyset 20$ max.	$\emptyset 20$ max.	$\emptyset 20$ max.	M30	M30	M30	M30	M30	M30	M30	M30	$\emptyset 10$ H13	max. R 4
z	$210 \pm 0,4$	$245 + 0,1$	—	—	—	—	—	—	—	—	—	—	—	—	—	—	8 min.	—

a The minimum thread depth is 1,8 times the screw diameter, D . The recommended full thread depth is $2 \cdot D + 6$ mm to facilitate interchangeability of valves and to reduce the number of fixing screw lengths. However, sufficient distance from fixing hole to port B shall be respected. The recommended engagement of fixing screw thread for ferrous mounting is $1,25 \cdot D$.

b Suggested diameter of port B, but may be of any size located within the space between the dimensions indicated as 50 mm and 205,5 mm; port B is not necessarily machined and may be provided by casting.

c The depth and angle of the pilot ports and the main ports are determined by the graphical layout of the hydraulic circuit and by the location of the valves in the manifold.

d Blind hole to accommodate the locating pin on the valve cover.

e The depth of d_1 , d_2 and G are given in the tables as dimension z .

Dimensions and geometrical tolerances in millimetres

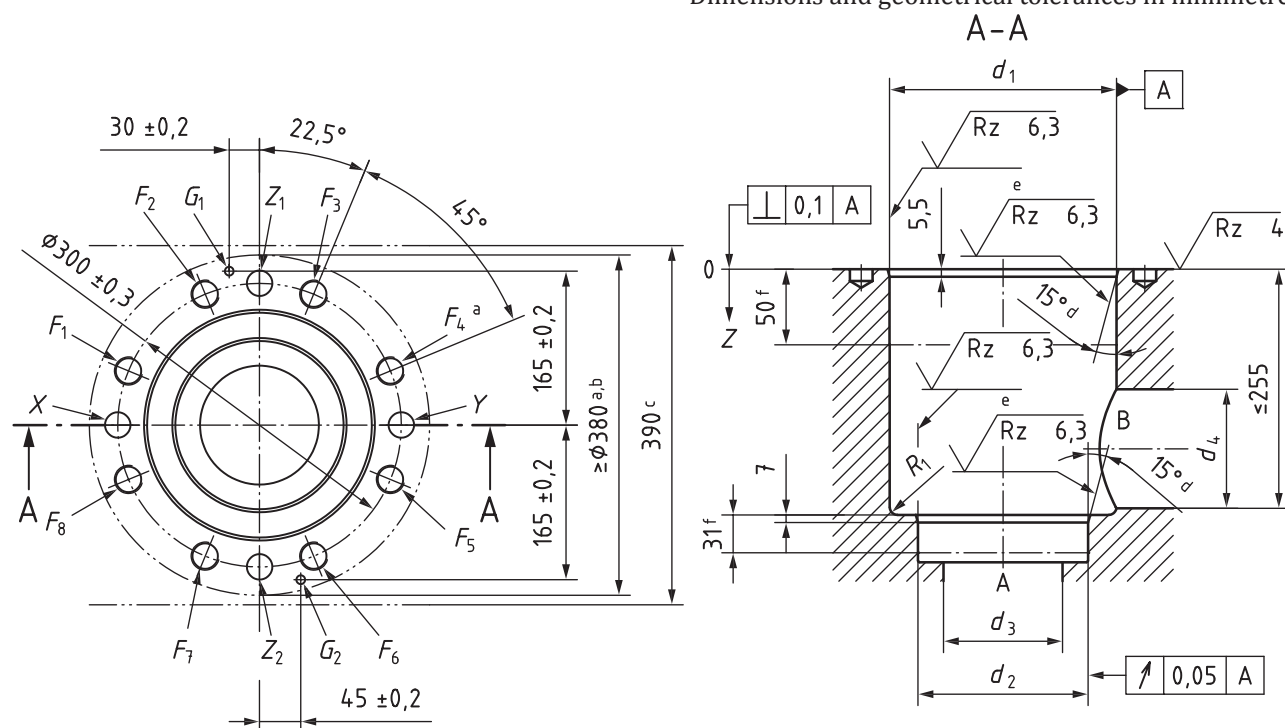

Key

- a The dimension specifying the area within the chain lines is the minimum dimension for mounting the cartridge valve cover. The fixing holes are arranged on a circular centre axis at equal distance to the valve cover mounting surface edges.
- b Pilot valves and adjustment devices may exceed this dimension.
- c This dimension gives the minimum space required for a two-port hydraulic slip-in cartridge valve and its cover with this cavity. The dimension is also the minimum distance from centreline to centreline of two identical cavities on a manifold. The valve manufacturer's attention is drawn to the fact that no part of the complete valve assembly shall exceed this dimension.
- d No burrs permitted in this area; the edges shall be rounded.
- e Visual examination.
- f Minimum length over which the specified surface finish shall apply.

Figure 15 — Cavity for two-port hydraulic slip-in cartridge valves of all types, except main system pressure-relief valves, with main ports of 125 mm nominal diameter (size 15) and circular flange cover (code: 7368 - 15 - 15 - 1 - 16)

Table 15 — Cavity for two-port hydraulic slip-in cartridge valves of all types, except main system pressure-relief valves, with main ports of 125 mm nominal diameter (size 15) and circular flange cover

Dimensions in millimetres

Dimension	d_1^e	d_2^e	d_3^c	$d_4^{b,c}$	X^c	Y^c	Z_1^c	Z_2^c	F_1^a	F_2^a	F_3^a	F_4^a	F_5^a	F_6^a	F_7^a	F_8^a	$G_1^{d,e}$	$G_2^{d,e}$	R_1
z	$\emptyset 225$ H7	$\emptyset 200$ H7	$\emptyset 150$ max.	$\emptyset 125$	$\emptyset 32$ max.	$\emptyset 32$ max.	$\emptyset 32$ max.	$\emptyset 32$ max.	M36	M36	M36	M36	M36	M36	M36	M36	$\emptyset 10$ H13	$\emptyset 10$ H13	max. R 4
z	$257 \pm 0,5$	$300 + 0,15$	—	—	—	—	—	—	—	—	—	—	—	—	—	—	10 min.	10 min.	—

a The minimum thread depth is 1,8 times the screw diameter, D . The recommended full thread depth is $2 \bullet D + 6$ mm to facilitate interchangeability of valves and to reduce the number of fixing screw lengths. However, sufficient distance from fixing hole to port B shall be respected. The recommended engagement of fixing screw thread for ferrous mounting is $1,25 \bullet D$.

b Suggested diameter of port B, but may be of any size located within the space between the dimensions indicated as 50 mm and 255 mm; port B is not necessarily machined and may be provided by casting.

c The depth and angle of the pilot ports and the main ports are determined by the graphical layout of the hydraulic circuit and by the location of the valves in the manifold.

d Blind hole to accommodate the locating pin on the valve cover.

e The depth of d_1 , d_2 , G_1 and G_2 are given in the tables as dimension z .

Dimensions and geometrical tolerances in millimetres

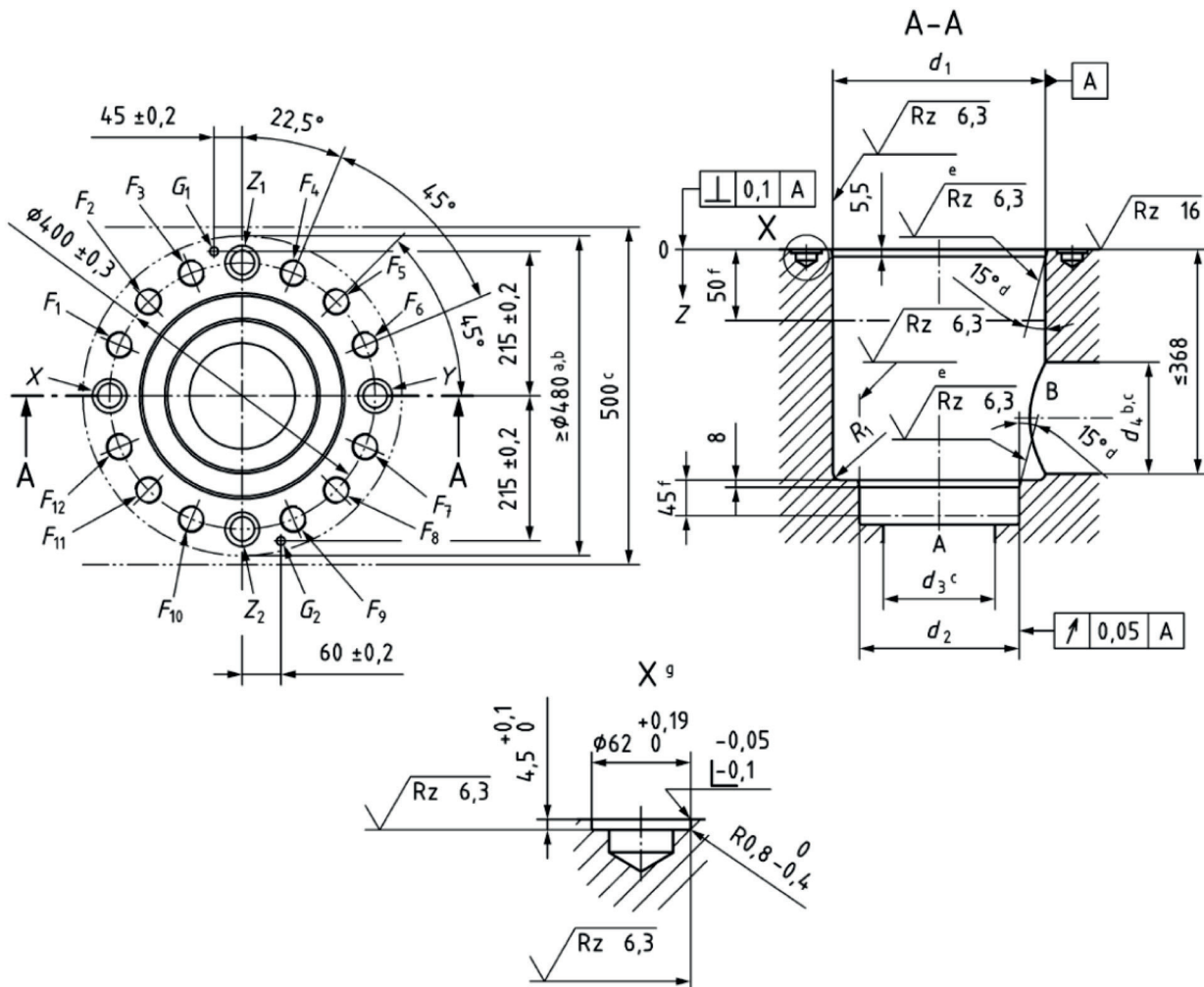

Key

- a The dimension specifying the area within the chain lines is the minimum dimension for mounting the cartridge valve cover. The fixing holes are arranged on a circular centre axis at equal distance to the valve cover mounting surface edges.
- b Pilot valves and adjustment devices may exceed this dimension.
- c This dimension gives the minimum space required for a two-port hydraulic slip-in cartridge valve and its cover with this cavity. The dimension is also the minimum distance from centreline to centreline of two identical cavities on a manifold. The valve manufacturer's attention is drawn to the fact that no part of the complete valve assembly shall exceed this dimension.
- d No burrs permitted in this area; the edges shall be rounded.
- e Visual examination.
- f Minimum length over which the specified surface finish shall apply.
- g Ports X, Y, Z₁ and Z₂.

Figure 16 — Cavity for two-port hydraulic slip-in cartridge valves of all types, except main system pressure-relief valves, with main ports of 16 mm nominal diameter (size 16) and circular flange cover (code: 7368 - 16 - 16 - 1 - 16)

Table 16 — Cavity for two-port hydraulic slip-in cartridge valves of all types, except main system pressure-relief valves, with main ports of 160 mm nominal diameter (size 16) and circular flange cover

Dimensions in millimetres

Dimension	d_1^e	d_2^e	d_3^c	$d_{4^{b,c}}$	X^c	Y^c	Z_1^c	Z_2^c	F_1^a	F_2^a	F_3^a	F_4^a	F_5^a	F_6^a	F_7^a	F_8^a	F_9^a	F_{10}^a	F_{11}^a	F_{12}^a	$G_1^{d,e}$	$G_2^{d,e}$	R_1	
	\emptyset 300 H7	\emptyset 270 H7	\emptyset 200 max.	\emptyset 160	\emptyset 40 max.	\emptyset 40 max.	\emptyset 40 max.	\emptyset 40 max.	M42	M42	M42	M42	M42	M42	M42	M42	M42	M42	M42	M42	M42	\emptyset 10 H13	\emptyset 10 H13	max. R 6,3
z	$370 \pm 0,5$	$425 + 0,15$	—	—	—	—	—	—	—	—	—	—	—	—	—	—	—	—	—	—	10 min.	10 min.	—	

a The minimum thread depth is 1,8 times the screw diameter, D . The recommended full thread depth is $2 \bullet D + 6$ mm to facilitate interchangeability of valves and to reduce the number of fixing screw lengths. However, sufficient distance from fixing hole to port B shall be respected. The recommended engagement of fixing screw thread for ferrous mounting is $1,25 \bullet D$.

b Suggested diameter of port B, but may be of any size located within the space between the dimensions indicated as 50 mm and 368 mm; port B is not necessarily machined and may be provided by casting.

c The depth and angle of the pilot ports and the main ports are determined by the graphical layout of the hydraulic circuit and by the location of the valves in the manifold.

d Blind hole to accommodate the locating pin on the valve cover.

e The depth of d_1 , d_2 , G_1 and G_2 are given in the tables as dimension z .

Bibliography

- [1] ISO 129-1, *Technical drawings — Indication of dimensions and tolerances — Part 1: General principles*
- [2] ISO 286-2, *Geometrical product specifications (GPS) — ISO code system for tolerances on linear sizes — Part 2: Tables of standard tolerance classes and limit deviations for holes and shafts*
- [3] ISO 965-1, *ISO general purpose metric screw threads — Tolerances — Part 1: Principles and basic data*
- [4] ISO 1101, *Geometrical product specification (GPS) — Geometrical tolerancing — Tolerances of form, orientation, location and run-out*
- [5] ISO 4288, *Geometrical Product Specifications (GPS) — Surface texture: Profile method — Rules and procedures for the assessment of surface texture*
- [6] ISO 4413, *Hydraulic fluid power — General rules and safety requirements for systems and their components*
- [7] ISO 5598, *Fluid power systems and components — Vocabulary*
- [8] ISO 5783, *Hydraulic fluid power — Code for identification of valve mounting surfaces and cartridge valve cavities*

British Standards Institution (BSI)

BSI is the national body responsible for preparing British Standards and other standards-related publications, information and services.

BSI is incorporated by Royal Charter. British Standards and other standardization products are published by BSI Standards Limited.

About us

We bring together business, industry, government, consumers, innovators and others to shape their combined experience and expertise into standards-based solutions.

The knowledge embodied in our standards has been carefully assembled in a dependable format and refined through our open consultation process. Organizations of all sizes and across all sectors choose standards to help them achieve their goals.

Information on standards

We can provide you with the knowledge that your organization needs to succeed. Find out more about British Standards by visiting our website at bsigroup.com/standards or contacting our Customer Services team or Knowledge Centre.

Buying standards

You can buy and download PDF versions of BSI publications, including British and adopted European and international standards, through our website at bsigroup.com/shop, where hard copies can also be purchased.

If you need international and foreign standards from other Standards Development Organizations, hard copies can be ordered from our Customer Services team.

Copyright in BSI publications

All the content in BSI publications, including British Standards, is the property of and copyrighted by BSI or some person or entity that owns copyright in the information used (such as the international standardization bodies) and has formally licensed such information to BSI for commercial publication and use.

Save for the provisions below, you may not transfer, share or disseminate any portion of the standard to any other person. You may not adapt, distribute, commercially exploit, or publicly display the standard or any portion thereof in any manner whatsoever without BSI's prior written consent.

Storing and using standards

Standards purchased in soft copy format:

- A British Standard purchased in soft copy format is licensed to a sole named user for personal or internal company use only.
- The standard may be stored on more than 1 device provided that it is accessible by the sole named user only and that only 1 copy is accessed at any one time.
- A single paper copy may be printed for personal or internal company use only.

Standards purchased in hard copy format:

- A British Standard purchased in hard copy format is for personal or internal company use only.
- It may not be further reproduced – in any format – to create an additional copy. This includes scanning of the document.

If you need more than 1 copy of the document, or if you wish to share the document on an internal network, you can save money by choosing a subscription product (see 'Subscriptions').

Reproducing extracts

For permission to reproduce content from BSI publications contact the BSI Copyright & Licensing team.

Subscriptions

Our range of subscription services are designed to make using standards easier for you. For further information on our subscription products go to bsigroup.com/subscriptions.

With **British Standards Online (BSOL)** you'll have instant access to over 55,000 British and adopted European and international standards from your desktop. It's available 24/7 and is refreshed daily so you'll always be up to date.

You can keep in touch with standards developments and receive substantial discounts on the purchase price of standards, both in single copy and subscription format, by becoming a **BSI Subscribing Member**.

PLUS is an updating service exclusive to BSI Subscribing Members. You will automatically receive the latest hard copy of your standards when they're revised or replaced.

To find out more about becoming a BSI Subscribing Member and the benefits of membership, please visit bsigroup.com/shop.

With a **Multi-User Network Licence (MUNL)** you are able to host standards publications on your intranet. Licences can cover as few or as many users as you wish. With updates supplied as soon as they're available, you can be sure your documentation is current. For further information, email subscriptions@bsigroup.com.

Revisions

Our British Standards and other publications are updated by amendment or revision.

We continually improve the quality of our products and services to benefit your business. If you find an inaccuracy or ambiguity within a British Standard or other BSI publication please inform the Knowledge Centre.

Useful Contacts

Customer Services

Tel: +44 345 086 9001

Email (orders): orders@bsigroup.com

Email (enquiries): cservices@bsigroup.com

Subscriptions

Tel: +44 345 086 9001

Email: subscriptions@bsigroup.com

Knowledge Centre

Tel: +44 20 8996 7004

Email: knowledgecentre@bsigroup.com

Copyright & Licensing

Tel: +44 20 8996 7070

Email: copyright@bsigroup.com

BSI Group Headquarters

389 Chiswick High Road London W4 4AL UK