

Hydraulic fluid power — Four-port directional control valves — Mounting surfaces

ICS 23.100.50

National foreword

This British Standard reproduces verbatim ISO 4401:2005 and implements it as the UK national standard. It supersedes BS ISO 4401:1994 which is withdrawn.

The UK participation in its preparation was entrusted by Technical Committee MCE/18, Fluid power systems, to Subcommittee MCE/18/-/5, Control components, which has the responsibility to:

- aid enquirers to understand the text;
- present to the responsible international/European committee any enquiries on the interpretation, or proposals for change, and keep UK interests informed;
- monitor related international and European developments and promulgate them in the UK.

A list of organizations represented on this subcommittee can be obtained on request to its secretary.

Cross-references

The British Standards which implement international publications referred to in this document may be found in the *BSI Catalogue* under the section entitled "International Standards Correspondence Index", or by using the "Search" facility of the *BSI Electronic Catalogue* or of British Standards Online.

This publication does not purport to include all the necessary provisions of a contract. Users are responsible for its correct application.

Compliance with a British Standard does not of itself confer immunity from legal obligations.

Summary of pages

This document comprises a front cover, an inside front cover, the ISO title page, pages ii to v, a blank page, pages 1 to 16, an inside back cover and a back cover.

The BSI copyright notice displayed in this document indicates when the document was last issued.

Amendments issued since publication

Amd. No.	Date	Comments

This British Standard was published under the authority of the Standards Policy and Strategy Committee on 18 November 2005

© BSI 18 November 2005

INTERNATIONAL
STANDARD

ISO
4401

Third edition
2005-07-15

**Hydraulic fluid power — Four-port
directional control valves — Mounting
surfaces**

*Transmissions hydrauliques — Distributeurs à quatre orifices — Plan
de pose*



Reference number
ISO 4401:2005(E)

Contents

Page

Foreword	iv
Introduction	v
1 Scope	1
2 Normative references	1
3 Terms and definitions	1
4 Symbols	2
5 Tolerances	2
6 Dimensions	2
7 Pressure limitations	3
8 Identification statement (reference to this International Standard)	3
Bibliography	16

Foreword

ISO (the International Organization for Standardization) is a worldwide federation of national standards bodies (ISO member bodies). The work of preparing International Standards is normally carried out through ISO technical committees. Each member body interested in a subject for which a technical committee has been established has the right to be represented on that committee. International organizations, governmental and non-governmental, in liaison with ISO, also take part in the work. ISO collaborates closely with the International Electrotechnical Commission (IEC) on all matters of electrotechnical standardization.

International Standards are drafted in accordance with the rules given in the ISO/IEC Directives, Part 2.

The main task of technical committees is to prepare International Standards. Draft International Standards adopted by the technical committees are circulated to the member bodies for voting. Publication as an International Standard requires approval by at least 75 % of the member bodies casting a vote.

Attention is drawn to the possibility that some of the elements of this document may be the subject of patent rights. ISO shall not be held responsible for identifying any or all such patent rights.

ISO 4401 was prepared by Technical Committee ISO/TC 131, *Fluid power systems*, Subcommittee SC 5, *Control products and components*.

This third edition cancels and replaces the second edition (ISO 4401:1994) which has been technically revised.

Introduction

In hydraulic fluid power systems, power is transmitted and controlled through a liquid under pressure within an enclosed circuit. Typical components found in such systems include hydraulic valves. These devices control flow direction, pressure or flow rate of liquids in the enclosed circuit.

Hydraulic fluid power — Four-port directional control valves — Mounting surfaces

1 Scope

This International Standard specifies the dimensions and other data relating to surfaces on which four-port hydraulic directional control valves are mounted in order to ensure their interchangeability.

It applies to mounting surfaces for four-port hydraulic directional control valves which represent current practice. They are generally applicable to industrial equipment.

2 Normative references

The following referenced documents are indispensable for the application of this document. For dated references, only the edition cited applies. For undated references, the latest edition of the referenced document (including any amendments) applies.

ISO 286-2, *ISO system of limits and fits — Part 2: Tables of standard tolerance grades and limit deviations for holes and shafts*

ISO 1101, *Geometrical Product Specifications (GPS) — Geometrical tolerancing — Tolerances of form, orientation, location and run-out*

ISO 1302, *Geometrical Product Specifications (GPS) — Indication of surface texture in technical product documentation*

ISO 4287, *Geometrical Product Specifications (GPS) — Surface texture: Profile method — Terms, definitions and surface texture parameters*

ISO 5598, *Fluid power systems and components — Vocabulary*

ISO 5783, *Hydraulic fluid power — Code for identification of valve mounting surfaces and cartridge valve cavities*

3 Terms and definitions

For the purposes of this document, the terms and definitions given in ISO 5598 apply.

4 Symbols

4.1 For the purposes of this International Standard, the following symbols apply:

- A, B, L, P, T, T₁, X and Y identify ports;
- F₁, F₂, F₃, F₄, F₅ and F₆ identify threaded holes for fixing cap screws (bolts) (see footnote a in the figures);
- G, G₁, G₂ identify locating pin holes.

4.2 An explanation for the codes is given in ISO 5783.

5 Tolerances

5.1 The following values shall be applied to the mounting surface, i.e. that area within dotted bold lines:

- surface roughness: $Ra \leq 0,8 \mu\text{m}$ as specified in ISO 1302 and ISO 4287;
- surface flatness: 0,01 mm over a distance of 100 mm, as specified in ISO 1101;
- tolerance for diameter of locating pin hole: H12 in accordance with ISO 286-2.

5.2 The following tolerances shall be complied with along the *x*- and *y*-axes with respect to the origin:

- pin holes and bolt holes: $\pm 0,1 \text{ mm}$;
- port holes: $\pm 0,2 \text{ mm}$.

As for the other dimensions, see the figures.

6 Dimensions

6.1 The mounting surface dimensions for hydraulic directional control valves with four service ports shall be selected from the figures and tables specified in 6.2 to 6.7.

6.2 Mounting surface dimensions for control valves with four service ports with 4,5 mm maximum port diameter (4401-02-01-0-05), are given in Figure 1 and Table 1.

6.3 Mounting surface dimensions for control valves with four service ports with 7,5 mm maximum port diameter:

- a) without pilot port (4401-03-02-0-05), are given in Figure 2 and Table 2;
- b) with pilot ports (4401-03-03-0-05), are given in Figure 3 and Table 3.

6.4 Mounting surface dimensions for control valves with four service ports with 11,2 mm maximum port diameter:

- a) without pilot port (4401-05-04-0-05), are given in Figure 4 and Table 4;
- b) with pilot ports (4401-05-05-0-05), are given in Figure 5 and Table 5;
- c) with drain port and without pilot ports (4401-05-06-0-05), are given in Figure 6 and Table 6.

6.5 Mounting surface dimensions for control valves with four service ports with pilot ports and with 17,5 mm maximum port diameter, with or without drain ports (4401-07-07-0-05), are given in Figure 7 and Table 7.

6.6 Mounting surface dimensions for control valves with four service ports with pilot ports and with 25 mm maximum port diameter, with or without drain ports (4401-08-08-0-05), are given in Figure 8 and Table 8.

6.7 Mounting surface dimensions for control valves with four service ports with pilot ports and with 32 mm maximum port diameter, with or without drain ports (4401-10-09-0-05), are given in Figure 9 and Table 9.

7 Pressure limitations

Operating pressure limitations for subplates and manifold blocks with these mounting surfaces shall be established by the manufacturer.

8 Identification statement (reference to this International Standard)

Use the following statement in test reports, catalogues and sales literature when electing to comply with this International Standard:

"Mounting surface dimensions conform to ISO 4401:2005, *Hydraulic fluid power — Four-port directional control valves — Mounting surfaces*"

Codification: 4401-02-01-0-05

Dimensions in millimetres

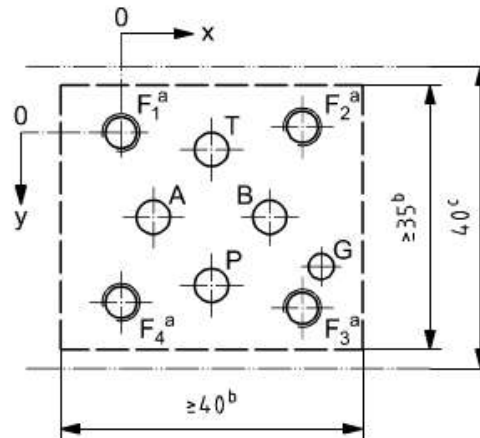

- ^a The minimum thread depth is 1,5 bolt diameters, D . The recommended full thread depth shall be $2D + 6$ mm to aid interchangeability of valves and to reduce the number of fixing bolt lengths. The recommended engagement of fixing cap screw (bolt) threads for ferrous mountings is $1,25D$.
- ^b The dimensions specifying the area within the dotted bold lines are the minimum dimensions for the mounting surface. The corners of the rectangle may be radiused to a maximum radius, r_{\max} , equal to the thread diameter of the fixing cap screws (bolts). Along each axis the fixing holes are at equal distances to the mounting surface edges.
- ^c This dimension gives the minimum space required for a valve with this mounting surface. The dimension is also the minimum distance from centreline to centreline of two identical mounting surfaces placed on a manifold block. The attention of valve manufacturers is drawn to the fact that no part of the width of the complete valve assembly is to exceed this dimension.

Figure 1 — Mounting surface for four-port hydraulic directional control valves with 4,5 mm maximum port diameter

Table 1 — Mounting surface for four-port hydraulic directional control valves with 4,5 mm maximum port diameter

Dimensions in millimetres

Axis	P	A	T	B	F ₁	F ₂	F ₃	F ₄	G ^a
	∅ 4,5 max.	∅ 4,5 max.	∅ 4,5 max.	∅ 4,5 max.	M5	M5	M5	M5	∅ 3,4
x	12	4,3	12	19,7	0	24	24	0	26,5
y	20,25	11,25	2,25	11,25	0	-0,75	23,25	22,5	17,75

NOTE Operating pressure limitations for subplates and manifold blocks with these mounting surfaces are specified by the manufacturer.

^a Blind holes made in the mounting surfaces to accommodate the locating pins on the valves; their minimum depth is 4 mm.

Codification: 4401-03-02-0-05

Dimensions in millimetres

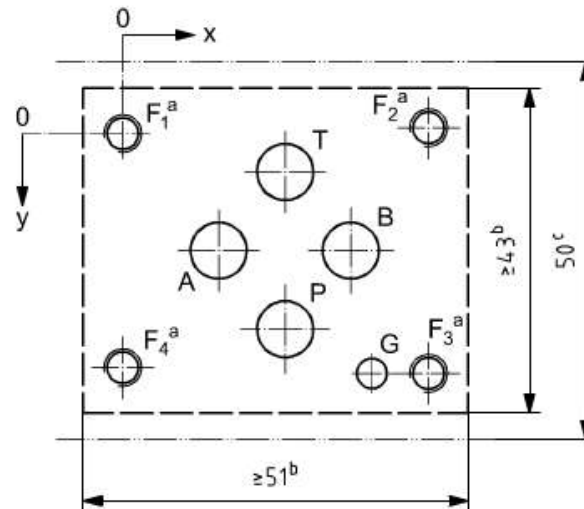

^a The minimum thread depth is 1,5 cap screw (bolt) thread diameters, D . The recommended full thread depth shall be $2D + 6$ mm to aid interchangeability of valves and to reduce the number of fixing cap screw (bolt) lengths. The recommended engagement of fixing cap screw (bolt) threads for ferrous mountings is $1,25D$.

^b The dimensions specifying the area within the dotted bold lines are the minimum dimensions for the mounting surface. The corners of the rectangle may be radiused to a maximum radius, r_{max} , equal to the thread diameter of the fixing cap screws (bolts). Along each axis the fixing holes are at equal distances to the mounting surface edges.

^c This dimension gives the minimum space required for a valve with this mounting surface. The dimension is also the minimum distance from centreline to centreline of two identical mounting surfaces placed on a manifold block. The attention of valve manufacturers is drawn to the fact that no part of the width of the complete valve assembly is to exceed this dimension.

Figure 2 — Mounting surface for four-port hydraulic directional control valves with 7,5 mm maximum port diameter and without pilot port

Table 2 — Mounting surface for four-port hydraulic directional control valves with 7,5 mm maximum port diameter and without pilot port

Dimensions in millimetres

Axis	P	A	T	B	F ₁	F ₂	F ₃	F ₄	G ^a
	∅ 7,5 max.	∅ 7,5 max.	∅ 7,5 max.	∅ 7,5 max.	M5	M5	M5	M5	∅ 4
x	21,5	12,7	21,5	30,2	0	40,5	40,5	0	33
y	25,9	15,5	5,1	15,5	0	-0,75	31,75	31	31,75

NOTE 1 The use of this mounting surface will require caution relative to the port seals.

NOTE 2 Operating pressure limitations for subplates and manifold blocks with these mounting surfaces are specified by the manufacturer.

^a Blind holes made in the mounting surfaces to accommodate the locating pins on the valves; their minimum depth is 4 mm.

Codification: 4401-03-03-0-05

Dimensions in millimetres

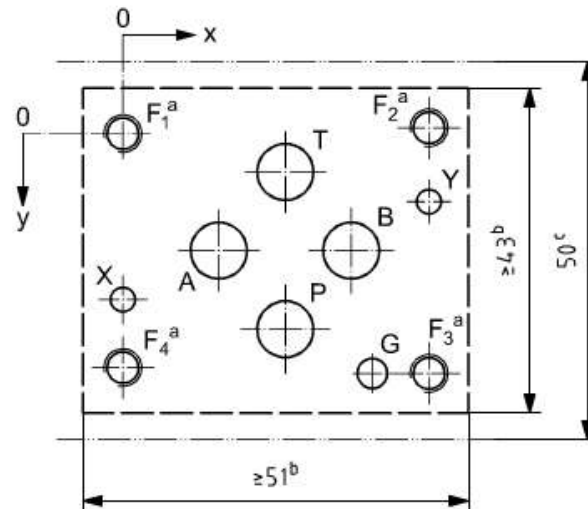

^a The minimum thread depth is 1,5 cap screw (bolt) thread diameters, D . The recommended full thread depth shall be $2D + 6$ mm to aid interchangeability of valves and to reduce the number of fixing cap screw (bolt) lengths. The recommended engagement of fixing cap screw (bolt) threads for ferrous mountings is $1,25D$.

^b The dimensions specifying the area within the dotted bold lines are the minimum dimensions for the mounting surface. The corners of the rectangle may be radiused to a maximum radius, r_{max} , equal to the thread diameter of the fixing cap screws (bolts). Along each axis the fixing holes are at equal distances to the mounting surface edges.

^c This dimension gives the minimum space required for a valve with this mounting surface. The dimension is also the minimum distance from centreline to centreline of two identical mounting surfaces placed on a manifold block. The attention of valve manufacturers is drawn to the fact that no part of the width of the complete valve assembly is to exceed this dimension.

Figure 3 — Mounting surface for four-port hydraulic directional control valves with 7,5 mm maximum port diameter and with pilot ports

Table 3 — Mounting surface for four-port hydraulic directional control valves with 7,5 mm maximum port diameter and with pilot ports

Dimensions in millimetres

Axis	P	A	T	B	F ₁	F ₂	F ₃	F ₄	X	Y	G ^a
	∅ 7,5 max.	∅ 7,5 max.	∅ 7,5 max.	∅ 7,5 max.	M5	M5	M5	M5	∅ 3,3 max.	∅ 3,3 max.	∅ 4
x	21,5	12,7	21,5	30,2	0	40,5	40,5	0	0	40,5	33
y	25,9	15,5	5,1	15,5	0	-0,75	31,75	31	22	9	31,75

NOTE 1 The use of this mounting surface will require caution relative to the port seals.

NOTE 2 Operating pressure limitations and manifold blocks with these mounting surfaces are specified by the manufacturer.

^a Blind holes made in the mounting surfaces to accommodate the locating pins on the valves; their minimum depth is 4 mm.

Codification: 4401-05-04-0-05

Dimensions in millimetres

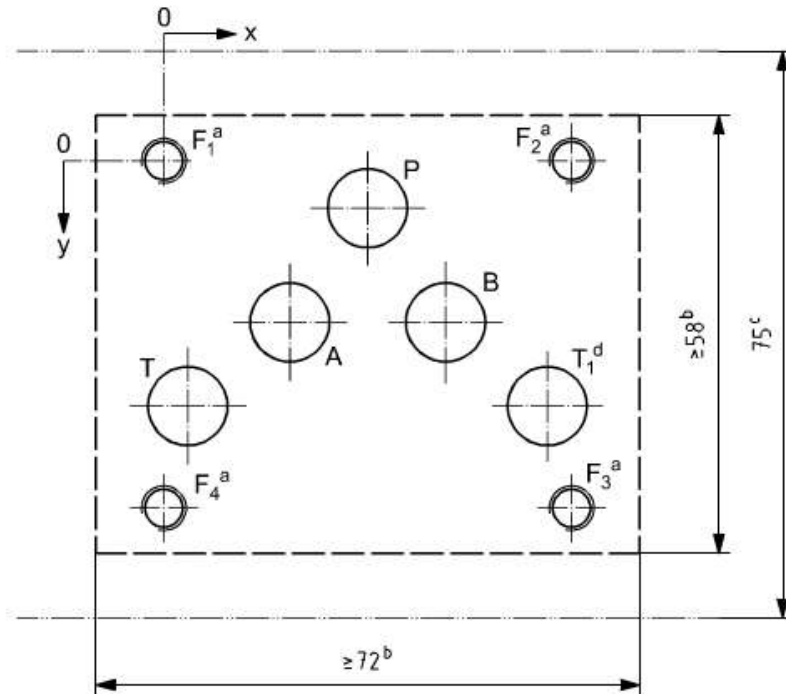

- ^a The minimum thread depth is 1,5 cap screw (bolt) thread diameters, D . The recommended full thread depth shall be $2D + 6$ mm to aid interchangeability of valves and to reduce the number of fixing cap screw (bolt) lengths. The recommended engagement of fixing cap screw (bolt) threads for ferrous mountings is $1,25D$.
- ^b The dimensions specifying the area within the dotted bold lines are the minimum dimensions for the mounting surface. The corners of the rectangle may be radiused to a maximum radius, r_{max} , equal to the thread diameter of the fixing cap screws (bolts). Along each axis the fixing holes are at equal distances to the mounting surface edges.
- ^c This dimension gives the minimum space required for a valve with this mounting surface. The dimension is also the minimum distance from centreline to centreline of two identical mounting surfaces placed on a manifold block. The attention of valve manufacturers is drawn to the fact that no part of the width of the complete valve assembly is to exceed this dimension.
- ^d T_1 -port is optional.

Figure 4 — Mounting surface for four-port hydraulic directional control valves with 11,2 mm maximum port diameter and without pilot port

Table 4 — Mounting surface for four-port hydraulic directional control valves with 11,2 mm maximum port diameter and without pilot port

Dimensions in millimetres

Axis	P	A	T	T_1 (optional)	B	F_1	F_2	F_3	F_4
	$\varnothing 11,2$ max.	$\varnothing 11,2$ max.	$\varnothing 11,2$ max.	$\varnothing 11,2$ max.	$\varnothing 11,2$ max.	M6	M6	M6	M6
x	27	16,7	3,2	50,8	37,3	0	54	54	0
y	6,3	21,4	32,5	32,5	21,4	0	0	46	46
NOTE Operating pressure limitations and manifold blocks with these mounting surfaces are specified by the manufacturer.									

Codification: 4401-05-05-0-05

Dimensions in millimetres

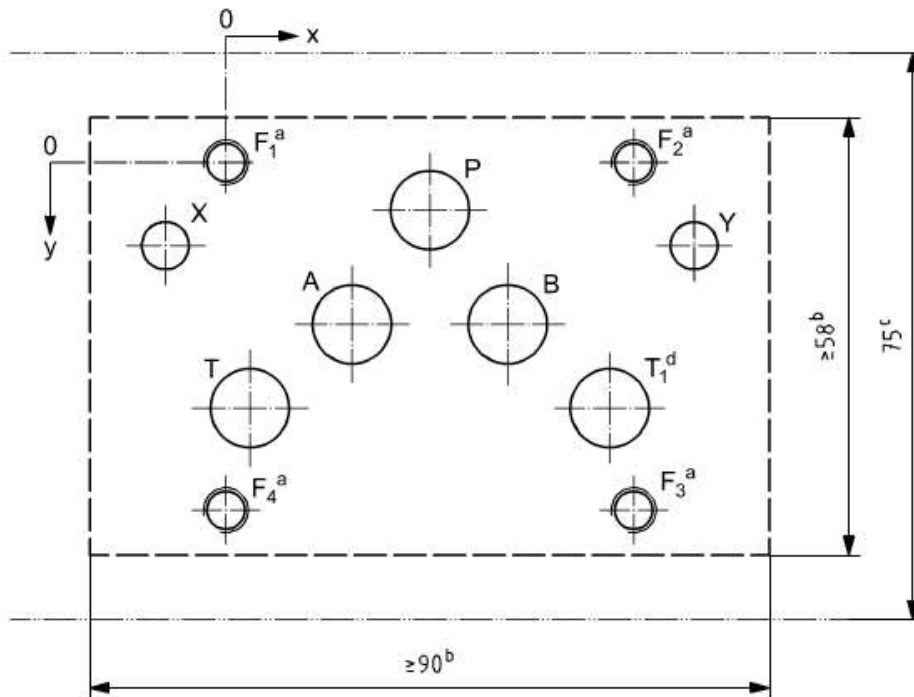

^a The minimum thread depth is 1,5 cap screw (bolt) thread diameters, D . The recommended full thread depth shall be $2D + 6$ mm to aid interchangeability of valves and to reduce the number of fixing cap screw (bolt) lengths. The recommended engagement of fixing cap screw (bolt) threads for ferrous mountings is $1,25D$.

^b The dimensions specifying the area within the dotted bold lines are the minimum dimensions for the mounting surface. The corners of the rectangle may be radiused to a maximum radius, r_{\max} , equal to the thread diameter of the fixing cap screws (bolts). Along each axis the fixing holes are at equal distances to the mounting surface edges.

^c This dimension gives the minimum space required for a valve with this mounting surface. The dimension is also the minimum distance from centreline to centreline of two identical mounting surfaces placed on a manifold block. The attention of valve manufacturers is drawn to the fact that no part of the width of the complete valve assembly is to exceed this dimension.

^d T_1 -port is optional.

Figure 5 — Mounting surface for four-port hydraulic directional control valves with 11,2 mm maximum port diameter and with pilot ports

Table 5 — Mounting surface for four-port hydraulic directional control valves with 11,2 mm maximum port diameter and with pilot ports

Dimensions in millimetres

Axis	P	A	T	T_1 (optional)	B	F_1	F_2	F_3	F_4	X	Y
		∅ 11,2 max.	∅ 11,2 max.	∅ 11,2 max.	∅ 11,2 max.	∅ 11,2 max.	M6	M6	M6	M6	∅ 6,3 max.
x	27	16,7	3,2	50,8	37,3	0	54	54	0	- 8	62
y	6,3	21,4	32,5	32,5	21,4	0	0	46	46	11	11

NOTE Operating pressure limitations for subplates and manifold blocks with these mounting surfaces are specified by the manufacturer.

Codification: 4401-05-06-0-05

Dimensions in millimetres

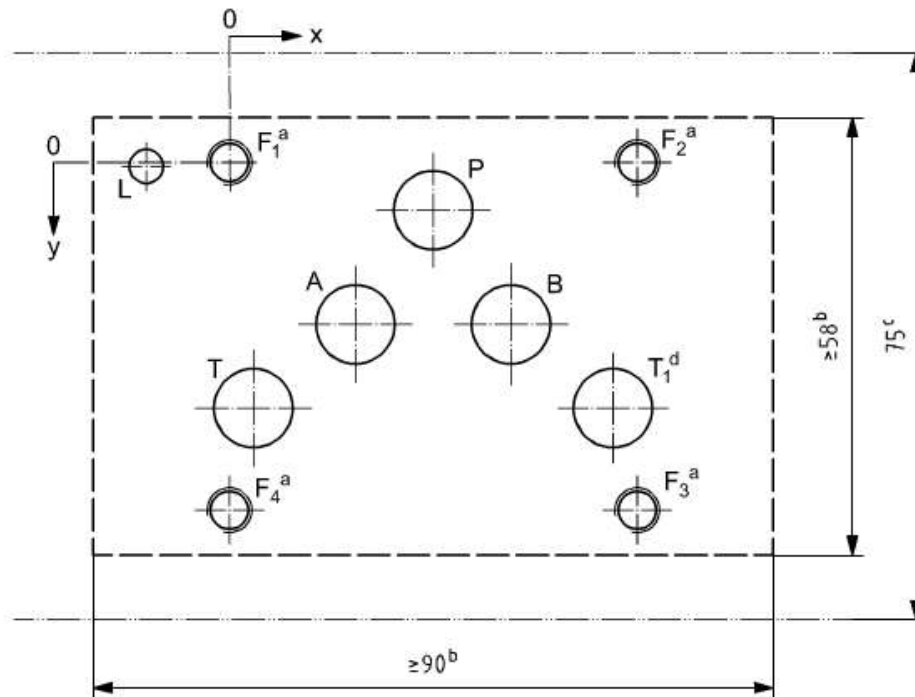

^a The minimum thread depth is 1,5 cap screw (bolt) thread diameters, D . The recommended full thread depth shall be $2D + 6$ mm to aid interchangeability of valves and to reduce the number of fixing cap screw (bolt) lengths. The recommended engagement of fixing cap screw (bolt) threads for ferrous mountings is $1,25D$.

^b The dimensions specifying the area within the dotted bold lines are the minimum dimensions for the mounting surface. The corners of the rectangle may be radiused to a maximum radius, r_{max} , equal to the thread diameter of the fixing cap screws (bolts). Along each axis the fixing holes are at equal distances to the mounting surface edges.

^c This dimension gives the minimum space required for a valve with this mounting surface. The dimension is also the minimum distance from centreline to centreline of two identical mounting surfaces placed on a manifold block. The attention of valve manufacturers is drawn to the fact that no part of the width of the complete valve assembly is to exceed this dimension.

^d T_1 -port is optional.

Figure 6 — Mounting surface for four-port hydraulic directional control valves with 11,2 mm maximum port diameter, with drain port and without pilot ports

Table 6 — Mounting surface for four-port hydraulic directional control valves with 11,2 mm maximum port diameter, with drain port and without pilot ports

Dimensions in millimetres

Axis	P	A	T	T_1 (optional)	B	F_1	F_2	F_3	F_4	L
	$\varnothing 11,2$ max.	$\varnothing 11,2$ max.	$\varnothing 11,2$ max.	$\varnothing 11,2$ max.	$\varnothing 11,2$ max.	M6	M6	M6	M6	$\varnothing 4,5$ max.
x	27	16,7	3,2	50,8	37,3	0	54	54	0	- 11
y	6,3	21,4	32,5	32,5	21,4	0	0	46	46	0,5

NOTE Operating pressure limitations for subplates and manifold blocks with these mounting surfaces are specified by the manufacturer.

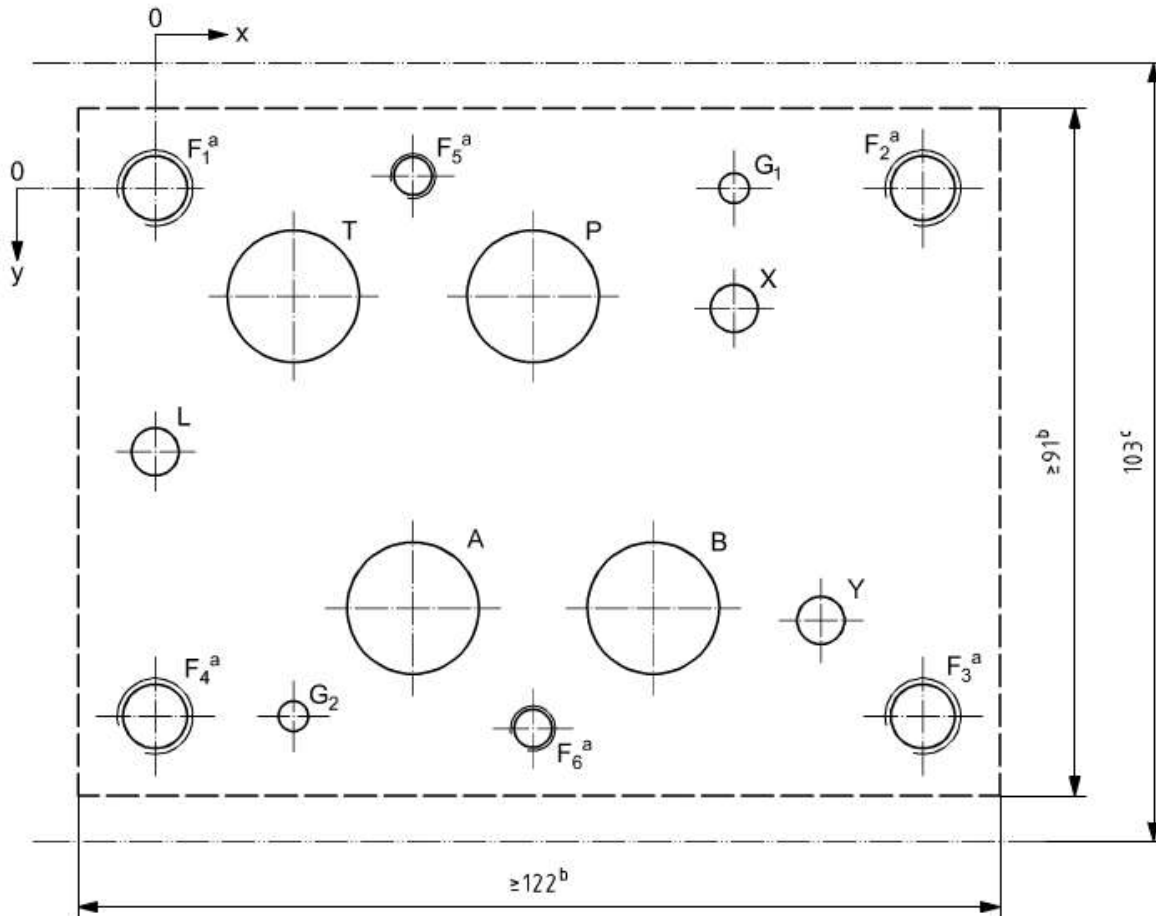

^a The minimum thread depth is 1,5 cap screw (bolt) thread diameters, D . The recommended full thread depth shall be $2D + 6$ mm to aid interchangeability of valves and to reduce the number of fixing cap screw (bolt) lengths. The recommended engagement of fixing cap screw (bolt) threads for ferrous mountings is $1,25D$.

^b The dimensions specifying the area within the dotted bold lines are the minimum dimensions for the mounting surface. The corners of the rectangle may be radiused to a maximum radius, r_{\max} , equal to the thread diameter of the fixing cap screws (bolts). Along each axis the fixing holes are at equal distances to the mounting surface edges.

^c This dimension gives the minimum space required for a valve with this mounting surface. The dimension is also the minimum distance from centreline to centreline of two identical mounting surfaces placed on a manifold block. The attention of valve manufacturers is drawn to the fact that no part of the width of the complete valve assembly is to exceed this dimension.

Figure 7 — Mounting surface for four-port hydraulic directional control valves with pilot ports and with 17,5 mm maximum port diameter, with or without drain ports

Table 7 — Mounting surface for four-port hydraulic directional control valves with pilot ports and with 17,5 mm maximum port diameter, with or without drain ports

Dimensions in millimetres

Axis	P	A	T	B	L ^a	X	Y	G ₁ ^b	G ₂ ^b	F ₁	F ₂	F ₃	F ₄	F ₅	F ₆
	∅ 17,5 max.	∅ 17,5 max.	∅ 17,5 max.	∅ 17,5 max.	∅ 6,3 max.	∅ 6,3 max.	∅ 6,3 max.	∅ 4	∅ 4	M10	M10	M10	M10	M6	M6
x	50	34,1	18,3	65,9	0	76,6	88,1	76,6	18,3	0	101,6	101,6	0	34,1	50
y	14,3	55,6	14,3	55,6	34,9	15,9	57,2	0	69,9	0	0	69,9	69,9	- 1,6	71,5
NOTE Operating pressure limitations for subplates and manifold blocks with these mounting surfaces are specified by the manufacturer.															
^a Drain port is optional.															
^b Blind holes made in the mounting surfaces to accommodate the locating pins on the valves; their minimum depth is 8 mm.															

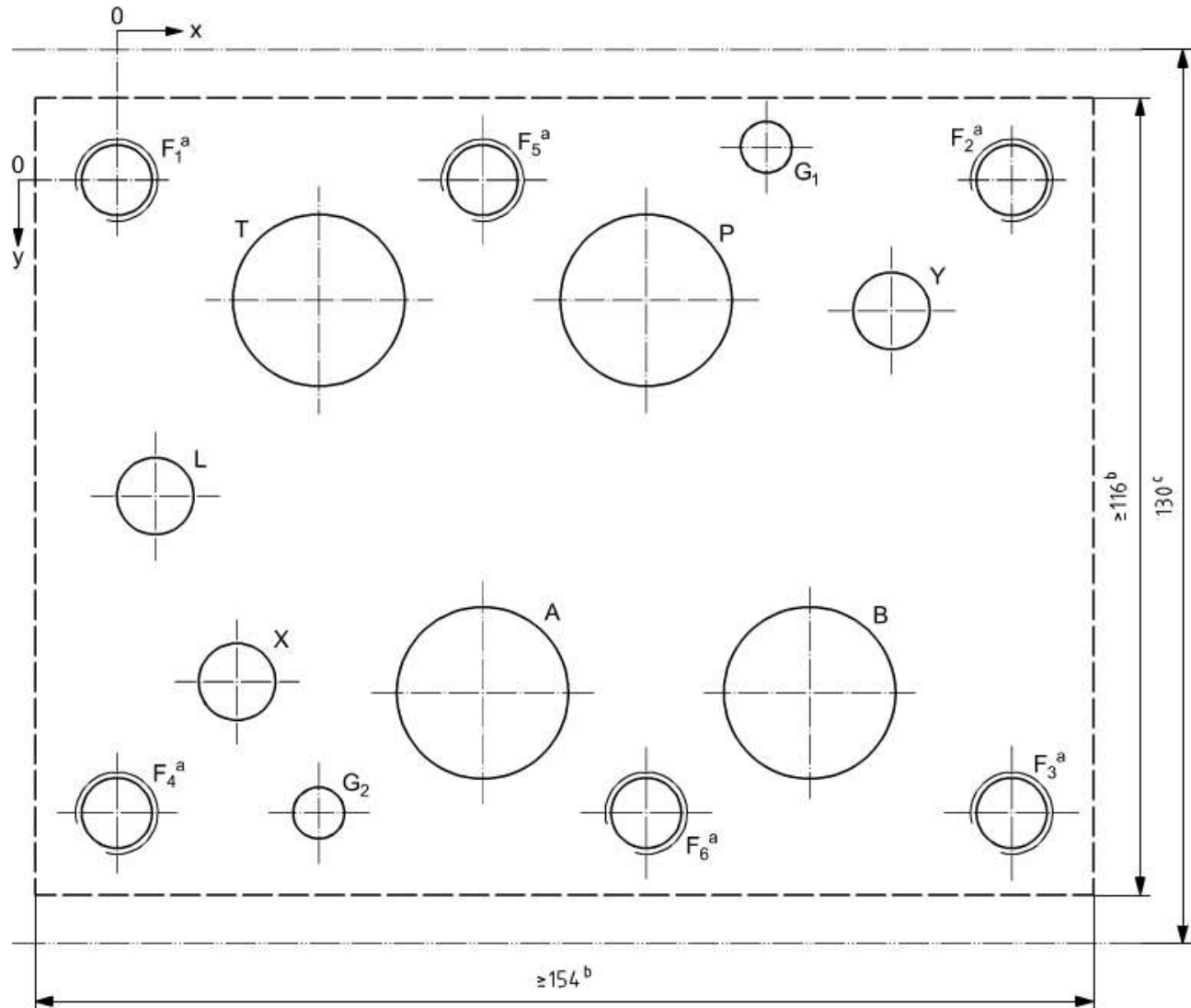

^a The minimum thread depth is 1,5 cap screw (bolt) thread diameters, D . The recommended full thread depth shall be $2D + 6$ mm to aid interchangeability of valves and to reduce the number of fixing cap screw (bolt) lengths. The recommended engagement of fixing cap screw (bolt) threads for ferrous mountings is $1,25D$.

^b The dimensions specifying the area within the dotted bold lines are the minimum dimensions for the mounting surface. The corners of the rectangle may be radiused to a maximum radius, r_{max} , equal to the thread diameter of the fixing cap screws (bolts). Along each axis the fixing holes are at equal distances to the mounting surface edges.

^c This dimension gives the minimum space required for a valve with this mounting surface. The dimension is also the minimum distance from centreline to centreline of two identical mounting surfaces placed on a manifold block. The attention of valve manufacturers is drawn to the fact that no part of the width of the complete valve assembly is to exceed this dimension.

Figure 8 — Mounting surface for four-port hydraulic directional control valves with pilot ports and with 25 mm maximum port diameter, with or without drain ports

Table 8 — Mounting surface for four-port hydraulic directional control valves with pilot ports and with 25 mm maximum port diameter, with or without drain ports

Dimensions in millimetres

Axis	P	A	T	B	L ^a	X	Y	G ₁ ^b	G ₂ ^b	F ₁	F ₂	F ₃	F ₄	F ₅	F ₆
	∅ 25 max.	∅ 25 max.	∅ 25 max.	∅ 25 max.	∅ 11,2 max.	∅ 11,2 max.	∅ 11,2 max.	∅ 7,5	∅ 7,5	M12	M12	M12	M12	M12	M12
x	77	53,2	29,4	100,8	5,6	17,5	112,7	94,5	29,4	0	130,2	130,2	0	53,2	77
y	17,5	74,6	17,5	74,6	46	73	19	- 4,8	92,1	0	0	92,1	92,1	0	92,1

NOTE 1 The use of this mounting will require caution relative to the port seals.

NOTE 2 Operating pressure limitations for subplates and manifold blocks with these mounting surfaces are specified by the manufacturer.

^a Drain port is optional.

^b Blind holes made in the mounting surfaces to accommodate the locating pins on the valves; their minimum depth is 8 mm.

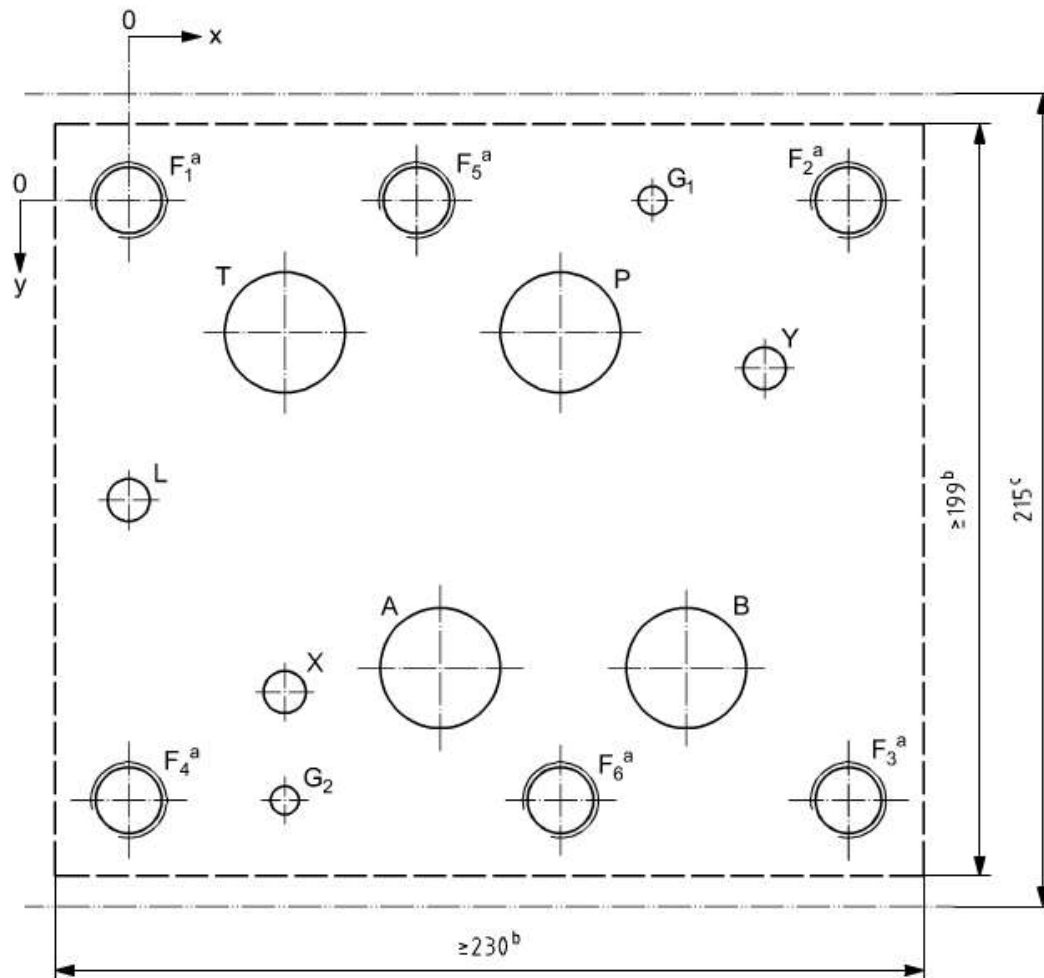

^a The minimum thread depth is 1,5 cap screw (bolt) thread diameters, D . The recommended full thread depth shall be $2D + 6$ mm to aid interchangeability of valves and to reduce the number of fixing cap screw (bolt) lengths. The recommended engagement of fixing cap screw (bolt) threads for ferrous mountings is $1,25D$.

^b The dimensions specifying the area within the dotted bold lines are the minimum dimensions for the mounting surface. The corners of the rectangle may be radiused to a maximum radius, r_{\max} , equal to the thread diameter of the fixing cap screws (bolts). Along each axis the fixing holes are at equal distances to the mounting surface edges.

^c This dimension gives the minimum space required for a valve with this mounting surface. The dimension is also the minimum distance from centreline to centreline of two identical mounting surfaces placed on a manifold block. The attention of valve manufacturers is drawn to the fact that no part of the width of the complete valve assembly is to exceed this dimension.

Figure 9 — Mounting surface for four-port hydraulic directional control valves with pilot ports and with 32 mm maximum port diameter, with or without drain ports

Table 9 — Mounting surface for four-port hydraulic directional control valves with pilot ports and with 32 mm maximum port diameter, with or without drain ports

Dimensions in millimetres

Axis	P	A	T	B	L ^a	X	Y	G ₁ ^b	G ₂ ^b	F ₁	F ₂	F ₃	F ₄	F ₅	F ₆
	∅ 32 max.	∅ 32 max.	∅ 32 max.	∅ 32 max.	∅ 11,2 max.	∅ 11,2 max.	∅ 11,2 max.	∅ 7,5	∅ 7,5	M20	M20	M20	M20	M20	M20
x	114,3	82,5	41,3	147,6	0	41,3	168,3	138,6	41,3	0	190,5	190,5	0	76,2	114,3
y	35	123,8	35	123,8	79,4	130,2	44,5	0	158,8	0	0	158,8	158,8	0	158,8
NOTE Operating pressure limitations for subplates and manifold blocks with these mounting surfaces are specified by the manufacturer.															
^a Drain port is optional.															
^b Blind holes made in the mounting surfaces to accommodate the locating pins on the valves; their minimum depth is 8 mm.															

Bibliography

- [1] ISO 129, *Technical drawings — Dimensioning — General principles, definitions, methods of execution and special indications*
- [2] ISO 286-1, *ISO system of limits and fits — Part 1: Bases of tolerances, deviations and fits*
- [3] ISO 965-1, *ISO general-purpose metric screw threads — Tolerances — Part 1: Principles and basic data*

BSI — British Standards Institution

BSI is the independent national body responsible for preparing British Standards. It presents the UK view on standards in Europe and at the international level. It is incorporated by Royal Charter.

Revisions

British Standards are updated by amendment or revision. Users of British Standards should make sure that they possess the latest amendments or editions.

It is the constant aim of BSI to improve the quality of our products and services. We would be grateful if anyone finding an inaccuracy or ambiguity while using this British Standard would inform the Secretary of the technical committee responsible, the identity of which can be found on the inside front cover.
Tel: +44 (0)20 8996 9000. Fax: +44 (0)20 8996 7400.

BSI offers members an individual updating service called PLUS which ensures that subscribers automatically receive the latest editions of standards.

Buying standards

Orders for all BSI, international and foreign standards publications should be addressed to Customer Services. Tel: +44 (0)20 8996 9001.
Fax: +44 (0)20 8996 7001. Email: orders@bsi-global.com. Standards are also available from the BSI website at <http://www.bsi-global.com>.

In response to orders for international standards, it is BSI policy to supply the BSI implementation of those that have been published as British Standards, unless otherwise requested.

Information on standards

BSI provides a wide range of information on national, European and international standards through its Library and its Technical Help to Exporters Service. Various BSI electronic information services are also available which give details on all its products and services. Contact the Information Centre.
Tel: +44 (0)20 8996 7111. Fax: +44 (0)20 8996 7048. Email: info@bsi-global.com.

Subscribing members of BSI are kept up to date with standards developments and receive substantial discounts on the purchase price of standards. For details of these and other benefits contact Membership Administration.
Tel: +44 (0)20 8996 7002. Fax: +44 (0)20 8996 7001.
Email: membership@bsi-global.com.

Information regarding online access to British Standards via British Standards Online can be found at <http://www.bsi-global.com/bsonline>.

Further information about BSI is available on the BSI website at <http://www.bsi-global.com>.

Copyright

Copyright subsists in all BSI publications. BSI also holds the copyright, in the UK, of the publications of the international standardization bodies. Except as permitted under the Copyright, Designs and Patents Act 1988 no extract may be reproduced, stored in a retrieval system or transmitted in any form or by any means – electronic, photocopying, recording or otherwise – without prior written permission from BSI.

This does not preclude the free use, in the course of implementing the standard, of necessary details such as symbols, and size, type or grade designations. If these details are to be used for any other purpose than implementation then the prior written permission of BSI must be obtained.

Details and advice can be obtained from the Copyright & Licensing Manager.
Tel: +44 (0)20 8996 7070. Fax: +44 (0)20 8996 7553.
Email: copyright@bsi-global.com.