

BS ISO 4000-2:2013



BSI Standards Publication

Passenger car tyres and rims

Part 2: Rims

bsi.

...making excellence a habit.™

National foreword

This British Standard is the UK implementation of ISO 4000-2:2013. It supersedes BS ISO 4000-2:2007 which is withdrawn.

The UK participation in its preparation was entrusted to Technical Committee AUE/4, Tyres and wheels for motor vehicles.

A list of organizations represented on this committee can be obtained on request to its secretary.

This publication does not purport to include all the necessary provisions of a contract. Users are responsible for its correct application.

© The British Standards Institution 2013. Published by BSI Standards Limited 2013

ISBN 978 0 580 79660 9

ICS 43.040.50

Compliance with a British Standard cannot confer immunity from legal obligations.

This British Standard was published under the authority of the Standards Policy and Strategy Committee on 31 December 2013.

Amendments issued since publication

Date	Text affected
------	---------------

INTERNATIONAL
STANDARD

BS ISO 4000-2:2013

ISO
4000-2

Fifth edition
2013-12-15

Passenger car tyres and rims —

Part 2:
Rims

Pneumatiques et jantes pour voitures particulières —
Partie 2: Jantes



Reference number
ISO 4000-2:2013(E)

© ISO 2013



COPYRIGHT PROTECTED DOCUMENT

© ISO 2013

All rights reserved. Unless otherwise specified, no part of this publication may be reproduced or utilized otherwise in any form or by any means, electronic or mechanical, including photocopying, or posting on the internet or an intranet, without prior written permission. Permission can be requested from either ISO at the address below or ISO's member body in the country of the requester.

ISO copyright office
Case postale 56 • CH-1211 Geneva 20
Tel. + 41 22 749 01 11
Fax + 41 22 749 09 47
E-mail copyright@iso.org
Web www.iso.org

Published in Switzerland

Contents

	Page
Foreword	iv
1 Scope	1
2 Normative references	1
3 Terms and definitions	1
4 Designation and marking	1
5 5° tapered (drop-centre) rims	1
5.1 Rim flanges	1
5.2 Rim contours	2
5.3 Rim diameter and hump circumference	5
6 Valve holes	6
6.1 General	6
6.2 Snap-in	6
6.3 Other valves	6

Foreword

ISO (the International Organization for Standardization) is a worldwide federation of national standards bodies (ISO member bodies). The work of preparing International Standards is normally carried out through ISO technical committees. Each member body interested in a subject for which a technical committee has been established has the right to be represented on that committee. International organizations, governmental and non-governmental, in liaison with ISO, also take part in the work. ISO collaborates closely with the International Electrotechnical Commission (IEC) on all matters of electrotechnical standardization.

The procedures used to develop this document and those intended for its further maintenance are described in the ISO/IEC Directives, Part 1. In particular the different approval criteria needed for the different types of ISO documents should be noted. This document was drafted in accordance with the editorial rules of the ISO/IEC Directives, Part 2 (see www.iso.org/directives).

Attention is drawn to the possibility that some of the elements of this document may be the subject of patent rights. ISO shall not be held responsible for identifying any or all such patent rights. Details of any patent rights identified during the development of the document will be in the Introduction and/or on the ISO list of patent declarations received (see www.iso.org/patents).

Any trade name used in this document is information given for the convenience of users and does not constitute an endorsement.

For an explanation on the meaning of ISO specific terms and expressions related to conformity assessment, as well as information about ISO's adherence to the WTO principles in the Technical Barriers to Trade (TBT) see the following URL: Foreword - Supplementary information

The committee responsible for this document is ISO/TC 31, *Tyres, rims and valves*, Subcommittee SC 3, *Passenger car tyres and rims*.

This fifth edition cancels and replaces the fourth edition (ISO 4000-2:2007), which has been technically revised.

ISO 4000 consists of the following parts, under the general title *Passenger car tyres and rims*:

- *Part 1: Tyres (metric series)*
- *Part 2: Rims*

Passenger car tyres and rims —

Part 2: Rims

1 Scope

This part of ISO 4000 specifies the designation, contour and dimensions of 5° tapered (drop-centre) rims primarily intended for passenger cars.

2 Normative references

The following documents, in whole or in part, are normatively referenced in this document and are indispensable for its application. For dated references, only the edition cited applies. For undated references, the latest edition of the referenced document (including any amendments) applies.

ISO 3911, *Wheels and rims for pneumatic tyres — Vocabulary, designation and marking*

3 Terms and definitions

For the purposes of this document, the terms and definitions given in ISO 3911 apply.

4 Designation and marking

The rim shall be designated by its nominal rim-diameter code, nominal rim-width code and rim flange type (e.g. 15 × 6 J or 13 × 5,50 B).

5 5° tapered (drop-centre) rims

5.1 Rim flanges

Recommended rim flange contours are given in [Table 1](#) for the nominal rim diameter codes.

Table 1 — Recommended rim flanges

Nominal rim-diameter code	Rim flange
10	B
12	
13	
14	J
15	
16	
17	
18	
19	
20	
21	
22	
23	
24	
25	
26	
28	
30	

5.2 Rim contours

Dimensions and tolerances of the rims shall be as given in [Figure 1](#) and [Table 2](#). Optional bead seat contours and their dimensions are given in [Figure 2](#) and [Table 3](#).

Dimensions in millimetres

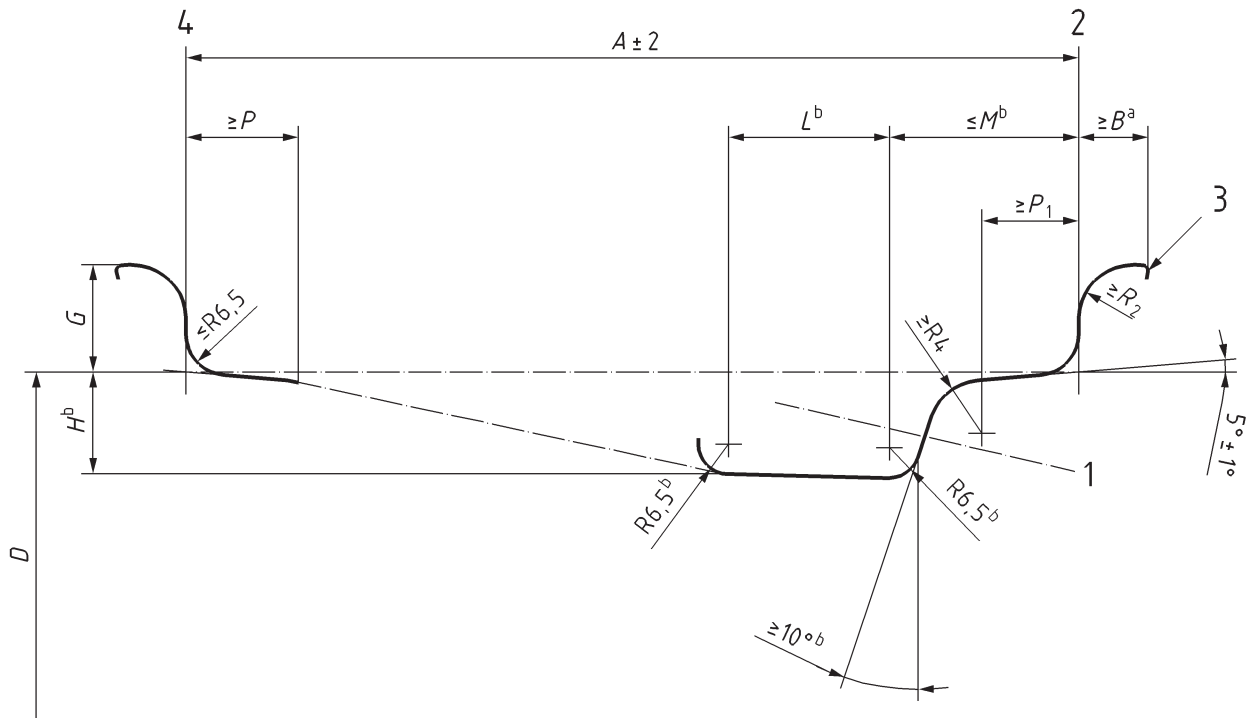

Key

- 1 valve hole (see [Clause 6](#))
- 2 tyre mounting side
- 3 break corner equivalent to 0,5 minimum R
- 4 tyre non-mounting side
- a Flange width includes edge radius. The portion of a flange beyond the minimum width shall *not be higher* than the highest point of the flange
- b These dimensions comprise the minimum well envelope for tyre mounting purposes at M max. or less, except for localized areas at the weld or valve hole
- c Optional groove in rim flange for wheel weight retention is permissible

NOTE For use with tubeless tyres, humps are necessary on the mounting side and preferred on the non-mounting side.

Figure 1 — Contour of 5° tapered (drop-centre) rims

Table 2 — Dimensions of 5° tapered (drop-centre) rims

Dimensions in millimetres

Diameter code	Rim width code and flange type ^c	<i>B</i>	<i>G</i>	<i>P</i>	<i>P</i> ₁	<i>H</i> ^a	<i>L</i>	<i>M</i>	<i>R</i> ₂
		min.	±1,0	min.	min.	gauge	gauge	max.	min.
10 12 13	3.00 B	10,0	14,5	13,0	15,0	15,0	16,0	28,0	7,5
	3.50 B	10,0	14,5	15,0	17,0	15,0	19,0	34,0	7,5
	4.00 B	10,0	14,5	15,0	17,0	15,0	19,0	45,0	7,5
	4.50 B and wider	10,0	14,5	19,5	19,5	15,0	22,0	45,0	7,5
14 through 21	3J	11,0	17,5	13,0	13,0	17,3 ^b	16,0	28,0	9,5
	3 1/2 J	11,0	17,5	15,0	17,0	17,3 ^b	19,0	34,0	9,5
	4 J	11,0	17,5	15,0	17,0	17,3 ^b	19,0	45,0	9,5
	4 1/2 J and wider	11,0	17,5	19,5	19,5	17,3 ^b	22,0	45,0	9,5
22 and greater	4 1/2 J and wider	11,0	17,5	19,5	19,5	22,0 ^d	22,0	45,0	9,5

^a Minimum dimensions for well depth (*H*) and well angle are required for tyre mounting. Larger values may be required to ensure sufficient space for tubeless tyre valve seating.

^b For J-type rims, a deviation to *H* gauge of 17 mm is permitted with a corresponding *M* max. of 43 mm.

^c Dimension *A* = rim width code × 25,4 (rounded to 0,5 mm) (increments of code = 0.5).

^d Some existing designs may follow minimum value of 17,3 well depth.

Dimensions in millimetres

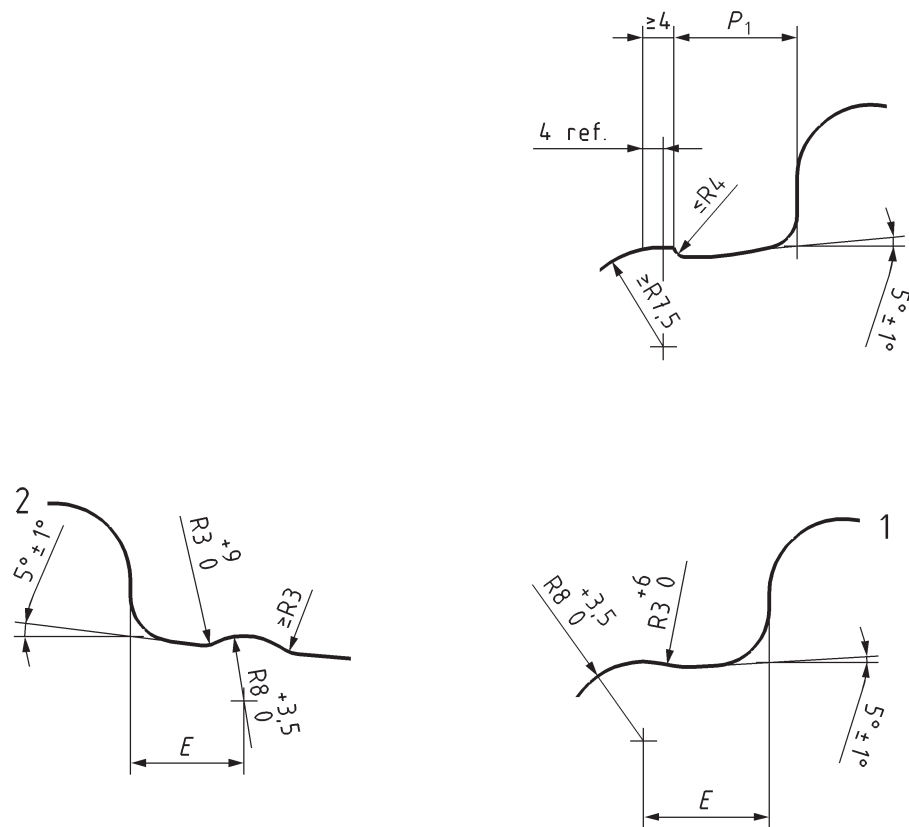

Key

- 1 tyre mounting side
- 2 tyre non-mounting side

Figure 2 — Optional bead seat contours

Table 3 — E dimension for round humps (see [Figure 2](#))

Dimensions in millimetres

Rim width code and flange type	E
3.00 B and 3 J	13 min.
3.50 B, 3 1/2 J, 4.00 B, 4 J	16 min.
4.50 B, 4 1/2 J and wider	21,0 ^{+2,0} ₀ ^a
^a 19,5 ^{+2,0} ₀ mm permitted for rim widths 4.50 B (4 1/2 J) to 7.00 B (7 J).	

5.3 Rim diameter and hump circumference

The specified rim diameter, *D*, for nominal rim-diameter codes and hump circumferences is given in [Table 4](#).

Table 4 — Specified rim diameter and hump circumference of 5° tapered (drop-centre) rims

Dimensions in millimetres

Nominal rim-diameter code	Specified rim diameter $D \pm 0,4^a$	Circumference	
		Flat hump $\begin{smallmatrix} 0 \\ -3,5 \end{smallmatrix}$	Round hump $\begin{smallmatrix} 0 \\ -3,5 \end{smallmatrix}^b$
10	253,2	795,4	797,6
12	304,0	955,0	957,6
13	329,4	1 034,8	1 037,0
14	354,8	1 114,6	1 116,8
15	380,2	1 194,4	1 196,6
16	405,6	1 274,2	1 276,4
17	436,6	1 371,6	1 373,8
18	462,0	1 451,4	1 453,6
19	487,4	1 531,2	1 533,4
20	512,8	1 611,0	1 613,2
21	538,2	1 690,8	1 693,0
22	563,6	1 770,6	1 772,8
23	589,0	1 850,4	1 852,6
24	614,4	1 930,2	1 932,4
25	639,8	2 010,0	2 012,2
26	665,2	2 089,8	2 092,0
28	716,0	2 249,4	2 251,6
30	766,8	2 409,0	2 411,2

^a Tolerance is for tyre design purpose only. The rim measurement is by a circumference-measuring tape related to a mandrel.

^b A tolerance of $\begin{smallmatrix} 0 \\ -5,0 \end{smallmatrix}$ mm is permitted on the vehicle inboard side only.

6 Valve holes

6.1 General

Valve hole edges on the tyre side of rims shall be rounded or chamfered; valve hole edges on the weather side of rims shall be free from burrs that could damage the valve.

6.2 Snap-in

To provide for adequate sealing, an unbroken smooth inside surface having at least 0,75 mm or 25 % of rim thickness, whichever is greater, shall be maintained. Suitable valves shall be used. Valve hole details for snap-in valves shall be as shown in [Figure 3](#) or [4](#) for rims with 17,3 mm minimum well depth.

6.3 Other valves

Holes for other valves are under consideration.

Dimensions in millimetres

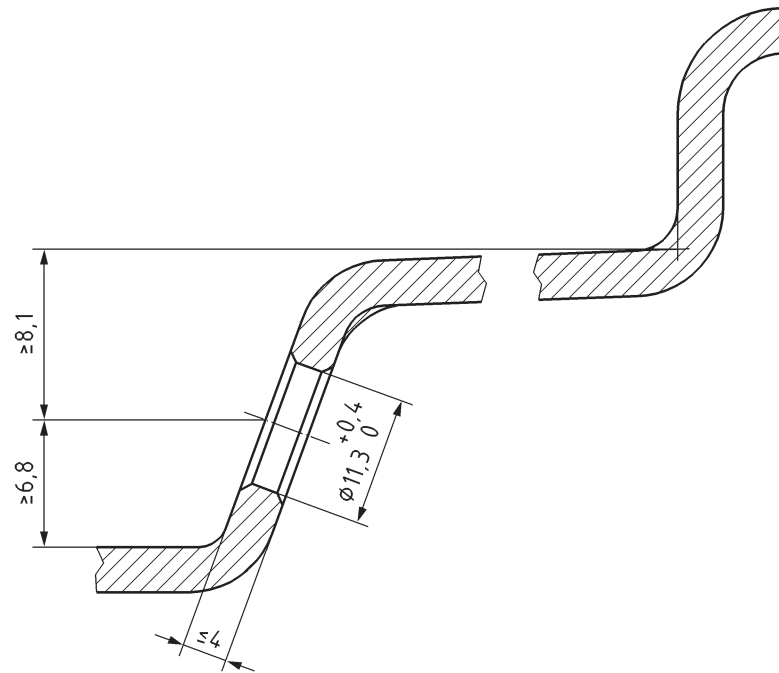
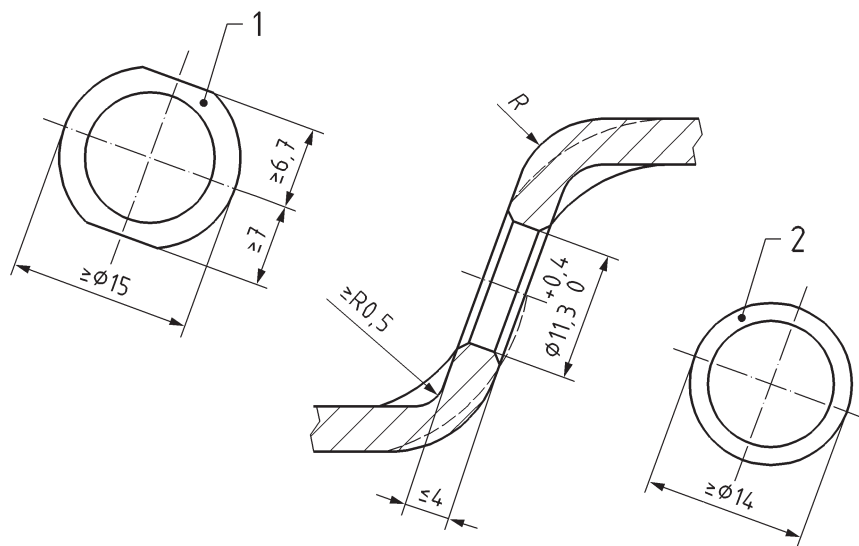

Figure 3 — Valve hole dimensions for snap-in valves

Dimensions in millimetres



Key

- 1 flat surface with no radial striations
- 2 flat surface for clamp-in valves

Figure 4 — Valve hole dimensions around valve hole

British Standards Institution (BSI)

BSI is the national body responsible for preparing British Standards and other standards-related publications, information and services.

BSI is incorporated by Royal Charter. British Standards and other standardization products are published by BSI Standards Limited.

About us

We bring together business, industry, government, consumers, innovators and others to shape their combined experience and expertise into standards-based solutions.

The knowledge embodied in our standards has been carefully assembled in a dependable format and refined through our open consultation process. Organizations of all sizes and across all sectors choose standards to help them achieve their goals.

Information on standards

We can provide you with the knowledge that your organization needs to succeed. Find out more about British Standards by visiting our website at bsigroup.com/standards or contacting our Customer Services team or Knowledge Centre.

Buying standards

You can buy and download PDF versions of BSI publications, including British and adopted European and international standards, through our website at bsigroup.com/shop, where hard copies can also be purchased.

If you need international and foreign standards from other Standards Development Organizations, hard copies can be ordered from our Customer Services team.

Subscriptions

Our range of subscription services are designed to make using standards easier for you. For further information on our subscription products go to bsigroup.com/subscriptions.

With **British Standards Online (BSOL)** you'll have instant access to over 55,000 British and adopted European and international standards from your desktop. It's available 24/7 and is refreshed daily so you'll always be up to date.

You can keep in touch with standards developments and receive substantial discounts on the purchase price of standards, both in single copy and subscription format, by becoming a **BSI Subscribing Member**.

PLUS is an updating service exclusive to BSI Subscribing Members. You will automatically receive the latest hard copy of your standards when they're revised or replaced.

To find out more about becoming a BSI Subscribing Member and the benefits of membership, please visit bsigroup.com/shop.

With a **Multi-User Network Licence (MUNL)** you are able to host standards publications on your intranet. Licences can cover as few or as many users as you wish. With updates supplied as soon as they're available, you can be sure your documentation is current. For further information, email bsmusales@bsigroup.com.

BSI Group Headquarters

389 Chiswick High Road London W4 4AL UK

Revisions

Our British Standards and other publications are updated by amendment or revision.

We continually improve the quality of our products and services to benefit your business. If you find an inaccuracy or ambiguity within a British Standard or other BSI publication please inform the Knowledge Centre.

Copyright

All the data, software and documentation set out in all British Standards and other BSI publications are the property of and copyrighted by BSI, or some person or entity that owns copyright in the information used (such as the international standardization bodies) and has formally licensed such information to BSI for commercial publication and use. Except as permitted under the Copyright, Designs and Patents Act 1988 no extract may be reproduced, stored in a retrieval system or transmitted in any form or by any means – electronic, photocopying, recording or otherwise – without prior written permission from BSI. Details and advice can be obtained from the Copyright & Licensing Department.

Useful Contacts:

Customer Services

Tel: +44 845 086 9001

Email (orders): orders@bsigroup.com

Email (enquiries): cservices@bsigroup.com

Subscriptions

Tel: +44 845 086 9001

Email: subscriptions@bsigroup.com

Knowledge Centre

Tel: +44 20 8996 7004

Email: knowledgecentre@bsigroup.com

Copyright & Licensing

Tel: +44 20 8996 7070

Email: copyright@bsigroup.com



...making excellence a habit.™