

BS EN 15583-2:2012



BSI Standards Publication

# Winter maintenance equipment — Snow ploughs

Part 2: Testing criteria and their  
requirements

**bsi.**

...making excellence a habit.™

**National foreword**

This British Standard is the UK implementation of EN 15583-2:2012.

The UK participation in its preparation was entrusted to Technical Committee B/513, Construction equipment and plant and site safety.

A list of organizations represented on this committee can be obtained on request to its secretary.

This publication does not purport to include all the necessary provisions of a contract. Users are responsible for its correct application.

© The British Standards Institution 2012. Published by BSI Standards Limited 2012

ISBN 978 0 580 68163 9

ICS 43.160

**Compliance with a British Standard cannot confer immunity from legal obligations.**

This British Standard was published under the authority of the Standards Policy and Strategy Committee on 31 May 2012.

**Amendments issued since publication**

Date	Text affected
------	---------------

---

EUROPEAN STANDARD

**EN 15583-2**

NORME EUROPÉENNE

EUROPÄISCHE NORM

February 2012

ICS 43.160

English Version

## Winter maintenance equipment - Snow ploughs - Part 2: Testing criteria and their requirements

Matériels de viabilité hivernale - Lames de déneigement -  
Partie 2: Critères d'essai et exigences

Winterdienstausrüstung - Schneepflüge - Teil 2:  
Prüfkriterien und deren Anforderungen

This European Standard was approved by CEN on 14 January 2012.

CEN members are bound to comply with the CEN/CENELEC Internal Regulations which stipulate the conditions for giving this European Standard the status of a national standard without any alteration. Up-to-date lists and bibliographical references concerning such national standards may be obtained on application to the CEN-CENELEC Management Centre or to any CEN member.

This European Standard exists in three official versions (English, French, German). A version in any other language made by translation under the responsibility of a CEN member into its own language and notified to the CEN-CENELEC Management Centre has the same status as the official versions.

CEN members are the national standards bodies of Austria, Belgium, Bulgaria, Croatia, Cyprus, Czech Republic, Denmark, Estonia, Finland, France, Germany, Greece, Hungary, Iceland, Ireland, Italy, Latvia, Lithuania, Luxembourg, Malta, Netherlands, Norway, Poland, Portugal, Romania, Slovakia, Slovenia, Spain, Sweden, Switzerland, Turkey and United Kingdom.



EUROPEAN COMMITTEE FOR STANDARDIZATION  
COMITÉ EUROPÉEN DE NORMALISATION  
EUROPÄISCHES KOMITEE FÜR NORMUNG

**Management Centre: Avenue Marnix 17, B-1000 Brussels**

## Contents

Page

Foreword.....	3
1 Scope .....	4
2 Normative references .....	4
3 Terms and definitions .....	4
4 Requirements .....	5
4.1 General requirements.....	5
4.2 Testing criteria – static.....	5
4.2.1 General.....	5
4.2.2 Description of the test bench .....	5
4.3 Testing criteria – dynamic .....	7
4.3.1 General.....	7
4.3.2 Validation criteria after testing .....	9
4.3.3 Side reverse test criteria of front-mounted snow plough and variable V-ploughs.....	9
Annex A (informative) Test protocol .....	10
Bibliography .....	11

## Foreword

This document (EN 15583-2:2012) has been prepared by Technical Committee CEN/TC 337 “Winter maintenance and road service area maintenance equipment”, the secretariat of which is held by AFNOR.

This European Standard shall be given the status of a national standard, either by publication of an identical text or by endorsement, at the latest by August 2012, and conflicting national standards shall be withdrawn at the latest by August 2012.

Attention is drawn to the possibility that some of the elements of this document may be the subject of patent rights. CEN [and/or CENELEC] shall not be held responsible for identifying any or all such patent rights.

According to the CEN/CENELEC Internal Regulations, the national standards organizations of the following countries are bound to implement this European Standard: Austria, Belgium, Bulgaria, Croatia, Cyprus, Czech Republic, Denmark, Estonia, Finland, France, Germany, Greece, Hungary, Iceland, Ireland, Italy, Latvia, Lithuania, Luxembourg, Malta, Netherlands, Norway, Poland, Portugal, Romania, Slovakia, Slovenia, Spain, Sweden, Switzerland, Turkey and the United Kingdom.

## 1 Scope

This European standard is valid for snow ploughs designed to be fitted to winter maintenance vehicles on their front-mounting plates according to EN 15432 and also for side-mounted snow ploughs.

Requirements regarding the testing of override security systems and/or bump security systems of front-mounted or side-mounted snow ploughs for winter service are determined by this document. This document is meant to assess the demands made on snow ploughs operated in traffic.

The document is valid for:

- single-side snow ploughs;
- variable V-ploughs.

The following points are not standardized by this document:

- V-shaped snow ploughs;
- requirements for registration and approval;
- requirements made by carrier vehicle manufacturers;
- requirements on safety – these are dealt with in EN 13021.

## 2 Normative references

The following documents, in whole or in part, are normatively referenced in this document and are indispensable for its application. For dated references, only the edition cited applies. For undated references, the latest edition of the referenced document (including any amendments) applies.

EN 10027-1, *Designation systems for steels — Part 1: Steel names*

EN 10027-2, *Designation systems for steels — Part 2: Numerical System*

EN 13021, *Winter service machines — Safety requirements*

EN 15144, *Winter maintenance equipment — Terminology — Terms for winter maintenance*

EN 15432, *Winter and road service area maintenance equipments — Front-mounted equipments — Interchangeability*

## 3 Terms and definitions

For the purposes of this document, the terms and definitions given in EN 15144 and the following apply.

### 3.1

#### **ice scraper**

implement to remove ice from the traffic area by scraping and pushing aside

### 3.2

#### test bench

support on which the snow clearing blade shall be positioned

## 4 Requirements

### 4.1 General requirements

The snow plough shall be tested in static and dynamic way. The manufacturer has to ensure, that both tests are made in the same configuration as the snow plough is being used by the customer. Tests shall be made with new scraper blades.

### 4.2 Testing criteria – static

#### 4.2.1 General

The static test will measure the resistance in daNm of the override system. The results shall be reported in the test protocol.

The static test of the override protection does not include V-ploughs and variable V-ploughs.

#### 4.2.2 Description of the test bench

##### 4.2.2.1 General

For the machinery of the test bench see Figure 1.

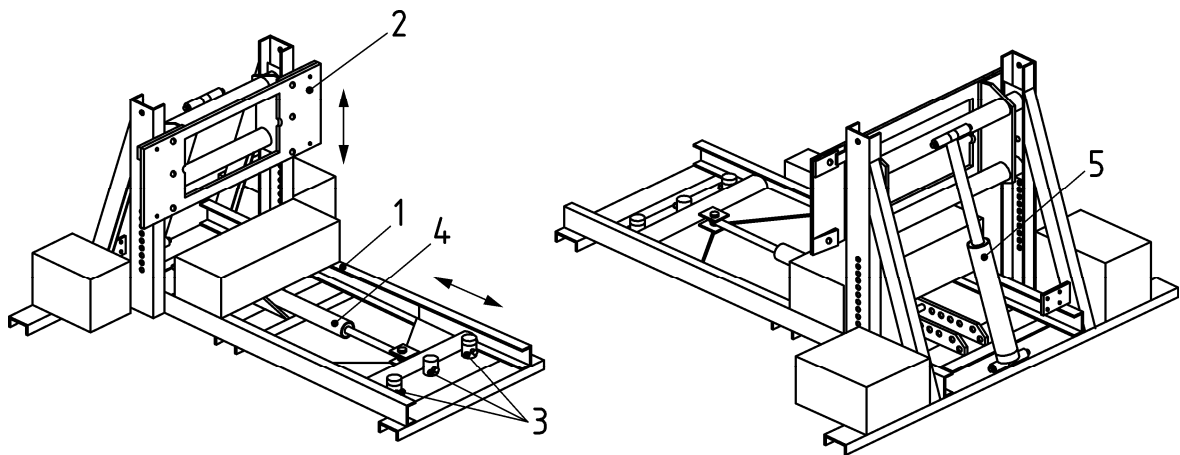

#### Key

- 1 base frame
- 2 attachment plate, adjustable in height, subject to F1 or F2 (see EN 15432)
- 3 mobile obstacle with possibility of assembly in different positions
- 4 plate movement cylinder
- 5 obstacle movement

Figure 1

##### 4.2.2.2 Purpose

To determine the force when tackling the obstacle ( $F_a$ ), see **phase 1** and the maximum force ( $F_{max}$ ) when getting over the obstacle **phase 2** and **phase 3** (see Figure 2a).

Dimensions in millimetres

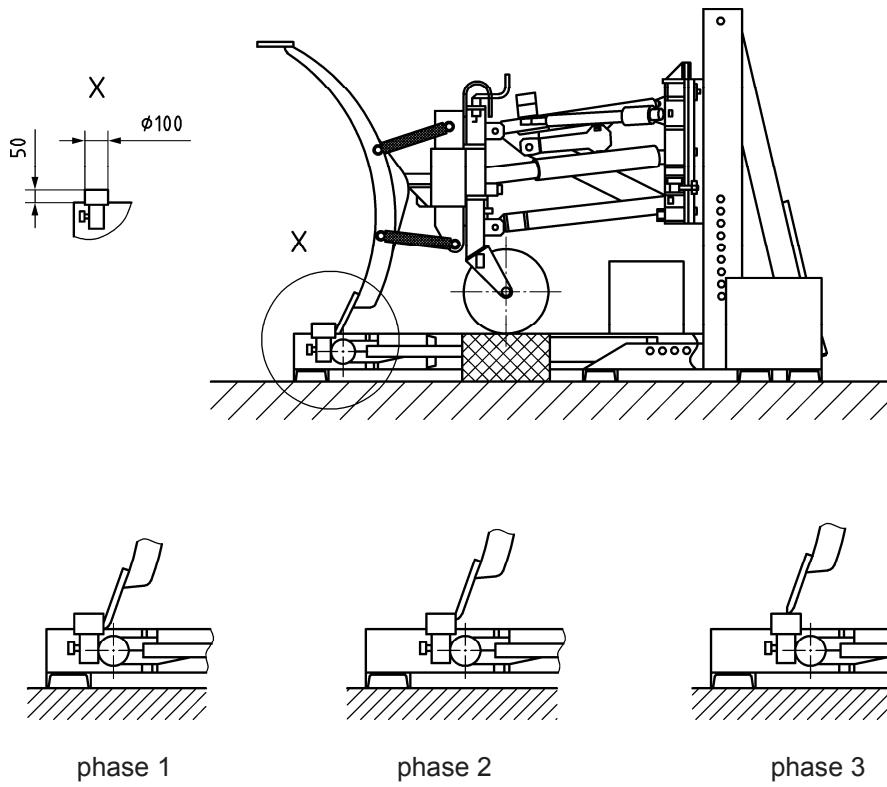

Figure 2a

The impact of force shall happen in the middle of the plough share (see figure 2b).

Dimensions in millimetres

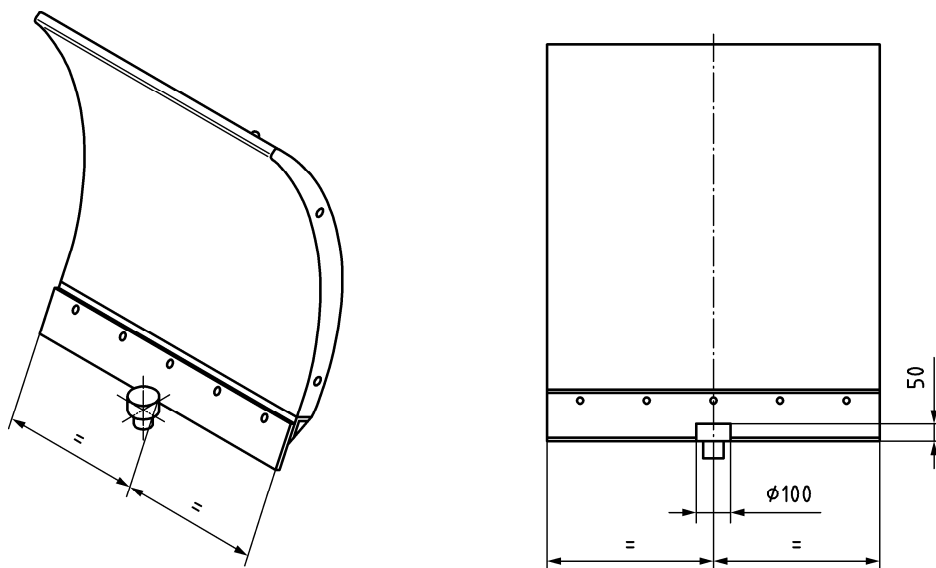

Figure 2b



The force values are obtained as follows:

$$F_{\max} = A \cdot P_{\max} \quad (1)$$

$$F_a = A \cdot P_a \quad (2)$$

where:

- $P_a$  pressure measured in bar inside the cylinder in phase 1
- $P_{\max}$  pressure measured in bar inside the cylinder when getting over the obstacle
- $F_a$  resistant force in phase 1
- $F_{\max}$  maximum resistant force when getting over the obstacle
- $A$  effective plunger square footage of the cylinder

#### 4.2.2.3 Test conditions

- a) dimensions of the obstacle  $\varnothing=100$  mm H=50 mm;
- b) height of plate, see EN 15432;
- c) obstacle movement speed < 0,05 m/s;
- d) working angle  $\alpha = 0^\circ$ ;
- e) attachment angle  $\beta$  = angle declared by manufacturer. If the attachment angle  $\beta$  is variable, the maximum pressure value obtained shall be taken.
- f) the test shall be repeated on the single element or, in the case of blade with just one element, on the single blade. If the elements are the same, the test shall be carried out for just one element;
- g) the force shall act in the centre of the blade (tolerance  $\pm 50$  mm);
- h) the scraper blade shall be in steel;
- i) obstacle material: steel S 355 (see EN 10027-1 and EN 10027-2);
- j) the blade shall be in the floating position during the test.

### 4.3 Testing criteria – dynamic

#### 4.3.1 General

The dynamic test for override protection is valid for mounted and side mounted single side snow ploughs and for ice scrapers.

The dynamic test of the override protection does not include V-ploughs and variable V-ploughs.

security: according to EN 13021

speed: see Table 1

Testing in three different positions (middle  $\pm 200$  mm, in outer element left and right up to 400 mm from the outer edge on each side).

attack angle  $\beta$ : declared by the manufacturer

clearing angle  $\alpha$ :  $0^\circ$  and maximum (declared by the manufacturer)

Size of obstacle two versions:

Version 1: Diameter 100 mm  $\rightarrow$  minimum height 50 mm (see Figure 3). The test shall be defined by the manufacturer. For speed see in Table 1.

Dimensions in millimetres

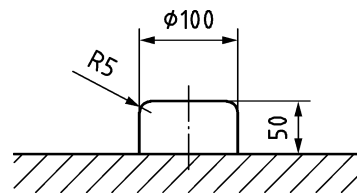

**Figure 3**

Version 2: Diameter 500 mm; minimum height 20 mm (see Figure 3) The test shall be defined by the manufacturer. With this test at least two override sections shall be included. For speed see in Table 1.

Dimensions in millimetres

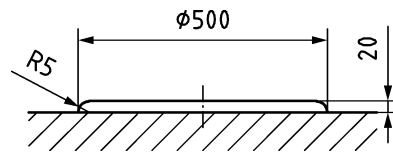

**Figure 4**

material of obstacle	steel S 355 (see EN 10027-1 and EN 10027-2)
material of scraper blade	steel (shall be defined by the manufacturer)
height of scraper blade	shall be defined by the manufacturer
thickness of scraper blade	shall be defined by the manufacturer
working condition	in floating position
testing temperature	the atmosphere temperature while testing shall be documented
number of testing	three per each test (18 in summary)

The test results shall be reported in the test protocol (see Annex A). For testing speed see Table 1.

Table 1 — Testing speed

	Obstacle Version 1 (in km/h)	Obstacle Version 2 (in km/h)
Front mounted snow plough	25	40
Side mounted snow plough	25	40
Ice scraper	5	5

#### 4.3.2 Validation criteria after testing

There shall be no visible damage on the snow plough after the tests. Nothing shall be bending, broken or cracked. The validation criteria are only valid for the dynamic tests.

#### 4.3.3 Side reverse test criteria of front-mounted snow plough and variable V-ploughs

The manufacturer shall measure the force for side reverse as a static test.

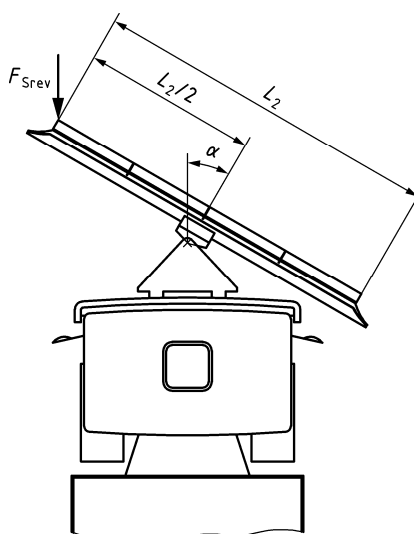

#### Key

- $F_{Srev}$  side reverse bump force
- $L_2$  length of snow plough
- $\alpha$  maximum possible angle

Figure 5

The height of force-application shall be horizontal at 200 mm from the ground and directly into the plough frame (see Figure 5).

The results shall be reported in the test protocol.

The manufacturer shall define the angle  $\alpha$  (see Figure 5) at which the test has been made. The test shall be carried out at the maximum possible angle  $\alpha$ .

**Annex A**  
(informative)  
**Test protocol**

Producer:				
Snow plough model:				
Fabrication No.:				
Date of testing:				
Type of snow plough:				
Material of scraper blade:				
Height of scraper blade:				
Thickness of scraper blade:				
Testing temperature:				
		Obstacle Version 1		
		Section		
		Outer element left	Center element	Outer element right
Testing speed [km/h]	Test No.	Visual damage detected (yes/ no)?		
	1			
	2			
	3			
		Obstacle Version 2		
		Section		
		Outer elements left	Center element	Outer elements right
		Visual damage detected (yes/ no)?		
Testing speed [km/h]	Test No.			
	1			
	2			
	3			

## Bibliography

EN 15583-1:2009, *Winter maintenance equipment — Snow ploughs — Part 1: Product description and requirements*





# British Standards Institution (BSI)

BSI is the national body responsible for preparing British Standards and other standards-related publications, information and services.

BSI is incorporated by Royal Charter. British Standards and other standardization products are published by BSI Standards Limited.

## About us

We bring together business, industry, government, consumers, innovators and others to shape their combined experience and expertise into standards-based solutions.

The knowledge embodied in our standards has been carefully assembled in a dependable format and refined through our open consultation process. Organizations of all sizes and across all sectors choose standards to help them achieve their goals.

## Information on standards

We can provide you with the knowledge that your organization needs to succeed. Find out more about British Standards by visiting our website at [bsigroup.com/standards](http://bsigroup.com/standards) or contacting our Customer Services team or Knowledge Centre.

## Buying standards

You can buy and download PDF versions of BSI publications, including British and adopted European and international standards, through our website at [bsigroup.com/shop](http://bsigroup.com/shop), where hard copies can also be purchased.

If you need international and foreign standards from other Standards Development Organizations, hard copies can be ordered from our Customer Services team.

## Subscriptions

Our range of subscription services are designed to make using standards easier for you. For further information on our subscription products go to [bsigroup.com/subscriptions](http://bsigroup.com/subscriptions).

With **British Standards Online (BSOL)** you'll have instant access to over 55,000 British and adopted European and international standards from your desktop. It's available 24/7 and is refreshed daily so you'll always be up to date.

You can keep in touch with standards developments and receive substantial discounts on the purchase price of standards, both in single copy and subscription format, by becoming a **BSI Subscribing Member**.

**PLUS** is an updating service exclusive to BSI Subscribing Members. You will automatically receive the latest hard copy of your standards when they're revised or replaced.

To find out more about becoming a BSI Subscribing Member and the benefits of membership, please visit [bsigroup.com/shop](http://bsigroup.com/shop).

With a **Multi-User Network Licence (MUNL)** you are able to host standards publications on your intranet. Licences can cover as few or as many users as you wish. With updates supplied as soon as they're available, you can be sure your documentation is current. For further information, email [bsmusales@bsigroup.com](mailto:bsmusales@bsigroup.com).

## BSI Group Headquarters

389 Chiswick High Road London W4 4AL UK

## Revisions

Our British Standards and other publications are updated by amendment or revision.

We continually improve the quality of our products and services to benefit your business. If you find an inaccuracy or ambiguity within a British Standard or other BSI publication please inform the Knowledge Centre.

## Copyright

All the data, software and documentation set out in all British Standards and other BSI publications are the property of and copyrighted by BSI, or some person or entity that owns copyright in the information used (such as the international standardization bodies) and has formally licensed such information to BSI for commercial publication and use. Except as permitted under the Copyright, Designs and Patents Act 1988 no extract may be reproduced, stored in a retrieval system or transmitted in any form or by any means – electronic, photocopying, recording or otherwise – without prior written permission from BSI. Details and advice can be obtained from the Copyright & Licensing Department.

## Useful Contacts:

### Customer Services

**Tel:** +44 845 086 9001

**Email (orders):** [orders@bsigroup.com](mailto:orders@bsigroup.com)

**Email (enquiries):** [cservices@bsigroup.com](mailto:cservices@bsigroup.com)

### Subscriptions

**Tel:** +44 845 086 9001

**Email:** [subscriptions@bsigroup.com](mailto:subscriptions@bsigroup.com)

### Knowledge Centre

**Tel:** +44 20 8996 7004

**Email:** [knowledgecentre@bsigroup.com](mailto:knowledgecentre@bsigroup.com)

### Copyright & Licensing

**Tel:** +44 20 8996 7070

**Email:** [copyright@bsigroup.com](mailto:copyright@bsigroup.com)



...making excellence a habit.™