

# Design and application of gypsum blocks

The European Standard EN 15318:2007 has the status of a  
British Standard

ICS 91.100.10

## National foreword

This British Standard is the UK implementation of EN 15318:2007.

The UK participation in its preparation was entrusted by Technical Committee B/544, Plastering, rendering, dry lining, to Subcommittee B/544/1, Gypsum plasters, cast gypsum and ancillaries.

A list of organizations represented on this committee can be obtained on request to its secretary.

This publication does not purport to include all the necessary provisions of a contract. Users are responsible for its correct application.

**Compliance with a British Standard cannot confer immunity from legal obligations.**

This British Standard was published under the authority of the Standards Policy and Strategy Committee on 31 October 2007

© BSI 2007

ISBN 978 0 580 55712 5

### Amendments issued since publication

Amd. No.	Date	Comments

ICS 91.100.10

English Version

## Design and application of gypsum blocks

Conception et exécution des ouvrages en carreaux de  
plâtrePlanung und Ausführung von Bauteilen aus Gips-  
Wandbauplatten

This European Standard was approved by CEN on 26 August 2007.

CEN members are bound to comply with the CEN/CENELEC Internal Regulations which stipulate the conditions for giving this European Standard the status of a national standard without any alteration. Up-to-date lists and bibliographical references concerning such national standards may be obtained on application to the CEN Management Centre or to any CEN member.

This European Standard exists in three official versions (English, French, German). A version in any other language made by translation under the responsibility of a CEN member into its own language and notified to the CEN Management Centre has the same status as the official versions.

CEN members are the national standards bodies of Austria, Belgium, Bulgaria, Cyprus, Czech Republic, Denmark, Estonia, Finland, France, Germany, Greece, Hungary, Iceland, Ireland, Italy, Latvia, Lithuania, Luxembourg, Malta, Netherlands, Norway, Poland, Portugal, Romania, Slovakia, Slovenia, Spain, Sweden, Switzerland and United Kingdom.



EUROPEAN COMMITTEE FOR STANDARDIZATION  
COMITÉ EUROPÉEN DE NORMALISATION  
EUROPÄISCHES KOMITEE FÜR NORMUNG

Management Centre: rue de Stassart, 36 B-1050 Brussels

**Contents**

Page

Foreword.....3

1 Scope .....4

2 Normative references .....4

3 Terms and definitions .....5

4 Design .....6

4.1 General.....6

4.2 Materials .....6

4.3 Structure and Functions .....6

4.3.1 General.....6

4.3.2 Dividing or separating partitions .....7

4.3.3 Backing partitions.....7

4.3.4 Ducts .....7

4.3.5 Lining of posts .....7

4.4 Specific structural requirements.....7

4.4.1 General.....7

4.4.2 Damp rooms .....7

4.4.3 Walls exposed to impacts .....8

4.4.4 Safety in the event of fire .....8

4.4.5 Protection against noise .....8

4.4.6 Overhanging partitions .....8

4.5 Requirements .....8

4.5.1 Mechanical strength and stability .....8

4.5.2 Fire behaviour .....8

4.5.3 Safety in use.....9

4.5.4 Noise protection.....11

4.5.5 Energy saving and thermal insulation: thermal resistance of structures .....12

Bibliography .....14

## Foreword

This document (EN 15318:2007) has been prepared by Technical Committee CEN/TC 241 “Gypsum and gypsum based products”, the secretariat of which is held by AFNOR.

This European Standard shall be given the status of a national standard, either by publication of an identical text or by endorsement, at the latest by April 2008, and conflicting national standards shall be withdrawn at the latest by April 2008.

Attention is drawn to the possibility that some of the elements of this document may be the subject of patent rights. CEN [and/or CENELEC] shall not be held responsible for identifying any or all such patent rights.

This document has been prepared under a mandate given to CEN by the European Commission and the European Free Trade Association, and supports essential requirements of EC Directive(s).

According to the CEN/CENELEC Internal Regulations, the national standards organizations of the following countries are bound to implement this European Standard: Austria, Belgium, Bulgaria, Cyprus, Czech Republic, Denmark, Estonia, Finland, France, Germany, Greece, Hungary, Iceland, Ireland, Italy, Latvia, Lithuania, Luxembourg, Malta, Netherlands, Norway, Poland, Portugal, Romania, Slovakia, Slovenia, Spain, Sweden, Switzerland and the United Kingdom.

## 1 Scope

This European Standard defines the rules for the design of gypsum blocks as specified in EN 12859, assembled with adhesives as specified in EN 12860. Accessory products are also defined in this document. It is applicable to non-loadbearing partition walls and internal insulation of walls in rooms of residential buildings, offices, hospitals, schools etc. and to linings of posts, beams, ducts, shafts etc, that are suitable to receive finishes such as paint and wallpaper without any prior traditional plastering, but having had normal preparation prior to painting.

Certain components requiring special provisions are not covered by this standard and require special consideration.

## 2 Normative references

The following referenced documents are indispensable for the application of this document. For dated references, only the edition cited applies. For undated references, the latest edition of the referenced document (including any amendments) applies

EN 12859:2001, *Gypsum blocks - Definitions, requirements and test methods*

EN 12860, *Gypsum based adhesives for gypsum blocks - Definitions, requirements and test methods*

EN 13501-2, *Fire classification of construction products and building elements - Part 2: Classification using data from fire resistance tests, excluding ventilation services*

### 3 Terms and definitions

For the purposes of this European Standard, the following terms and definitions apply.

#### 3.1

##### **partition**

non-loadbearing, self-supporting vertical wall fixed to the shell construction at the periphery

#### 3.2

##### **dividing partition**

partition separating two rooms or spaces belonging to the same structural unit (office, school, house, etc.)

#### 3.3

##### **backing partition**

partition placed back-to-back with a wall element to which it is not connected

#### 3.4

##### **partition connected at top**

partition extending over the whole distance between the floor and the ceiling and connected to the shell construction at the top

#### 3.5

##### **partition free at top**

partition extending over the whole distance but not connected to the shell construction at the top

#### 3.6

##### **dwarf partition**

partition extending only over part of the distance between the floor and the ceiling

#### 3.7

##### **single partition**

partition of thickness equal to that of the gypsum block

#### 3.8

##### **multiple partition**

partition comprising several single gypsum block partitions separated by a cavity, possibly fitted with insulation

#### 3.9

##### **composite partition**

single or multiple partition connected to other materials to satisfy specific performance requirements

#### 3.10

##### **free-ended partition**

partition with an unconnected vertical edge

#### 3.11

##### **overhanging partition**

partition at the end of the top floor

#### 3.12

##### **lining (of posts)**

encasement of any load bearing element

#### 3.13

##### **duct**

vertical or inclined structure that incorporates shafts and does not convey fluids (air, smoke) directly

**3.14**

**shaft**

vertical structure that conveys fluids or gases directly

NOTE Shafts made of gypsum blocks are intended to convey only air or smoke

**3.15**

**panel**

part of partition between stiffeners, between structural elements, between stiffener and structural elements

**3.16**

**stiffener**

existing or additional structural element contributing to the stability of the gypsum block structure

**3.17**

**additional vertical stiffener**

vertical reinforcing element connected at its two ends to the structure or to an additional horizontal stiffener

**3.18**

**additional horizontal stiffener**

horizontal reinforcing element ensuring the load is transferred to the structure

**3.19**

**horizontal stiffener for dwarf partition**

horizontal reinforcing element connected at its two ends to the structure or to an additional stiffener to ensure the horizontal loads are transferred

**3.20**

**mechanical stress level**

- HIGH: stresses in non-residential rooms
- NORMAL: stresses in residential rooms

## **4 Design**

### **4.1 General**

By following the recommendations in this document, the designer can specify partitions suitable for the use for which they are intended.

### **4.2 Materials**

- gypsum blocks according to EN 12859;
- gypsum-based adhesives for gypsum blocks according to EN 12860;
- other materials and accessories can be used.

### **4.3 Structure and Functions**

#### **4.3.1 General**

The following factors can influence the choice of the type of gypsum blocks and shall be taken into account with the structural requirements:

- a) type of building (single-family houses, buildings, etc.), purpose (accommodation, schools, offices, hospitals, etc.) and use (for example: damp rooms);



- b) dimensional accuracy of the structure;
- c) service arrangements (distribution of fluids, electricity);
- d) type of connections to the structure and to the incorporated elements (frames, etc.), fixing loads.

The following functions shall also be taken into account in the choice of the type of gypsum blocks:

- e) exposure to impacts and abrasion;
- f) temperature and humidity conditions;
- g) thermal insulation;
- h) sound insulation;
- i) safety in the event of fire.

#### **4.3.2 Dividing or separating partitions**

The partitions ensure one or more of the following functions:

Separation, fire protection, sound insulation or thermal insulation, supporting of loads, impact strength.

#### **4.3.3 Backing partitions**

Backings are structures intended to reinforce the thermal insulation, sound insulation or fire resistance properties of the structures against which they are backed.

#### **4.3.4 Ducts**

The ducts ensure one or more of the following functions:

- protecting the ambient medium against noise generated or transmitted by the shafts;
- protecting the shafts against fire;
- preventing propagation of the fire from one room to another.

Vertical ducts can be made of gypsum blocks on one or more faces according to their positioning relative to the shell construction. The duct walls can be single or composite according to the performance required.

#### **4.3.5 Lining of posts**

For aesthetic or technical reasons (fire resistance), all types of post (wood, metal, concrete ...) can be protected by gypsum block structures.

### **4.4 Specific structural requirements**

#### **4.4.1 General**

Depending on the type of building or purposes of the rooms, special precautions shall be taken into account.

#### **4.4.2 Damp rooms**

In rooms exposed intermittently to water, either by use or by the need to wash the surface of the partition or the adjacent floor, water-repellent gypsum blocks shall be used.

The type of blocks is determined depending on the planned use of the room and on the level of exposure of the wall to water.

#### **4.4.3 Walls exposed to impacts**

In rooms where a higher surface resistance is required with respect to impacts (e.g. schools, corridors ...), it is recommended to use high-density blocks in the area's involved.

#### **4.4.4 Safety in the event of fire**

Where the structure is considered to meet fire resistance requirements, it shall have been the subject of a test and a classification according to EN 13501-2.

The blocks can also be selected as a function of the fire resistance values in use specified in 4.5.2.2, Table 1.

#### **4.4.5 Protection against noise**

Where the structure is considered to meet sound insulation requirements, the blocks are selected as a function of the information in 4.5.5.

#### **4.4.6 Overhanging partitions**

Special provisions shall be made to improve the safety conditions in use.

### **4.5 Requirements**

#### **4.5.1 Mechanical strength and stability**

Gypsum block partitions are self-supporting non-loadbearing structures that do not affect the general stability of the structure. The mechanical requirements linked to safety in use are covered in 4.5.3.

#### **4.5.2 Fire behaviour**

##### **4.5.2.1 Reaction to fire**

Gypsum blocks conforming to EN 12859 are classed as Euroclass A1 (non-combustible) without testing when they contain less than 1% by volume or by mass (according to the most unfavourable value regarding reaction to fire) of homogeneously distributed organic material.

If they contain more than 1 % of organic material by mass or by volume, they shall be tested and classified according to EN 13501-1.

##### **4.5.2.2 Fire resistance**

###### **a) Fire resistance of single partitions**

The values in use established in previous tests to be confirmed or determined subsequently on the basis of EN 1364-1 are given in Table 1.

Table 1 — Fire resistance: values in use

Thickness	Density class	E min.	E min.	EI min.	EI min.
		Solid blocks	Blocks with cavities	Solid blocks	Blocks with cavities
50	low (L)				
50	medium (M)	60		60	
50	high (H)				
60	L				
60	M	120	60	120	60
60	H	120	60	120	60
70	L				
70	M	180	120	180	120
70	H	180	120	180	120
80	L				
80	M				
80	H				
100	L				
100	M	240	180	240	180
100	H	240	180	240	180

For cases not covered above, a test by an accredited laboratory is necessary to determine performance. This test may be replaced by the opinion of a laboratory based on extrapolation of a close solution.

#### b) Fire resistance of composite partitions and other gypsum block structures

For cases not covered above, the structure shall be the subject of a test and classification according to EN 13501-2. This test may be replaced by the opinion of a laboratory based on extrapolation of a related solution.

### 4.5.3 Safety in use

#### 4.5.3.1 General

Gypsum block partitions are self-supporting and present no risk to the safety of the user as long as the requirements of this subclause are met. The maximum dimensions indicated in the tables below result from

just mechanical considerations. This allows the structure to withstand the normal and high mechanical stresses.

The tables below define the maximum permitted dimensions for gypsum blocks of all densities.

Dimensioning of the partition is obtained by dividing into panels, the maximum dimensions of which are indicated according to the stress levels in Table 2 and Table 3. The panels are limited by the structure of the building or stiffeners as shown in Figures 1, 2 and 3.

**Table 2 — Maximum dimensions of single partitions**  
**Stress level: normal**

Blocks solid HD	Blocks solid MD	Blocks solid LD	Blocks with cavities MD	Type 1a partition <sup>b</sup>			Type 1b partition <sup>c</sup>			Type 2 partition <sup>d</sup>			Type 3 partition <sup>e</sup>		
				S max. m <sup>2</sup> <sup>a</sup>	H max. m	L max m	S max. m <sup>2</sup> <sup>a</sup>	H max. m	L max m.	S max. m <sup>2</sup> <sup>a</sup>	H max. m	L max m.	S max. m <sup>2</sup> <sup>a</sup>	H max. m	L max m.
		50	50												
	50	60	60												
50	60	70	70	32	4,00	8,00								1,50	1,50
60	70	80	80	55	5,00	11,0				2,75				2,50	2,50
70	80	100	100	77	5,50	14,0				3,50				3,50	3,50
80	100				5,50	16,5				5,00				4,00	4,00

<sup>a</sup> The maximum surface area is the first criterion to be met.

<sup>b</sup> Type 1a partitions = partitions without openings.

<sup>c</sup> Type 1b partitions = partitions without openings and with large height dimension.

<sup>d</sup> Type 2 partitions = partitions with openings.

<sup>e</sup> Type 3 partitions = partitions not connected at top.

NOTE The same limits apply to partitions made of water-repellent blocks.

**Table 3 — Maximum dimensions of single partitions**  
Stress level: high

Blocks solid	Blocks solid	Blocks solid	Blocks with cavities	Type 1a partition <sup>b</sup>			Type 1b partition <sup>c</sup>			Type 2 partition <sup>d</sup>			Type 3 partition <sup>e</sup>		
				S max.	H max.	L max.	S max.	H max.	L max.	S max.	H max.	L max.	S max.	H max.	L max.
HD	MD	LD	MD	m <sup>2 a</sup>	m	m.	m <sup>2 a</sup>	m	m	m <sup>2 a</sup>	m	m.	m <sup>2 a</sup>	m	m.
		50	50	10	2,5	4									
	50	60	60	12	3	5	8	4		10	2,5	4			
50	60	70	70	16	4	6	10	8		12	3	5	10	2,5	4
60	70	80	80	18	5	7	14	9		16	4	6	12	3	5
70	80	100	100	24	6	8	18	10		18	5	7	16	4	6
80	100			32	8	10	24	12		24	8	8	18	5	7
				32	8	10									

<sup>a</sup> The maximum surface area is the first criterion to be met.

<sup>b</sup> Type 1a partitions = partitions without openings.

<sup>c</sup> Type 1b partitions = partitions without openings and with large height dimension.

<sup>d</sup> Type 2 partitions = partitions with openings.

<sup>e</sup> Type 3 partitions = partitions not connected at top.

NOTE The same limits apply to partitions made of water-repellent blocks.

#### 4.5.3.2 Stiffeners

The stiffeners shall be designed according to the details given in the figures below. Other solutions are possible if the stability of the partitions has been proven.

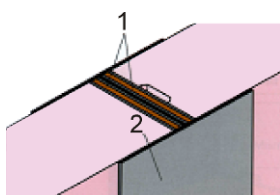

Key

- 1 resilient foam tape
- 2 metallic stiffener

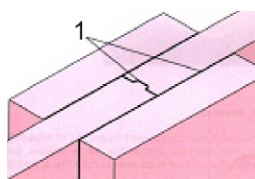

Key

- 1 gypsum based adhesive

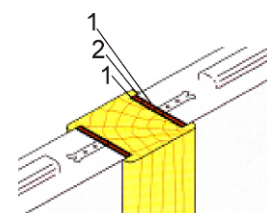

Key

- 1 gypsum based adhesive
- 2 cork

**Figure 1 — Metallic stiffener    Figure 2 — Stiffener out of gypsum blocks    Figure 3 — Wood with stiffener**

#### 4.5.4 Noise protection

The sound insulation performance of the gypsum block partitions is indicated in Table 4. The values in use for  $R_w$ , (and  $C$ ,  $C_{tr}$ ) expressed in dB (decibels) are determined on the basis of previous tests or tests to be confirmed or determined based on EN ISO 717-1 with flexible and tight joints.

Table 4 — Sound insulation of type 1a and 1b single partitions

Partition thickness (mm)	Density class L 600 to 800	Density class M 800 to 1100	Density class H 1100 to 1500
50	29 <sub>(-2,-3)</sub> to 30 <sub>(-1,-2)</sub>	30 <sub>(-1,-2)</sub> to 33 <sub>(-1,-3)</sub>	33 <sub>(-1,-3)</sub> to 35 <sub>(-1,-2)</sub>
60	30 <sub>(-1,-3)</sub> to 31 <sub>(0,-2)</sub>	31 <sub>(0,-2)</sub> to 34 <sub>(-1,-2)</sub>	34 <sub>(-1,-2)</sub> to 37 <sub>(0,-2)</sub>
70	31 <sub>(-1,-3)</sub> to 33 <sub>(-1,-2)</sub>	33 <sub>(-1,-2)</sub> to 35 <sub>(0,-2)</sub>	35 <sub>(0,-2)</sub> to 39 <sub>(-1,-3)</sub>
80	31 <sub>(-1,-2)</sub> to 34 <sub>(-1,-2)</sub>	34 <sub>(-1,-2)</sub> to 37 <sub>(-1,-3)</sub>	37 <sub>(-1,-3)</sub> to 40 <sub>(0,-3)</sub>
100	32 <sub>(-1,-2)</sub> to 35 <sub>(0,-3)</sub>	35 <sub>(0,-3)</sub> to 39 <sub>(-1,-4)</sub>	39 <sub>(-1,-4)</sub> to 44 <sub>(-1,-5)</sub>

For cases not covered above, the performances shall be determined by an accredited laboratory. This test may be replaced by the opinion of a laboratory based on extrapolation of a related solution.

#### 4.5.5 Energy saving and thermal insulation: thermal resistance of structures

The thermal resistance R per unit of surface area of the gypsum block structures can be calculated for homogenous elements using the formula given in EN ISO 6946, Building components and building elements - Thermal resistance and thermal transmittance - Calculation method :

$$R = \Sigma \left[ \frac{\lambda}{e} + \left( \frac{1}{h_i} + \frac{1}{h'_i} \right) \right] \quad (1)$$

where

- R is the thermal resistance in m<sup>2</sup>K/W;
- λ is the thermal conductivity of the block in W/mK (at 23 °C and 50 % RH);
- h<sub>i</sub> and h'<sub>i</sub> are the heat transfer coefficients of the wall in m<sup>2</sup>K/W;
- e is the thickness of the blocks in m.

For the calculation, the values of λ given in 5.3.2 of EN 12859:2001 shall be used as shown in Table 5.

Table 5 — Thermal conductivity values of gypsum as a function of the density

<b>P</b>	<b><math>\Lambda_{23/50}</math></b>
600	0,18
700	0,22
800	0,26
900	0,30
1000	0,34
1100	0,39
1200	0,43
1300	0,47
1400	0,51
1500	0,54

NOTE 1  $\rho$  is the density in kg / m<sup>3</sup>.

NOTE 2  $\lambda_{23/50}$  is the thermal conductivity of the gypsum in W/mK.

In the case of blocks of the medium-density class as defined in EN 12859 Gypsum blocks, the values given in Table 6 below may be used:

Table 6 — Conventional thermal resistance (R) values for medium-density (class M) blocks

<b>Thickness in mm</b>	<b>50</b>	<b>60</b>	<b>70</b>	<b>80</b>	<b>100</b>
Thermal resistance R in m <sup>2</sup> K/W	0,14	0,17	0,20	0,23	0,29
	(solid)	(solid)	(solid)	(solid)	(solid)
	0,17	0,20	0,23	0,29	0,35
	(with cavities)	(with cavities)	(with cavities)	(with cavities)	(with cavities)

## Bibliography

- [1] EN 14195, *Metal framing components for gypsum plasterboard systems - Definitions, requirements and test methods*
- [2] EN 13963, *Jointing materials for gypsum plasterboards - Definitions, requirements and test methods*
- [3] EN ISO 140-3, *Acoustics - Measurement of sound insulation in buildings and of building elements - Part 3: Laboratory measurements of airborne sound insulation of building elements (ISO 140-3:1995)*
- [4] EN ISO 6946, *Building components and building elements - Thermal resistance and thermal transmittance - Calculation method (ISO 6946:1996)*
- [5] EN 1364-1, *Fire resistance tests for non-loadbearing elements - Part 1: Walls*
- [6] EN 13501-1, *Fire classification of construction products and building elements - Part 1: Classification using data from reaction to fire tests*
- [7] EN ISO 717-1, *Acoustics - Rating of sound insulation in buildings and of building elements - Part 1: Airborne sound insulation (ISO 717-1:1996)*





---

---

## BSI — British Standards Institution

BSI is the independent national body responsible for preparing British Standards. It presents the UK view on standards in Europe and at the international level. It is incorporated by Royal Charter.

### Revisions

British Standards are updated by amendment or revision. Users of British Standards should make sure that they possess the latest amendments or editions.

It is the constant aim of BSI to improve the quality of our products and services. We would be grateful if anyone finding an inaccuracy or ambiguity while using this British Standard would inform the Secretary of the technical committee responsible, the identity of which can be found on the inside front cover.  
Tel: +44 (0)20 8996 9000. Fax: +44 (0)20 8996 7400.

BSI offers members an individual updating service called PLUS which ensures that subscribers automatically receive the latest editions of standards.

### Buying standards

Orders for all BSI, international and foreign standards publications should be addressed to Customer Services. Tel: +44 (0)20 8996 9001.  
Fax: +44 (0)20 8996 7001. Email: [orders@bsi-global.com](mailto:orders@bsi-global.com). Standards are also available from the BSI website at <http://www.bsi-global.com>.

In response to orders for international standards, it is BSI policy to supply the BSI implementation of those that have been published as British Standards, unless otherwise requested.

### Information on standards

BSI provides a wide range of information on national, European and international standards through its Library and its Technical Help to Exporters Service. Various BSI electronic information services are also available which give details on all its products and services. Contact the Information Centre.  
Tel: +44 (0)20 8996 7111. Fax: +44 (0)20 8996 7048. Email: [info@bsi-global.com](mailto:info@bsi-global.com).

Subscribing members of BSI are kept up to date with standards developments and receive substantial discounts on the purchase price of standards. For details of these and other benefits contact Membership Administration.  
Tel: +44 (0)20 8996 7002. Fax: +44 (0)20 8996 7001.  
Email: [membership@bsi-global.com](mailto:membership@bsi-global.com).

Information regarding online access to British Standards via British Standards Online can be found at <http://www.bsi-global.com/bsonline>.

Further information about BSI is available on the BSI website at <http://www.bsi-global.com>.

### Copyright

Copyright subsists in all BSI publications. BSI also holds the copyright, in the UK, of the publications of the international standardization bodies. Except as permitted under the Copyright, Designs and Patents Act 1988 no extract may be reproduced, stored in a retrieval system or transmitted in any form or by any means – electronic, photocopying, recording or otherwise – without prior written permission from BSI.

This does not preclude the free use, in the course of implementing the standard, of necessary details such as symbols, and size, type or grade designations. If these details are to be used for any other purpose than implementation then the prior written permission of BSI must be obtained.

Details and advice can be obtained from the Copyright & Licensing Manager.  
Tel: +44 (0)20 8996 7070. Fax: +44 (0)20 8996 7553.  
Email: [copyright@bsi-global.com](mailto:copyright@bsi-global.com).