

BS EN ISO 10675-1:2016



BSI Standards Publication

Non-destructive testing of welds — Acceptance levels for radiographic testing

Part 1: Steel, nickel, titanium and their
alloys

bsi.

National foreword

This British Standard is the UK implementation of EN ISO 10675-1:2016. It supersedes BS EN ISO 10675-1:2013 which is withdrawn.

The UK participation in its preparation was entrusted to Technical Committee WEE/46, Non-destructive testing.

A list of organizations represented on this committee can be obtained on request to its secretary.

This publication does not purport to include all the necessary provisions of a contract. Users are responsible for its correct application.

© The British Standards Institution 2017.
Published by BSI Standards Limited 2017

ISBN 978 0 580 87623 3

ICS 25.160.40

Compliance with a British Standard cannot confer immunity from legal obligations.

This British Standard was published under the authority of the Standards Policy and Strategy Committee on 31 **January 2017**.

Amendments/Corrigenda issued since publication

Date	Text affected
------	---------------

EUROPEAN STANDARD

EN ISO 10675-1

NORME EUROPÉENNE

EUROPÄISCHE NORM

December 2016

ICS 25.160.40

Supersedes EN ISO 10675-1:2013

English Version

**Non-destructive testing of welds - Acceptance levels for
radiographic testing - Part 1: Steel, nickel, titanium and
their alloys (ISO 10675-1:2016)**

Essais non destructifs des assemblages soudés -
Niveaux d'acceptation pour évaluation par
radiographie - Partie 1: Acier, nickel, titane et leurs
alliages (ISO 10675-1:2016)

Zerstörungsfreie Prüfung von Schweißverbindungen -
Zulässigkeitsgrenzen für die Durchstrahlungsprüfung -
Teil 1: Stahl, Nickel, Titan und deren Legierungen (ISO
10675-1:2016)

This European Standard was approved by CEN on 14 December 2016.

CEN members are bound to comply with the CEN/CENELEC Internal Regulations which stipulate the conditions for giving this European Standard the status of a national standard without any alteration. Up-to-date lists and bibliographical references concerning such national standards may be obtained on application to the CEN-CENELEC Management Centre or to any CEN member.

This European Standard exists in three official versions (English, French, German). A version in any other language made by translation under the responsibility of a CEN member into its own language and notified to the CEN-CENELEC Management Centre has the same status as the official versions.

CEN members are the national standards bodies of Austria, Belgium, Bulgaria, Croatia, Cyprus, Czech Republic, Denmark, Estonia, Finland, Former Yugoslav Republic of Macedonia, France, Germany, Greece, Hungary, Iceland, Ireland, Italy, Latvia, Lithuania, Luxembourg, Malta, Netherlands, Norway, Poland, Portugal, Romania, Slovakia, Slovenia, Spain, Sweden, Switzerland, Turkey and United Kingdom.



EUROPEAN COMMITTEE FOR STANDARDIZATION
COMITÉ EUROPÉEN DE NORMALISATION
EUROPÄISCHES KOMITEE FÜR NORMUNG

CEN-CENELEC Management Centre: Avenue Marnix 17, B-1000 Brussels

European foreword

This document (EN ISO 10675-1:2016) has been prepared by Technical Committee ISO/TC 44 “Welding and allied processes” in collaboration with Technical Committee CEN/TC 121 “Welding and allied processes” the secretariat of which is held by DIN.

This European Standard shall be given the status of a national standard, either by publication of an identical text or by endorsement, at the latest by June 2017, and conflicting national standards shall be withdrawn at the latest by June 2017.

Attention is drawn to the possibility that some of the elements of this document may be the subject of patent rights. CEN [and/or CENELEC] shall not be held responsible for identifying any or all such patent rights.

This document supersedes EN ISO 10675-1:2013.

According to the CEN-CENELEC Internal Regulations, the national standards organizations of the following countries are bound to implement this European Standard: Austria, Belgium, Bulgaria, Croatia, Cyprus, Czech Republic, Denmark, Estonia, Finland, Former Yugoslav Republic of Macedonia, France, Germany, Greece, Hungary, Iceland, Ireland, Italy, Latvia, Lithuania, Luxembourg, Malta, Netherlands, Norway, Poland, Portugal, Romania, Slovakia, Slovenia, Spain, Sweden, Switzerland, Turkey and the United Kingdom.

Endorsement notice

The text of ISO 10675-1:2016 has been approved by CEN as EN ISO 10675-1:2016 without any modification.

Contents

	Page
Foreword	iv
1 Scope	1
2 Normative references	1
3 Terms and definitions	1
4 Radiographic technique	2
5 Acceptance levels	2
Annex A (informative) Guide to the limitations of radiographic testing	5
Annex B (informative) Examples for determination of area percentage (%) of imperfections	6
Annex C (informative) Calculation of the sum of acceptable areas	8
Bibliography	10

Foreword

ISO (the International Organization for Standardization) is a worldwide federation of national standards bodies (ISO member bodies). The work of preparing International Standards is normally carried out through ISO technical committees. Each member body interested in a subject for which a technical committee has been established has the right to be represented on that committee. International organizations, governmental and non-governmental, in liaison with ISO, also take part in the work. ISO collaborates closely with the International Electrotechnical Commission (IEC) on all matters of electrotechnical standardization.

The procedures used to develop this document and those intended for its further maintenance are described in the ISO/IEC Directives, Part 1. In particular the different approval criteria needed for the different types of ISO documents should be noted. This document was drafted in accordance with the editorial rules of the ISO/IEC Directives, Part 2 (see www.iso.org/directives).

Attention is drawn to the possibility that some of the elements of this document may be the subject of patent rights. ISO shall not be held responsible for identifying any or all such patent rights. Details of any patent rights identified during the development of the document will be in the Introduction and/or on the ISO list of patent declarations received (see www.iso.org/patents).

Any trade name used in this document is information given for the convenience of users and does not constitute an endorsement.

For an explanation on the meaning of ISO specific terms and expressions related to conformity assessment, as well as information about ISO's adherence to the World Trade Organization (WTO) principles in the Technical Barriers to Trade (TBT) see the following URL: www.iso.org/iso/foreword.html.

The committee responsible for this document is ISO/TC 44, *Welding and allied processes*, Subcommittee SC 5, *Testing and inspection of welds*.

This second edition cancels and replaces the first edition (ISO 10675-1:2008), which has been technically revised.

Requests for official interpretations of any aspect of this document should be directed to the Secretariat of ISO/TC 44/SC 5 via your national standards body. A complete listing of these bodies can be found at www.iso.org.

A list of all parts in the ISO 10675 series can be found on the ISO website.

Non-destructive testing of welds — Acceptance levels for radiographic testing —

Part 1: Steel, nickel, titanium and their alloys

1 Scope

This document specifies acceptance levels for indications from imperfections in butt welds of steel, nickel, titanium and their alloys detected by radiographic testing. If agreed, the acceptance levels can be applied to other types of welds or materials.

The acceptance levels can be related to welding standards, application standards, specifications or codes. This document assumes that the radiographic testing has been carried out in accordance with ISO 17636-1 and ISO 17636-2.

When assessing whether a weld meets the requirements specified for a weld quality level, the sizes of imperfections permitted by standards are compared with the dimensions of indications revealed by a radiograph made of the weld.

2 Normative references

The following documents are referred to in the text in such a way that some or all of their content constitutes requirements of this document. For dated references, only the edition cited applies. For undated references, the latest edition of the referenced document (including any amendments) applies.

ISO 5817, *Welding — Fusion-welded joints in steel, nickel, titanium and their alloys (beam welding excluded) — Quality levels for imperfections*

ISO 6520-1, *Welding and allied processes — Classification of geometric imperfections in metallic materials — Part 1: Fusion welding*

ISO 17636-1, *Non-destructive testing of welds — Radiographic testing — Part 1: X- and gamma-ray techniques with film*

ISO 17636-2, *Non-destructive testing of welds — Radiographic testing — Part 2: X- and gamma-ray techniques with digital detectors*

ISO 17637, *Non-destructive testing of welds — Visual testing of fusion-welded joints*

3 Terms and definitions

No terms and definitions are listed in this document.

ISO and IEC maintain terminological databases for use in standardization at the following addresses:

- IEC Electropedia: available at <http://www.electropedia.org/>
- ISO Online browsing platform: available at <http://www.iso.org/obp>

4 Radiographic technique

Welded joints shall be visually tested and evaluated in accordance with ISO 17637 before radiographic testing.

Depending on the weld quality level, radiographic technique A or B in accordance with ISO 17636-1 or ISO 17636-2 shall be used, as shown in [Table 1](#).

Table 1 — Radiographic testing

Quality levels in accordance with ISO 5817	Testing techniques and classes in accordance with ISO 17636-1 and ISO 17636-2	Acceptance levels in accordance with this document
B	B	1
C	B ^a	2
D	A	3

^a However, the minimum number of exposure for circumferential weld testing may correspond to the requirements of class A of ISO 17636-1 or ISO 17636-2.

When quantification of undercut and/or excessive penetration by radiographic testing is required, specific procedures using test exposures may be applied in order to establish a basis for approximate quantification in accordance with the requirements of ISO 5817. This shall be specified in the adopted specification/procedure.

5 Acceptance levels

The acceptance levels of this document are basically valid for evaluation of imperfections which cannot be detected and evaluated by visual testing. Surface imperfections (such as undercut and excessive penetration, surface damage, weld spatter, etc.) which, due to object geometry, cannot be evaluated, but where the interpreter suspects the ISO 5817 quality levels are not fulfilled, shall be subject to more specific testing.

The acceptance levels for indications are shown in [Table 2](#) and [Table 3](#). The types of imperfections are selected from ISO 5817 and defined in ISO 6520-1.

The symbols used in [Table 2](#) and [Table 3](#) are the following:

- l length of indication, in millimetres;
- s nominal butt weld thickness, in millimetres;
- t base material thickness, in millimetres;
- L any 100 mm testing length;
- w_p width of the weld, in millimetres;
- h width of indication, the width or height of surface imperfection, in millimetres;
- d diameter of pore, in millimetres;
- d_A diameter of pore envelope area;

- b width of excess penetration of weld, in millimetres;
- A sum of projected areas of indications related to each $L \times w_p$, in % (see [Annex B](#));
- Σl summary length of imperfections within L , in millimetres (indications shall not be divided into different ranges L).

Table 2 — Acceptance levels for internal indications in butt welds

No.	Type of internal imperfections in accordance with ISO 6520-1	Acceptance level 3 ^a	Acceptance level 2 ^a	Acceptance level 1
1	Cracks (100)	Not permitted	Not permitted	Not permitted
2a	Porosity and gas pores (2012, 2011) Single layer	$A \leq 2,5 \%$ $d \leq 0,4s$, max. 5 mm $L = 100$ mm	$A \leq 1,5 \%$ $d \leq 0,3s$, max. 4 mm $L = 100$ mm	$A \leq 1 \%$ $d \leq 0,2s$, max. 3 mm $L = 100$ mm
2b	Porosity and gas pores (2012, 2011) Multilayer	$A \leq 5 \%$ $d \leq 0,4s$, max. 5 mm $L = 100$ mm	$A \leq 3 \%$ $d \leq 0,3s$, max. 4 mm $L = 100$ mm	$A \leq 2 \%$ $d \leq 0,2s$, max. 3 mm $L = 100$ mm
3b	Clustered (localized) porosity (2013)	$d_A \leq w_p$, max. 25 mm $L = 100$ mm	$d_A \leq w_p$, max. 20 mm $L = 100$ mm	$d_A \leq w_p/2$, max. 15 mm $L = 100$ mm
4	Linear porosity (2014)	$l \leq s$, max. 75 mm $d \leq 0,4s$, max. 4 mm $L = 100$ mm	$l \leq s$, max. 50 mm $d \leq 0,3s$, max. 3 mm $L = 100$ mm	$l \leq s$, max. 25 mm $d \leq 0,2s$, max. 2 mm $L = 100$ mm
5 ^d	Elongated cavities (2015) and wormholes (2016)	$h < 0,4s$, max. 4 mm $\Sigma l \leq s$, max. 75 mm $L = 100$ mm	$h < 0,3s$, max. 3 mm $\Sigma l \leq s$, max. 50 mm $L = 100$ mm	$h < 0,2s$, max. 2 mm $\Sigma l \leq s$, max. 25 mm $L = 100$ mm
6 ^e	Shrinkage cavity (202) (other than crater pipes)	$h < 0,4s$, max. 4 mm $l \leq 25$ mm	Not permitted	Not permitted
7	Crater pipe (2024)	$h \leq 0,2t$, max. 2 mm $l \leq 0,2t$, max. 2 mm	Not permitted	Not permitted
8 ^d	Slag inclusions (301), flux inclusions (302) and oxide inclusions (303)	$h < 0,4s$, max. 4 mm $\Sigma l \leq s$, max. 75 mm $L = 100$ mm	$h < 0,3s$, max. 3 mm $\Sigma l \leq s$, max. 50 mm $L = 100$ mm	$h < 0,2s$, max. 2 mm $\Sigma l \leq s$, max. 25 mm $L = 100$ mm
9	Metallic inclusions (304) (other than copper)	$l \leq 0,4s$, max. 4 mm	$l \leq 0,3s$, max. 3 mm	$l \leq 0,2s$, max. 2 mm
10	Copper inclusions (3042)	Not permitted	Not permitted	Not permitted
11 ^e	Lack of fusion (401)	Permitted, but only intermittently and not breaking the surface $\Sigma l \leq 25$ mm, $L = 100$ mm	Not permitted	Not permitted
12 ^e	Lack of penetration (402)	$\Sigma l \leq 25$ mm, $L = 100$ mm	Not permitted	Not permitted

^a Acceptance levels 3 and 2 may be specified with suffix X, which denotes that all indications over 25 mm are unacceptable.

^b See [Figure C.1](#) and [Figure C.2](#) (normative).

^c See [Figure C.3](#) and [Figure C.4](#) (normative).

^d See [Figure C.5](#) and [Figure C.6](#) (normative).

^e If the length of the weld is below 100 mm, then the maximum length of indications shall not exceed 25 % of that weld.

Table 3 — Surface imperfections

No.	Type of surface imperfections in accordance with ISO 6520-1	Acceptance level 3 ^a	Acceptance level 2 ^a	Acceptance level 1
13	Crater cracks (104)	Not permitted	Not permitted	Not permitted
14a	Undercut, continues and intermittent (5011,5012) $t > 3$ mm	Smooth transition is required $h \leq 0,2t$, max. 1 mm	Smooth transition is required $h \leq 0,1t$, max. 0,5 mm	Smooth transition is required $h \leq 0,05t$, max. 0,5 mm
14b	Undercut, continues and intermittent (5011,5012) $0,5$ mm $\leq t \leq 3$ mm	Smooth transition is required $l \leq 25$ mm, $h \leq 0,2t$	Smooth transition is required $l \leq 25$ mm, $h \leq 0,1t$	Smooth transition is required Not permitted
15a	Shrinkage groove (root undercut 5013) $t > 3$ mm	Smooth transition is required $l \leq 25$ mm, $h \leq 0,2t$, max. 2 mm	Smooth transition is required $l \leq 25$ mm, $h \leq 0,1t$, max. 1 mm	Smooth transition is required $l \leq 25$ mm, $h \leq 0,05t$, max. 0,5 mm
15b	Shrinkage groove (root undercut 5013) $0,5$ mm $\leq t \leq 3$ mm	Smooth transition is required $h \leq 0,2$ mm + $0,1t$	Smooth transition is required $l \leq 25$ mm, $h \leq 0,1t$	Smooth transition required Not permitted
16a	Excess penetration (504) $0,5$ mm $\leq t \leq 3$ mm	$h \leq 1$ mm + $0,6b$	$h \leq 1$ mm + $0,3b$	$h \leq 1$ mm + $0,1b$
16b	Excess penetration (504) $t > 3$ mm	$h \leq 1$ mm + $1,0b$, max. 5 mm	$h \leq 1$ mm + $0,6b$, max. 4 mm	$h \leq 1$ mm + $0,2b$, max. 3 mm
17	Stray arc (601)	Permitted, if the properties of the parent metal are not affected.	Not permitted	Not permitted
18	Spatter (602)	Acceptance depends on application, e.g. material, corrosion protection.		
19a	Root concavity (515) $0,5$ mm $\leq s \leq 3$ mm	$h \leq 0,2$ mm + $0,1t$	$l \leq 25$ mm, $h \leq 0,1t$	Not permitted
19b	Root concavity (515) $s > 3$ mm	$l \leq 25$ mm, $h \leq 0,2t$, max. 2 mm	$l \leq 25$ mm, $h \leq 0,1t$, max. 1 mm	$l \leq 25$ mm, $h \leq 0,05t$, max. 0,5 mm
20	Poor restart (517) $s \geq 0,5$ mm	Permitted, The limit depends on the type of imperfection (see ISO 5817).	Not permitted	Not permitted
21a	Sagging (509) Incompletely filled groove (511) $0,5$ mm $\leq s \leq 3$ mm	$l \leq 25$ mm, $h \leq 0,25t$	$l \leq 25$ mm, $h \leq 0,1t$	Not permitted
21b	Sagging (509) Incompletely filled groove (511) $s > 3$ mm	$L \leq 25$ mm, $h \leq 0,25t$, max. 2 mm	$l \leq 25$ mm, $h \leq 0,1t$, max. 1 mm	$l \leq 25$ mm, $h \leq 0,05t$, max. 0,5 mm
22a	Linear misalignment (507) $0,5$ mm $\leq s \leq 3$ mm	$h \leq 0,2$ mm + $0,25t$	$h \leq 0,2$ mm + $0,15t$	$h \leq 0,2$ mm + $0,1t$
22b	Linear misalignment, longitudinal welds (507) $s > 3$ mm	$h \leq 0,25t$, max. 5 mm	$h \leq 0,15t$, max. 4 mm	$h \leq 0,1t$, max. 3 mm
22c	Linear misalignment, circumferential welds (507) $s \geq 0,5$ mm	$h \leq 0,5 t$, max. 4 mm	$h \leq 0,5 t$, max. 3 mm	$h \leq 0,5 t$, max. 2 mm

NOTE The acceptance levels are those defined for visual testing. These defects are normally evaluated by visual testing.

^a Acceptance levels 3 and 2 may be specified with suffix X, which denotes that all indications over 25 mm are unacceptable.

Annex A (informative)

Guide to the limitations of radiographic testing

A.1 General

NOTE The numbers between brackets conform to those used in ISO 6520-1.

A.2 Volumetric imperfections in butt welds

- Porosities and gas pores (2011, 2013, 2015 and 2017)
- Wormholes and elongated cavities (2016 and 2015)
- Solid inclusions (300)
- Copper inclusions (3042)

The above imperfections listed in [Table 2](#) will be readily detected using radiographic technique A or B of ISO 17636-1 or ISO 17636-2 as shown in [Table 1](#).

A.3 Cracks in butt welds

- Crater cracks (104)
- Cracks (100)

The detectability of cracks by radiographic testing depends on the crack height, the ramification (presence of branching parts), opening width, direction of the X-ray beam to crack orientation and radiographic technique parameters.

Reliable detection of all cracks is therefore limited. The use of radiographic technique B or better, as specified in ISO 17636-1 or ISO 17636-2, will provide better crack detectability than radiographic technique A.

A.4 Planar imperfections in butt welds

- Lack of fusion (401)
- Lack of penetration (402)

The detection of lack of fusion and lack of penetration depends on characteristics of imperfections and radiographic technique parameters.

Lack of side-wall fusion will probably not be detected (except it is associated with other imperfections such as slag inclusions), unless it is radiographed in the direction of the side-wall.

Annex B (informative)

Examples for determination of area percentage (%) of imperfections

[Figure B.1](#) to [Figure B.9](#) give a presentation of different area percentage (%) of imperfections. This should assist the assessment of imperfections on radiographs and fracture surfaces.

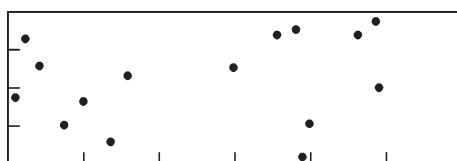

Figure B.1 — $A = 1 \%$

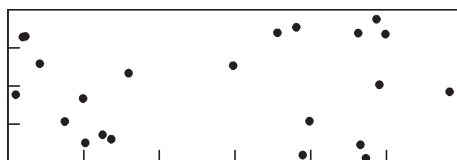

Figure B.2 — $A = 1,5 \%$

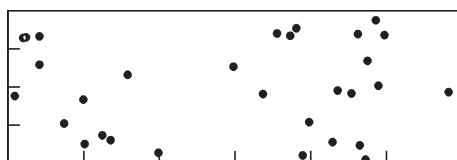

Figure B.3 — $A = 2 \%$

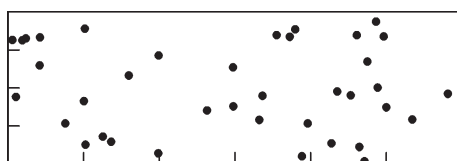

Figure B.4 — $A = 2,5 \%$

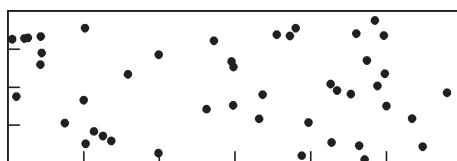

Figure B.5 — $A = 3 \%$



Figure B.6 — $A = 4\%$



Figure B.7 — $A = 5\%$

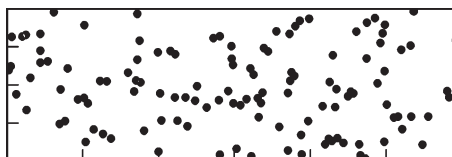

Figure B.8 — $A = 8\%$

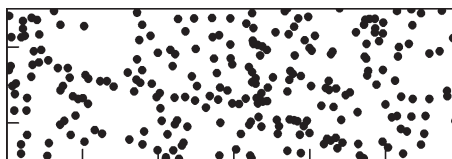

Figure B.9 — $A = 16\%$

Annex C (informative)

Calculation of the sum of acceptable areas

C.1 Clustered porosity

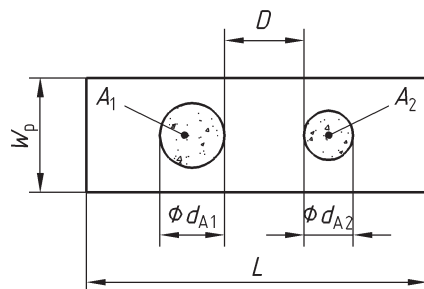

Figure C.1 — Clustered porosity, $D > d_{A2}$

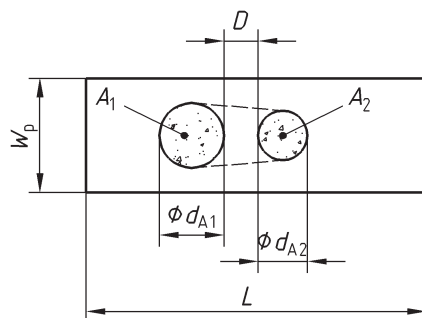

Figure C.2 — Clustered porosity, $D < d_{A2}$

The sum of the different pore envelop areas ($A_1 + A_2 \dots$) related to the evaluation area, $L \times w_p$ (see [Figure C.1](#)), shall be calculated.

If D is less than d_{A1} or d_{A2} , whatever is smaller, an envelope surrounding the porosity areas, $A_1 + A_2$, shall be considered as one area of imperfection (see [Figure C.2](#)).

C.2 Linear porosity

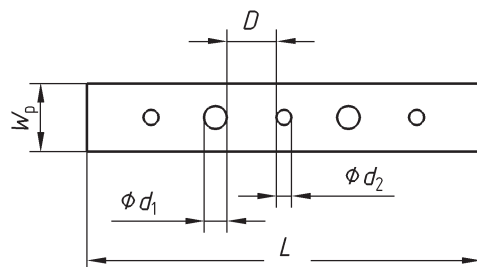

Figure C.3 — Linear porosity, $D > d_2$

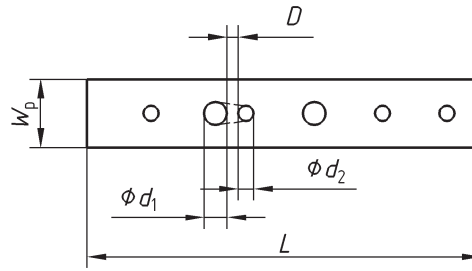

Figure C.4 — Linear porosity, $D < d_2$

The sum of the different pore areas related to the evaluation area, $L \times w_p$ (see [Figure C.3](#)), shall be calculated.

If D is smaller than the smaller diameter of one of the neighbouring pores, the full connected area of the two pores shall be taken into the sum of imperfections (see [Figure C.4](#)).

C.3 Elongated cavities and wormholes

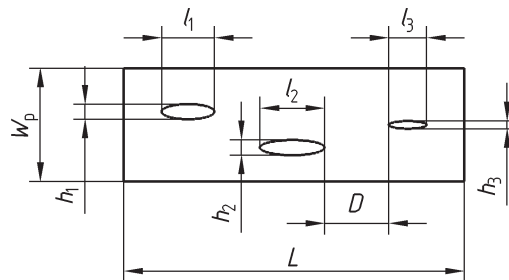

Figure C.5 — Elongated cavities and wormholes, $D > l_3$

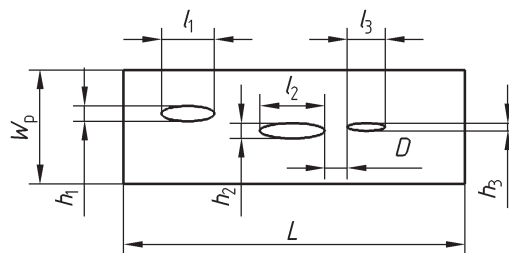

Figure C.6 — Elongated cavities and wormholes, $D < l_3$

The sum of the length of indications, Σl , shall be determined for each testing length, L (see [Figure C.5](#)).

If D is smaller than the shorter length of one of the neighbouring imperfections, the full connection of the two imperfections is to be taken into the sum of imperfections (see [Figure C.6](#)).

Bibliography

- [1] ISO 17635, *Non-destructive testing of welds — General rules for fusion welds in metallic materials*
- [2] IIW. *Reference radiographs for assessment of weld imperfections according to ISO 5817* [English/French/German]. DVS, Düsseldorf

British Standards Institution (BSI)

BSI is the national body responsible for preparing British Standards and other standards-related publications, information and services.

BSI is incorporated by Royal Charter. British Standards and other standardization products are published by BSI Standards Limited.

About us

We bring together business, industry, government, consumers, innovators and others to shape their combined experience and expertise into standards-based solutions.

The knowledge embodied in our standards has been carefully assembled in a dependable format and refined through our open consultation process. Organizations of all sizes and across all sectors choose standards to help them achieve their goals.

Information on standards

We can provide you with the knowledge that your organization needs to succeed. Find out more about British Standards by visiting our website at bsigroup.com/standards or contacting our Customer Services team or Knowledge Centre.

Buying standards

You can buy and download PDF versions of BSI publications, including British and adopted European and international standards, through our website at bsigroup.com/shop, where hard copies can also be purchased.

If you need international and foreign standards from other Standards Development Organizations, hard copies can be ordered from our Customer Services team.

Copyright in BSI publications

All the content in BSI publications, including British Standards, is the property of and copyrighted by BSI or some person or entity that owns copyright in the information used (such as the international standardization bodies) and has formally licensed such information to BSI for commercial publication and use.

Save for the provisions below, you may not transfer, share or disseminate any portion of the standard to any other person. You may not adapt, distribute, commercially exploit, or publicly display the standard or any portion thereof in any manner whatsoever without BSI's prior written consent.

Storing and using standards

Standards purchased in soft copy format:

- A British Standard purchased in soft copy format is licensed to a sole named user for personal or internal company use only.
- The standard may be stored on more than 1 device provided that it is accessible by the sole named user only and that only 1 copy is accessed at any one time.
- A single paper copy may be printed for personal or internal company use only.

Standards purchased in hard copy format:

- A British Standard purchased in hard copy format is for personal or internal company use only.
- It may not be further reproduced – in any format – to create an additional copy. This includes scanning of the document.

If you need more than 1 copy of the document, or if you wish to share the document on an internal network, you can save money by choosing a subscription product (see 'Subscriptions').

Reproducing extracts

For permission to reproduce content from BSI publications contact the BSI Copyright & Licensing team.

Subscriptions

Our range of subscription services are designed to make using standards easier for you. For further information on our subscription products go to bsigroup.com/subscriptions.

With **British Standards Online (BSOL)** you'll have instant access to over 55,000 British and adopted European and international standards from your desktop. It's available 24/7 and is refreshed daily so you'll always be up to date.

You can keep in touch with standards developments and receive substantial discounts on the purchase price of standards, both in single copy and subscription format, by becoming a **BSI Subscribing Member**.

PLUS is an updating service exclusive to BSI Subscribing Members. You will automatically receive the latest hard copy of your standards when they're revised or replaced.

To find out more about becoming a BSI Subscribing Member and the benefits of membership, please visit bsigroup.com/shop.

With a **Multi-User Network Licence (MUNL)** you are able to host standards publications on your intranet. Licences can cover as few or as many users as you wish. With updates supplied as soon as they're available, you can be sure your documentation is current. For further information, email subscriptions@bsigroup.com.

Revisions

Our British Standards and other publications are updated by amendment or revision.

We continually improve the quality of our products and services to benefit your business. If you find an inaccuracy or ambiguity within a British Standard or other BSI publication please inform the Knowledge Centre.

Useful Contacts

Customer Services

Tel: +44 345 086 9001

Email (orders): orders@bsigroup.com

Email (enquiries): cservices@bsigroup.com

Subscriptions

Tel: +44 345 086 9001

Email: subscriptions@bsigroup.com

Knowledge Centre

Tel: +44 20 8996 7004

Email: knowledgecentre@bsigroup.com

Copyright & Licensing

Tel: +44 20 8996 7070

Email: copyright@bsigroup.com

BSI Group Headquarters

389 Chiswick High Road London W4 4AL UK