

Technical drawings — Representation of splines and serrations

The European Standard EN ISO 6413 : 1994 has the status of a
British Standard

Committees responsible for this British Standard

The preparation of this British Standard was entrusted to Technical Committee TDE/4, Engineering drawing practice, upon which the following bodies were represented:

Atomic Weapons Establishment
British Gas plc
British Standards Society
Drawing Office Material Manufacturers' and Dealers' Association
Electricity Association
Gauge and Tool Makers' Association
HEVAC Association
Institution of Chemical Engineers
Institution of Engineering Designers
Power Generation Contractors' Association
Society of British Aerospace Companies Ltd.
University of Warwick

This British Standard, having been prepared under the direction of the Engineering Sector Board, was published under the authority of the Standards Board and comes into effect on
15 September 1995

© BSI 1995

Amendments issued since publication

Amd. No.	Date	Text affected

The following BSI references relate to the work on this standard:
Committee reference TDE/4
Draft announced in *BSI News*
August 1995

ISBN 0 580 23774 5

Contents

	Page
Committees responsible	Inside front cover
National foreword	ii
<hr/>	
Foreword	2
Specification	
1 Scope	3
2 Normative references	3
3 Definitions	3
4 Designation	3
5 Complete representation of spline joints	4
6 Simplified representation	4
7 Assembly drawings	6
<hr/>	
Annex	
A (normative) Proportions and dimensions of graphical symbols	7
<hr/>	
Table	
1 Simplified representation	5
A.1 Dimensions	7

National foreword

This British Standard has been prepared by Technical Committee TDE/4 and is the English language version of EN ISO 6413 : 1994 *Technical drawings — Representation of splines and serrations*, published by the European Committee for Standardization (CEN). It is identical with ISO 6413 : 1988, published by the International Organization for Standardization (ISO).

This British Standard partially supersedes BS 308 : Part 1. It is envisaged that when the full range of European Standards on technical drawing is implemented BS 308 will be withdrawn.

Cross-references

Publication referred to	Corresponding British Standard
ISO 14 : 1982	BS 5686 : 1986 <i>Specification for straight-sided splines for cylindrical shafts: metric nominal dimensions, tolerances and gauging requirements</i>
ISO 128 : 1982	BS 308 <i>Engineering drawing practice</i>
ISO 3098-1 : 1974	Part 1 : 1993 <i>Recommendations for general principles</i>
ISO 4156 : 1981	Part 1 : 1993 <i>Recommendations for general principles</i>
	BS 6186 <i>Specification for straight cylindrical involute splines: metric module side fit</i>
	Part 1 : 1981 <i>Dimensions and tolerances</i>

Compliance with a British Standard does not of itself confer immunity from legal obligations.

ICS 01.100.20; 21.120.30

Descriptors: Drawings, technical drawings, splines, graphic methods

English version

Technical drawings — Representation of splines and serrations

(ISO 6413 : 1988)

Dessins techniques — Représentation des
cannelures et des dentelures
(ISO 6413 : 1988)

Technische Zeichnungen — Darstellung von
Keilwellen und Kerbverzahnungen
(ISO 6413 : 1988)

This European Standard was approved by CEN on 1994-10-14. CEN members are bound to comply with the CEN/CENELEC Internal Regulations which stipulate the conditions for giving this European Standard the status of a national standard without any alteration.

Up-to-date lists and bibliographical references concerning such national standards may be obtained on application to the Central Secretariat or to any CEN member.

This European Standard exists in three official versions (English, French, German). A version in any other language made by translation under the responsibility of a CEN member into its own language and notified to the Central Secretariat has the same status as the official versions.

CEN members are the national standards bodies of Austria, Belgium, Denmark, Finland, France, Germany, Greece, Iceland, Ireland, Italy, Luxembourg, Netherlands, Norway, Portugal, Spain, Sweden, Switzerland and United Kingdom.

CEN

European Committee for Standardization
Comité Européen de Normalisation
Europäisches Komitee für Normung

Central Secretariat: rue de Stassart 36, B-1050 Brussels

Foreword

This European Standard was taken over by CEN from the work of ISO/TC 10, Technical drawings, product definition and related documentation, of the International Standards Organization (ISO).

The Technical Board had decided to submit the final draft for Formal Vote. The result was positive.

This European Standard shall be given the status of a national standard, either by publication of an identical text or by endorsement, at the latest by April 1995, and conflicting national standards shall be withdrawn at the latest by April 1995.

According to the CEN/CENELEC Internal Regulations, the following countries are bound to implement this European Standard: Austria, Belgium, Denmark, Finland, France, Germany, Greece, Iceland, Ireland, Italy, Luxembourg, Netherlands, Norway, Portugal, Spain, Sweden, Switzerland, United Kingdom.

Technical drawings — Representation of splines and serrations

1 Scope

This International Standard specifies the rules and graphical symbols for the representations of splines and serrations on technical drawings.

Two methods of representation are specified as follows :

- a) true representation;
- b) simplified representation.

The rules and graphical symbols specified in this International Standard are applicable to detail drawings of the parts (shafts and hubs) and to assembly drawings of joints.

NOTE — For uniformity all figures in this International Standard are drawn in the first-angle orthographic projection.

It should be understood that the third-angle orthographic projection could equally well have been used without prejudice to the principles established.

2 Normative references

The following standards contain provisions which, through reference in this text, constitute provisions of this International Standard. At the time of publication, the editions indicated were valid. All standards are subject to revision, and parties to agreements based on this International Standard are encouraged to investigate the possibility of applying the most recent editions of the standards listed below. Members of IEC and ISO maintain registers of currently valid International Standards.

ISO 14 : 1982, *Straight-sided splines for cylindrical shafts with internal centering — Dimensions, tolerances and verification.*

ISO 128 : 1982, *Technical drawings — General principles of presentation.*

ISO 3098-1 : 1974, *Technical drawings — Lettering — Part 1 : Currently used characters.*

ISO 3461-2 : 1987, *General principles for the creation of graphical symbols — Part 2 : Graphical symbols for use in technical product documentation.*

ISO 4156 : 1981, *Straight cylindrical involute splines — Metric module, side fit — Generalities, dimensions and inspection.*

3 Definitions

For the purposes of this International Standard, the following definitions apply.

3.1 spline joint : Connecting, co-axial, elements that transmit torque through the simultaneous engagement of equally spaced teeth situated around the periphery of a cylindrical external member with similar spaced mating spaces situated around the inner surface of the related cylindrical internal member. [ISO 4156 : 1981]

3.2 involute spline : One member of a spline joint having teeth or spaces that have involute flank profiles. [ISO 4156 : 1981]

3.3 straight-sided spline : One member of a spline joint having teeth or spaces that have straight-sided flank profiles.

3.4 serration : One member of a spline joint having teeth or spaces that generally have flank profiles of 60° pressure angle.

4 Designation

The designation of spline joints shall consist of the graphical symbol of the type and the designation of joint specified in the relevant International Standard (see clause 2) or any other standard dealing with this subject.

4.1 Graphical symbols

The type of spline joint is indicated by graphical symbols.

The graphical symbols for the straight-sided spline (see ISO 14) are shown in figure 1 and for the involute spline (see ISO 4156) and for serrations are shown in figure 2.



Figure 1



Figure 2

The proportion and dimensions of the graphical symbols are specified in annex A.

4.2 Method for indicating designation

The designation should be indicated near the feature but always connected to the contour of the spline joint by a leader line (see figure 3).

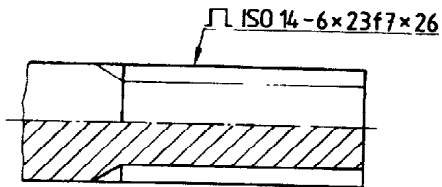

Figure 3

Where a spline joint is not in accordance with a standard as mentioned above, or where the requirement is modified, the necessary data shall be tabulated on the drawing or any other associated document and shall be cross-referenced by a leader line and graphical symbol to the applicable contour.

5 Complete representation of spline joints

A complete representation of spline joints showing all details with their true dimensions is generally not necessary in a technical drawing and should be avoided.

If such a representation has to be made, the drawing rules laid down in ISO 128 shall be applied.

If necessary, a designation of the spline joint in accordance with clause 4 may be added.

Figure 4 shows an example of a complete representation of a straight-sided spline joint.

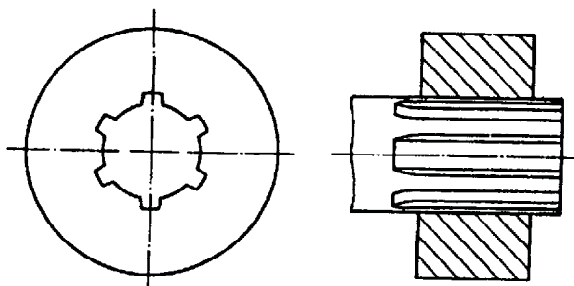

Figure 4

Figure 5 shows an example of a complete representation of an involute spline joint.

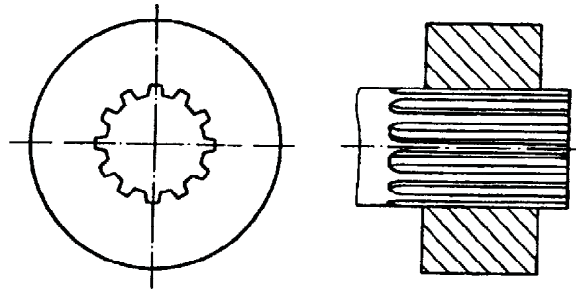

Figure 5

Figure 6 shows an example of a complete representation of a serration.

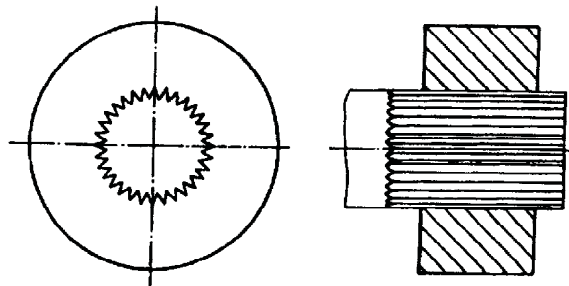

Figure 6

6 Simplified representation

6.1 General

A simplified representation for straight-sided splines and for involute splines as shown in table 1 is usually adequate to convey all the necessary information.

Table 1 – Simplified representation

	Straight-sided splines	Involute splines and serrations
Shaft		
Hub		
Spline joint		

1) If necessary, the designation of the spline joint in accordance with clause 4 shall be added (for examples, see figures 13 and 14).

6.2 Representation of details (shafts and hubs)

As a fundamental principle, the parts of a spline joint shall be represented as a solid part without teeth, but with the addition of the root surface in a continuous thin line (see ISO 128, line type B) or the pitch surface in a thin chain line (see ISO 128, line type G).

6.2.1 Contours and edges

The contours and edges of a shaft (e.g. an external spline) or a hub (e.g. an internal spline) shall be drawn as if they were

- in an unsectioned view, solid parts (without teeth) bounded by a cylinder representing the tip surface (outside

diameter, for example, of an external spline or inside diameter, for example, of an internal spline);

- in an axial section, a shaft or hub having two diametrically opposed teeth (shown unsectioned), regardless of tooth spacing.

6.2.2 Root surface

For straight-sided splines, the root surface (minor diameter of external splined part, major diameter of internal spline) shall be drawn with a continuous thin line (see ISO 128, line type B).

In the axial section of a splined shaft or hub, however, the root surface shall be drawn with a continuous thick line (see ISO 128, line type A) in accordance with table 1.

6.2.3 Pitch surface

The pitch surface (pitch diameter) shall be drawn with a thin chain line (see ISO 128, line type G) for involute splines and serrations.

6.2.4 Usable length

The usable length of the splined part shall be represented with a continuous thick line (see ISO 128, line type A) (see figure 7).

Usually, only the usable length of a splined part shall be drawn.

6.2.5 Tool run-out

If necessary, the tool run-out may be represented by an oblique line or a radius with the same line as used for the root surface (see figures 7 and 8).

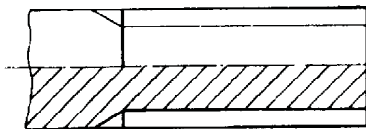

Figure 7



Figure 8

6.2.6 Position of teeth

If it is essential to indicate the position of the teeth in relation to a given axial plane, one or two teeth may be drawn with a continuous thick line (see ISO 128, line type A) (see figure 9).

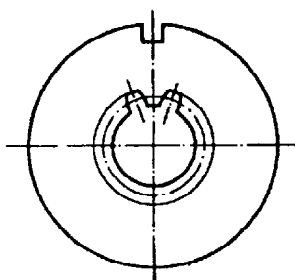

Figure 9

6.2.7 Detailed drawing of tooth profile

If the designation is not sufficiently clear, a detailed drawing of the tooth profile should be added (see figure 10).

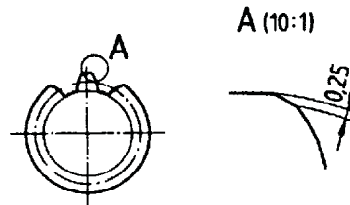

Figure 10

6.2.8 Surface texture

If it is necessary to specify the surface texture of the contacting surfaces (excluding root and tip diameter), the graphical symbol, the designation and the drawing indications used for surface texture should be indicated on a common leader line as shown in figure 11.

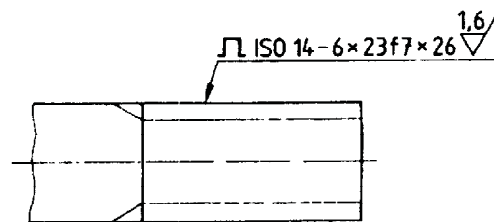

Figure 11

7 Assembly drawings

The rules specified for the representation of details are also applicable to assembly drawings (see figure 12).

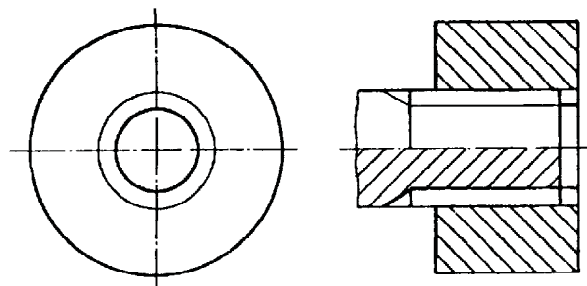

Figure 12

In assembly drawings, the designations of both parts (hub and shaft) shall be combined as shown in figures 13 and 14.

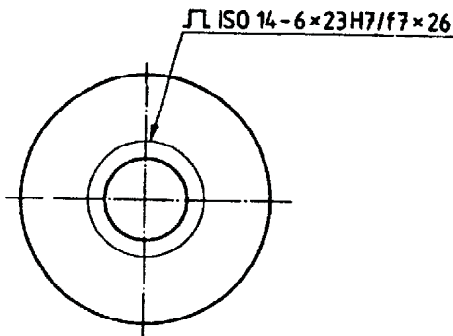

Figure 13

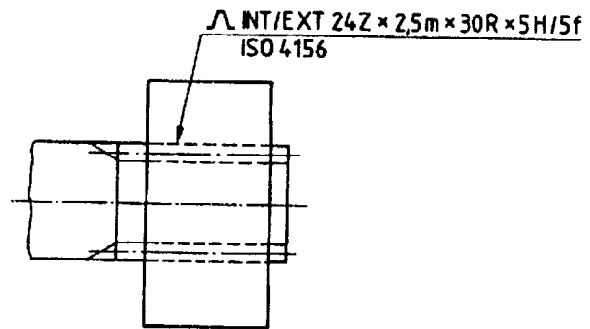

Figure 14

Annex A (normative)

Proportions and dimensions of graphical symbols

In order to harmonize the sizes of the graphical symbols specified in this International Standard with those of the other drawing indications, the following rules, in accordance with ISO 3461-2, shall be applied.

A.1 General requirements

A.1.1 The graphical symbols shown in clause 4 shall be indicated using a line thickness d' equal to one-tenth of the height h of the lettering used for the dimensions in the relevant drawing.

A.1.2 The numerals and letters used for the additional specifications shall be drawn using the same line thickness d , height h and type of lettering as used for dimensions in the relevant drawing, and in accordance with ISO 3098-1 (lettering type B, vertical).

A.2 Proportions

The graphical symbols shall be drawn in accordance with figures A.1 and A.2.



Figure A.1



Figure A.2

A.3 Dimensions

The range of sizes to be used for the graphical symbols and additional specifications are given in table A.1.

Table A.1 — Dimensions

	Dimensions in millimetres					
Height of numerals and letters, h	3,5	5	7	10	14	20
Line thickness for symbols, d' , and lettering, d	0,35	0,5	0,7	1	1,4	2
Height of symbol, h'	3,5	5	7	10	14	20

List of references

See national foreword.

BSI — British Standards Institution

BSI is the independent national body responsible for preparing British Standards. It presents the UK view on standards in Europe and at the international level. It is incorporated by Royal Charter.

Contract requirements

A British Standard does not purport to include all the necessary provisions of a contract. Users of British Standards are responsible for their correct application.

Revisions

British Standards are updated by amendment or revision. Users of British Standards should make sure that they possess the latest amendments or editions.

Any person who finds an inaccuracy or ambiguity while using this British Standard should bring it to the attention of the Quality Manager, BSI without delay so that the matter may be investigated swiftly.

BSI offers members an individual updating service called PLUS which ensures that subscribers automatically receive the latest editions of standards.

Buying standards

Orders for all BSI, international and foreign standards publications should be addressed to Customer Services, Sales Department at Chiswick: Tel: 0181 996 7000; Fax: 0181 996 7001.

In response to orders for international standards, it is BSI policy to supply the BSI implementation of those that have been published as British Standards, unless otherwise requested.

Information on standards

BSI provides a wide range of information on national, European and international standards through its Library, the Standardline Database, the BSI Information Technology Service (BITS) and its Technical Help to Exporters Service. Contact the Information Department at Chiswick: Tel: 0181 996 7111; Fax: 0181 996 7048.

Subscribing members of BSI are kept up to date with standards developments and receive substantial discounts on the purchase price of standards. For details of these and other benefits contact Customer Services, Membership at Chiswick: Tel: 0181 996 7002; Fax: 0181 996 7001.

Copyright

Copyright subsists in all BSI publications and no part may be reproduced in any form without the prior permission in writing of BSI. This does not preclude the free use, in the course of implementing the standard of necessary details such as symbols and size, type or grade designations including use by incorporation into computer programs, but where these details are reproduced including without limitation in printed form, in computer programs or in any other form whatsoever, the permission in writing of BSI must be obtained and if granted will be on terms including royalty, before the product is sold, licensed or otherwise exploited for commercial gain. Enquiries about copyright should be made to the Copyright Manager at Chiswick.