

Geometrical Product Specifications (GPS) — Surface texture: Profile method; Measurement standards —

Part 1: Material measures

The European Standard EN ISO 5436-1:2000 has the status of a British Standard

ICS 17.040.20

National foreword

This British Standard is the official English language version of EN ISO 5436-1:2000. It is identical with ISO 5436-1:2000.

The UK participation in its preparation was entrusted by Technical Committee TDW/4, Engineering drawing, metrology, precision measurement and all related documentation, to Subcommittee TDW/4/-/3, The properties and metrology of surfaces, which has the responsibility to:

- aid enquirers to understand the text;
- present to the responsible international/European committee any enquiries on the interpretation, or proposals for change, and keep the UK interests informed;
- monitor related international and European developments and promulgate them in the UK.

A list of organizations represented on this Subcommittee can be obtained on request to its secretary.

Cross-references

The British Standards which implement international or European publications referred to in this document may be found in the BSI Standards Catalogue under the section entitled “International Standards Correspondence Index”, or by using the “Find” facility of the BSI Standards Electronic Catalogue.

A British Standard does not purport to include all the necessary provisions of a contract. Users of British Standards are responsible for their correct application.

Compliance with a British Standard does not of itself confer immunity from legal obligations.

Summary of pages

This document comprises a front cover, an inside front cover, the EN ISO title page, the EN ISO foreword page, the ISO title page, pages ii to v, a blank page, pages 1 to 14, the annex ZA page, and a back cover.

The BSI copyright date displayed in this document indicates when the document was last issued.

Amendments issued since publication

Amd. No.	Date	Comments

This British Standard, having been prepared under the direction of the Consumer Products and Services Sector Policy and Strategy Committee, was published under the authority of the Standards Policy and Strategy Committee on 23 August 2001

© BSI 23 August 2001

ISBN 0 580 38404 7

ICS 17.040.30

English version

Geometrical Product Specifications (GPS) - Surface texture:
Profile method; Measurement standards - Part 1: Material
measures (ISO 5436-1:2000)

Spécification géométrique des produits (GPS) - Etat de
surface: Méthode du profil; Etalons - Partie 1: Mesures
matérialisées (ISO 5436-1:2000)

Geometrische Produktspezifikationen (GPS) -
Oberflächenbeschaffenheit: Tastschnittverfahren; Normale
- Teil 1: Maßverkörperungen (ISO 5436-1:2000)

This European Standard was approved by CEN on 10 March 2000.

CEN members are bound to comply with the CEN/CENELEC Internal Regulations which stipulate the conditions for giving this European Standard the status of a national standard without any alteration. Up-to-date lists and bibliographical references concerning such national standards may be obtained on application to the Central Secretariat or to any CEN member.

This European Standard exists in three official versions (English, French, German). A version in any other language made by translation under the responsibility of a CEN member into its own language and notified to the Central Secretariat has the same status as the official versions.

CEN members are the national standards bodies of Austria, Belgium, Czech Republic, Denmark, Finland, France, Germany, Greece, Iceland, Ireland, Italy, Luxembourg, Netherlands, Norway, Portugal, Spain, Sweden, Switzerland and United Kingdom.



EUROPEAN COMMITTEE FOR STANDARDIZATION
COMITÉ EUROPÉEN DE NORMALISATION
EUROPÄISCHES KOMITEE FÜR NORMUNG

Central Secretariat: rue de Stassart, 36 B-1050 Brussels

Foreword

The text of the International Standard from Technical Committee ISO/TC 213 "Dimensional and geometrical product specifications and verification" of the International Organization for Standardization (ISO) has been taken over as an European Standard by Technical Committee CEN/TC 290 "Dimensional and geometrical product specification and verification", the secretariat of which is held by AFNOR.

This European Standard shall be given the status of a national standard, either by publication of an identical text or by endorsement, at the latest by September 2000, and conflicting national standards shall be withdrawn at the latest by September 2000.

According to the CEN/CENELEC Internal Regulations, the national standards organizations of the following countries are bound to implement this European Standard: Austria, Belgium, Czech Republic, Denmark, Finland, France, Germany, Greece, Iceland, Ireland, Italy, Luxembourg, Netherlands, Norway, Portugal, Spain, Sweden, Switzerland and the United Kingdom.

Endorsement notice

The text of the International Standard ISO 5436-1:2000 has been approved by CEN as a European Standard without any modification.

NOTE: Normative references to International Standards are listed in annex ZA (normative).

INTERNATIONAL
STANDARD

ISO
5436-1

First edition
2000-03-15

**Geometrical Product Specifications
(GPS) — Surface texture: Profile method;
Measurement standards —**

Part 1:
Material measures

*Spécification géométrique des produits (GPS) — État de surface: Méthode
du profil; Étalons —*

Partie 1: Mesures matérialisées



Reference number
ISO 5436-1:2000(E)

Contents

Page

1	Scope	1
2	Normative references	1
3	Terms and definitions	1
4	Design requirements	2
4.1	Material	2
4.2	Size of measurement standard.....	2
5	Types, purposes and metrological characteristics of measurement standards	2
5.1	General.....	2
5.2	Type A — Depth measurement standard	2
5.3	Type B — Tip condition measurement standard.....	3
5.4	Type C — Spacing measurement standard	3
5.5	Type D — Roughness measurement standard.....	3
5.6	Type E — Profile coordinate measurement standard.....	4
6	Measurement standard requirements	4
6.1	Type A — Depth measurement standard	4
6.2	Type B — Tip condition measurement standard.....	5
6.3	Type C — Spacing measurement standard	6
6.4	Type D — Roughness measurement standard.....	7
6.5	Type E — Profile coordinate measurement standard.....	8
7	Definition of the measurands for the measurement standards	9
7.1	Type A1	9
7.2	Type A2	10
7.3	Type B2	10
7.4	Type B3	10
7.5	Types C1 to C4, and D.....	11
7.6	Type E1	11
7.7	Type E2	11
8	Measurement standard certificate	12
Annex A (informative) Relation to the GPS matrix model		13
Bibliography		14

Foreword

ISO (the International Organization for Standardization) is a worldwide federation of national standards bodies (ISO member bodies). The work of preparing International Standards is normally carried out through ISO technical committees. Each member body interested in a subject for which a technical committee has been established has the right to be represented on that committee. International organizations, governmental and non-governmental, in liaison with ISO, also take part in the work. ISO collaborates closely with the International Electrotechnical Commission (IEC) on all matters of electrotechnical standardization.

International Standards are drafted in accordance with the rules given in the ISO/IEC Directives, Part 3.

Draft International Standards adopted by the technical committees are circulated to the member bodies for voting. Publication as an International Standard requires approval by at least 75 % of the member bodies casting a vote.

Attention is drawn to the possibility that some of the elements of this part of ISO 5436 may be the subject of patent rights. ISO shall not be held responsible for identifying any or all such patent rights.

International Standard ISO 5436-1 was prepared by Technical Committee ISO/TC 213, *Dimensional and geometrical product specifications and verification*.

This first edition of ISO 5436-1, together with ISO 5436-2, cancels and replaces (ISO 5436:1985), which has been technically revised.

ISO 5436 consists of the following parts, under the general title *Geometrical Product Specifications (GPS)—Surface texture: Profile method; Measurement standards*:

- *Part 1: Material measures*
- *Part 2: Software measurement standards*

Annex A of this part of ISO 5436 is for information only.

Introduction

This part of ISO 5436 is a geometrical product specification (GPS) standard and is to be regarded as a general GPS standard (see ISO/TR 14638). It influences chain link 6 of the chain of standards on roughness, waviness and primary profile.

For more detailed information of the relation of this part of ISO 5436 to the GPS matrix model, see annex A.

This part of ISO 5436 introduces a new measurement standard, namely Type E, to calibrate the profile co-ordinate system.

NOTE "Measurement standards" were formerly referred to as "calibration specimens".

Geometrical Product Specifications (GPS) — Surface texture: Profile method; Measurement standards —

Part 1: Material measures

1 Scope

This part of ISO 5436 specifies the characteristics of material measures used as measurement standards (etalons) for the calibration of metrological characteristics of instruments for the measurement of surface texture by the profile method as defined in ISO 3274.

2 Normative references

The following normative documents contain provisions which, through reference in this text, constitute provisions of this part of ISO 5436. For dated references, subsequent amendments to, or revisions of, any of these publications do not apply. However, parties to agreements based on this part of ISO 5436 are encouraged to investigate the possibility of applying the most recent editions of the normative documents indicated below. For undated references, the latest edition of the normative document referred to applies. Members of ISO and IEC maintain registers of currently valid International Standards.

ISO 3274:1996, *Geometrical Product Specifications (GPS) — Surface texture: Profile method — Nominal characteristics of contact (stylus) instruments.*

ISO 4287:1997, *Geometrical Product Specifications (GPS) — Surface texture: Profile method — Terms, definitions and surface texture parameters.*

ISO 4288:1996, *Geometrical Product Specifications (GPS) — Surface texture: Profile method — Rules and procedures for the assessment of surface texture.*

ISO 10012-1:1992, *Quality assurance requirements for measuring equipment — Part 1: Metrological confirmation system for measuring equipment.*

ISO 12085:1996, *Geometrical Product Specifications (GPS) — Surface texture: Profile method — Motif parameters.*

ISO/TS 14253-2:1999, *Geometrical Product Specifications (GPS) — Inspection by measurement of workpieces and measuring equipment — Part 2: Guide to the estimation of uncertainty in GPS measurement, in calibration of measuring equipment and in product verification.*

BIPM, IEC, IFCC, ISO, IUPAC, IUPAP, OIML. *International vocabulary of basic and general terms used in metrology (VIM)*, 1993.

BIPM, IEC IFCC, ISO, IUPAC, IUPAP, OIML. *Guide to the expression of uncertainty in measurement (GUM)*, 1993.

3 Terms and definitions

For the purposes of this part of ISO 5436, the terms and definitions given in ISO 3274, ISO 4287 and VIM apply.

4 Design requirements

4.1 Material

The material used for measurement standards A to E shall be hard enough to ensure adequate life in relation to cost (manufacturing and calibration). Its surface shall be smooth and flat enough not to affect the evaluation.

4.2 Size of measurement standard

The measurement window shall be large enough to provide for the total length of traverse required for all intended determinations. The measurement window consists of that region of the total surface over which calibration measurements are made. One or more kinds of measurement standards may be provided on a single block. To ensure the best possible economic conditions, overall dimensions of measurement standards are not given.

5 Types, purposes and metrological characteristics of measurement standards

5.1 General

The calibration of the existing wide range of instruments in all modes of operation calls for more than one type of measurement standard. Each measurement standard may have a limited range of application according to its own characteristics and those of the instrument to be calibrated. The validity of the calibration of an instrument will be dependent on the correct association of these characteristics.

To cover the range of requirements, five types of measurement standards are described, each of which may have a number of variants (see Table 1).

Table 1 — Types and names of measurement standards

Type	Name
A	Depth measurement standard
B	Tip condition measurement standard
C	Spacing measurement standard
D	Roughness measurement standard
E	Profile coordinate measurement standard

5.2 Type A — Depth measurement standard

These measurement standards are for calibrating the vertical profile component of stylus instruments.

5.2.1 Type A1 — Wide grooves with flat bottoms

These measurement standards have a wide calibrated groove with a flat bottom, a ridge with a flat top, or a number of such separated features of equal or increasing depth or height. Each feature is wide enough to be insensitive to the shape or condition of the stylus tip (see Figure 1).

5.2.2 Type A2 — Wide grooves with rounded bottoms

These measurement standards are similar to type A1, except that the grooves have rounded bottoms of sufficient radius to be insensitive to the shape or condition of the stylus tip (see Figure 2).

5.3 Type B — Tip condition measurement standard

These measurement standards are primarily for calibrating the condition of the stylus tip.

5.3.1 Type B1

These measurement standards have a narrow groove or a number of separated grooves proportioned to be increasingly sensitive to the dimensions of the stylus tip. The narrow grooves have rounded bottoms of sufficient radius to be sensitive to the shape or condition of the stylus tip.

5.3.2 Type B2

These measurement standards have two groove patterns of nominally equal R_a values, one being sensitive and the other insensitive to the dimensions of the stylus tip (see Figures 3 and 4).

5.3.3 Type B3

These measurement standards have a fine protruding edge. Uncoated razor blades, for example, have edge widths of approximately 0,1 μm or less. The stylus condition may be assessed by traversing such a specimen and recording the surface profile.

5.4 Type C — Spacing measurement standard

These measurement standards are used primarily for calibrating vertical profile components. They may also be used for calibrating horizontal profile components if the spacing of the grooves is held within limits acceptable for this purpose. The purpose of the series of measurement standards is to enable the transmission characteristics to be checked for a number of spacings and amplitudes.

They have a grid of repetitive grooves of simple shape (either sinusoidal, triangular or arcuate).

An essential requirement of type C measurement standards is that standardized measurement standards of differing waveform are nevertheless compatible, in the sense that they will all lead to the same state of instrument calibration or verification, provided they are used correctly.

5.5 Type D — Roughness measurement standard

5.5.1 General

These measurement standards are for overall calibration of instruments.

NOTE The variation over the area of a type D standard is typically higher than that of a type C standard. Therefore it is normally necessary to average a statistically determined number of appropriately positioned tracings to get the full benefit of the D standard.

5.5.2 Type D1 — Unidirectional irregular profile

These measurement standards have irregular profiles (for example as obtained by grinding) in the direction of traverse, but they have the convenience of an approximately constant cross-section perpendicular to the direction of traverse.

The measurement standards simulate work pieces containing a wide range of crest spacings, but reduce the number of traverses needed to give a good average value. They provide, for reassurance, a final overall check on calibration.

5.5.3 Type D2 — Circular irregular profile

These circular measurement standards have irregular profiles in the radial direction, but they have the convenience of an approximately constant cross-section along their circumference.

5.6 Type E — Profile coordinate measurement standard

These measurement standards are intended for calibrating the profile co-ordinate system of the instrument.

5.6.1 Type E1 — Precision sphere or hemisphere

These measurement standards consist of a sphere or hemisphere.

5.6.2 Type E2 — Precision prism

These measurement standards consist of a prism with a trapezium cross-section. The base of the trapezium is the longer of the parallel surfaces. The top surface and the two surfaces generated by the sides of the trapezium are the measuring surfaces. The angles of the two side measuring surfaces are designed so that the stylus tip is in contact with the surface throughout the measuring instrument's range.

6 Measurement standard requirements

6.1 Type A — Depth measurement standard

6.1.1 Type A1 — Wide grooves with flat bottoms

The wide grooves with flat bottoms on these measurement standards are characterized by their width W and their depth d (see Figure 1).

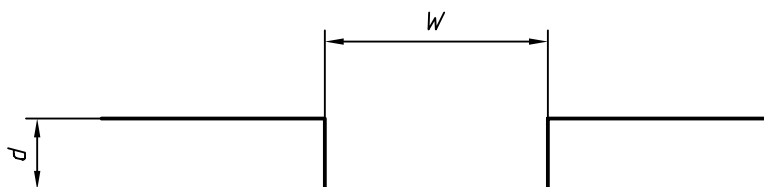

NOTE Wide ridges with flat tops are equivalent.

Figure 1 — Type A1 groove

6.1.2 Type A2 — Wide grooves with rounded bottoms

The wide grooves with rounded bottoms on these measurement standards are characterized by their radius r and their depth d (see Figure 2).

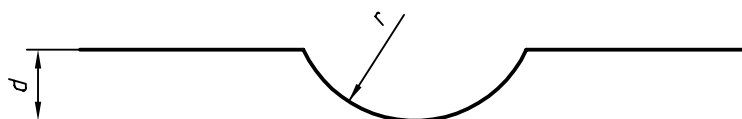

Figure 2 — Type A2 groove

6.1.3 Basis of assessment

The basis of assessment for types A1 and A2 is given in 7.1 and 7.2; requirements regarding statements of mean values are given in clause 8.

6.2 Type B — Tip condition measurement standard

6.2.1 Type B1

The narrow grooves with rounded bottoms on these measurement standards are characterized by their radius r and their depth d .

6.2.2 Type B2

These measurement standards have two or more groove patterns formed on a common base.

6.2.2.1 Sensitive groove pattern (see Figure 3)

Isosceles triangular grooves with sharp peaks and valleys, with RS_m and apex angle α proportioned to make Ra dependent on the size of the stylus tip.

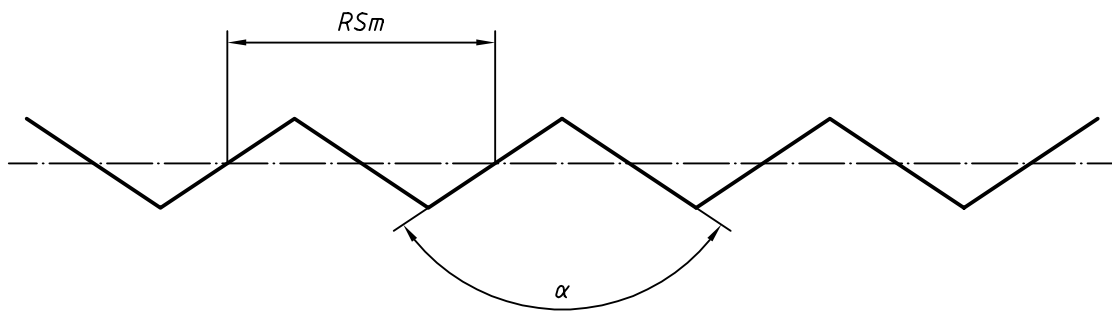

Figure 3 — Type B2 grooves (sensitive groove pattern)

6.2.2.2 Insensitive groove pattern (see Figure 4)

Approximately sinusoidal or arcuate grooves, proportioned to make Ra substantially independent of the stylus tip.

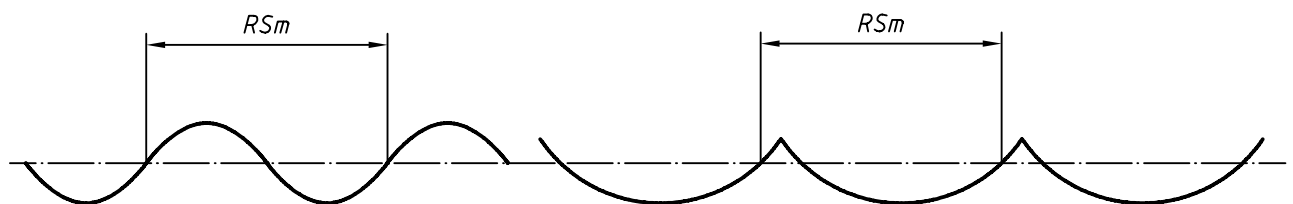

Figure 4 — Type B2 grooves (insensitive groove pattern)

6.2.2.3 Basis of assessment

The basis of assessment for type B2 is given in 7.3.

6.2.3 Type B3

The radius and apex angle of the protruding edge are smaller than the radius and apex angle of the stylus to be assessed.

The basis of assessment for type B3 is given in 7.4.

6.3 Type C — Spacing measurement standard

6.3.1 Type C1 — Grooves having a sine wave profile (see Figure 5)

These measurement standards are characterized by RSm and Ra . The values shall be chosen such that attenuation by the stylus or filter is negligible.

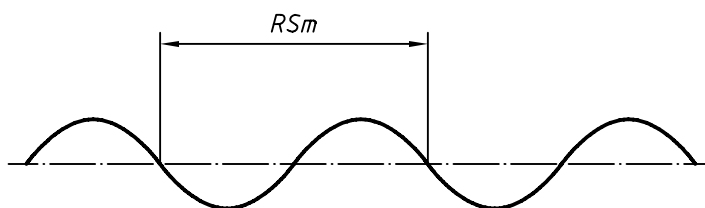

Figure 5 — Type C1 grooves

The basis of assessment for type C1 is given in 7.5.

6.3.2 Type C2 — Grooves having an isosceles triangular profile (see Figure 6)

These measurement standards are characterized by RSm and Ra . The values shall be chosen such that attenuation by the stylus or filter is negligible.

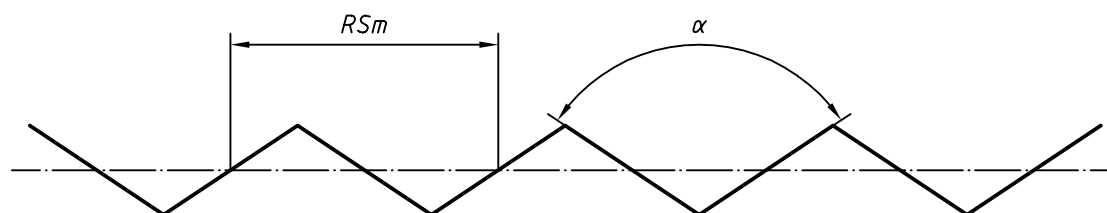

Figure 6 — Type C2 grooves

The basis of assessment for type C2 is given in 7.5.

6.3.3 Type C3 - Simulated sine wave grooves (see Figure 7)

These measurement standards are characterized by RSm and Ra . These are simulated sine waves, which include triangular profiles with rounded or truncated peaks and valleys, the total root mean square (r.m.s.) harmonic content of which shall not exceed 10 % of the r.m.s. value of the fundamental.

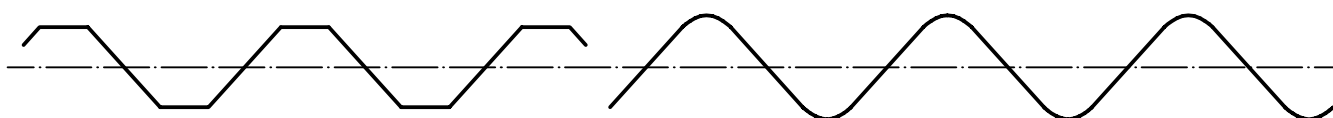

Figure 7 — Type C3 grooves

The basis of assessment for type C3 is given in 7.5.

6.3.4 Type C4 — Grooves having an arcuate profile (see Figure 8)

These measurement standards are characterized by PSm and Pa . The values shall be chosen such that attenuation by the stylus or filter is negligible.

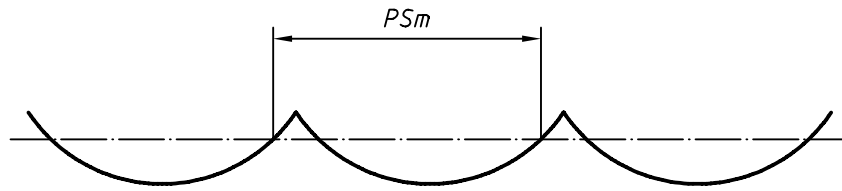

Figure 8 — Type C4 grooves

The basis of assessment for type C4 is given in 7.5.

6.4 Type D — Roughness measurement standard

6.4.1 Type D1 — Unidirectional irregular profiles (see Figure 9)

These measurement standards are characterized by Ra and Rz . These have irregular ground profiles which are repeated every $5\lambda_c$ in the longitudinal direction of the measurement standard. Normal to the measuring direction of the measurement standard, the profile shape is constant.

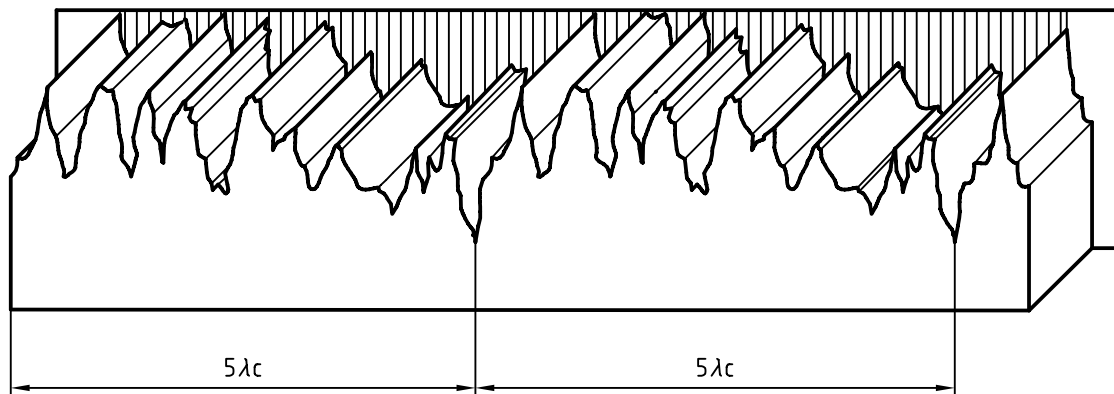

Figure 9 — Type D1 grooves (profile repetition at $5\lambda_c$ intervals)

The basis of assessment for type D1 is given in 7.5.

6.4.2 Type D2 - Circular irregular profile (see Figure 10)

These measurement standards are characterized by R_a and R_z . These have irregular profiles which are repeated every $5\lambda_c$ in the radial direction of the measurement standard. Normal to the measuring direction of the measurement standard (in the circumferential direction), the profile shape is constant.

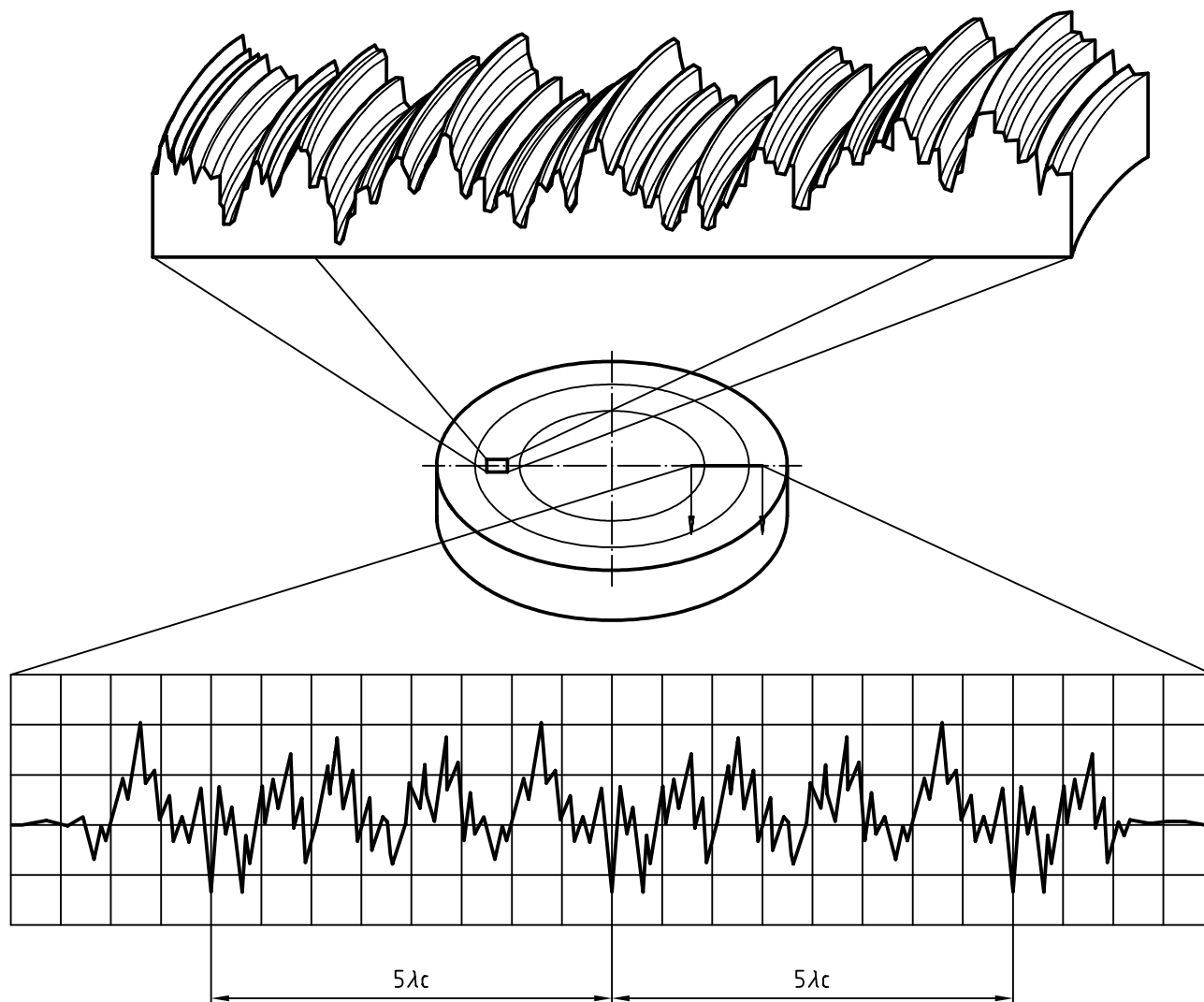

Figure 10 — Type D2 grooves

The basis of assessment for type D2 is given in 7.5.

6.5 Type E — Profile coordinate measurement standard

6.5.1 Type E1 — Precision sphere or hemisphere

These measurement standards are characterized by their radius and P_t .

NOTE The radius of the sphere (or hemisphere) should be sufficient to allow the spherical portion of the stylus tip to remain in contact (and not another part of the stylus) during a symmetrical traverse from either side of the highest point of the sphere (or hemisphere) through the full measuring range of the instrument within the traverse length.

6.5.2 Type E2 — Precision prism

These measurement standards are characterized by the angles between the surfaces and Pt on each surface.

NOTE The size and shape of the trapezium cross-section should be sufficient to allow the spherical portion of the stylus tip to remain in contact (and not another part of the stylus) through a symmetrical traverse over the prism through the full measuring range of the instrument within the traverse length of the instrument. The length of the top plane of the measurement standard should be sufficient to level in a stable manner (see Figure 11).



Figure 11 — Type E2 — Precision prism

7 Definition of the measurands for the measurement standards

7.1 Type A1

The equation:

$$Z = \alpha \times X + \beta + h \times \delta$$

with unknowns α , β and h , is fitted by the method of least squares to a profile equal in length to three times the width of the groove (see Figure 12). The variable δ takes the value +1 in regions A and B and the value -1 in region C (see Figure 12). The depth of the groove d is twice the estimated value of h

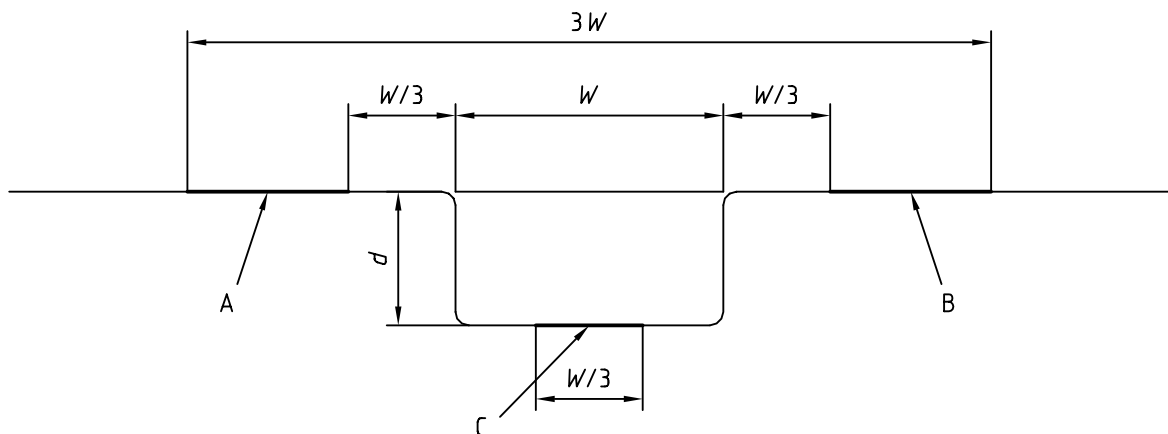

NOTE Wide ridges with flat tops are equivalent.

Figure 12 — Assessment of calibrated values for type A1

To avoid the influence of any rounding of the corners, the upper surface on each side of the groove shall be ignored for a length equal to one-third of the width of the groove. The surface at the bottom of the groove is assessed only over the central third of its width. The portions to be used for assessment purposes are those shown at A, B and C in Figure 12.

A significant number of traces, not less than five, shall be taken evenly distributed over the measuring window (avoiding defects).

7.2 Type A2

A least squares mean line representing the upper level is drawn over the groove. A least squares circle is fitted through the centre third of the width of the groove. The depth is assessed from the line to the lowest point of the fitted circle (see Figure 13).

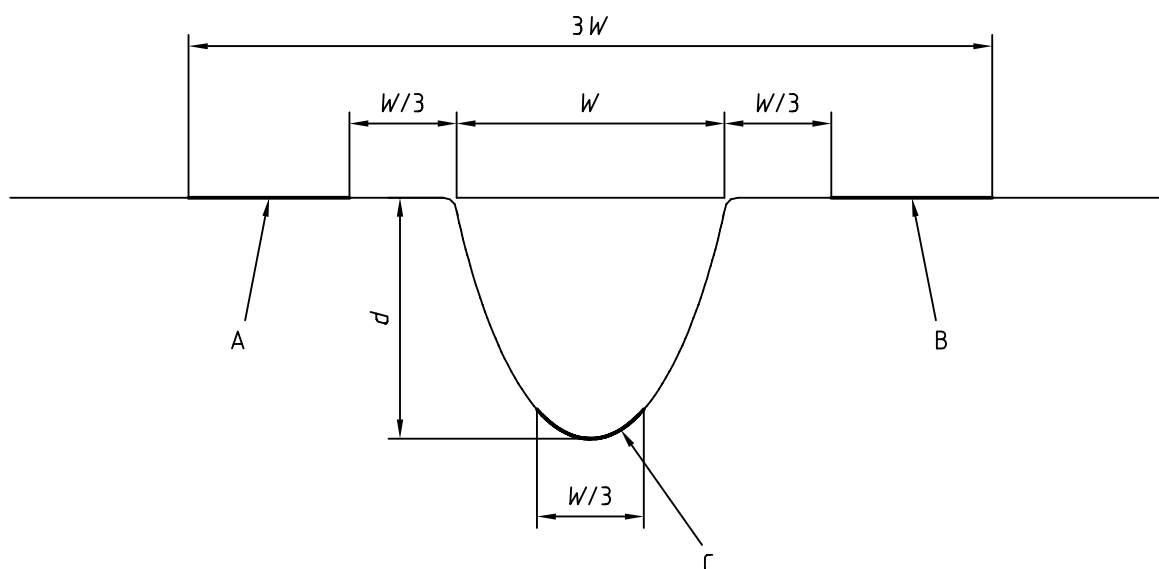

Figure 13 — Assessment of calibrated values for type A2

The portions to be used for assessment purposes are those shown at A, B and C in Figure 13.

A significant number of traces, not less than five, shall be taken evenly distributed over the measuring window (avoiding defects).

7.3 Type B2

The ratio of the mean Ra of the sensitive grid and the mean Ra of the insensitive grid shall be calibrated using a substantially sharp tip ($< 2 \mu\text{m}$ nominal radius) and a Gaussian filter having a λc cut-off according to the certificate and if not otherwise specified according to the rules given in ISO 4288.

A significant number of traces, not less than 18, shall be taken evenly distributed over the measuring window (avoiding defects), all instrument adjustments remaining constant throughout the determination.

7.4 Type B3

The stylus condition may be measured by traversing a sharp protruding edge, such as a razor blade, as shown in Figure 14. If r_1 is the stylus tip radius and r_2 is the radius of the razor blade edge, the recorded profile has a radius $r = r_1 + r_2$. If, in addition, r_2 is much less than r_1 , then the recorded radius is approximately equal to the stylus tip radius itself. This method can only be used with direct profile recording instruments with very slow traversing speed capability.

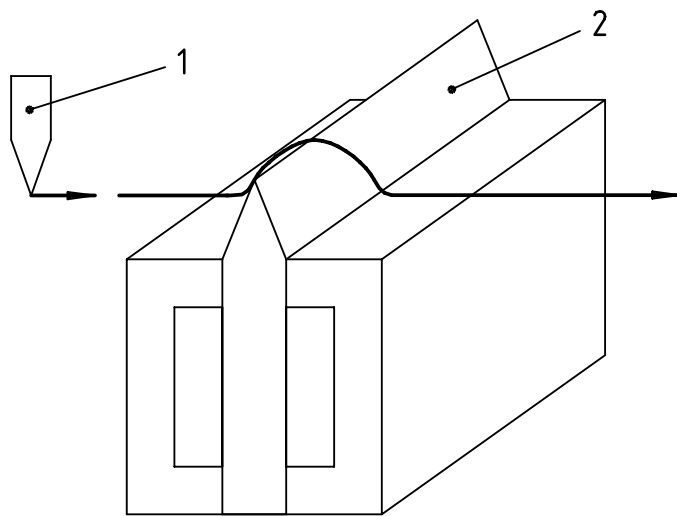

Schematic diagram of razor blade trace for profiling the shape of a stylus tip to determine its radius

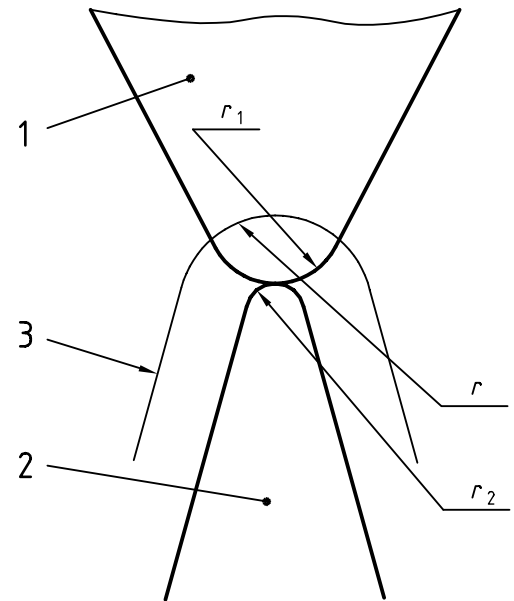

The output profile essentially represents the stylus tip shape if the radius and apex angle of the razor blade are much finer

Key

- 1 Stylus
- 2 Razor blade
- 3 Recorded profile

Figure 14 — Use of Type B3 measurement standard

7.5 Types C1 to C4, and D

The profile shall be traced and parameters shall be calculated according to the appropriate ISO standards (ISO 3274, ISO 4287, ISO 4288 and ISO 12085).

A significant number of traces, not less than 12, shall be taken evenly distributed over the measuring window (avoiding defects).

The declared parameter values issued with each measurement standard refer to a smooth straight datum and filtered profiles derived from the trace according to ISO 3274. Although the wider grooves are generally insensitive to the dimensions of the stylus tip, sensitivity in this respect may become appreciable for the narrowest grooves, and for this reason the parameter values shall be declared with reference to the stylus tip.

7.6 Type E1

A profile shall be taken symmetrically about the crown and be as long as possible within the limits that the measuring range of the instrument and the probe geometry will allow.

The radius shall be determined, via a least squares mean arc fitted to the profile, together with Pt .

7.7 Type E2

A symmetrical profile parallel to the edges shall be taken which includes the top surface and the two side surfaces of the trapezium and be as long as possible within the limits that the measuring range of the instrument and the probe geometry will allow.

The angles between the top surface and the sides of the trapezium shall be determined, via least squares mean line fits of the respective surfaces, together with the out of flatness values for the three faces.

8 Measurement standard certificate

After each measurement standard has been individually calibrated, it shall be accompanied by at least the minimum required of information for measurement standards as defined in ISO 10012-1 and where applicable the following information:

- a) the effective radius of the stylus tip(s) to which each calibrated value applies;
- b) details of calibration, including the number of observations taken;
- c) for each relevant metrological characteristic the calibrated mean value with its estimated expanded uncertainty, U (according to GUM or ISO/TS 14253-2 or both);
- d) for each relevant metrological characteristic the standard deviation from the mean;
- e) any other reference conditions to which each calibration applies, for example the basis of digital evaluation (ordinate discretization, vertical quantization), and whether the values declared refer to direct measurement or are obtained therefrom.

As far as possible the required information specified above shall be marked on each measurement standard; but if there is insufficient space, the values may be stated separately and uniquely identified with the measurement standard, for example by means of a serial number.

NOTE 1 The nominal value is used only as an aid to identification. The difference between the nominal value and the conventional true value does not constitute an error.

NOTE 2 The conventional true value is the value to be used for calibrating an instrument. It is the measured mean value of the appointed number and distribution of traces taken across the measuring window of the measurement standard, corrected for any predetermined errors in the calibrating equipment, as far as these are known. Visible defects in the measuring window should be avoided. Some degree of uncertainty in the calibrated mean value is permitted to allow for the possibility of residual errors in the calibrating equipment which are unknown and for which correction cannot be made, but whose limits would be estimable.

Annex A (informative)

Relation to the GPS matrix model

For full details about the GPS matrix model see ISO/TR 14638.

A.1 Information about this part of ISO 5436 and its use

This part of ISO 5436 defines measurement standards for the calibration of contact (stylus) instruments for the measurement of surface texture by the profile method as defined in ISO 3274.

A.2 Position in the GPS matrix model

This part of ISO 5436 is a general GPS standard, which influences chain link 6 of the chain of standards on roughness, waviness and primary profile in the general GPS matrix, as illustrated in Figure A.1.

Global GPS standards						
General GPS matrix						
Chain link number	1	2	3	4	5	6
Size						
Distance						
Radius						
Angle						
Form of line independent of datum						
Form of line dependent on datum						
Form of surface independent of datum						
Form of surface dependent on datum						
Orientation						
Location						
Circular run-out						
Total run-out						
Datums						
Roughness profile						
Waviness profile						
Primary profile						
Surface imperfections						
Edges						

**Fundamental
GPS
standards**

Figure A.1

A.3 Related standards

The related International Standards are those of the chains of standards indicated in Figure A.1.

Bibliography

- [1] ISO/TR 14638:1995, *Geometrical product specifications (GPS) — Masterplan*.

Annex ZA (normative)
Normative references to international publications
with their relevant European publications

This European Standard incorporates by dated or undated reference, provisions from other publications. These normative references are cited at the appropriate places in the text and the publications are listed hereafter. For dated references, subsequent amendments to or revisions of any of these publications apply to this European Standard only when incorporated in it by amendment or revision. For undated references the latest edition of the publication referred to applies.

<u>Publication</u>	<u>Year</u>	<u>Title</u>	<u>EN</u>	<u>Year</u>
ISO 3274	1996	Geometrical product specifications (GPS) - Surface texture: Profile method - Nominal characteristics of contact (stylus) instruments	EN ISO 3274	1997
ISO 4287	1997	Geometrical product specifications (GPS) - Surface texture: Profile method - Terms, definitions and surface texture parameters	EN ISO 4287	1998
ISO 4288	1996	Geometrical product specifications (GPS) - Surface texture: Profile method - Rules and procedures for the assessment of surface texture	EN ISO 4288	1997
ISO 10012-1	1992	Quality assurance requirements for measuring equipment - Part 1: Metrological confirmation system for measuring equipment	EN 30012-1	1993
ISO 12085	1996	Geometrical product specification (GPS) - Surface texture: Profile method - Motif parameters	EN ISO 12085	1997

BSI — British Standards Institution

BSI is the independent national body responsible for preparing British Standards. It presents the UK view on standards in Europe and at the international level. It is incorporated by Royal Charter.

Revisions

British Standards are updated by amendment or revision. Users of British Standards should make sure that they possess the latest amendments or editions.

It is the constant aim of BSI to improve the quality of our products and services. We would be grateful if anyone finding an inaccuracy or ambiguity while using this British Standard would inform the Secretary of the technical committee responsible, the identity of which can be found on the inside front cover. Tel: 020 8996 9000. Fax: 020 8996 7400.

BSI offers members an individual updating service called PLUS which ensures that subscribers automatically receive the latest editions of standards.

Buying standards

Orders for all BSI, international and foreign standards publications should be addressed to Customer Services. Tel: 020 8996 9001. Fax: 020 8996 7001. Standards are also available from the BSI website at <http://www.bsi-global.com>.

In response to orders for international standards, it is BSI policy to supply the BSI implementation of those that have been published as British Standards, unless otherwise requested.

Information on standards

BSI provides a wide range of information on national, European and international standards through its Library and its Technical Help to Exporters Service. Various BSI electronic information services are also available which give details on all its products and services. Contact the Information Centre. Tel: 020 8996 7111. Fax: 020 8996 7048.

Subscribing members of BSI are kept up to date with standards developments and receive substantial discounts on the purchase price of standards. For details of these and other benefits contact Membership Administration. Tel: 020 8996 7002. Fax: 020 8996 7001. Further information about BSI is available on the BSI website at <http://www.bsi-global.com>.

Copyright

Copyright subsists in all BSI publications. BSI also holds the copyright, in the UK, of the publications of the international standardization bodies. Except as permitted under the Copyright, Designs and Patents Act 1988 no extract may be reproduced, stored in a retrieval system or transmitted in any form or by any means – electronic, photocopying, recording or otherwise – without prior written permission from BSI.

This does not preclude the free use, in the course of implementing the standard, of necessary details such as symbols, and size, type or grade designations. If these details are to be used for any other purpose than implementation then the prior written permission of BSI must be obtained.

If permission is granted, the terms may include royalty payments or a licensing agreement. Details and advice can be obtained from the Copyright Manager. Tel: 020 8996 7070.