

BS EN ISO 2418:2017



BSI Standards Publication

**Leather — Chemical, physical
and mechanical and fastness
test — Sampling location (ISO
2418:2017)**

National foreword

This British Standard is the UK implementation of EN ISO 2418:2017. It supersedes BS EN ISO 2418:2002 which is withdrawn.

The UK participation in its preparation was entrusted to Technical Committee TCI/69, Footwear, leather and coated fabrics.

A list of organizations represented on this committee can be obtained on request to its secretary.

This publication does not purport to include all the necessary provisions of a contract. Users are responsible for its correct application.

© The British Standards Institution 2017.
Published by BSI Standards Limited 2017

ISBN 978 0 580 86625 8

ICS 59.140.30

Compliance with a British Standard cannot confer immunity from legal obligations.

This British Standard was published under the authority of the Standards Policy and Strategy Committee on 28 February 2017.

Amendments/corrigenda issued since publication

Date	Text affected
------	---------------

EUROPEAN STANDARD

EN ISO 2418

NORME EUROPÉENNE

EUROPÄISCHE NORM

February 2017

ICS 59.140.30

English Version

Leather - Chemical, physical and mechanical and fastness test - Sampling location (ISO 2418:2017)

Cuir - Essais chimiques, physiques, mécaniques et de solidité - Emplacement de l'échantillonnage (ISO 2418:2017)

Leder - Chemische, physikalische und mechanische Prüfungen und Echtheitsprüfungen - Probenahmestelle (ISO 2418:2017)

This European Standard was approved by CEN on 19 January 2017.

CEN members are bound to comply with the CEN/CENELEC Internal Regulations which stipulate the conditions for giving this European Standard the status of a national standard without any alteration. Up-to-date lists and bibliographical references concerning such national standards may be obtained on application to the CEN-CENELEC Management Centre or to any CEN member.

This European Standard exists in three official versions (English, French, German). A version in any other language made by translation under the responsibility of a CEN member into its own language and notified to the CEN-CENELEC Management Centre has the same status as the official versions.

CEN members are the national standards bodies of Austria, Belgium, Bulgaria, Croatia, Cyprus, Czech Republic, Denmark, Estonia, Finland, Former Yugoslav Republic of Macedonia, France, Germany, Greece, Hungary, Iceland, Ireland, Italy, Latvia, Lithuania, Luxembourg, Malta, Netherlands, Norway, Poland, Portugal, Romania, Serbia, Slovakia, Slovenia, Spain, Sweden, Switzerland, Turkey and United Kingdom.



EUROPEAN COMMITTEE FOR STANDARDIZATION
COMITÉ EUROPÉEN DE NORMALISATION
EUROPÄISCHES KOMITEE FÜR NORMUNG

CEN-CENELEC Management Centre: Avenue Marnix 17, B-1000 Brussels

European foreword

This document (EN ISO 2418:2017) has been prepared by Technical Committee IULTCS "International Union of Leather Technologists and Chemists Societies" in collaboration with Technical Committee CEN/TC 289 "Leather" the secretariat of which is held by UNI.

This European Standard shall be given the status of a national standard, either by publication of an identical text or by endorsement, at the latest by August 2017, and conflicting national standards shall be withdrawn at the latest by August 2017.

Attention is drawn to the possibility that some of the elements of this document may be the subject of patent rights. CEN [and/or CENELEC] shall not be held responsible for identifying any or all such patent rights.

According to the CEN-CENELEC Internal Regulations, the national standards organizations of the following countries are bound to implement this European Standard: Austria, Belgium, Bulgaria, Croatia, Cyprus, Czech Republic, Denmark, Estonia, Finland, Former Yugoslav Republic of Macedonia, France, Germany, Greece, Hungary, Iceland, Ireland, Italy, Latvia, Lithuania, Luxembourg, Malta, Netherlands, Norway, Poland, Portugal, Romania, Serbia, Slovakia, Slovenia, Spain, Sweden, Switzerland, Turkey and the United Kingdom.

Endorsement notice

The text of ISO 2418:2017 has been approved by CEN as EN ISO 2418:2017 without any modification.

Contents

Page

Foreword	iv
1 Scope	1
2 Normative references	1
3 Terms and definitions	1
4 Location of laboratory samples	1
4.1 General.....	1
4.1.1 Segmentation of leather.....	1
4.1.2 Selection of samples.....	2
4.1.3 Sampling for physical and colour fastness testing.....	2
4.1.4 Sampling for chemical testing.....	3
4.1.5 Sampling where areas of tension exist.....	3
4.2 Whole hides, skins and sides.....	4
4.3 Bends (butts).....	5
4.4 Shoulders.....	6
4.5 Bellies.....	7
5 Storage of laboratory samples	7
6 Identification of laboratory sample	8
6.1 Marking of the direction of the backbone.....	8
6.2 Marking.....	8
Bibliography	9

Foreword

ISO (the International Organization for Standardization) is a worldwide federation of national standards bodies (ISO member bodies). The work of preparing International Standards is normally carried out through ISO technical committees. Each member body interested in a subject for which a technical committee has been established has the right to be represented on that committee. International organizations, governmental and non-governmental, in liaison with ISO, also take part in the work. ISO collaborates closely with the International Electrotechnical Commission (IEC) on all matters of electrotechnical standardization.

The procedures used to develop this document and those intended for its further maintenance are described in the ISO/IEC Directives, Part 1. In particular the different approval criteria needed for the different types of ISO documents should be noted. This document was drafted in accordance with the editorial rules of the ISO/IEC Directives, Part 2 (see www.iso.org/directives).

Attention is drawn to the possibility that some of the elements of this document may be the subject of patent rights. ISO shall not be held responsible for identifying any or all such patent rights. Details of any patent rights identified during the development of the document will be in the Introduction and/or on the ISO list of patent declarations received (see www.iso.org/patents).

Any trade name used in this document is information given for the convenience of users and does not constitute an endorsement.

For an explanation on the meaning of ISO specific terms and expressions related to conformity assessment, as well as information about ISO's adherence to the World Trade Organization (WTO) principles in the Technical Barriers to Trade (TBT) see the following URL: www.iso.org/iso/foreword.html.

ISO 2418 was prepared by the Physical Test Commission of the International Union of Leather Technologists and Chemists Societies (IUP Commission, IULTCS), in collaboration with the European Committee for Standardization (CEN) Technical Committee CEN/TC 289, *Leather*, the secretariat of which is held by UNI, in accordance with the Agreement on technical cooperation between ISO and CEN (Vienna Agreement).

The Chemical and Fastness Test Commissions were consulted in the preparation of this standard. The locations of the samples are identical to those given in IUP 2 published in *J. Soc. Leather Trades Chemists* **42**, pp. 382-385, (1958) and IUC 2 published in *J. Soc. Leather Trades Chemists* **49**, pp. 6-8, (1965). IUP 2 was declared an official method in 1959 and IUC 2 in 1965. Updated versions were published in *J. Soc. Leather Tech. Chem.* **82**, p. 194, (1998) and further revisions were published in *J. Soc. Leather Tech. Chem.* **84**, p. 303, (2000) and reconfirmed as official methods in March 2001. The ISO Standard differs slightly in the text and includes tolerances for measurements but the locations of the samples are identical.

IULTCS, originally formed in 1897, is a world-wide organization of professional leather societies to further the advancement of leather science and technology. IULTCS has three Commissions, which are responsible for establishing international methods for the sampling and testing of leather. ISO recognizes IULTCS as an international standardizing body for the preparation of test methods for leather.

This third edition cancels and replaces the second edition (ISO 2418:2002), which has been technically revised with the following changes:

- [Clause 4](#) and the location of laboratory samples have been clarified;
- [Figure 1](#) to [Figure 5](#) have been re-drawn and re-labelled;
- [6.2 d\)](#) has also been added.

Leather — Chemical, physical and mechanical and fastness tests — Sampling location

1 Scope

This document specifies the location of a laboratory sample within a piece of leather and the method of labelling and marking the laboratory samples for future identification.

It is applicable to all types of leather derived from mammals irrespective of the tanning used.

It is not applicable to leathers derived from birds, fish, reptiles or furs.

2 Normative references

There are no normative references in this document.

3 Terms and definitions

For the purposes of this document, the terms and definitions given in the International Glossary of Leather Terms^[1] apply.

ISO and IEC maintain terminological databases for use in standardization at the following addresses:

- IEC Electropedia: available at <http://www.electropedia.org/>
- ISO Online browsing platform: available at <http://www.iso.org/obp>

4 Location of laboratory samples

4.1 General

4.1.1 Segmentation of leather

For the purposes of this document, the following segmentation of leather is considered (see [Figure 1](#)): bend (or butt), shoulder and belly.

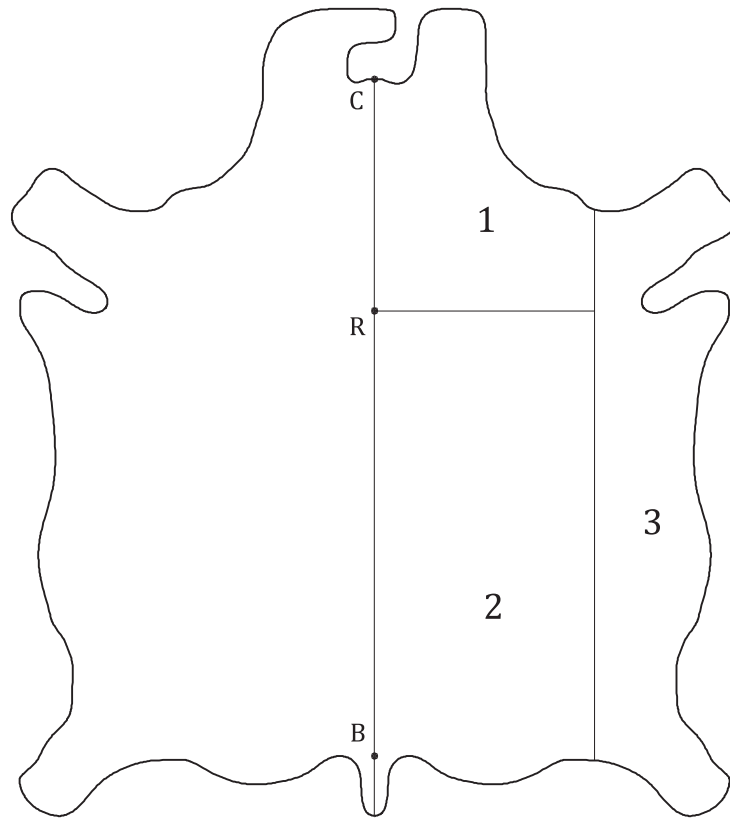

Key

- 1 shoulder
- 2 bend
- 3 belly
- B root of the tail (if visible)
- C top of the neck
- BC backbone
- R shoulder point where $CR = BC/3$

Figure 1 — Segmentation of a whole hide

4.1.2 Selection of samples

4.1.2.1 Areas selected for laboratory samples shall be free from all obvious defects such as scratches and flay cuts.

4.1.2.2 The sampling procedures described are designed to allow concurrent physical, colour fastness and chemical testing.

4.1.2.3 The results of analyses carried out on samples taken from different segments can vary significantly. For this reason, added to the impossibility to uniquely define segments size, sampling from whole hides and sides is to be preferred (see [4.2](#)).

4.1.3 Sampling for physical and colour fastness testing

4.1.3.1 For physical and colour fastness testing, take leather samples from the non-shaded areas specified in [Figure 2](#) to [Figure 5](#) as appropriate.

4.1.3.2 In arbitration analysis, only leather samples taken from the appropriate area of whole hides, skin or sides (see [4.2](#)) shall be used as the test sample.

4.1.4 Sampling for chemical testing

4.1.4.1 For chemical testing, take leather samples from the shaded area specified in [Figure 2](#) to [Figure 5](#) as appropriate.

4.1.4.2 If the minimum mass required for chemical testing is not attained, sample from the corresponding area on the other side of the backbone. If this is impossible, take additional material from the area immediately adjacent to the sampling position.

4.1.4.3 Uncontaminated trimmings from physical test pieces may be used for chemical testing except in arbitration analysis.

4.1.4.4 In arbitration analysis, only leather samples taken from the appropriate shaded area of whole hides, skin or sides (see [4.2](#)) shall be used as the chemical test sample.

4.1.5 Sampling where areas of tension exist

If a hide is cut into half hides or segments and dried afterwards in a toggling drier or a drying process that creates tension in the leather at the edges, then the distance of the sampling areas from the edges of the leather shall be increased from 50 mm to at least 100 mm where possible.

4.2 Whole hides, skins and sides

Take the non-shaded square piece GJKH and/or the shaded square piece HLMN shown in [Figure 2](#). In small skins, the distances EF and JK can be shorter than the length required for a single sample. When sampling small skins, modify the method of sampling using the minimum deviation from this procedure.

NOTE Sampling areas can be taken either on the right and/or left side of the hide.

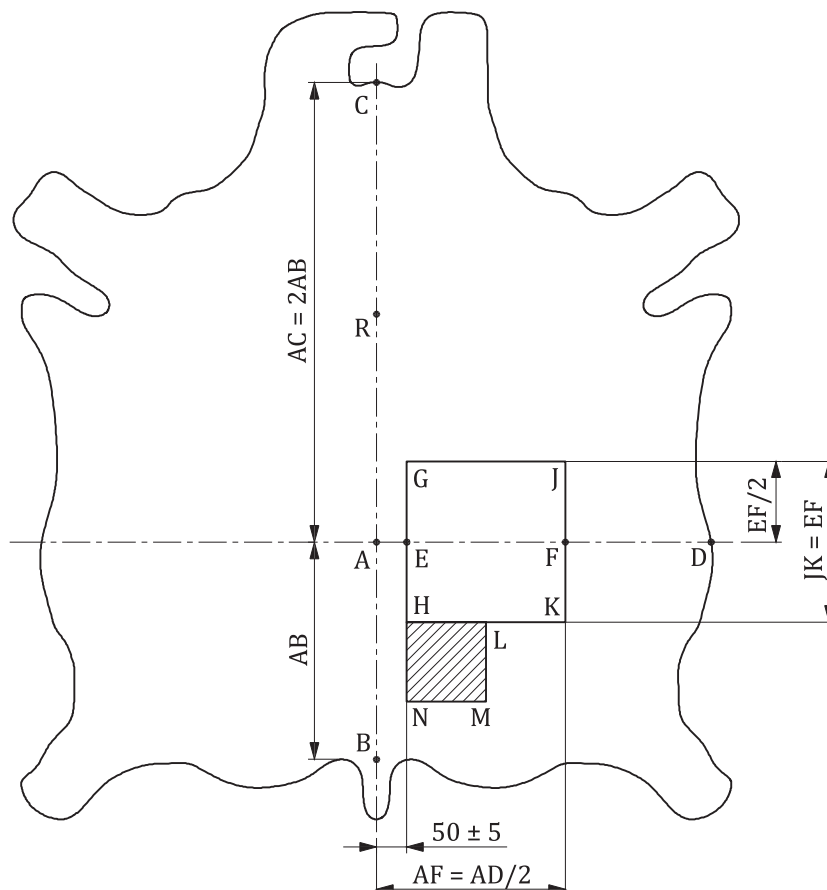

Key

- B root of the tail
- C top of the neck
- BC backbone
- D at the edge of the hide
- AD line perpendicular to BC
- $AB = BC/3$, such that $AC = 2AB$
- $AE = (50 \pm 5)$ mm (see also [4.1.5](#))
- $AF = FD$
- $JK = EF$
- $GE = EH$
- $HL = NM = HN = ML = HK/2$

NOTE Lines GH, JK, HN and LM are parallel to BC.

Figure 2 — Sampling location for whole hides, skins and sides

4.3 Bends (butts)

Take the non-shaded square piece GJKH and/or the shaded square piece HLMN shown in [Figure 3](#).

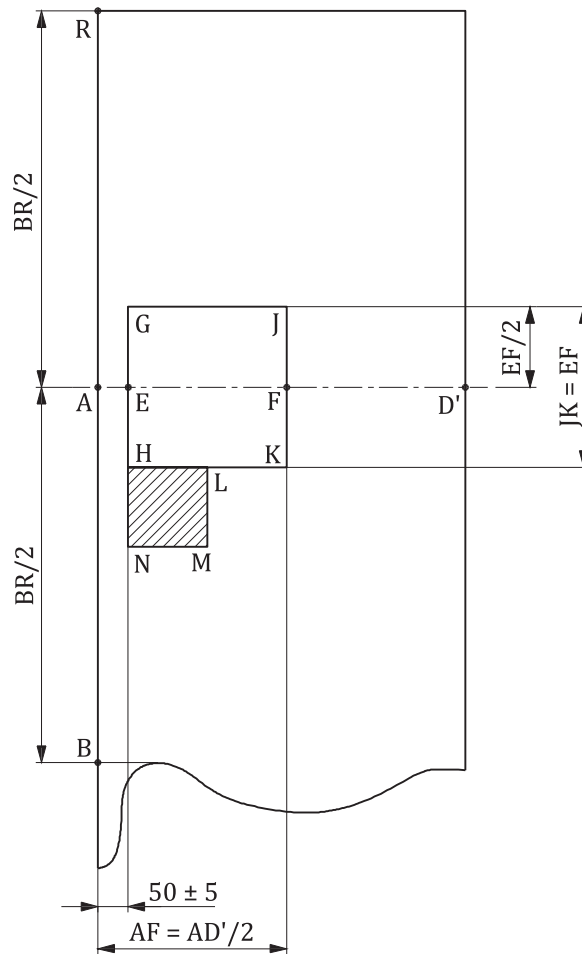

Key

- B root of the tail
- R shoulder point (see [Figure 1](#))
- BR lies along the backbone
- D' at the edge of the bend (butt)
- AD' line perpendicular to BR
- AB = BR/2, such that AB = AR
- AE = (50 ± 5) mm (see also [4.1.5](#))
- AF = FD'
- JK = EF
- GE = EH
- HL = NM = HN = ML = HK/2

NOTE Lines GH, JK, HN and LM are parallel to BR.

Figure 3 — Representation of a bend showing sampling location for bends (or butts)

4.4 Shoulders

Take the non-shaded rectangular piece GHJK and/or the shaded square piece HLMN shown in [Figure 4](#).

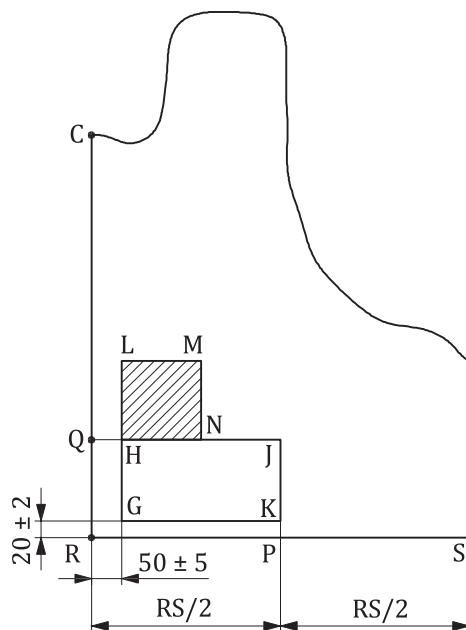

Key

- C top of the neck
- R shoulder point (see [Figure 1](#))
- CR lies along the backbone
- S at the edge of the shoulder
- KP = (20 ± 2) mm (see also [4.1.5](#))
- HQ = (50 ± 5) mm (see also [4.1.5](#))
- RP = PS
- GH = JK = HL = LM = MN = GK/2

NOTE Lines RS, HJ, GK and LM are perpendicular to CR. Lines GL, KJ and NM are parallel to CR.

Figure 4 — Representation of a shoulder showing sampling location for shoulders

4.5 Bellies

Take the non-shaded rectangular piece GHJK and/or the shaded square pieces HLMN and GL'M'N' shown in [Figure 5](#).

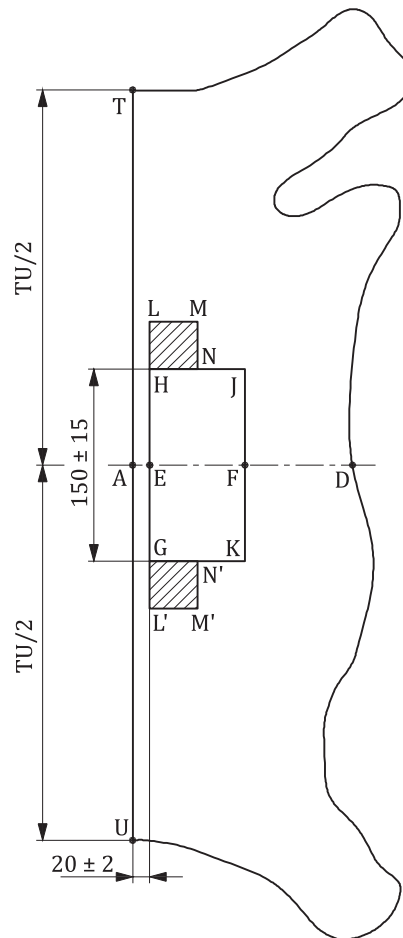

Key

- T neck end of the belly
- U tail end of the belly
- D at the edge of the hide
- AD line perpendicular to TU
- TA = AU
- GE = EH = EF = GK = HJ
- LH = NH = GN' = GL' = GH/4
- GH = (150 ± 15) mm
- AE = (20 ± 2) mm (see also [4.1.5](#))

Figure 5 — Representation of a belly showing sampling location for bellies

5 Storage of laboratory samples

Store laboratory samples in such a way as to avoid contamination and the effects of localized heating.

6 Identification of laboratory sample

6.1 Marking of the direction of the backbone

Mark the direction of the backbone by an arrow pointing towards the head positioned along the edge of the sample nearest to the backbone.

6.2 Marking

Mark the laboratory sample with the following information:

- a) the reference number of the batch of leather;
- b) the date of sampling;
- c) the reference number of the sample (if any);
- d) the segment of the hide that the sample was taken from: bend (or butt), shoulder or belly;
- e) the number and the date of this document, i.e. ISO 2418:2017;
- f) any deviation from the sampling procedure specified in this document (see [4.2](#)).

Bibliography

- [1] INTERNATIONAL COUNCIL OF TANNERS. International Glossary of Leather Terms¹⁾, 2nd edition

1) Issued by the International Council of Tanners in 1975 with the Addenda of 1978.

British Standards Institution (BSI)

BSI is the national body responsible for preparing British Standards and other standards-related publications, information and services.

BSI is incorporated by Royal Charter. British Standards and other standardization products are published by BSI Standards Limited.

About us

We bring together business, industry, government, consumers, innovators and others to shape their combined experience and expertise into standards-based solutions.

The knowledge embodied in our standards has been carefully assembled in a dependable format and refined through our open consultation process. Organizations of all sizes and across all sectors choose standards to help them achieve their goals.

Information on standards

We can provide you with the knowledge that your organization needs to succeed. Find out more about British Standards by visiting our website at bsigroup.com/standards or contacting our Customer Services team or Knowledge Centre.

Buying standards

You can buy and download PDF versions of BSI publications, including British and adopted European and international standards, through our website at bsigroup.com/shop, where hard copies can also be purchased.

If you need international and foreign standards from other Standards Development Organizations, hard copies can be ordered from our Customer Services team.

Copyright in BSI publications

All the content in BSI publications, including British Standards, is the property of and copyrighted by BSI or some person or entity that owns copyright in the information used (such as the international standardization bodies) and has formally licensed such information to BSI for commercial publication and use.

Save for the provisions below, you may not transfer, share or disseminate any portion of the standard to any other person. You may not adapt, distribute, commercially exploit, or publicly display the standard or any portion thereof in any manner whatsoever without BSI's prior written consent.

Storing and using standards

Standards purchased in soft copy format:

- A British Standard purchased in soft copy format is licensed to a sole named user for personal or internal company use only.
- The standard may be stored on more than 1 device provided that it is accessible by the sole named user only and that only 1 copy is accessed at any one time.
- A single paper copy may be printed for personal or internal company use only.

Standards purchased in hard copy format:

- A British Standard purchased in hard copy format is for personal or internal company use only.
- It may not be further reproduced – in any format – to create an additional copy. This includes scanning of the document.

If you need more than 1 copy of the document, or if you wish to share the document on an internal network, you can save money by choosing a subscription product (see 'Subscriptions').

Reproducing extracts

For permission to reproduce content from BSI publications contact the BSI Copyright & Licensing team.

Subscriptions

Our range of subscription services are designed to make using standards easier for you. For further information on our subscription products go to bsigroup.com/subscriptions.

With **British Standards Online (BSOL)** you'll have instant access to over 55,000 British and adopted European and international standards from your desktop. It's available 24/7 and is refreshed daily so you'll always be up to date.

You can keep in touch with standards developments and receive substantial discounts on the purchase price of standards, both in single copy and subscription format, by becoming a **BSI Subscribing Member**.

PLUS is an updating service exclusive to BSI Subscribing Members. You will automatically receive the latest hard copy of your standards when they're revised or replaced.

To find out more about becoming a BSI Subscribing Member and the benefits of membership, please visit bsigroup.com/shop.

With a **Multi-User Network Licence (MUNL)** you are able to host standards publications on your intranet. Licences can cover as few or as many users as you wish. With updates supplied as soon as they're available, you can be sure your documentation is current. For further information, email subscriptions@bsigroup.com.

Revisions

Our British Standards and other publications are updated by amendment or revision.

We continually improve the quality of our products and services to benefit your business. If you find an inaccuracy or ambiguity within a British Standard or other BSI publication please inform the Knowledge Centre.

Useful Contacts

Customer Services

Tel: +44 345 086 9001

Email (orders): orders@bsigroup.com

Email (enquiries): cservices@bsigroup.com

Subscriptions

Tel: +44 345 086 9001

Email: subscriptions@bsigroup.com

Knowledge Centre

Tel: +44 20 8996 7004

Email: knowledgecentre@bsigroup.com

Copyright & Licensing

Tel: +44 20 8996 7070

Email: copyright@bsigroup.com

BSI Group Headquarters

389 Chiswick High Road London W4 4AL UK