



Standard Specification for Heavy Hex Structural Bolt/Nut/Washer Assemblies, Alloy Steel, Heat Treated, 200 ksi Minimum Tensile Strength^{1,2}

This standard is issued under the fixed designation F3111; the number immediately following the designation indicates the year of original adoption or, in the case of revision, the year of last revision. A number in parentheses indicates the year of last reappraisal. A superscript epsilon (ϵ) indicates an editorial change since the last revision or reappraisal.

1. Scope

1.1 This specification covers heat treated, alloy steel, heavy hex structural bolt/nut/washer assemblies, also referred to as “sets,” having a tensile strength of 200 to 215 ksi. These assemblies are capable of developing a minimum predetermined tension when installed by applying an initial torque followed by rotation to the nut or bolt head, while at the same time preventing the rotation of the opposite side of the assembly.

NOTE 1—The installations in [Appendix X1](#) are important to the proper application of this product.

1.2 An assembly consists of a heavy hex structural head bolt, nut and two washers covered by this specification.

1.3 The assemblies are available in sizes 1 in. to 1 ¼ in. inclusive.

1.4 The fastener assemblies are intended for use in structural connections in the following environmental conditions:

1.4.1 Interiors, normally dry, including interiors where structural steel is embedded in concrete, encased in masonry or protected by membrane or noncorrosive contact type fireproofing.

1.4.2 Interiors and exteriors, normally dry, under roof, where the installed assemblies are soundly protected by a shop-applied or field-applied coating to the structural steel system.

1.5 The fastener assemblies are not intended for use in structural connections in the following environments, with or without protection by a shop-applied or field-applied coating to the structural steel system:

1.5.1 Exteriors not under roof.

1.5.2 Chemical environments in which strong concentrations of highly corrosive gases, fumes, or chemicals, either in solution or as concentrated liquids or solids, contact the fasteners or their protective coating.

1.5.3 Heavy industrial environments severe enough to be classified as a chemical environment as described in [1.5.2](#).

1.5.4 Condensation and high humidity environments maintaining almost continuous condensation, including submerged in water and soil.

1.5.5 Cathodically protected environments, in which current is applied to the structural steel system by the sacrificial anode method or the DC power method.

1.6 *Units*—The values stated in inch-pound units are to be regarded as standard. No other units of measurement are included in this standard.

1.7 The following precautionary statement pertains only to the test method portions, [Section 13](#), [Section 14](#) and [Annex A2](#) of this Specification: *This standard does not purport to address all of the safety concerns, if any, associated with its use. It is the responsibility of the user of this standard to establish appropriate safety and health practices and determine the applicability of regulatory limitations prior to use.*

2. Referenced Documents

2.1 *ASTM Standards*:³

[A751 Test Methods, Practices, and Terminology for Chemical Analysis of Steel Products](#)

[E709 Guide for Magnetic Particle Testing](#)

[E1444/E1444M Practice for Magnetic Particle Testing](#)

[F606/F606M Test Methods for Determining the Mechanical Properties of Externally and Internally Threaded Fasteners, Washers, Direct Tension Indicators, and Rivets](#)

¹ This specification is under the jurisdiction of ASTM Committee [F16](#) on Fasteners and is the direct responsibility of Subcommittee [F16.02](#) on Steel Bolts, Nuts, Rivets and Washers.

Current edition approved April 1, 2016. Published May 2016. originally approved in 2014. last previous edition approved in 2014 as F3111–14. DOI: 10.1520/F3111-16.

² The "Heavy-Hex Structural Bolt/Nut/Washer Assemblies, Alloy Steel, Heat Treated, 200 ksi Minimum Tensile Strength" of Grade 2 is covered by US patent number 7 070 664, July 4, 2006. Interested parties are invited to submit information regarding the identification of an alternative(s) to this patented item to the ASTM International Headquarters. Your comments will receive careful consideration at a meeting of the responsible technical committee, which you may attend.

ASTM International takes no position respecting the validity of any patent rights asserted in connection with any item mentioned in this standard. Users of this standard are expressly advised that determination of the validity of any such patent rights, and the risk of infringement of such rights, are entirely their own responsibility.

³ For referenced ASTM standards, visit the ASTM website, www.astm.org, or contact ASTM Customer Service at service@astm.org. For *Annual Book of ASTM Standards* volume information, refer to the standard's Document Summary page on the ASTM website.

- [F788 Specification for Surface Discontinuities of Bolts, Screws, and Studs, Inch and Metric Series](#)
- [F812 Specification for Surface Discontinuities of Nuts, Inch and Metric Series](#)
- [F1470 Practice for Fastener Sampling for Specified Mechanical Properties and Performance Inspection](#)
- [F1789 Terminology for F16 Mechanical Fasteners](#)
- [F2328 Test Method for Determining Decarburization and Carburization in Hardened and Tempered Threaded Steel Bolts, Screws, Studs, and Nuts](#)
- 2.2 *ASME Standards*:⁴
 - [B1.3 Screw Thread Gaging Systems for Acceptability: Inch and Metric Screw Threads \(UN, UNR, UNJ, M, and MJ\)](#)
 - [B1.15 Unified Inch Screw Threads \(UNJ Thread Form\)](#)
 - [B18.2.6 Fasteners for Use in Structural Applications](#)

3. Terminology

3.1 Definitions of Terms Specific to This Standard:

3.1.1 The definition of terms used in this specification shall be as specified in Terminology [F1789](#), unless otherwise defined herein.

3.1.2 *component lot, n*—component lot, for the purpose of assigning an identification number and from which test samples shall be selected, shall consist of all bolts, all nuts or all washers processed essentially together through all operations to the shipping container, of which each component has the following common characteristics: heat number (mill heat); nominal dimensions (size), grade, and heat treatment lot.

3.1.3 *manufacturer, n*—entity that assembles, lubricates, tests, and certifies compliance with this specification.

4. Ordering Information

4.1 Orders for assemblies shall include the items of information below. Optional items not on the purchase order shall be considered as not being required (see [Note 2](#)):

- 4.1.1 Quantity of assemblies,
- 4.1.2 Size, including nominal bolt diameter, bolt length, and thread pitch,
- 4.1.3 Grade, that is, Grade 1 or Grade 2,
- 4.1.4 Name of product, that is, heavy hex structural bolt/nut/washer assemblies,
- 4.1.5 ASTM designation and year of publication, and
- 4.1.6 Special requirements, if required.

NOTE 2—A typical order description follows: 1000 assemblies, 1 ¼ diameter by 4 in. long with 7 threads per inch, Grade 2, Heavy Hex Structural Bolt/Nut/Washer Assemblies, ASTM F3111-14.

5. Materials and Manufacture

5.1 Heavy Hex Structural Bolt/Nut/Washer Assemblies:

- 5.1.1 The bolts shall be heavy hex structural bolts.
- 5.1.2 The assemblies shall consist of one heavy hex structural bolt, with one nut and two washers assembled on the bolt and the nut threaded on the bolt a minimum of one turn.
- 5.1.3 All nuts shall be heavy hex structural.

⁴ Available from American Society of Mechanical Engineers (ASME), ASME International Headquarters, Two Park Ave., New York, NY 10016-5990, <http://www.asme.org>.

5.1.4 All washers used in the assembly shall be circular and through hardened.

5.1.5 *Protective Coatings*—The bolts, nuts and washers shall not be coated by hot dip zinc coating, mechanical deposition, electroplating, dip-spin, dip-drain, or spray methods with zinc or other metallic coatings.

NOTE 3—Protective coatings may be shop-applied or field-applied to installed assemblies.

5.1.6 Lubrication:

5.1.6.1 The assemblies shall be lubricated by the manufacturer to meet the Assembly Lot Tension Test requirements in Section 8.

5.1.6.2 Lubrication in addition to that applied by the manufacturer is permitted, provided the Assembly Lot Tension Test requirements in Section 8 are met.

5.1.7 *Secondary Processing*—Secondary processing shall not be permitted to an assembly lot, except that lubrication may be added as provided in [5.1.6.2](#).

5.2 Heavy Hex Structural Bolts:

5.2.1 Heat Treatment:

5.2.1.1 If phosphate coating has been applied to the raw material, the residual phosphate shall be removed prior to heat treatment, and a record of the application of this processing step shall be maintained by the processor.

5.2.1.2 Heavy hex structural bolts shall be heat treated by quenching in oil from the austenitizing temperature and then tempering by reheating to a temperature not less than 1000°F.

5.2.2 *Thread*—The threads of heavy hex structural bolts shall be rolled.

5.3 Nuts:

5.3.1 Nuts shall be made by hot forming.

5.3.2 Nuts shall be heat treated by quenching in a liquid medium from a temperature above the transformation temperature and tempering at a temperature of at least 850°F.

5.3.3 Threads shall be formed by tapping.

5.4 Washers:

5.4.1 Washers shall be through hardened.

6. Chemical Composition

6.1 Heavy Hex Structural Bolts:

6.1.1 Steel for bolts shall be made by the basic oxygen process.

6.1.2 Bolts shall be alloy steel conforming to the chemical composition in [Table 1](#).

6.1.3 Product analysis may be made by the purchaser on finished bolts representing each lot. The chemical composition shall conform to the requirements in [Table 1](#), Product Analysis.

6.1.4 Heats of steel to which bismuth, selenium, tellurium, lead or boron has been intentionally added shall not be permitted.

6.1.5 Compliance with [6.1.4](#) shall be based on certification that heats of steel having any of the listed elements intentionally added were not used to produce the bolts.

6.1.6 Chemical analysis shall be performed in accordance with Test Methods, Practices, and Terminology [A751](#).

6.2 Nuts:

TABLE 1 Chemical Requirements for Bolts

NOTE 1—Aluminum, cobalt, niobium/columbium, nickel, titanium, tungsten, zirconium, or any other alloying elements may be added to obtain the desired alloying effect.

Element	Composition, %			
	Heat Analysis, %		Product Analysis, %	
	min	max	min	max
Carbon	0.38	0.42	0.36	0.44
Manganese	0.40	0.60	0.37	0.63
Phosphorus	...	0.01	...	0.015
Sulfur	...	0.01	...	0.015
Silicon	...	0.10	...	0.12
Chromium	1.20	1.40	1.15	1.45
Molybdenum	0.60	0.80	0.57	0.83
Vanadium	0.30	0.40	0.27	0.43

TABLE 3 Chemical Requirements for Washers

Element	Composition, %			
	Heat Analysis, %		Product Analysis, %	
	min	max	min	max
Carbon	0.42	0.48	0.40	0.50
Manganese	0.60	0.90	0.57	0.93
Silicon	0.15	0.35	0.13	0.37
Phosphorus	...	0.030	...	0.035
Sulfur	...	0.030	...	0.035

TABLE 4 Hardness Requirements for Bolts

Bolt Size, in.	Bolt Length, in.	Rockwell C	
		Min	Max
1 to 1 1/4, incl	all	38	45

6.2.1 Steel for nuts shall be made by the basic oxygen or electric-furnace process.

6.2.2 Nuts shall conform to the chemical composition in **Table 2**.

6.2.3 Product analysis may be made by the purchaser on finished nuts representing each lot. The chemical composition shall conform to the requirements in **Table 2**, Product Analysis.

6.2.4 Chemical analysis shall be performed in accordance with Test Methods, Practices, and Terminology **A751**.

6.3 Washers:

6.3.1 Steel used in the manufacture of washers shall be produced by the basic-oxygen or electric-furnace process.

6.3.2 Washers shall conform to the chemical composition specified in **Table 3**.

6.3.3 Product analysis may be made by the purchaser on finished washers representing each lot. The chemical composition shall conform to the requirements in **Table 3**, Product Analysis.

6.3.4 Chemical analysis shall be performed in accordance with Test Methods, Practices, and Terminology **A751**.

7. Mechanical Property Requirements for Heavy Hex Bolts, Nuts and Washers

7.1 Heavy Hex Bolts:

7.1.1 *Hardness*—Bolts shall conform to the hardness specified in **Table 4**.

7.1.2 Tensile Properties:

7.1.2.1 Bolts shall be wedge tested full size and shall conform to the minimum and maximum wedge tensile load, and proof load or alternative proof load specified in **Table 5**. The load achieved during proof load testing shall be equal to or greater than the specified proof load.

7.1.2.2 When the length of the bolt makes full size testing impractical, machined specimens shall be tested and shall conform to the requirements specified in **Table 6**. When bolts are tested by both full size and machined specimen methods, the full size test shall take precedence.

7.1.2.3 For bolts on which both hardness and tension tests are performed, acceptance based on tensile requirements shall take precedence in the event of low hardness readings.

7.1.2.4 Sample bolts shall be used to verify that the alloy steel material and heat treatment provides resistance to Environmental Hydrogen Embrittlement (EHE), in accordance with the requirements of **Annex A2**.

7.2 Nuts:

7.2.1 Nuts shall conform to the surface hardness specified in **Table 7**.

7.2.2 Nuts shall withstand the proof load stress specified in **Table 8**.

7.3 Washers:

7.3.1 Washers shall conform to the core hardness specified in **Table 9**.

8. Assembly Lot Tension Test

8.1 *Purpose*—The assembly lot test shall be performed on fastener assemblies to determine the ability of the assembly to provide the required initial tension range when the initial torque is applied, and to provide the minimum required pretension when the final rotation is applied.

8.2 *Requirement*—Full size completed assemblies shall be tested in accordance with **14.4**. When the specified torque in **Table 10** Column 1 is applied, an initial bolt tension shall conforming to the requirements of **Table 10** Columns 2 and 3. When the Final Rotation specified in **Table 10** Column 4 is subsequently applied, the minimum bolt tension shall conform to the requirements of **Table 10** Column 5.

9. Carburization/Decarburization of Heavy Hex Structural Bolts

9.1 This test is intended to evaluate the presence or absence of carburization and decarburization as determined by the difference in microhardness near the surface and core.

9.2 Requirements:

TABLE 2 Chemical Requirements for Nuts

Element	Composition, %			
	Heat Analysis, %		Product Analysis, %	
	min	max	min	max
Carbon	0.30	0.48	0.28	0.50
Manganese	0.60	0.90	0.57	0.93
Silicon	0.15	0.35	0.13	0.37
Phosphorus	...	0.050	...	0.055
Sulfur	...	0.050	...	0.055

TABLE 5 Tensile Requirements for Full Size Bolts

Bolt Size, Threads per in.	Stress Area, ^{A,B} in. ²	Tensile Load, ^C lbf		Proof Load, lbf	Alternative Proof Load, lbf
		Min	Max	Length Measurement Method	Yield Strength Method
Column 1	Column 2	Column 3	Column 4	Column 5	Column 6
Grade 1					
1 in. - 8	0.615	123 100	132 300	98 500	119 100
1 1/8 in. - 7	0.776	155 200	166 800	124 200	139 700
1 1/4 in. - 7	0.983	196 700	211 400	157 400	177 000
Grade 2					
1 in. - 8	0.640	128 000	137 700	102 400	115 200
1 1/8 in. - 7	0.808	161 600	173 600	129 300	145 400
1 1/4 in. - 7	1.019	203 800	219 100	163 000	183 400

^A The stress area for Grade 1 is calculated as: $A_s = 0.7854[0.5(d_{3\text{ max}} + d_{2\text{ max}})]^2$

^B The stress area for Grade 2 is calculated in accordance with Annex A1.

^C Loads tabulated are based on the following:

Bolt Size, in.	Column 3	Column 4	Column 5	Column 6
1 to 1 1/4	200 000 psi	215 000 psi	160 000 psi	180 000 psi

TABLE 6 Tensile Strength Requirements for Specimens Machined from Bolts

Nominal Bolt Diameter, in.	Tensile Strength, ksi		Yield Strength (0.2 % offset), min, ksi	Elongation in 2 in. or 50 mm, min, %	Reduction of Area, min, %
	min	max			
1 to 1 1/4, incl	200	215	180	14	40

TABLE 7 Hardness Requirements for Nuts

Bolt Size, in.	Surface Hardness, Rockwell C	
	Min	Max
1 to 1 1/4, incl	30	40

TABLE 8 Proof Load Requirements for Nuts

Nominal Size, Threads per inch	Stress Area, A_s , ^{A,B} in. ²	Proof Load Stress, ksi	Nut Proof Load, ^C lbf
Grade 1			
1 in. - 8	0.615	200	123 100
1 1/8 in. - 7	0.776	200	155 200
1 1/4 in. - 7	0.983	200	196 700
Grade 2			
1 in. - 8	0.640	200	128 000
1 1/8 in. - 7	0.808	200	161 600
1 1/4 in. - 7	1.019	200	203 800

^A The stress area for Grade 1 is calculated as:

$$A_s = 0.7854[0.5(d_{3\text{ max}} + d_{2\text{ max}})]^2$$

^B The stress area for Grade 2 is calculated in accordance with Annex A1.

^C To determine nut proof load in pounds, multiply the appropriate nut proof load stress by the tensile stress area of the thread.

9.2.1 *Carburization*—The assemblies shall show no evidence of a carburized surface when evaluated in accordance with 14.1.4.

9.2.2 *Decarburization*—Hardness value differences shall not exceed the requirements set forth for decarburization in Test Method F2328 for class 3/4 H materials when evaluated in accordance with 14.1.4.

TABLE 9 Core Hardness Requirements for Washers

Rockwell C	
Min 40	Max 45

10. Dimensions of Heavy Hex Structural Bolts, Nuts, and Washers

10.1 Heavy Hex Bolts:

10.1.1 Bolts shall be furnished with heavy hex structural heads.

10.1.2 The head and body dimensions shall conform to the dimensional requirements in Table 11, and ASME B18.2.6 section 2.1.1 for top of head, 2.1.5 for true position of head, 2.1.6 for bearing surface, 2.1.9.3 for incomplete thread diameter, 2.1.10 for point, and 2.1.11 for straightness.

10.1.3 Threads:

10.1.3.1 The thread length shall be as specified in Table 11.

10.1.3.2 Threads for Grade 1 shall have the coarse series, class 2A UNJ thread as specified in ASME B1.15.

10.1.3.3 Threads for Grade 2 shall be as specified in Annex A1, and shall have Class 2A tolerances as calculated in section 4.3.3 of ASME B1.15.

10.1.3.4 The gauging limit for bolts shall be verified during manufacture. In case of purchaser/supplier controversy over thread compliance, System 21 of ASME B1.3 shall be used for referee purposes.

10.2 Nuts:

10.2.1 The dimensions for nuts shall conform to the dimensional requirements in Table 12, and ASME B18.2.6, sections 3.1.4, 3.1.5 and 3.1.6.

10.2.2 Threads for nuts for Grade 1 shall be coarse series, class 2B UNJ thread as specified in ASME B1.15.

10.2.3 Threads for nuts for Grade 2 shall be as specified in Annex A1, and shall have Class 2B tolerances as calculated in section 4.3.4 of ASME B1.15.

10.3 Washers:

10.3.1 All circular washers shall conform to the dimensions shown in Table 13.

TABLE 10 Assembly Lot Tension Test Requirements

Bolt Size, in.	Initial Torque (ft-lbs)	Initial Tension lbs, min ^A	Initial Tension lbs, max ^B	Final Rotation (degrees) ^C	Final Tension lbs, min ^D	Tension lbs, min (for information only) ^E
	Column 1	Column 2	Column 3	Column 4	Column 5	Column 6
Grade 1						
1	400	30 000	86 000	180	90 000	86 000
1 1/8	600	38 000	109 000	180	114 000	109 000
1 1/4	900	48 300	138 000	180	145 000	138 000
Grade 2						
1	400	31 000	90 000	180	94 000	90 000
1 1/8	600	40 000	113 000	180	119 000	113 000
1 1/4	900	50 000	143 000	180	150 000	143 000

^A The values in Column 2 are based upon 35% of the values in Column 6, rounded to the nearest 1000 lbs (kip).

^B The values in Column 3 are equal to the values in Column 6.

^C Tolerance for Final Rotation in Column 4 as applied for this test is ± 15 degrees.

^D The values in Column 5 are based upon 105% of the values in Column 6, rounded to the nearest 1000 lbs (kip).

^E The values in Column 6 are equal to 70% of the specified minimum tensile strength for tests of full size F3111 bolts tested in axial tension and are rounded to the nearest 1000 lbs (kip).

10.3.2 The deviation from flatness shall not exceed 0.010 in. per inch as the maximum deviation from a straight edge placed on the cut side.

10.3.3 Circular runout of the outside diameter with respect to the hole shall not exceed 0.030 FIM.

10.3.4 Burrs shall not project above the immediately adjacent washer surface more than 0.010 in.

11. Workmanship, Finish, and Appearance

11.1 For heavy hex structural bolts, the allowable limits, inspection, and evaluation of the surface discontinuities, quench cracks, forging cracks, head bursts, shear bursts, seams, folds, thread laps, voids, tool marks, nicks, and gouges shall be in accordance with Specification F788 except that threads shall have no laps at the root or on the flanks located below the pitch line, when inspected in accordance with Specification F788, S1.2.

11.2 For the nut component, the allowable limits, inspection, and evaluation of surface discontinuities, quench cracks, forging cracks, inclusion cracks, bursts, shear bursts, seams, voids, tool marks, nicks and gouges shall be in accordance with Specification F812.

11.3 Washers shall be free of excess mill scale and foreign material on bearing surfaces.

12. Magnetic Particle Inspection for Heavy Hex Structural Bolt Longitudinal Discontinuities and Transverse Cracks

12.1 Requirements:

12.1.1 Each sample representative of the bolt lot shall be magnetic particle inspected for longitudinal discontinuities and transverse cracks.

12.1.2 The lot, as represented by the sample, shall be free from nonconforming bolts, as defined in Specification F788, when inspected in accordance with Section 12.2.

12.2 Inspection Procedure:

12.2.1 The inspection sample shall be selected at random from each bolt lot in accordance with 13.4.2.4 and examined

for longitudinal discontinuities and transverse cracks in the threads, body, fillet, and underside of the head.

12.2.2 Magnetic particle inspection shall be conducted in accordance with Guide E709 or Practice E1444/E1444M. Guide E709 shall be used for referee purposes. If any nonconforming bolt is found during the manufacturer's examination of the lot selected in 12.2.1, the lot shall be 100 % magnetic particle tested and all nonconforming bolts shall be removed and scrapped or destroyed.

12.2.3 Eddy current or liquid penetrant inspection may be substituted for the 100 % magnetic particle inspection when nonconforming bolts are found and 100 % inspection is required. On completion of the eddy current or liquid penetrant inspection, a random sample selected from each bolt lot in accordance with Guide F1470, shall be reexamined by the magnetic particle method. In case of controversy, the magnetic particle test shall take precedence.

12.2.4 Magnetic particle indications of themselves shall not be cause for rejection. If in the opinion of the quality assurance representative the indications may be cause for rejection, a sample taken in accordance with Guide F1470 shall be examined by microscopic examination or removal by surface grinding to determine if the indicated discontinuities are within Specification F788 limits.

13. Testing

13.1 Testing Responsibility:

13.1.1 Each component lot and assembly lot shall be tested by the manufacturer prior to shipment in accordance with the lot identification control quality assurance plan in 13.4.

13.1.2 When components or assemblies are furnished by a source other than the manufacturer, the responsible party as defined in Section 18 shall be responsible for assuring all tests have been performed and the components and assemblies comply with the requirements of this specification.

13.2 Purpose of Lot Inspection—The purpose of a lot inspection program is to ensure that each lot conforms to the requirements of this specification. For such a plan to be fully

TABLE 11 Heavy Hex Bolts

NOTE 1—The bolt length L shall be the distance measured parallel to the axis of the bolt from the bearing surface of the head to the center point of the groove through which shear will occur. Bolts are normally supplied in ¼ in. length increments.

NOTE 2—For bolts 1 in. diameter with length up to 6 in., inclusive, length tolerance is 3/16 in. underlength. For longer 1 in. diameter bolts and other diameters, length tolerance is ¼ in. underlength.

NOTE 3—FIM = Full Indicator Movement.

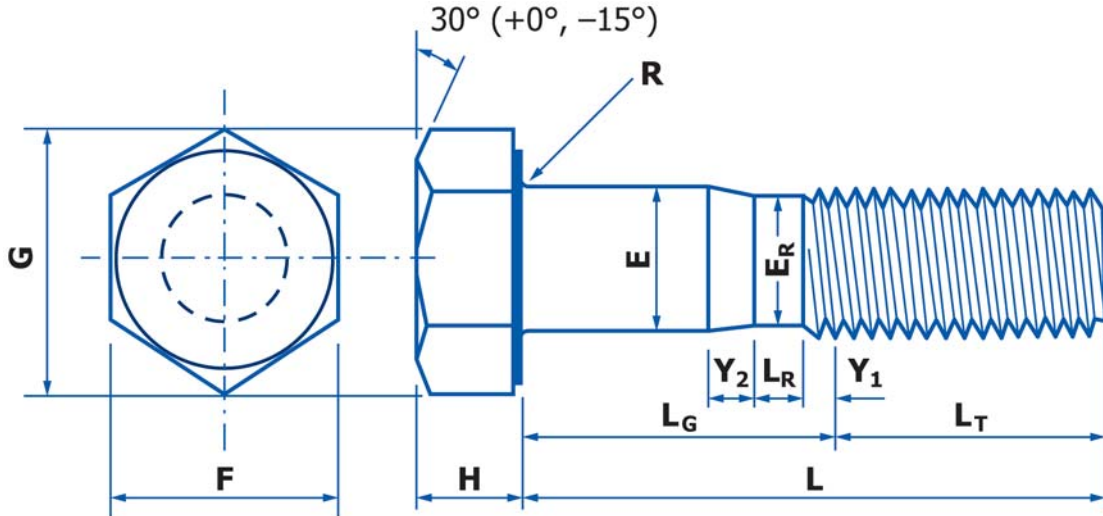

Nominal Size		1	1 1/8	1 1/4
Basic Diameter, E, in.		1.000	1.125	1.250
Full-Size Body Diameter E, in.	max	1.022	1.149	1.277
	min	0.976	1.098	1.223
Width Across Flats, F, in. ^A	nom	1 5/8	1 13/16	2
	max	1.625	1.812	2.000
	min	1.575	1.756	1.938
Width Across Corners, G, in.	max	1.876	2.093	2.309
	min	1.796	2.002	2.209
Head Height, H, in. ^B	nom	39/64	11/16	25/32
	max	0.627	0.718	0.813
	min	0.591	0.658	0.749
Radius of Fillet, R, in.	nom	3/32	3/32	7/64
	max	0.110	0.110	0.138
	min	0.087	0.087	0.098
Transition Body Diameter, ER, in.	nom	59/64	1 1/32	1 5/32
	max	0.933	1.046	1.171
	min	0.917	1.030	1.155
Body Transition Length, Y ₂ , in.	nom	0.305	0.354	0.354
	max	0.394	0.450	0.450
	min	0.207	0.244	0.244
Reduced Body Length, LR, in.	nom	1/2	9/16	9/16
	max	0.625	0.715	0.715
	min	0.375	0.429	0.429
Transition Thread Length Y ₁ , in. ^C	Ref	0.31	0.34	0.34
Thread Length, LT, in. ^D	Ref	2.049	2.322	2.322
Maximum Total Runout of Bearing Surface FIM, in. ^E		0.028	0.032	0.035

^A See ASME B18.2.6, sections 2.1.2 and 2.1.3.

^B See ASME B18.2.6, section 2.1.4.

^C Transition thread length, Y₁, is a reference dimension, intended for calculation purposes only, that represents the length of incomplete threads and tolerance on grip gaging length.

^D See ASME B18.2.6, section 2.1.10.2.

^E See ASME B18.2.6, section 2.1.6.

effective, it is essential that distributors and purchasers maintain the identification and integrity of each lot until the assemblies are installed.

13.3 Lot Control—All components shall be manufactured, processed, and tested in accordance with a lot control plan that provides lot purity and lot identification. The manufacturer and

distributors shall identify and maintain the integrity of each lot of components and finished assemblies from raw material selection through all processing operations and treatments to final packing and shipment. Each component lot shall be assigned its own component lot number and each assembly lot its own assembly lot number.

TABLE 12 Heavy Hex Nut Dimensions

NOTE 1—Bearing surfaces shall be flat and perpendicular to the axis of the threaded hole within the total runout (FIM) tabulated for the respective nut size.

NOTE 2—The tops of washer faced nuts shall be flat and the diameter of chamfer circle shall be equal to the maximum width across flats within a tolerance of -15%. The length of chamfer at hex comers shall be 5% to 15% of the basic thread diameter. The surface of chamfer may be slightly convex or rounded.

NOTE 3—FIM = Full Indicator Movement.

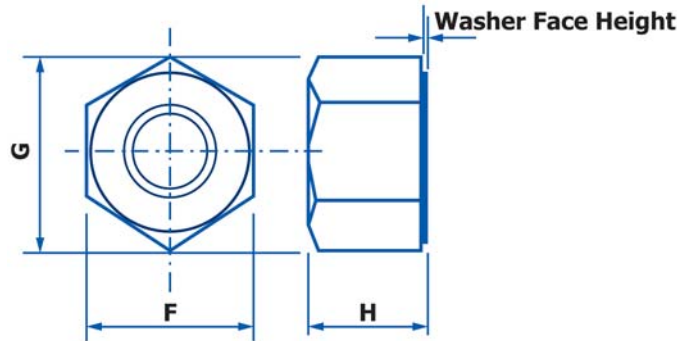

Nominal Size		1	1 1/8	1 1/4
Width Across Flats, F, in. ^A	nom	1.000	1.125	1.250
	max	1 5/16	1 13/16	2
	min	1.625	1.812	2.000
Width Across Corners, G, in. ^B	max	1.575	1.756	1.938
	min	1.876	2.093	2.309
	min	1.796	2.002	2.209
Thickness, H, in. ^C	nom	1 3/16	1 1/32	1 15/32
	max	1.214	1.367	1.501
	min	1.147	1.295	1.424
	nom	1/64	1/64	1/64
Washer Face Height, in.	nom	1/64	1/64	1/64
Total Runout of Bearing Face FIM, in. ^D		0.024	0.027	0.030

^A The width across flats of heavy hex nuts shall be the overall distance measured, perpendicular to the axis of the nut, between two opposite sides of the nut. No transverse section through the nut between 25% and 75% of the actual nut thickness, as measured from the bearing surface, shall be less than the minimum width across flats.

^B A rounding or lack of fill at junction of hex comers with chamfer shall be permissible, provided the width across comers is within specified limits at and beyond a distance equal to 17.5% of the basic thread diameter from the chamfered faces.

^C The nut thickness shall be the overall distance measured parallel to the axis of the nut, from the top of the nut to the bearing surface, and shall include the thickness of the washer face where provided.

^D Nuts shall have a washer faced bearing surface and chamfered top. The diameter of washer face shall be within the limits of the maximum width across flats and 95% of the minimum width across flats.

13.4 Number of Tests:

13.4.1 Sampling of Assemblies:

13.4.1.1 Assembly lot tension test sample size shall be in accordance with Guide F1470, Sample Level C, Table 3, with a minimum of two assemblies.

13.4.1.2 When tested in accordance with the required sampling plan, a component lot shall be rejected if any of the test specimens fail to meet the applicable requirements.

13.4.2 Sampling of Heavy Hex Structural Bolts:

13.4.2.1 Tensile strength, proof load, product hardness and carburization/decarburization sampling shall be in accordance with Guide F1470.

13.4.2.2 Chemical composition sampling shall be one test per heat conducted by the steel producer.

13.4.2.3 Sampling for dimensional and thread fit compliance shall be in accordance with the quality assurance provisions of ASME B18.2.6.

13.4.2.4 Sampling for workmanship, surface discontinuities, including head bursts, and magnetic particle inspection shall be in accordance with Guide F1470.

13.4.2.5 Sampling for resistance to Environmental Hydrogen Embrittlement shall be in accordance with Annex A2.

13.4.3 Sampling of Nuts:

13.4.3.1 Proof load and product hardness sampling shall be in accordance with Guide F1470.

13.4.3.2 Chemical composition sampling shall be one test per heat conducted by the steel producer.

13.4.3.3 Sampling for dimensional and thread fit compliance shall be in accordance with the quality assurance provisions of ASME B18.2.6.

13.4.4 Sampling of Washers:

13.4.4.1 Product hardness sampling shall be in accordance with Guide F1470.

13.4.4.2 Chemical composition sampling shall be one test per heat conducted by the steel producer.

14. Test Methods

14.1 Heavy Hex Structural Bolts:

14.1.1 Chemical analyses shall be conducted in accordance with Test Methods, Practices, and Terminology A751.

TABLE 13 Hardened Circular Washers Dimensions

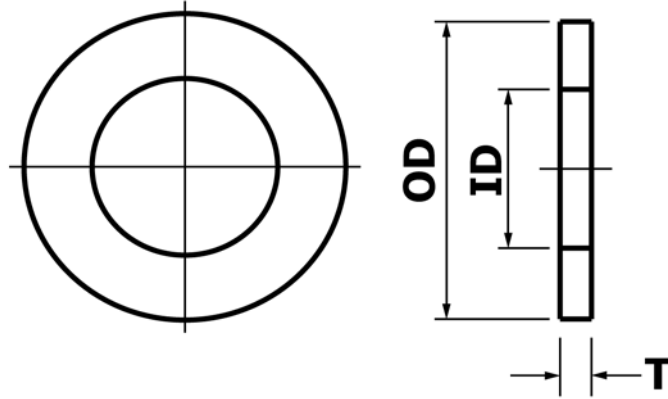

Nominal Size		1	1 1/8	1 1/4
Inside Diameter (ID), in.	nom	1 1/16	1 3/16	1 3/8
	max	1.085	1.251	1.438
	min	1.063	1.188	1.375
Outside Diameter (OD), in.	nom	2	2 1/4	2 1/2
	max	2.063	2.313	2.563
	min	1.937	2.187	2.437
Thickness (T), in.	nom	1/4	1/4	5/16
	max	0.264	0.264	0.343
	min	0.209	0.209	0.287

14.1.2 *Tensile and Hardness*—Tensile and hardness tests shall be conducted in accordance with Test Methods F606/F606M using the wedge tension testing of full size product method to determine full size tensile strength.

14.1.3 *Proof Load*—Proof load tests shall be conducted in accordance with Test Methods F606/F606M Method 1, Length Measurement, or Method 2, Yield Strength, at the option of the manufacturer.

14.1.4 *Carburization/decarburization*—Carburization/decarburization tests shall be conducted in accordance with Test Method F2328 using the Microindentation Hardness Method.

14.1.5 *Environmental Hydrogen Embrittlement*—Testing for resistance to Environmental Hydrogen Embrittlement shall be in accordance with Annex A2.

14.2 *Nuts:*

14.2.1 Chemical analyses shall be conducted in accordance with Test Methods, Practices, and Terminology A751.

14.2.2 Hardness and proof load tests shall be conducted in accordance with Test Methods F606/F606M.

14.3 *Washers:*

14.3.1 Chemical analyses shall be conducted in accordance with Test Methods, Practices, and Terminology A751.

14.3.2 *Hardness:*

14.3.2.1 Hardness tests shall be conducted in accordance with the Rockwell test method specified in Test Methods F606/F606M.

14.3.2.2 A minimum of two core hardness readings shall be taken 180° apart on at least one face at a minimum depth of 0.015 in from the original surface.

14.4 *Assembly Installation Tension Test:*

14.4.1 *Test Conditions*—Tests shall be conducted at an ambient temperature between 50 and 90°F (10 and 32°C).

14.4.2 *Test Device:*

14.4.2.1 The tension measuring device shall be capable of measuring the assembly tension after torquing.

14.4.2.2 The tension measuring device shall be calibrated to within 1% of the required pretension.

14.4.2.3 The tension measuring device (and any other equipment) shall be calibrated based on the frequency of use and the equipment manufacturer’s recommendation, but not less than one time per year.

14.4.3 *Installation and Tension Test:*

14.4.3.1 Install the heavy hex structural bolt, nut, washer, and appropriate spacer washer(s) in the tension measuring device. The device shall restrain the head from turning.

14.4.3.2 Install the washer(s) under the nut such that three to five threads of the bolt are located between the bearing face of the nut and the underside of the bolt head using the washer furnished with the assembly in contact with the nut.

14.4.3.3 The bolt component shall be restrained during the assembly tightening.

14.4.3.4 Initially tighten the assembly using a hand wrench by turning the nut to produce the setting tension specified below.

Bolt Diameter, in.	Setting Tension	Tension, 1000 lb
1		8 to 10
1 1/8		11 to 13
1 1/4		14 to 16

14.4.3.5 Apply the specified torque in Table 10 Column 1.

14.4.3.6 In order to pass this portion of the test, the bolt tension shall be between the minimum Initial Tension in Table 10 Column 2 and the maximum Initial Tension in Table 10 Column 3, inclusive.

14.4.3.7 Apply the Final Rotation specified in **Table 10** Column 4, with a permitted tolerance of ± 15 degrees.

14.4.3.8 In order to pass this portion of the test, the minimum bolt tension shall conform to the requirements of **Table 10** Column 5.

14.4.3.9 Record the Initial Tension and the Final Tension.

15. Inspection

15.1 If the inspection described in **15.2** is required by the purchaser, it shall be specified in the inquiry and contract or order.

15.2 The purchaser's representative shall have free entry to all parts of the manufacturer's works or supplier's place of business that concern the manufacture or supply of the assemblies. The manufacturer or supplier shall afford the purchaser's representative all reasonable facilities to satisfy the representative that the assemblies are being furnished in accordance with this specification. All tests and inspections required by the specification that are requested by the purchaser's representative shall be made before shipment, and shall be conducted so as not to interfere unnecessarily with the operation of the manufacturers or suppliers operations.

16. Rejection and Rehearing

16.1 Disposition of nonconforming sets shall be in accordance with the section on Disposition of Nonconforming Lots of Guide **F1470**.

17. Certification

17.1 The manufacturer or supplier, whichever is the responsible party as defined in Section **19**, shall furnish the purchaser a test report for each lot that includes the following:

17.1.1 Heat analysis and heat number of each component (bolt, nut, and washers), and a statement certifying that heats having the elements listed in **6.1.4** intentionally added were not used to produce the bolts.

17.1.2 Results of hardness, tensile and proof load tests of each component (bolt, nut, and washers), when applicable.

17.1.3 Results of test for resistance for Environmental Hydrogen Embrittlement, with a copy of the test report as required by Section **A2.9** of **Annex A2**.

17.1.4 *Results of Assembly Installation Tension Tests*—At the manufacturer's option, the mean and standard deviations may be reported.

17.1.5 Results of magnetic particle inspection tests.

17.1.6 Results of visual inspection for bursts.

17.1.7 Statement of compliance with dimensional and thread fit requirements.

17.1.8 Assembly lot number, individual component lot numbers for bolt-nut-washers, and purchase order number.

17.1.9 ASTM specification number, grade, and issue date.

17.1.10 Country of origin.

17.1.11 Complete mailing address of responsible party.

17.1.12 Title and signature of the individual assigned certification responsibility by the company officers.

17.2 Failure to include all the required information on the test report shall be cause for rejection.

18. Responsibility

18.1 The party responsible for the assemblies shall be the organization that supplies the assemblies to the purchaser and certifies that the assemblies have been manufactured, sampled, tested, and inspected in accordance with this specification and meets all of its requirements.

19. Product Marking of Heavy Hex Structural Bolts, Nuts and Washers

19.1 *Manufacturers Identification*—All components of each assembly shall be marked by the manufacturer with a unique identifier to identify the manufacturer.

19.2 Identification of Bolts:

19.2.1 Bolts for Grade 1 assemblies shall be marked with the symbol "F3111-1". Bolts for Grade 2 assemblies shall be marked with the symbol "F3111-2".

19.2.2 *Marking Location and Methods*—All markings shall be located on the top of the bolt head and shall be raised or depressed at the manufacturer's option.

19.3 Identification of Nuts:

19.3.1 Nuts for Grade 1 assemblies shall be marked with the symbol "XT-1". Nuts for Grade 2 assemblies shall be marked with the symbol "XT-2".

19.3.2 Additional identification or distinguishing marks, or both, may be used by the manufacturer.

19.3.3 All marking symbols shall be raised or depressed on one face of the nut at the manufacturer's option.

19.3.4 Grade and manufacturer's identification shall be separate and distinct. The two identifications shall preferably be in different locations and, when on the same level, shall be separated by at least two spaces.

19.4 Identification of Washers:

19.4.1 Washers shall be marked with the symbol "XT".

19.4.2 Additional identification or distinguishing marks, or both, may be used by the manufacturer.

19.4.3 All marking symbols shall be depressed on one face of the washer.

19.4.4 Type and manufacturer's identification shall be separate and distinct. The two identifications shall preferably be in different locations and, when on the same level, shall be separated by at least two spaces.

19.5 *Acceptance Criteria*—Components that are not marked in accordance with these provisions shall be considered nonconforming and subject to rejection.

20. Packaging and Package Marking

20.1 Packaging:

20.1.1 Unless otherwise specified, the assemblies shall be properly packed to prevent loss and damage during shipment. Special packaging requirements shall be defined at the time of the inquiry and order, but shall not void the requirements in **20.1.2** and **5.1.2**.

20.1.2 All products shall be assembled. (See **5.1.2**.)

20.2 Package Marking:

20.2.1 Each shipping unit shall include or be plainly marked with the following information:

- 20.2.1.1 ASTM designation and grade,
- 20.2.1.2 Size, nominal diameter, and length,
- 20.2.1.3 Name of the manufacturer and the supplier, if furnished by an entity other than the manufacturer,
- 20.2.1.4 Number of assemblies,
- 20.2.1.5 Assembly lot number(s),
- 20.2.1.6 Purchase order number(s), when required by the customer, and

20.2.1.7 Country of origin.

21. Keywords

21.1 alloy steel; fasteners; heavy hex structural bolt; heavy hex structural bolt/nut/washer assembly; structural

ANNEXES

(Mandatory Information)

A1. GRADE 2 ASSEMBLIES

A1.1 Thread Dimensions for Grade 2 Assemblies

A1.1.1 The basic thread dimensions for Grade 2 assemblies are as provided in [Table A1.1](#).

TABLE A1.1 Basic Thread Dimensions, Grade 2 Assemblies

NOTE 1—Values have been established based on a function of pitch, P. The thread values based on a function of height, H, are used for reference only.

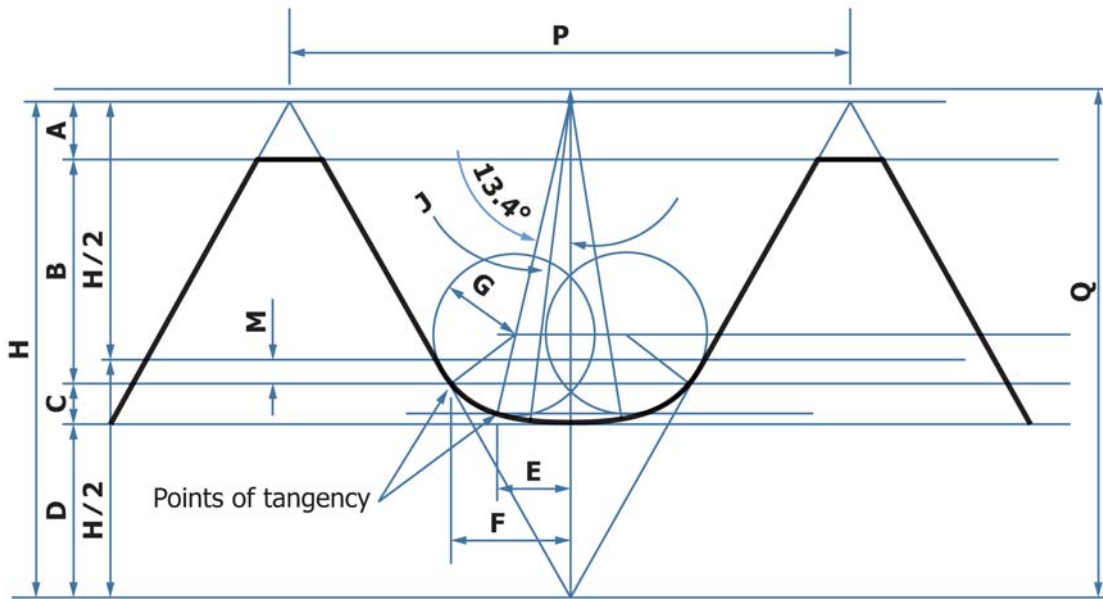

Nominal Size, in.	1	1 1/8	1 1/4
Major Diameter, in.	0.9980	1.1228	1.2478
Threads per inch	8	7	7
Pitch, in.	0.1250	0.1429	0.1429
A, in.	0.0135	0.0155	0.0155
B, in.	0.0460	0.0526	0.0526
C, in.	0.0106	0.0121	0.0121
D, in.	0.0381	0.0435	0.0435
E, in.	0.0167	0.0190	0.0190
F, in.	0.0281	0.0321	0.0321
G, in.	0.0180	0.0206	0.0206
H, in.	0.1083	0.1237	0.1237
J, in.	0.0722	0.0825	0.0825
M, in.	0.0054	0.0062	0.0062
Q, in.	0.1104	0.1261	0.1261

A1.2 Stress Area for Grade 2 Assemblies

A1.2.1 The stress area A_s is calculated as follows:

$$A_s = (\pi / 4)[(d_2 + d_3) / 2]^2 \quad (\text{A1.1})$$

where:

A_s = tensile stress area, in.²

d_{bsc} = basic major diameter, in.

n = threads per in.

H = $(\sqrt{3} / 2) * d_{\text{bsc}} / n$

d_2 = $d_{\text{bsc}} - (3/4 H)$

d_1 = $d_2 - 2 (H / 20)$

Θ = $\sin^{-1} (2 \sqrt{3} / 15)$

z = $(H / 6) (\cos \Theta)$

x' = $(H / 6) (\sin 30^\circ)$

y = $(H / 2) (\cos \Theta)$

z' = $(2H / 3) - y - z$

d_3 = $d_1 - 2 (z - x' + z')$

A2. TEST METHOD

A2.1. Scope

A2.1.1 This test method defines the procedures and tests to evaluate the susceptibility to Environmental Hydrogen Embrittlement (EHE) of an ASTM F3111 bolt.

A2.1.2 This test method shall qualify the bolt for use relative to EHE.

A2.1.3 The characteristic to be evaluated by this test method is the susceptibility to EHE caused by hydrogen generated from corrosion. Testing shall be performed on specimen ASTM F3111 bolts manufactured to the tensile strength of the bolt (see Section 5 Specimen Bolt Requirements). The internal hydrogen embrittlement (IHE) susceptibility will also be inherently evaluated when the EHE is tested through this test method. There is no need for a separate IHE susceptibility test.

A2.2. Referenced Documents

A2.2.1 *ASTM Standards*.⁵

[E4 Practices for Force Verification of Testing Machines](#)

[F519 Test Method for Mechanical Hydrogen Embrittlement Evaluation of Plating/Coating Processes and Service Environments](#)

[F606 Test Methods for Determining the Mechanical Properties of Externally and Internally Threaded Fasteners, Washers, and Rivets \(Metric\) F0606_F0606M](#)

[F1624 Test Method for Measurement of Hydrogen Embrittlement Threshold in Steel by the Incremental Step Loading Technique](#)

[F1789 Terminology for F16 Mechanical Fasteners](#)

[F2078 Terminology Relating to Hydrogen Embrittlement Testing](#)

[F2660 Test Method for Qualifying Coatings for Use on A490 Structural Bolts Relative to Environmental Hydrogen Embrittlement](#)

[G3 Practice for Conventions Applicable to Electrochemical Measurements in Corrosion Testing](#)

[G15 Terminology Relating to Corrosion and Corrosion Test-](#)

[ing \(Withdrawn 2010\)](#)⁶

[G44 Practice for Exposure of Metals and Alloys by Alternate Immersion in Neutral 3.5 % Sodium Chloride Solution](#)

A2.2.2 *Other References:*

[Townsend Jr., H. E., Met Trans, V6A, April, 1976 Raymond, L., The Susceptibility of Fasteners to Hydrogen Embrittlement and Stress Corrosion Cracking: Fastener System Design. In J. H. Bickford, & S. Nassar, Handbook of Bolts and Bolted Joints, New York, USA: Marcel Dekker, Inc., 1998, pp. 723-756.](#)

A2.3. Terminology

A2.3.1 *Definitions:*

A2.3.1.1 Terminology for this test method shall be used in accordance with Terminology [F1789](#), Terminology [F2078](#), and Terminology [G15](#) except as described below.

A2.3.2 *Definitions of Terms Specific to This Standard:*

A2.3.2.1 *specimen lot, n*—at least 15 ASTM F3111 specimen bolts manufactured in the same process from the same lot of a steel alloy.

A2.4. Significance and Use

A2.4.1 This test method describes the testing procedure that shall be used to qualify material for use in ASTM F3111 bolts made of any steel composition permitted by this specification. The test method measures the susceptibility of the material to the influence of an externally applied potential (see [A2.7.2.3.2](#)) by testing for the threshold of embrittlement in a salt solution environment.

A2.5. Specimen Bolt Requirements

A2.5.1 Testing shall be carried out using ASTM F3111 specimen bolts heat treated to achieve strength values near the maximum permitted by this standard. Specimen bolts are designed to simulate a worst case material condition with respect to susceptibility to environmental hydrogen embrittlement (EHE). For this reason, tensile values for specimen bolts approach the maximum limits for F3111 bolts.

⁵ For referenced ASTM standards, visit the ASTM website, www.astm.org, or contact ASTM Customer Service at service@astm.org. For *Annual Book of ASTM Standards* volume information, refer to the standard's Document Summary page on the ASTM website.

⁶ The last approved version of this historical standard is referenced on www.astm.org.

A2.5.2 Specimen bolts shall be the nominal inch size to be produced: 1, 1-1/8 or 1-1/4 in.

A2.5.3 Specimen bolts shall be for a lot that displays between 210 and 215 ksi, when tested in accordance with Test Methods **F606/F606M**.

A2.5.4 Specimen bolts shall be from homogeneous lots traceable to given mill heats of steel alloy.

A2.5.5 Tensile strengths for the specimen bolts must be within the range of 210 and 215 ksi, and dimensional and compositional conformance to this Specification shall be provided by the supplier of each specimen lot.

A2.6 Sample Quantities Required

A2.6.1 A minimum of twelve (12) bolts from any specimen lot shall be used for evaluation and qualification. Additional samples may be required for repeat test and shall be held in contingency.

A2.7. Test Procedures

A2.7.1 Open Circuit Potential (OCP):

A2.7.1.1 The freely corroding or Open Circuit Potential (OCP) shall be measured in 3.5% NaCl solution produced in accordance with Practice **G44** to characterize the corrosion behavior of the bolt. The OCP measurement shall be made on the bolt in accordance with Practice **G3**. The OCP measurement shall be taken using a potentiostat capable of making measurements with a resolution no less than ± 5 mV.

A2.7.1.2 A second OCP test shall be performed and the two tests shall be compared for consistency. If the OCP test is not ± 5 mV with the other OCP test, then a known material shall be used to test the accuracy of the reference electrode. If the electrode is accurate, then another bolt sample shall be tested to obtain consistency. One reason for inconsistency is dissimilar metals in the test setup.

A2.7.2 Environmental Hydrogen Embrittlement Testing:

A2.7.2.1 Mechanical Test Set-up:

A2.7.2.1.1 The test shall be conducted on bolts that have been truncated by removal of the bolt head. Cut off the bolt head using a water cooled cut off saw or other device that does not cause excessive heating of the bolt. The length of the specimen bolt for testing shall be a minimum length of 1.5 inches and a maximum length of 4.0 inches. The truncated bolt specimen shall be adjusted to achieve the placement of a minimum of two threads between the gripping devices. The exposed threads shall be equally spaced on each side of the minor diameter of the threads. This placement of the bolt specimen in the gripping device is shown in Fig. 1 of ASTM **F2660** with the grade to be used for the bolts.

A2.7.2.1.2 The loading method required for this test is a four-point (4 pt) bend, which produces constant moment along the gage section so that the stress may be calculated anywhere along the length of the fastener. The test is conducted under displacement control. The loading method shall have a specified load accuracy of $\pm 0.5\%$, programmable to increase incrementally in steps of load and time. The loading method shall be within the guidelines of calibration, force range, resolution, and verification of Practices **E4**.

A2.7.2.2 Fast Fracture Testing:

A2.7.2.2.1 The first step in the testing sequence shall be a measurement of the fast fracture load of the specimen bolts in bending, FFS(B). Determine this value by performing a test in accordance with Test Method **F1624**, Section 8, as shown in Fig. 2A, using a fast fracture protocol. Test a minimum of five specimen bolts.

A2.7.2.2.2 The average of these five test results shall determine the fast fracture strength of each condition.

A2.7.2.3 EHE Sample Testing:

A2.7.2.3.1 To measure the EHE susceptibility of the fastener, bolts are tested in the environment/setup described in section **A2.7.1.1** and **A2.7.2.3.2** using the step load methodology described in Test Method **F1624**, Section 8, to measure P_{th} .

A2.7.2.3.2 To test at the OCP of the bolt, the environmental chamber shall be partially filled with 3.5% NaCl solution produced in accordance with Practice **G44** with the level of the solution being maintained below the threshold section of the bolt specimen. The reference electrode shall be placed in close vicinity to the bolt threads. An electrochemical potential equal to the measured OCP from section **A2.7.1** shall be imposed on the specimen during the test to negate the influence of any dissimilar metals in the environmental chamber, such as the loading pins and gripping devices. When the potential reading is stable, the remaining salt solution is added to the chamber to fully immerse the bolt sample.

(1) As an alternative to imposing an electrochemical potential, the test can be performed under freely corroding conditions, provided the specimen is isolated from all metal contacts. It should be verified that there is no conductivity between the specimen and the adapters. The freely corroding potential, or OCP (section **A2.7.1**), shall be measured and recorded.

A2.7.2.3.3 The loading profile of the first sample bolt shall be (10/5/2,4), or ten (10) steps tested with a hold time of 2-hours followed by ten (10) steps at a hold time of 4-hours in 5% increments of FFS(B), taken as the initial value of P_{max} . Loading is not released during the transition from the 2-hour to 4-hour hold requirement. The test proceeds until the sample experiences a load drop of more than 5% during any single step in the load rate. An example of the step loading profile is shown in Fig. 2B of ASTM **F2660**.

A2.7.2.3.4 Subsequent tests shall be at progressively decreasing loading rates by using the same (10/5/2,4) profile and lowering P_{max} to the value of the previous threshold load thereby lowering the ΔP for each loading step. As P_{max} is decreased, the resolution is increased and the loading rate is decreased. The test proceeds until the sample experiences a load drop of more than 5% during any single step in the load rate.

A2.7.2.3.5 The threshold load for the bolts, P_{th} , is obtained when the threshold load for the subsequent test is within a value of 5% of P_{max} of the threshold load measured on the previous test at the higher loading rate. The minimum value of the threshold load obtained through these measurements shall be used in the calculation described in Section **A2.8**. The lowest threshold value established by consecutive tests shall be considered the threshold load for the bolts, P_{th} . The minimum

number of samples to accomplish the establishment of the threshold load shall be five (5) specimen bolts.

A2.8 EHE Acceptance Criterion

A2.8.1 Perform tests on fasteners to the same hydrogen embrittlement acceptance criterion as Test Method F519, Type 1a specimens that require a threshold stress equal in value to that of 75% of the notch tensile strength (NTS = 1.6 UTS) of the Type 1a specimen, which is equal to or greater than 1.2 UTS.

A2.8.2 To obtain the equivalent acceptance criterion for the bolt, the net tensile stress at the root of the thread should also be equal to or greater than 1.2 UTS. Since d/D for fasteners is always greater than 0.8, that is greater than 0.7 used with Test Method F519 notched tensile specimen, the fastener must be tested in bending to attain the same stress level.

A2.8.3 The acceptance criterion for EHE shall be a threshold load in bending, σ_b , to produce the same stress or greater than the load in tension that produces a stress of 1.2 UTS or σ_b

≥ 1.2 UTS. Since the limit load of a bolt in bending equals $2.3 YS \approx 2.0$ UTS; the acceptance criterion for EHE is equivalent to $\geq 60\%$ of the fast fracture load in bending, FFS(B).

A2.8.3.1 Therefore for acceptance, the following condition must be met:

$$P_{th} \geq 0.6 \text{ FFS (B)}$$

A2.9. Test Report

A2.9.1 *Report Content:*

A2.9.1.1 Heat analysis and heat number for the steel from which the bolts are made;

A2.9.1.2 Bolt diameter;

A2.9.1.3 Bolt tensile strength;

A2.9.1.4 Fast fracture load of the specimen bolts in bending, FFS(B);

A2.9.1.5 Data for step load testing;

A2.9.1.6 Determination of bend load threshold, P_{th} ; and

A2.9.1.7 Statement that the material lot satisfies the requirements of Annex A2.

APPENDIX

(Nonmandatory Information)

X1. PRE-INSTALLATION VERIFICATION TESTING, PRETENSIONING AND INSPECTION

X1.1 Pre-Installation Verification Testing Using Bolt Tension Calibration Device

X1.1.1 Take three heavy hex structural bolt assemblies (bolt, nut and washers) of each production lot, as provided as a complete set by the manufacturer or supplier. Each set is called a “fastener assembly.” One assembly washer is used in this test.

X1.1.2 Use a slotted bushing on the back of the bolt tension calibration device.

X1.1.3 Place the bolt in the bolt tension calibration device.

X1.1.4 Add spacers, spacer bushings, flat plate shims or washers, or a combination thereof, as necessary to have approximately two to three threads of stickout beyond the face of the nut when the nut is finger tight. Any shims, spacers, or washers should be flat prior to use. Final stickout may range between five threads and a flush end condition (no stickout). Place the washer from the fastener assembly under the nut so that it will be adjacent to the nut.

X1.1.5 Snug the bolt using the technique (spud wrench, impact wrench, or installation wrench) to be used on the structure. Use approximately the same manual effort or wrench effort as will be used in the structure.

X1.1.6 Further tighten the bolt by turning the nut with the installation wrench until the following Initial Torque is applied.

Bolt Size, in.	Initial Torque,
	foot-pounds, Grade 1 and Grade 2
1	400
1 1/8	600
1 1/4	900

X1.1.7 Further tighten the bolt by turning the nut with the installation wrench until the following rotation of the nut is applied.

Bolt Size, in.	Rotation
	Grade 1 and Grade 2
1	1/2 turn (180°)
1 1/8	1/2 turn (180°)
1 1/4	1/2 turn (180°)

X1.1.8 Verify that the achieved bolt pretension, as read on the bolt tension calibration device dial gage, reaches or exceeds the pretension given in the table below:

Bolt Size, in.	Pretension, pounds, min	
	Grade 1	Grade 2
1	90 000	94 000
1 1/8	114 000	119 000
1 1/4	145 000	150 000

X1.1.9 Remove the fastener assembly and repeat steps X1.1.2 through X1.1.7 above so that a total of three consecutive fastener assemblies have been tested, and that all satisfy the requirements for bolt tension.

X1.1.10 Identifying the assembly test lot, record the achieved bolt pretensions for each tested fastener assembly in a record-keeping system.

X1.2 Heavy Hex Structural Bolt/Nut/Washer Assembly Pretensioning

X1.2.1 Align all bolt holes to permit insertion of the bolts without undue damage to the threads.

X1.2.2 Place a bolt in each hole with one washer directly under the bolt head and against the steel, place one washer against the steel over the threaded end of the bolt, and thread the nut onto the bolt.

X1.2.3 Using a systematic approach, compact the joint from the most rigid part of the joint toward the free edges, achieving the snug tight condition. Snug tight is the condition that exists when all of the plies in a connection have been pulled into firm contact by the bolts in the joint and all of the bolts in the joint have been tightened sufficiently to prevent the removal of the nuts without the use of a wrench. Firm contact is defined as the condition that exists on a faying surface when the plies are solidly seated against each other, but not necessarily in continuous contact.

X1.2.4 Multiple passes with the wrench may be necessary to achieve firm contact when connection materials do not align in-plane, or the connecting elements do not fit flatly at the faying surface.

X1.2.5 Using a systematic approach, further tighten the bolt by applying the Initial Torque to each assembly. In a joint bolt pattern with several rows, such as a large connection plate in a connection, or a bolted girder web or flange splice, the bolts in the center of the joint should be tightened first, then proceed toward the free edges of the plate. In a joint with a single or double row of bolts, tightening begins where the steel is already in contact, then proceed toward the end where the steel may not be in contact. If there is solid contact between the steel at all locations, the direction of tightening does not matter.

Bolt Size, in.	Initial Torque, foot-pounds	Tolerance for Initial Torque, foot-pounds
	Grade 1 and Grade 2	Grade 1 and Grade 2
1	400	-100, +200
1 1/8	600	-100, +300
1 1/4	900	-100, +300

X1.2.6 Using a systematic approach, further tighten the bolt by turning the nut, while holding the head, until the following rotation of the nut is applied. Alternatively, the bolt head may be turned while the nut is held.

Bolt Size, in.	Rotation Grade 1 and Grade 2	
	Both faces normal to bolt axis	One face normal to bolt axis, other sloped not more than 1:20 (no sloping washer used)
1	1/2 turn (180°)	2/3 turn (240°)
1 1/8	1/2 turn (180°)	2/3 turn (240°)
1 1/4	1/2 turn (180°)	2/3 turn (240°)
Tolerance for Rotation	-30°, +60°	-30°, +60°

X1.3 Inspection of Heavy Hex Structural Bolt/Nut/ Washer Assembly Pretensioning

X1.3.1 Inspection Prior to Installation:

X1.3.1.1 Inspect the materials to verify that they are readily identifiable, have proper markings, and have proper documentation in accordance with the project specifications.

X1.3.1.2 Inspect the storage methods to ensure that fastener lots are kept separate and identifiable until time for assembly. Fastener assemblies (bolt, nut and washers) must be kept together as shipped by the supplier.

X1.3.1.3 Verify that adequate lubrication is present for the fasteners to be used. Additional lubrication of any component of the fastener assembly is permitted, provided the Assembly Installation Tension Test as prescribed in Section 8 and Section 14.4 is performed on a minimum of two assemblies representative of those assemblies receiving such additional lubrication.

X1.3.1.4 Observe the pre-installation verification for the fastener assemblies representative of those to be installed. Three fastener assemblies of each assembly lot must be tested at the start of the work, prior to installation on the structure. The pre-installation verification test is to be performed by the bolting crew(s).

X1.3.2 Inspection After the Joint has been brought to the Snug Tight Condition:

X1.3.2.1 Visually verify that firm contact has been achieved in the joint, using the proper fastener assemblies. Firm contact is defined as the condition that exists on a faying surface when the plies are solidly seated against each other, but not necessarily in continuous contact.

X1.3.2.2 Visually verify that the length of bolt used is proper for the grip. The end of the bolt threads must be at least flush with the face of the nut (not recessed). The maximum stickout is usually in the range of four to six threads, but varies by bolt diameter and production tolerances. If needed, use a sample bolt and nut from the same lot as a comparator, running the nut up the threads but allowing two full turns at the end for pretensioning. For joints where the threads must be excluded from the shear plane, additional verification of bolt length and the direction in which the bolt is oriented may be necessary.

X1.3.2.3 Visually verify that all of the bolts in the joint have been tightened sufficiently to prevent the turning of the nuts without the use of a wrench. Where visual inspection indicates that the fastener may not have been sufficiently tightened to prevent the removal of the nut by hand, physically check that the nut cannot be removed by hand.

X1.3.3 Inspection During and After Pretensioning:

X1.3.3.1 Perform routine observation of the application of the Initial Torque and the application of the Rotation to verify the use of the proper techniques as described in X1.2.5 and X1.2.6. One need not observe all pretensioning operations.

ASTM International takes no position respecting the validity of any patent rights asserted in connection with any item mentioned in this standard. Users of this standard are expressly advised that determination of the validity of any such patent rights, and the risk of infringement of such rights, are entirely their own responsibility.

This standard is subject to revision at any time by the responsible technical committee and must be reviewed every five years and if not revised, either reapproved or withdrawn. Your comments are invited either for revision of this standard or for additional standards and should be addressed to ASTM International Headquarters. Your comments will receive careful consideration at a meeting of the responsible technical committee, which you may attend. If you feel that your comments have not received a fair hearing you should make your views known to the ASTM Committee on Standards, at the address shown below.

This standard is copyrighted by ASTM International, 100 Barr Harbor Drive, PO Box C700, West Conshohocken, PA 19428-2959, United States. Individual reprints (single or multiple copies) of this standard may be obtained by contacting ASTM at the above address or at 610-832-9585 (phone), 610-832-9555 (fax), or service@astm.org (e-mail); or through the ASTM website (www.astm.org). Permission rights to photocopy the standard may also be secured from the Copyright Clearance Center, 222 Rosewood Drive, Danvers, MA 01923, Tel: (978) 646-2600; <http://www.copyright.com/>