



# Standard Specification for “Fiberglass” (Glass-Fiber-Reinforced Thermosetting-Resin) Pipe Fittings for Nonpressure Applications<sup>1</sup>

This standard is issued under the fixed designation D3840; the number immediately following the designation indicates the year of original adoption or, in the case of revision, the year of last revision. A number in parentheses indicates the year of last reapproval. A superscript epsilon ( $\epsilon$ ) indicates an editorial change since the last revision or reapproval.

## 1. Scope\*

1.1 This specification covers fiberglass pipe fittings intended for use in gravity flow systems for conveying sanitary sewage, storm water, and those industrial wastes for which the fittings are determined to be suitable. Elbows, tees, laterals, crosses, reducers, and adapters are included. Both glass-fiber-reinforced thermosetting-resin pipe (RTRP) and glass-fiber-reinforced polymer mortar pipe (RPMP) are fiberglass pipes.

NOTE 1—For the purposes of this standard, polymer does not include natural polymers.

1.2 This specification is intended to cover only dimensions, material properties, and workmanship rather than the structural design of the fittings. The structural design of the fittings shall be as agreed upon between purchaser and supplier, and needs to take into consideration the anticipated conditions of installation and service.

1.3 This specification covers only fittings fabricated from cut sections of pipe, or from a combination of pipe sections and contact molded (hand layup), or machine fabricated components.

1.4 The values stated in inch-pound units are to be regarded as the standard. The values given in parentheses are provided for information purposes only.

1.5 The following safety hazards caveat pertains only to the test method portion, Section 11, of this specification. *This standard does not purport to address all of the safety concerns, if any, associated with its use. It is the responsibility of the user of this standard to establish appropriate safety and health practices and determine the applicability of regulatory limitations prior to use.*

NOTE 2—There is no known ISO equivalent to this standard.

<sup>1</sup> This specification is under the jurisdiction of ASTM Committee D20 on Plastics and is the direct responsibility of Subcommittee D20.23 on Reinforced Plastic Piping Systems and Chemical Equipment.

Current edition approved April 1, 2014. Published April 2014. Originally approved in 1979. Last previous edition approved in 2010 as D3840 – 10. This specification replaces Specification D4160. DOI: 10.1520/D3840-14.

## 2. Referenced Documents

### 2.1 ASTM Standards:<sup>2</sup>

- D638 Test Method for Tensile Properties of Plastics
- D883 Terminology Relating to Plastics
- D1600 Terminology for Abbreviated Terms Relating to Plastics
- D1763 Specification for Epoxy Resins
- D2290 Test Method for Apparent Hoop Tensile Strength of Plastic or Reinforced Plastic Pipe
- D3262 Specification for “Fiberglass” (Glass-Fiber-Reinforced Thermosetting-Resin) Sewer Pipe
- D3567 Practice for Determining Dimensions of “Fiberglass” (Glass-Fiber-Reinforced Thermosetting Resin) Pipe and Fittings
- D3892 Practice for Packaging/Packing of Plastics
- F412 Terminology Relating to Plastic Piping Systems
- F477 Specification for Elastomeric Seals (Gaskets) for Joining Plastic Pipe

## 3. Terminology

### 3.1 Definitions:

3.1.1 *General*—Definitions are in accordance with Terminologies D883 and F412. Abbreviations are in accordance with Terminology D1600, unless otherwise indicated.

### 3.2 Definitions of Terms Specific to This Standard:

3.2.1 *fiberglass pipe*—a tubular product containing glass fiber reinforcements embedded in or surrounded by cured thermosetting resin. It is acceptable for the composite structure to contain aggregate, granular or platelet fillers, thixotropic agents, pigments or dyes. It is acceptable to include thermoplastic or thermosetting liners or coatings.

3.2.2 *reinforced polymer mortar pipe*—a fiberglass pipe with aggregate.

3.2.3 *reinforced thermosetting resin pipe*—a fiberglass pipe without aggregate.

3.2.4 *qualification*—One or more tests used to prove the design of a product. Not a routine quality control test.

<sup>2</sup> For referenced ASTM standards, visit the ASTM website, www.astm.org, or contact ASTM Customer Service at service@astm.org. For *Annual Book of ASTM Standards* volume information, refer to the standard’s Document Summary page on the ASTM website.

\*A Summary of Changes section appears at the end of this standard

NOTE 3—Qualification requirements appear in 6.1, 7.2, and 12.3.

## 4. Materials

### 4.1 Laminating Resin:

4.1.1 *Type 1*—Polyester thermosetting resin, with or without fillers or thixotropic agents or both.

NOTE 4—For the purpose of this standard, polyester includes vinyl ester resins.

4.1.2 *Type 2*—Epoxy resin, conforming to the requirements of Specification **D1763**, with or without fillers or thixotropic agents, or both.

### 4.2 Reinforcement:

4.2.1 *Grade 1*—A commercial grade of glass fibers with a polyester-compatible finish.

4.2.2 *Grade 2*—A commercial grade of glass fibers with an epoxy-compatible finish.

4.3 *Gaskets*—The elastomeric gaskets used with the fittings joined to pipe shall conform to the requirements of Specification **F477**.

## 5. Fabrication

### 5.1 Permissible Components:

5.1.1 Fittings covered under this specification shall be fabricated from cut section of pipe that conform to the requirements of Specification **D3262**, or from a combination of such pipe sections and contact molded (hand layup) or machine fabricated components.

5.1.2 It is acceptable to incorporate saddles, wrappers, necked flanges, and other components of metal or other dissimilar materials, as agreed upon between purchaser and supplier, provided the materials of such components are resistant to the corrosive effects of the internal and external environments anticipated in service, or are lined or coated or both with materials that provide equivalent protection.

### 5.2 Bonding and Laminate Overlay Reinforcements:

5.2.1 Sections of the fitting shall be aligned and bonded together using polyester (Type 1) or epoxy (Type 2) resin materials with or without fiberglass reinforcement. Fiberglass reinforcement materials shall be compatible with the laminating resin; Grade 1 reinforcements shall be used with Type 1 laminating resin, and Grade 2 reinforcements shall be used with Type 2 laminating resin.

5.2.2 It is acceptable to apply laminated reinforcing overlays of bonded seams to either the outside or inside surface of the fitting, or to both inside and outside surfaces. The laminate shall be of chemically resistant construction suitable for the purpose and shall provide the additional strength necessary to meet the physical requirements shown in **Table 1**. Finished seam overlays shall be built up in two or more successive layers of reinforcement and shall be as crevice free as described in this paragraph and **5.2.3**. The width of the first layer shall be 2 in. (50 mm) minimum. Successive layers shall increase uniformly in width to provide the specified minimum total width of overlay that shall be centered on the seam. **Table 1** shows minimum widths of overlays required. The ends of each layer of reinforcement shall be overlapped a minimum of 1 in. (25 mm). Crevices between joined sections shall be filled

with a filled resin paste, leaving a smooth inner surface. The interior of the seams shall also be sealed by covering with not less than a 0.03 in. (0.76 mm) thickness of reinforced resin-rich surface that provides corrosion resistance suitable for the intended service. Alternatively, when it is necessary to fabricate a fitting where the size and configuration do not allow adequate access to interior seams, the cut edges of sections shall be sealed prior to assembly and any reinforcing overlay protected by a resin-rich surface that provides corrosion resistance suitable for the intended service.

5.2.3 Components of dissimilar materials, such as steel to polyester or epoxy laminates, or polyester to epoxy laminates, shall be bonded with a resin compound capable of adhering to both materials. The resin compound shall contact the joining surfaces of both components with the spaces between the components filled. The excess resin compound that extrudes from the seam shall be removed, leaving a smooth fillet. Sealing laminates and reinforcing overlays shall be applied where required (see **5.1.1**, **5.2.1**, and **5.2.2**).

## 6. Joints

6.1 The fitting joints shall be coupling or bell-and-spigot in accordance with the joint requirements of Specification **D3262**, unless otherwise specified. It is acceptable to qualify joint designs on straight sections of pipe.

## 7. Physical Requirements

7.1 Properties of structural laminates, used either as seam reinforcing overlays or as contact molded or machine fabricated components, other than cut sections of pipe, shall be as shown in **Table 1**, when tested in accordance with **11.1**.

7.2 *Shear Strength*—The minimum shear strength of seam reinforcing overlays shall be 500 psi (3.45 MPa) when tested in accordance with **11.2**.

## 8. Dimensions and Permissible Variations

8.1 *Wall Thickness*—The wall thickness of any area of the fitting furnished under this specification shall not at any point be less than 87.5 % of the nominal wall thickness published in the manufacturers' literature current at the time of purchase when measured in accordance with **11.3.1**.

8.2 *Fitting Diameters*—Fittings shall be supplied in nominal diameters as given in Specification **D3262**. The fitting diameter tolerances shall be as given in Specification **D3262**, when measured in accordance with **11.3.2**.

8.3 *Lengths*—The tolerance for the laying length and other significant dimensions shall be  $\pm 2$  in. ( $\pm 51$  mm) or  $\pm 1$  % of the dimension, whichever is greater. See **Tables 2-6** and **Figs. 1 and 2** for typical minimum laying lengths.

8.4 *Angular Dimensions*—Angular dimensions shall have a tolerance of  $\pm 1^\circ$  when measured in accordance with **11.3.4**.

## 9. Workmanship, Finish, and Appearance

9.1 The inside surfaces of each fitting shall blend smoothly and shall be free of bulges, dents, ridges, or other irregularities that result in a variation of more than  $\frac{1}{8}$  in. (3.2 mm) from that obtained on adjacent portions of the surface.

**TABLE 1 Minimum Properties of Structural Laminates**

Nominal Diameter, in. (mm)	Minimum Hoop Tensile Strength, lbf/in. (kN/m) of width <sup>A</sup>	Minimum Axial Tensile Strength, lbf/in. (kN/m) of circumference <sup>A</sup>	Minimum Total Width of Overlay, in. (mm) <sup>B</sup>
8 (203)	1600 (280)	1600 (280)	4 (100)
10 (254)	1600 (280)	1600 (280)	4 (100)
12 (305)	1600 (280)	1600 (280)	4 (100)
14 (356)	1600 (280)	1600 (280)	4 (100)
15 (381)	1600 (280)	1600 (280)	4 (100)
16 (406)	1600 (280)	1600 (280)	4 (100)
18 (457)	1600 (280)	1600 (280)	4 (100)
20 (508)	1600 (280)	1600 (280)	4 (100)
21 (533)	1600 (280)	1600 (280)	4 (100)
24 (610)	1600 (280)	1600 (280)	4 (100)
27 (686)	1600 (280)	1600 (280)	4 (100)
30 (762)	1600 (280)	1600 (280)	4 (100)
33 (838)	1700 (300)	1700 (300)	6 (150)
36 (914)	1800 (315)	1800 (315)	6 (150)
39 (991)	2000 (350)	2000 (350)	6 (150)
42 (1067)	2100 (368)	2100 (368)	6 (150)
45 (1143)	2300 (403)	2300 (403)	6 (150)
48 (1219)	2400 (420)	2400 (420)	8 (200)
51 (1295)	2600 (455)	2600 (455)	8 (200)
54 (1372)	2700 (473)	2700 (473)	8 (200)
60 (1524)	3000 (525)	3000 (525)	8 (200)
66 (1676)	3300 (578)	3300 (578)	10 (250)
72 (1829)	3600 (630)	3600 (630)	10 (250)
78 (1981)	3900 (683)	3900 (683)	10 (250)
84 (2134)	4200 (736)	4200 (736)	12 (300)
90 (2286)	4500 (788)	4500 (788)	12 (300)
96 (2438)	4800 (841)	4800 (841)	14 (350)
102 (2591)	5100 (893)	5100 (893)	16 (400)
108 (2743)	5400 (946)	5400 (946)	16 (400)
114 (2896)	5700 (998)	5700 (998)	16 (400)
120 (3048)	6000 (1051)	6000 (1051)	16 (400)
132 (3353)	6600 (1156)	6600 (1156)	18 (450)
144 (3658)	7200 (1261)	7200 (1261)	20 (500)
156 (3962)	7800 (1366)	7800 (1366)	22 (550)

<sup>A</sup>The values given are minimums only. Sound engineering practice dictates that all fittings be designed to withstand the loads and conditions anticipated in the service for which they are intended.

<sup>B</sup>The dimensions given are minimums for “butt-and-strap” type joints.

NOTE 5—This requirement is concerned with roughness and waviness and does not apply to diameter tolerances or thickness of internal seam reinforcement if present. See 8.2 for inside diameter tolerances, including internal reinforcement.

9.2 Joint sealing surfaces shall be free of dents, gouges, cracks, and other surface imperfections that will affect the integrity of the joints.

9.3 The inner surface of each reinforced plastic fitting component and connecting seam shall be composed of resin with or without reinforcement, aggregate, or filler. No glass fiber-reinforcement shall penetrate the interior surface of the fitting wall.

9.4 Internal and external reinforcements shall be free of voids, dry spots, cracks, and crazing. Some waviness in the internal reinforcement is permissible so long as the surface is smooth. Unless otherwise agreed upon between purchaser and supplier, all fittings shall meet the visual and repair criteria of Tables 7 and 8.

9.5 Fittings shall show good workmanship, including uniformity from item to item.

## 10. Sampling

10.1 Lot—Unless otherwise agreed upon between purchaser and supplier, one lot shall consist of 100 fittings of each type,

grade, and construction of laminate overlay reinforcement, or contact molded or machine fabricated component, or both.

10.2 Unit Sample—Select one fitting from each lot. Prepare a sample or representative laminate and test specimens to determine conformance with the requirements of 7.1 for ultimate tensile strength.

## 11. Test Methods

11.1 Ultimate Tensile Strength—Determine the ultimate tensile strength of sample laminate specimens cut from seam reinforcing overlays or contact molded or machine fabricated components, or from specimens of a laminate fabricated to be consistent in every way with the construction used in the reinforcing overlay or component of the fitting. One or both of the following test methods shall be employed at the manufacturer’s option:

11.1.1 Test Method D2290, using Type B specimens, except that the size of the specimens shall be permitted to be modified and speed of testing and rate of crosshead motion shall not apply. Record the load to fail of each specimen and determine the specimen width as close to the break as possible. Use the measured width and failure load to calculate the tensile strength.

TABLE 2 0° to 30° Elbow<sup>A</sup>

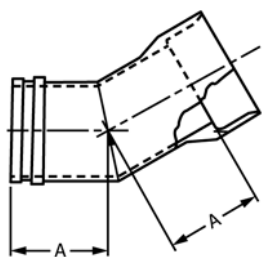

Pipe Size, in. (mm)	Dimension A <sup>B</sup> , in. (mm)
8 (203)	12 (305)
10 (254)	13 (330)
12 (305)	13 (330)
14 (356)	14 (356)
15 (381)	14 (356)
16 (406)	15 (381)
18 (457)	15 (381)
20 (508)	16 (406)
21 (533)	16 (406)
24 (610)	17 (432)
27 (686)	17 (432)
30 (762)	18 (457)
33 (838)	18 (457)
36 (914)	20 (508)
39 (991)	21 (533)
42 (1067)	22 (559)
45 (1143)	23 (584)
48 (1219)	24 (610)
54 (1372)	25 (635)
60 (1524)	26 (660)
66 (1676)	29 (737)
72 (1829)	29 (737)
78 (1981)	30 (762)
84 (2134)	34 (864)
90 (2286)	36 (914)
96 (2438)	38 (965)
102 (2591)	39 (991)
108 (2743)	41 (1041)

<sup>A</sup> Fitting end configurations other than the typical bell and spigot shown in the figure are acceptable as agreed upon between manufacturer and purchaser. Refer to Section 6.

<sup>B</sup> Dimensions given are typical minimum laying lengths. Laying lengths for fittings larger than 108 in. diameter shall be as agreed upon between purchaser and supplier.

11.1.2 *Test Method D638*, using flat Type I specimens, except that the specimens shall be the actual thickness of the reinforcing overlay or fabricated component and the other dimensions shall be suitable for the specimen thickness and the testing apparatus. Specimens shall be permitted to be machined on the edges, but shall not be machined on the surface. Tensile strength shall be the average of five specimens tested at a speed of 0.20 to 0.25 in. (5 to 6.4 mm)/min.

11.1.3 Conduct tests of anisotropic laminates to determine the ultimate tensile strength in both the hoop and axial directions. The ultimate tensile strength of isotropic laminates shall be permitted to be determined in either the hoop or axial direction.

11.2 *Minimum Shear Strength*—Determine the shear strength of axially oriented laminate specimens in accordance with 11.1.2, except that the specimens shall be representative of an overlay reinforced seam joining two cut sections of pipe

TABLE 3 31° to 60° Elbow<sup>A</sup>

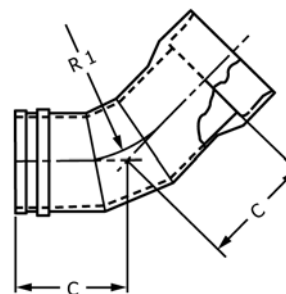

Pipe Size, in. (mm)	Dimension C <sup>B</sup> , in. (mm)	R1 (45°), in. (mm)
8 (203)	18.5 (470)	12.0 (305)
10 (254)	19.5 (495)	15.0 (381)
12 (305)	20.5 (521)	18.0 (457)
14 (356)	22.0 (559)	21.0 (533)
15 (381)	22.5 (572)	22.5 (572)
16 (406)	23.0 (584)	24.0 (610)
18 (457)	25.0 (635)	27.0 (686)
20 (508)	25.5 (648)	30.0 (762)
21 (533)	26.0 (660)	31.5 (800)
24 (610)	27.5 (699)	36.0 (914)
27 (686)	28.5 (724)	40.5 (1029)
30 (762)	31.0 (787)	45.0 (1143)
33 (838)	33.0 (838)	49.5 (1257)
36 (914)	34.5 (876)	54.0 (1372)
39 (991)	36.5 (927)	58.5 (1486)
42 (1067)	38.0 (965)	63.0 (1600)
45 (1143)	40.5 (1029)	67.5 (1715)
48 (1219)	41.5 (1054)	72.0 (1829)
54 (1372)	45.0 (1143)	81.0 (2057)
60 (1524)	48.5 (1232)	90.0 (2286)
66 (1676)	52.0 (1321)	99.0 (2515)
72 (1829)	55.5 (1410)	108.0 (2743)
78 (1981)	59.0 (1499)	117.0 (2972)
84 (2134)	62.5 (1588)	126.0 (3200)
90 (2286)	66.5 (1689)	135.0 (3429)
96 (2438)	70.0 (1778)	144.0 (3658)
102 (2591)	73.5 (1867)	153.0 (3886)
108 (2743)	77.0 (1956)	162.0 (4115)

<sup>A</sup>Fitting end configurations other than the typical bell and spigot shown in the figure are acceptable as agreed upon between the manufacturer and purchaser. Refer to Section 6.

<sup>B</sup>Dimensions given are typical minimum laying lengths. Laying lengths for fittings larger than 108 in. diameter shall be as agreed upon between purchaser and supplier.

in straight alignment (See Fig. 3). Calculate the shear strength by dividing the maximum load by the area of both sides of the pipe section covered by the reinforcing overlay on one side of the seam. If the specimen does not fail or if the failure occurs outside of the reinforced area, consider the results satisfactory provided the shear strength calculated from the maximum load exceeds 500 psi (3.45 MPa).

11.3 *Dimensions:*

11.3.1 *Wall Thickness*—Determine in accordance with Practice D3567.

11.3.2 *Inside Diameter*—Determine in accordance with Practice D3567.

11.3.3 *Outside Diameter*—Determine in accordance with Practice D3567.

TABLE 4 61° to 90° Elbow<sup>A</sup>

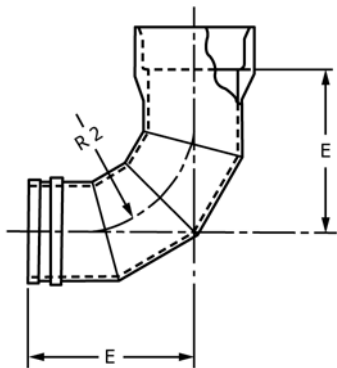

Pipe Size, in. (mm)	Dimension E <sup>B</sup> , in. (mm)	R2 (90°), in. (mm)
8 (203)	26.0 (660)	12.0 (305)
10 (254)	28.5 (724)	15.0 (381)
12 (305)	31.0 (787)	18.0 (457)
14 (356)	34.5 (876)	21.0 (533)
15 (381)	35.5 (902)	22.5 (572)
16 (406)	37.0 (940)	24.0 (610)
18 (457)	40.5 (1029)	27.0 (686)
20 (508)	43.0 (1092)	30.0 (762)
21 (533)	44.0 (1118)	31.5 (800)
24 (610)	46.0 (1219)	36.0 (914)
27 (686)	49.0 (1308)	40.5 (1029)
30 (762)	53.0 (1422)	45.0 (1143)
33 (838)	58.0 (1549)	49.5 (1257)
36 (914)	63.0 (1638)	54.0 (1372)
39 (991)	68.0 (1778)	58.5 (1486)
42 (1067)	71.0 (1854)	63.0 (1600)
45 (1143)	77.5 (1969)	67.5 (1715)
48 (1219)	80.0 (2070)	72.0 (1829)
54 (1372)	88.0 (2286)	81.0 (2057)
60 (1524)	95.0 (2489)	90.0 (2286)
66 (1676)	103.0 (2705)	99.0 (2515)
72 (1829)	115.0 (2921)	108.0 (2743)
78 (1981)	123.0 (3137)	117.0 (2972)
84 (2134)	131.5 (3340)	126.0 (3200)
90 (2286)	140.0 (3556)	135.0 (3429)
96 (2438)	148.5 (3772)	144.0 (3658)
102 (2591)	157.0 (3988)	153.0 (3886)
108 (2743)	165.5 (4204)	162.0 (4115)

<sup>A</sup>Fitting end configurations other than the typical bell and spigot shown in the figure are acceptable as agreed upon between the manufacturer and purchaser. Refer to Section 6.

<sup>B</sup>Dimensions given are typical minimum laying lengths. Laying lengths for fittings larger than 108 in. diameter shall be as agreed upon between purchaser and supplier.

TABLE 5 Tee<sup>A</sup>

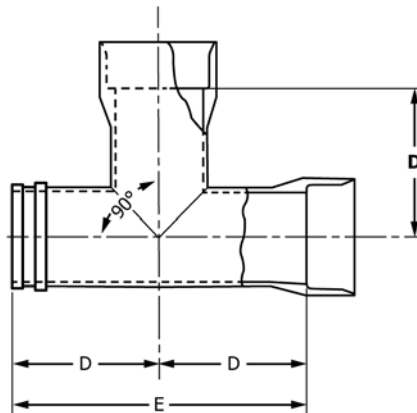

Pipe Size, in. (mm)	Dimension D <sup>B</sup> , in. (mm)	Dimension E <sup>B</sup> , in. (mm)
8 (203)	15.0 (381)	30.0 (762)
10 (254)	16.0 (406)	32.0 (813)
12 (305)	17.0 (432)	34.0 (864)
14 (356)	18.0 (457)	36.0 (914)
15 (381)	18.5 (470)	37.0 (940)
16 (406)	19.0 (483)	38.0 (965)
18 (457)	20.0 (508)	40.0 (1016)
20 (508)	21.0 (533)	42.0 (1067)
21 (533)	21.5 (546)	43.0 (1092)
24 (610)	24.0 (610)	48.0 (1219)
27 (686)	25.5 (648)	51.0 (1295)
30 (762)	27.0 (686)	54.0 (1372)
33 (838)	28.5 (724)	57.0 (1448)
36 (914)	30.0 (762)	60.0 (1524)
39 (991)	31.5 (800)	63.0 (1600)
42 (1067)	33.0 (838)	66.0 (1676)
45 (1143)	35.5 (902)	71.0 (1803)
48 (1219)	37.0 (940)	74.0 (1880)
54 (1372)	40.0 (1016)	80.0 (2032)
60 (1524)	43.0 (1092)	86.0 (2184)
66 (1676)	47.0 (1194)	94.0 (2388)
72 (1829)	50.0 (1270)	100.0 (2540)
78 (1981)	53.0 (1346)	106.0 (2692)
84 (2134)	56.0 (1422)	112.0 (2845)
90 (2286)	60.0 (1524)	120.0 (3048)
96 (2438)	63.0 (1600)	126.0 (3201)
102 (2591)	66.0 (1676)	132.0 (3353)
108 (2743)	69.0 (1753)	138.0 (3505)

<sup>A</sup> Fitting end configurations other than the typical bell and spigot shown in the figure are acceptable as agreed upon between the manufacturer and purchaser. Refer to Section 6.

<sup>B</sup> Dimensions given are minimum laying lengths. Laying lengths for fittings larger than 108 in. diameter shall be as agreed upon between purchaser and supplier.

11.3.4 *Lengths*—Determine in accordance with Practice D3567. Straightedges, levels, squares, and other devices shall be permitted to be employed as required by the configuration of the fitting or component.

11.3.5 *Angular Dimensions*—Measure with a protractor or other suitable device having graduations of 1 deg or less. Straightedges, levels, squares, and other devices shall be permitted to be employed as required by the configuration of the fitting or component. Alternatively, angular dimensions shall be permitted to be calculated from linear measurements.

## 12. Inspection

12.1 Visually and dimensionally inspect each fitting. Discrepancies shall be corrected or the defective fitting shall be rejected, as agreed upon between purchaser and supplier.

12.2 If the results of the test for ultimate tensile strength requirements of 7.1 fall below the required minimums, then, at the option of the supplier, that test shall be repeated on two additional sample laminates representative of that same lot, each of which shall conform to the requirements specified. If



TABLE 6 45° Wye<sup>A</sup>

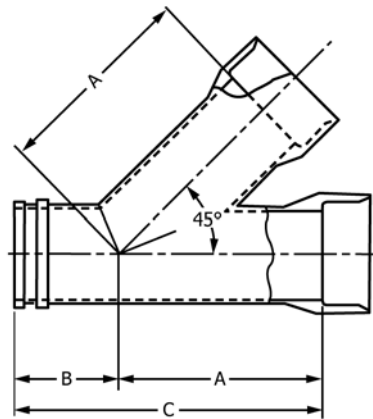

either of these two additional samples fail, the purchaser shall have the option to reject the lot.

12.3 The initial design of reinforcing overlays and fabricated components shall be qualified by dimensional and visual inspection and by testing in accordance with the requirements of 7.1 and 7.2. The overlay or component shall be requalified when any change occurs in either the resin formulation, the total amount of the reinforcement, the grade or composition of the finish (sizing or coating) of the reinforcement, the application method, or the technique of fabrication.

12.4 Additional inspections and tests shall be as agreed upon by the purchaser and the supplier as part of the purchase contract.

### 13. Packaging, Marking, and Shipping

13.1 Fittings shall be marked on the outside surface in letters not less than 1/2 in. in height and of bold type style in a color and type that will remain legible under normal handling and installation procedures. The marking shall include this ASTM specification number: D3840, manufacturer’s name or trademark, nominal size, and the words “GRAVITY SEWER.”

13.2 Fittings shall be prepared for shipment so as to ensure acceptance by common or other carriers.

13.3 All packing, packaging, and marking provisions of Practice D3892 shall apply to this specification.

### 14. Keywords

14.1 dimensions; fabrication; fiberglass; fittings; overlays; pipe

Pipe Size, in. (mm)	Dimension A <sup>B</sup> , in. (mm)	Dimension B <sup>B</sup> , in. (mm)	Dimension C <sup>B</sup> , in. (mm)
8 (203)	24.0 (610)	13.0 (330)	37.0 (940)
10 (254)	26.5 (673)	13.5 (343)	40.0 (1016)
12 (305)	29.0 (737)	13.5 (343)	42.5 (1080)
14 (356)	31.0 (787)	14.0 (356)	45.0 (1143)
15 (381)	32.5 (826)	14.5 (368)	47.0 (1194)
16 (406)	33.5 (851)	14.5 (368)	48.0 (1219)
18 (457)	36.0 (914)	15.0 (381)	51.0 (1295)
20 (508)	38.5 (978)	15.5 (394)	54.0 (1372)
21 (533)	39.5 (1003)	15.5 (394)	55.0 (1397)
24 (610)	43.5 (1105)	16.0 (406)	59.5 (1511)
27 (686)	47.0 (1194)	17.0 (432)	64.0 (1626)
30 (762)	50.5 (1283)	17.5 (445)	68.0 (1727)
33 (838)	54.0 (1372)	18.0 (457)	72.0 (1829)
36 (914)	58.0 (1473)	18.5 (470)	76.5 (1943)
39 (991)	61.5 (1562)	19.0 (483)	80.5 (2045)
42 (1067)	66.0 (1676)	21.0 (533)	87.0 (2210)
45 (1143)	69.5 (1765)	21.5 (546)	91.0 (2311)
48 (1219)	73.5 (1867)	22.0 (559)	95.5 (2426)
54 (1372)	80.5 (2045)	23.5 (597)	104.0 (2642)
60 (1524)	88.0 (2235)	24.5 (622)	112.5 (2858)
66 (1676)	97.0 (2464)	28.0 (711)	125.0 (3175)
72 (1829)	104.5 (2654)	29.0 (737)	133.5 (3391)
78 (1981)	111.5 (2832)	30.0 (762)	141.5 (3594)
84 (2134)	120.0 (3048)	32.5 (826)	152.5 (3874)
90 (2286)	127.0 (3226)	33.5 (851)	160.5 (4077)
96 (2438)	134.5 (3416)	35.0 (889)	169.5 (4305)
102 (2591)	141.5 (3594)	36.0 (914)	176.5 (4483)
108 (2743)	150.0 (3810)	38.5 (978)	188.5 (4788)

<sup>A</sup> Fitting end configurations other than the typical bell and spigot shown in the figure are acceptable as agreed upon between the manufacturer and purchaser. Refer to Section 6.

<sup>B</sup> Dimensions given are typical minimum laying lengths. Laying lengths for fittings larger than 108 in. diameter shall be as agreed upon between purchaser and supplier.

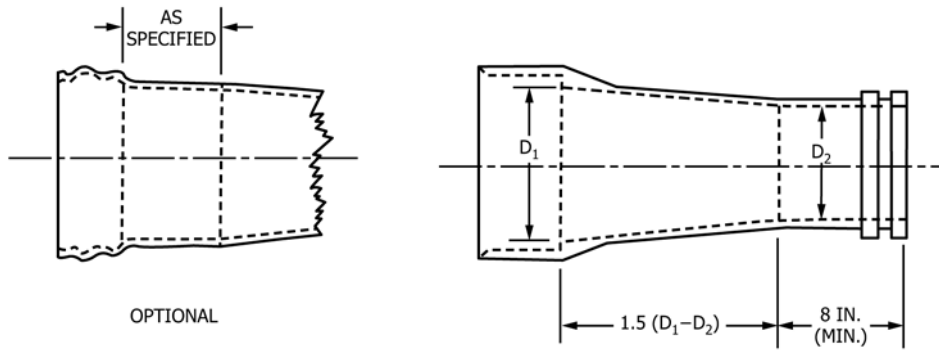

NOTE 1—Fitting end configurations other than the typical bell and spigot shown in the figure are acceptable as agreed upon between the manufacturer and purchaser. Refer to Section 6.

FIG. 1 Concentric Reducer

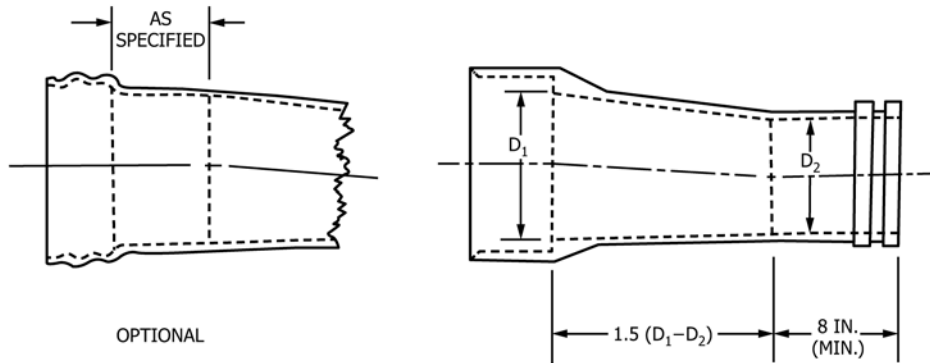

NOTE 1—Fitting end configurations other than the typical bell and spigot shown in the figure are acceptable as agreed upon between the manufacturer and purchaser. Refer to Section 6.

FIG. 2 Eccentric Reducer

**TABLE 7 Visual Inspection and Repair Criteria for Inside Surfaces of Fiberglass Pipe Fittings**

Indication	Description	Acceptable Without Repair		Permitted Repair	Maximum Repairs/ft <sup>2</sup>
		Maximum Size	No./ft. <sup>2</sup>		
Air bubble (void)	air entrapment within the liner reinforcement	1/16 in. in diameter	2/in. <sup>2</sup>	A	10
Chip	small piece broken from edge or surface	1/4 in. long and 1/2 the liner thickness	10	A	10
Crack	separation of the laminate extending through the thickness of the liner	none permitted	0	A	5
Crazing	fine cracks at or under the surface	none permitted	0	A	10
Dry-spot	area where reinforcement was not thoroughly wetted with resin	none permitted	0	A	0.35 ft <sup>2</sup> in area
Lack of fill-out	area where resin has drained from reinforcement	1 in. long and 1/2 the liner thickness	5	A	0.35 ft <sup>2</sup> in area
Pits (pinholes)	small craters in surface	1/8 in. long and 1/2 the liner thickness	15	A	15
Scratch	shallow mark, groove, furrow, or channel	maximum 1/4 of the liner thickness; if exceeds 1/2 of the liner thickness use repair <sup>A</sup>	no limit	B	no limit <sup>B</sup> 0.35 ft <sup>2</sup> area <sup>A</sup>
Wrinkle	an imperfection that has the appearance of a wave molded into the reinforcement material	no limit, provided wrinkle has not cracked the structural wall	no limit	none required	0

<sup>A</sup> Permitted repairs—Replace liner material in the discrepant area.

<sup>B</sup> Permitted repairs—Coat with liner resin.

**TABLE 8 Visual Inspection and Repair Criteria for Exterior Surfaces of Fiberglass Pipe Fittings**

Indication	Description	Acceptable Without Repair		Permitted Repair	Maximum Repairs/ft <sup>2</sup>
		Maximum Size	No./ft. <sup>2</sup>		
Burn	thermal decomposition evidenced by distortion or destruction of the surface, or both	5 % of the wall thickness; repair not permitted if decomposition extends beyond 35 % of wall thickness	5	A	1
Chip	small piece broken from edge or surface	maximum 1/4 in. long by 10 % of wall thickness (NTE 1/8 in. deep); if over 1/16 in. deep use repair <sup>B</sup>	2	A	5
Crack	separation of the laminate extending through the wall and visible on opposite surfaces	none permitted	0	A	5
Cut roving	broken or cut outer rovings due to scraping or scuffing during handling	none permitted; repair not permitted if damage extends beyond 35 % of wall thickness.	0	A	1
Crazing	fine cracks at or under the surface, exposing reinforcement	none permitted	0	A	5
Drip, resin	resin protrusion	1/2 in. high	no limit	C	no limit
Dry spot	area where reinforcement was not thoroughly wetted with resin	none permitted	0	B	5
Fish-eye	small globular mass that has not blended completely into the surrounding material	1/4 in. high	no limit	C	no limit
Fracture	rupture of laminate surface without complete penetration	none permitted; repair not permitted if fracture penetrates beyond outer 1/2 of wall thickness	0	A	2
Lack of fill-out	area where resin has drained from the reinforcement	2 in. long	5	B	0.5 ft <sup>2</sup> in area
Pits (pinholes)	small craters in surface	1/8 in. long with no exposed reinforcement	15	B	0.5 ft <sup>2</sup> in area
Scratch	shallow mark, groove, furrow, or channel caused by improper handling	no exposed reinforcement	no limit	B	20

<sup>A</sup> Apply a structural overlay extending at least 2 in. beyond the damaged area and resulting in a minimum total wall thickness in the repaired area of the wall thickness of the fitting or component in the affected area.

<sup>B</sup> Coat with resin.

<sup>C</sup> Grind excess to within tolerance.



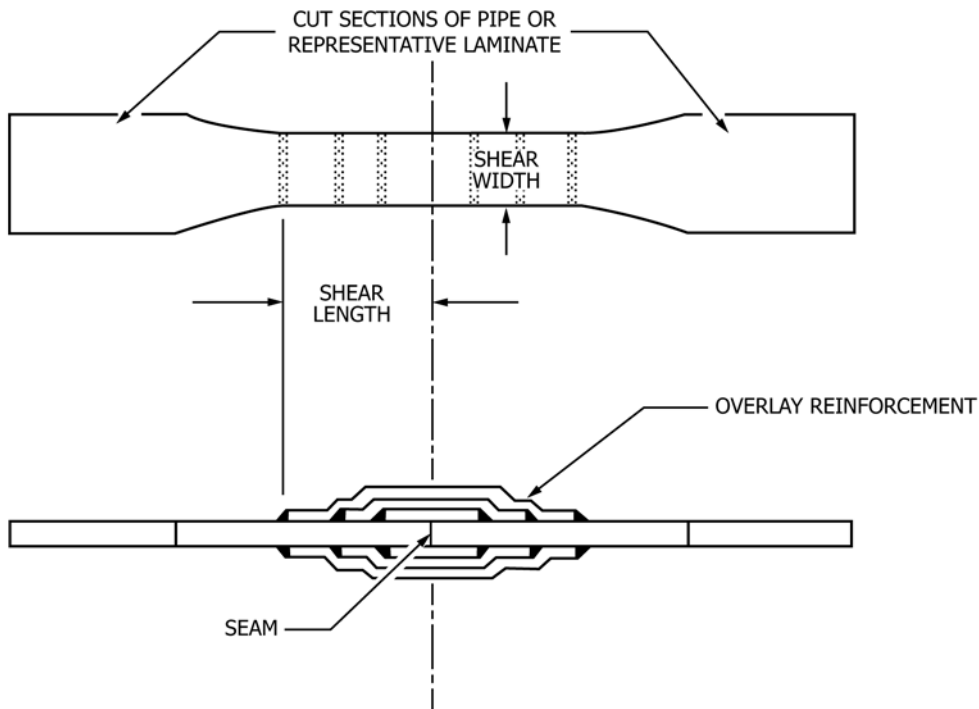

NOTE 1—It is acceptable to adjust the number of layers (symmetrically applied) and shear area, if desired, to ensure that shear is the failure mode.

FIG. 3 Shear Test Specimen

### SUMMARY OF CHANGES

Committee D20 has identified the location of selected changes to this standard since the last issue (D3840 – 10) that may impact the use of this standard. (April 1, 2014)

(1) Revised **Table 1**.

*ASTM International takes no position respecting the validity of any patent rights asserted in connection with any item mentioned in this standard. Users of this standard are expressly advised that determination of the validity of any such patent rights, and the risk of infringement of such rights, are entirely their own responsibility.*

*This standard is subject to revision at any time by the responsible technical committee and must be reviewed every five years and if not revised, either reapproved or withdrawn. Your comments are invited either for revision of this standard or for additional standards and should be addressed to ASTM International Headquarters. Your comments will receive careful consideration at a meeting of the responsible technical committee, which you may attend. If you feel that your comments have not received a fair hearing you should make your views known to the ASTM Committee on Standards, at the address shown below.*

*This standard is copyrighted by ASTM International, 100 Barr Harbor Drive, PO Box C700, West Conshohocken, PA 19428-2959, United States. Individual reprints (single or multiple copies) of this standard may be obtained by contacting ASTM at the above address or at 610-832-9585 (phone), 610-832-9555 (fax), or service@astm.org (e-mail); or through the ASTM website (www.astm.org). Permission rights to photocopy the standard may also be secured from the Copyright Clearance Center, 222 Rosewood Drive, Danvers, MA 01923, Tel: (978) 646-2600; http://www.copyright.com/*